

AVAILABLE FOR SUBLEASE

23392 MADERO, UNIT A
MISSION VIEJO, CA 92691



LISTING DATA

- Unit A: ±1,666 SF Industrial Unit
- ±400 SF of Office Space
- 3:1 Parking Ratio
- One (1) 12'x12' Ground Level Door
- 16' Clear Height
- 1 Window Office, Reception, and Private Restroom
- Corner Unit
- Located within Professionally Managed Business Park
- Sublease Term Through June 30, 2027

For more information, contact:

TED ROMMEL
Senior Vice President
CalDRE: 00830845
(949) 790-3117
trommel@leeirvine.com

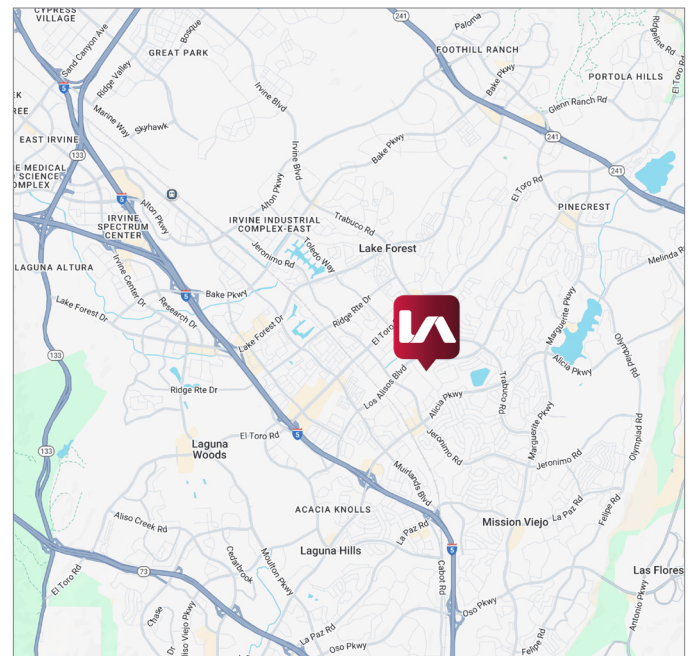

All information furnished regarding property for sale, rental or financing is from sources deemed reliable, but no warranty or representation is made to the accuracy thereof and same is submitted to errors, omissions, change of price, rental or other conditions prior to sale, lease or financing or withdrawal without notice. No liability of any kind is to be imposed on the broker herein.

AVAILABLE FOR SUBLEASE

23392 MADERO, UNIT A
MISSION VIEJO, CA 92691

FLOOR PLAN

±1,666 SF Industrial Unit

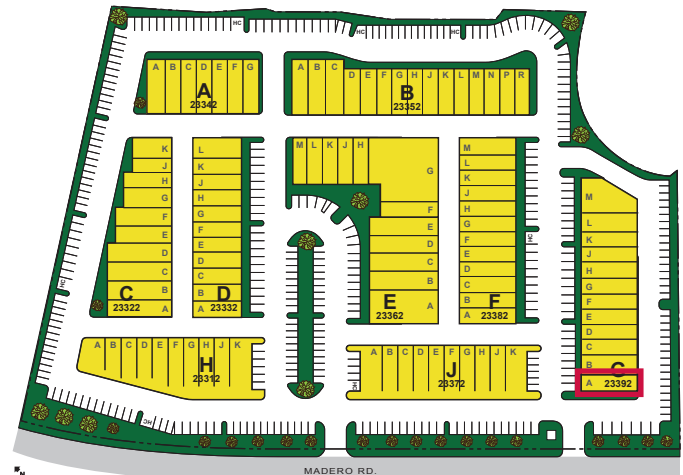
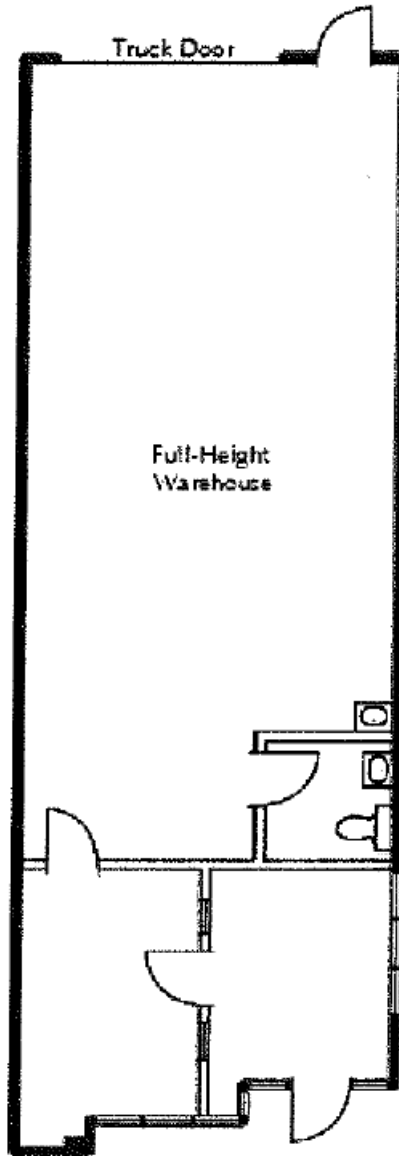

For more information, contact: **TED ROMMEL**
Senior Vice President
CalDRE: 00830845
(949) 790-3117
trommel@leeirvine.com

All information furnished regarding property for sale, rental or financing is from sources deemed reliable, but no warranty or representation is made to the accuracy thereof and same is submitted to errors, omissions, change of price, rental or other conditions prior to sale, lease or financing or withdrawal without notice. No liability of any kind is to be imposed on the broker herein.