

DEMOLITION NOTES:

1. OBTAIN DEMOLITION PERMITS AND INCLUDE ALL COSTS OF SAME IN CONTRACT PRICE, IF REQUIRED.
2. FURNISH ALL LABOR AND MATERIALS AS REQUIRED TO COMPLETE DEMOLITION AND REMOVAL OF ALL ITEMS AS INDICATED.
3. PROVIDE STRICT CONTROL OF JOB CLEANING AND PREVENT DUST AND DEBRIS FROM EMANATING FROM DEMOLITION AREA. KEEP AREA CLEAN.
4. IF ANY QUESTIONS ARISE AS TO THE REMOVAL OF ANY MATERIAL, CLARIFY THE POINT IN QUESTION WITH THE ARCHITECT BEFORE PROCEEDING.
5. AT COMPLETION OF DEMOLITION WORK, THE CONSTRUCTION AREA(S) SHALL BE LEFT IN "BROOM CLEAN" CONDITION. ALL DEBRIS AND MISCELLANEOUS MATERIAL SHALL BE REMOVED ENTIRELY FROM THE CONSTRUCTION SITE ON A DAILY BASIS TO WASTE AREA PROVIDED BY THE CONTRACTOR.
6. DEBRIS REMOVAL MUST BE PERFORMED USING THE . ALL DEBRIS REMOVAL SHALL BE PERFORMED IN ACCORDANCE WITH BUILDING MANAGEMENT REQUIREMENTS AND PROCEDURES.
7. CAREFULLY REMOVE ALL EXISTING LIGHT FIXTURES AND LENSES (WHERE DEMOLITION IS NOTED) AND STORE FOR FUTURE USE. BEFORE INDICATED RE-INSTALLATION, INSPECT EACH FIXTURE AND REPAIR OR REPLACE PARTS AS REQUIRED. ALL RELOCATED FIXTURES SHALL BE IN FULL OPERATING ORDER. ALL TUBES AND/OR BALLASTS NOT REUSED SHALL BE DISPOSED OF IN A PROPER MANNER.
8. IN PARTITIONS TO BE REMOVED, REMOVE ALL OUTLETS, SWITCHES, WIRES, ETC. TO THEIR SOURCE AS REQUIRED. RETAIN THERMOSTATS FOR REUSE.
9. CONTRACTOR SHALL BE RESPONSIBLE FOR PATCHING AND/OR REPAIRING ANY DAMAGE CAUSED BY HIM OR HIS SUBCONTRACTORS TO EXISTING CONSTRUCTION, OR TENANT SPACES. REFINISH TO MATCH EXISTING ADJACENT FINISH, OR AS NOTED HEREIN.
10. NO EXISTING SMOKE DETECTOR, PUBLIC ADDRESS SPEAKER, FIRE ALARM BOX OR SIMILAR DEVICE, INCLUDING THE ASSOCIATED WIRING SHALL BE DAMAGED DURING DEMOLITION AND SUBSEQUENT CONSTRUCTION. RELOCATION OF SMOKE DETECTORS, PUBLIC ADDRESS SPEAKERS AND FIRE ALARM EQUIPMENT, NECESSITATED BY NEW CONSTRUCTION, SHALL BE ACCOMPLISHED AS A FIRST PRIORITY, AND PER THE PLANS. NO ACTIVE SMOKE DETECTOR SHALL BE COVERED OR OTHERWISE REMOVED OR USED FOR OTHER THAN IT'S INTENDED PURPOSE.
11. WHERE DIRECTED, CAREFULLY REMOVE ALL EXISTING CEILING TILES WHERE DEMOLITION AND NEW CONSTRUCTION OCCUR AND STORE FOR LATER RE-USE. ALL BROKEN, PARTIAL, STAINED, OR DAMAGED TILES SHALL BE DISCARDED.
12. EXISTING CEILING GRID TO REMAIN EXCEPT WHERE DAMAGE OCCURS DUE TO DEMOLITION. REPLACE WITH NEW GRID TO MATCH EXISTING WHERE REQUIRED.
13. REMOVE TO SOURCE ALL PIPES, VENTS, APPLIANCES OR DRAINS NOT BEING RE-USED.
14. REMOVAL OF ANY EQUIPMENT, CABLING SWITCHES, AND CONDUIT PERTAINING TO DATA/COMMUNICATIONS AND TELEPHONE SHALL BE VERIFIED WITH TELEPHONE COMPANIES, SERVICE OWNER OR TENANT DATA/COMMUNICATIONS REPRESENTATIVE AS REQUIRED TO PREVENT NEW CONSTRUCTION DELAYS.
15. REMOVE ALL EXISTING IRREGULAR MATERIALS WHICH CAUSE RISES OR DEPRESSIONS IN FLOORING SURFACE, SUCH AS FASTENERS, OUTLET CORES, COVER PLATES, RESILIENT FLOOR COVERINGS, CARPET, CARPET PAD, FLASH PATCH, CONCRETE FILL, PLYWOOD, ETC.
16. CAREFULLY REMOVE ALL EXISTING WALL COVERING AT EXISTING PARTITIONS AND/OR COLUMNS, AS NOTED.
17. DEMOLITION IS NOT NECESSARILY LIMITED TO WHAT IS SHOWN ON DRAWINGS. THE INTENT IS TO INDICATE THE GENERAL SCOPE OF DEMOLITION REQUIRED TO COMPLETE THE WORK IN ACCORDANCE WITH THE CONTRACT DRAWINGS.
18. REMOVE EXISTING SIGNAGE/GRAPHICS AND STORE FOR RE-USE, WHERE APPLICABLE.
19. ALL EXISTING CARPET, VCT, BASE, AND WALLCOVERING TO BE REMOVED UNLESS NOTED OTHERWISE. SURFACES TO BE PREPARED TO RECEIVE NEW FINISHES.
20. CONTRACTOR TO COORDINATE LOCATION OF DUMPSTER 7 ALL DEMO WORK WITH LANDLORD.
21. HVAC: CONTRACTOR TO REMOVE ALL DUCTWORK. EXISTING ROOF TOP UNITS & EXHAUST FANS TO REMAIN.
22. EXHAUST HOOD: REMOVE HOOD AND FANS. G.C. TO CAP HOOD CURB TEMPORARILY WITH GALV. STEEL CAP SECURED TO CURB WITH 3/8" X 2" LAG SCREWS @16" OC.
23. FIRE SUPPRESSION SYSTEM: ALL EXISTING SPRINKLER HEADS TO REMAIN AS IS. ANY MODIFICATIONS TO FIRE SUPPRESSION SYSTEM TO PERMITTED BY A FIRE CONTRACTOR.

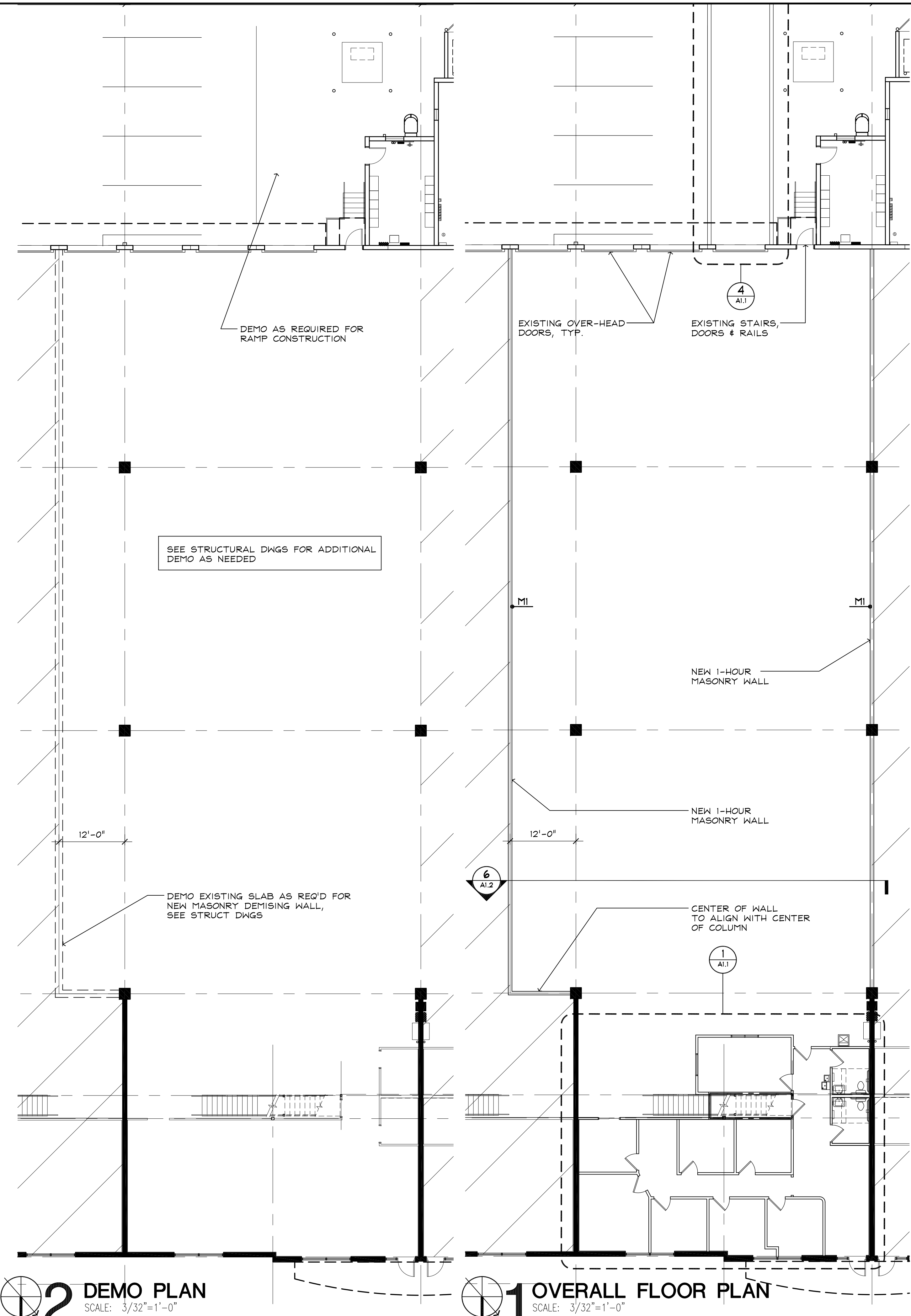

2 DEMO PLAN
SCALE: 3/32"=1'-0"

1 OVERALL FLOOR PLAN
SCALE: 3/32"=1'-0"

JVB
JVB ARCHITECT, LLC
 Architecture+Interior Design+Planning
 1719 N. Howard Avenue
 Suite 201
 Tampa, Florida 33607
 Ph: 813.258.3233
 Fax: 813.258.3236
 FL AA2601002
 email: jvb@jvbarch.com
 www.jvbarch.com
 © 2011 - All Rights Reserved

PRINTED
 7-28-11 PERMIT/CONSTRUCTION

1
2
3
4
5
6

REVISIONS

1	
2	
3	
4	
5	
6	

COPY PARTS INTL.
 2125 NW 115 AVE
 DOLPHIN COMMERCE CENTER PH II
 MIAMI, FLORIDA 33172

Joseph V. Belluccia, AIA
 FL REG AR92396

I CERTIFY TO THE BEST OF MY KNOWLEDGE THAT THE DRAWINGS & SPECIFICATIONS COMPLY WITH THE APPLICABLE MINIMUM BUILDING CODES

JOB NO : 11044
 DRAWN BY : RES
 ISSUE DATE : 7-28-11

SHEET TITLE:
OVERALL FLOOR & DEMOLITION PLAN
SHEET NUMBER
A10

11044 COPY PARTS INTL