

8-10 BACK HILL / FARRINGDON EC1R 5EN



HERBAL HOUSE

HIGH QUALITY FULLY FITTED
STUNNING WORKSPACE



ICONIC FARRINGDON LANDMARK

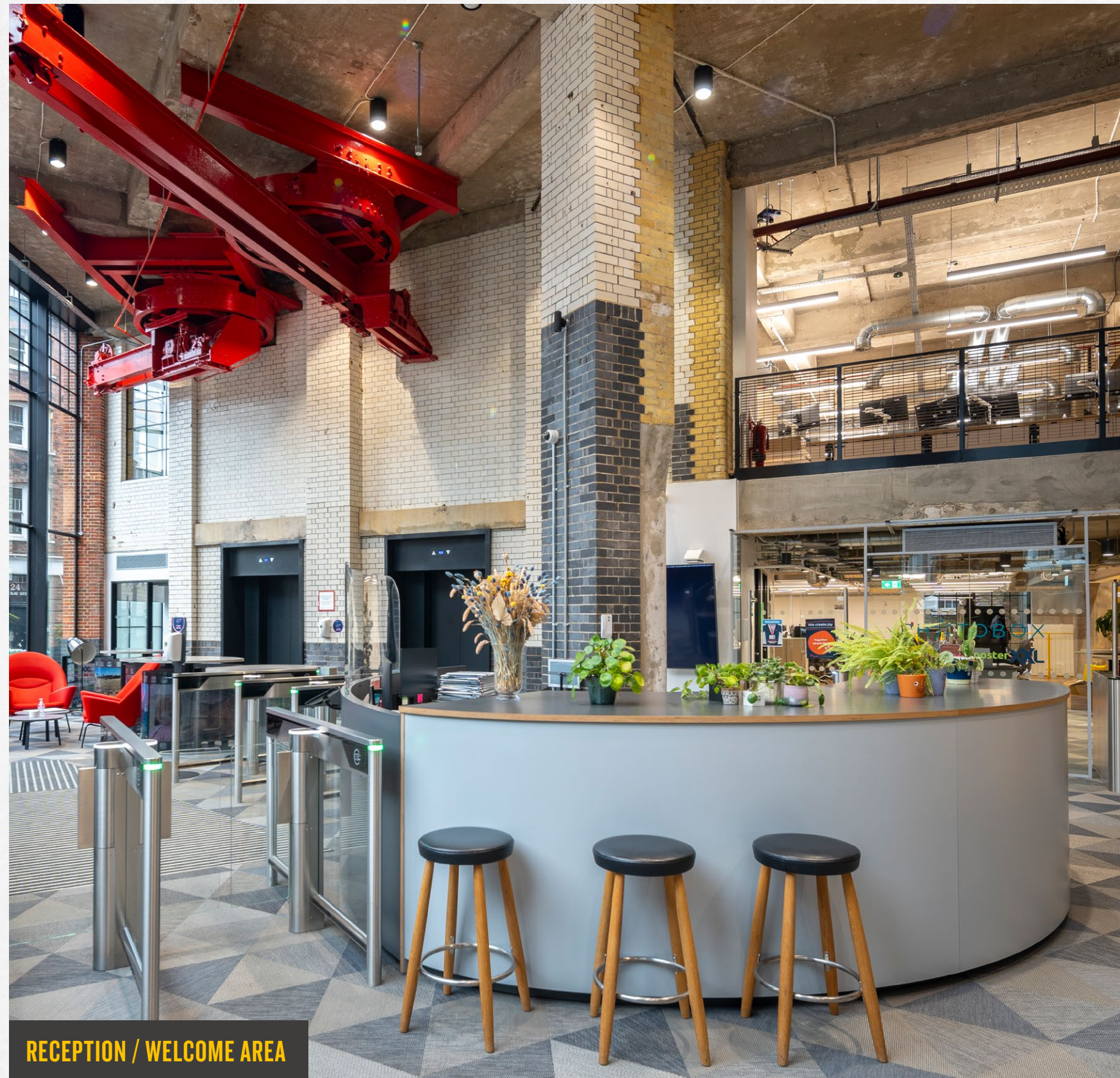

RECEPTION / WELCOME AREA



GROUND & UPPER GROUND FLOORS



**BESPOKE
INDUSTRIAL
FINISHES**

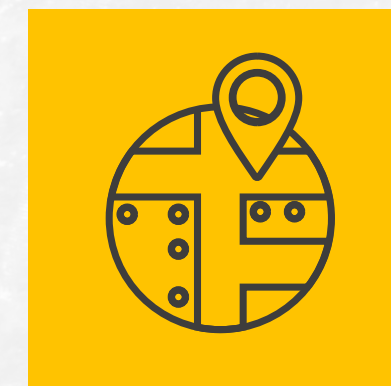

**PRIME
FARRINGDON
LOCATION**

**HERBAL HOUSE CELEBRATES ITS
INDUSTRIAL PAST, WITH CREATIVE AND
CONTEMPORARY WORKSPACE FOR TODAY.**

Originally built in 1928 to house the Daily Mirror Printworks, Herbal House now provides premium industrial-style, fully fitted offices – with 17,254 sq ft currently available on the ground and upper ground floors.

INDUSTRIAL STYLE WITH CHARACTER



UPPER GROUND FLOOR OFFICE

SUMMARY SPECIFICATION

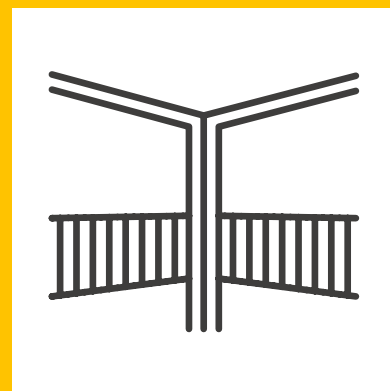

LARGE CENTRAL
FEATURE ATRIUM

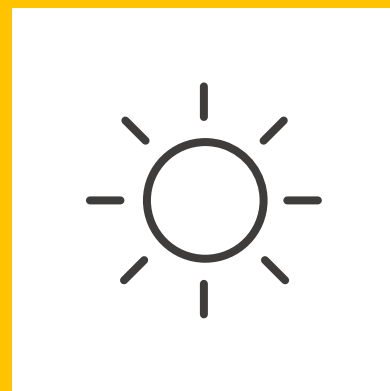

SUPERB NATURAL
LIGHT THROUGHOUT



EXTENSIVE COMMUNAL
BREAKOUT AREAS

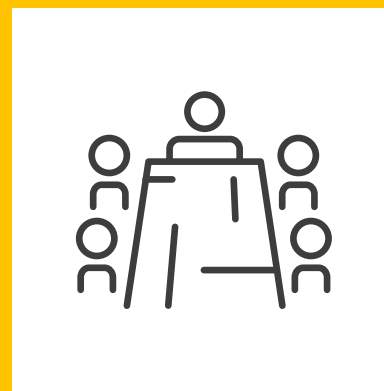

MEETING ROOMS
AT BASEMENT LEVEL



MANNED RECEPTION
& SECURITY

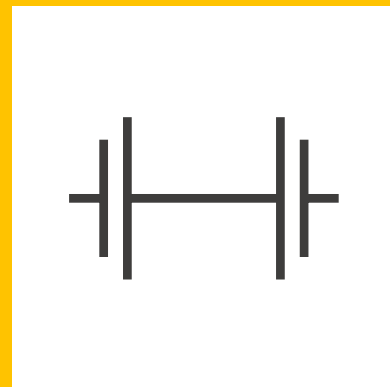

GYM

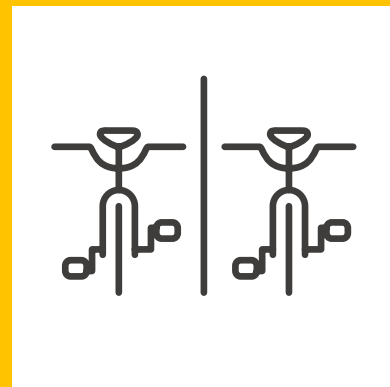

BIKE STORAGE
& LOCKERS

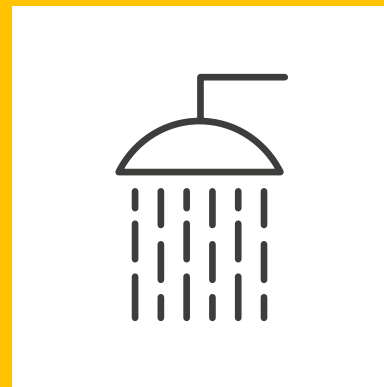

SHOWER &
CHANGING FACILITIES



GROUND FLOOR OFFICE

OPEN-PLAN SPACE TO CREATE



GROUND & UPPER GROUND FLOORS



UPPER GROUND FLOOR OFFICE



UPPER GROUND FLOOR BOARDROOM

THE UNIQUE SPACE AT HERBAL HOUSE ON GROUND AND UPPER GROUND LEVELS CATER FOR COLLABORATIVE OPEN-PLAN WORKING.

The basement level features a large shared communal space for town halls, a variety of break out areas, extra meeting rooms, a gym and a large kitchen.

The end of journey facilities are well appointed and provide easy access for the morning commute.

A UNIQUE WORKSPACE

Floor	Sq Ft	Sq M
Upper Ground	7,233	672
Ground	8,600	799

Lower Ground - LET	(13,254)	(1,231)
Shared Communal Space		
Shared Ground Floor Reception	(1,400)	(130)
Shared Basement Breakout Space	(6,544)	(1,231)

GROUND FLOOR 8,600 SQ FT / 799 SQ M

Workstations	140
16 person boardroom	01
8 person meeting room	01
4 person meeting rooms	02
3 person meeting rooms	03
2 person meeting room	01
1 to 1 areas	04
Teapoint	01

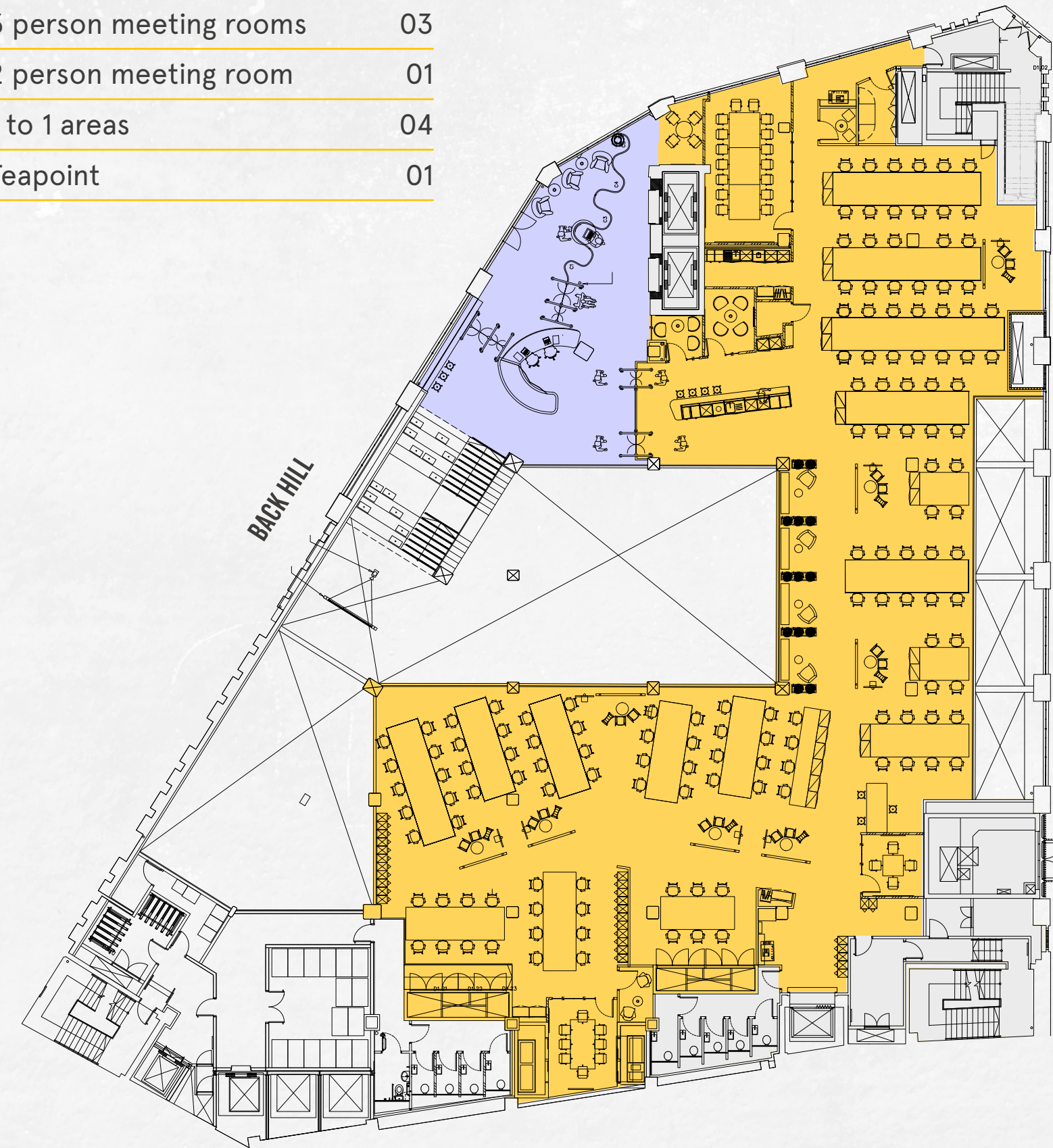

Office Shared Ground Floor Reception Area Core

UPPER GROUND FLOOR 7,233 SQ FT / 672 SQ M

Workstations	120
12 person boardroom	01
4 person meeting room	01
1 to 1 areas	04
Teapoint	01

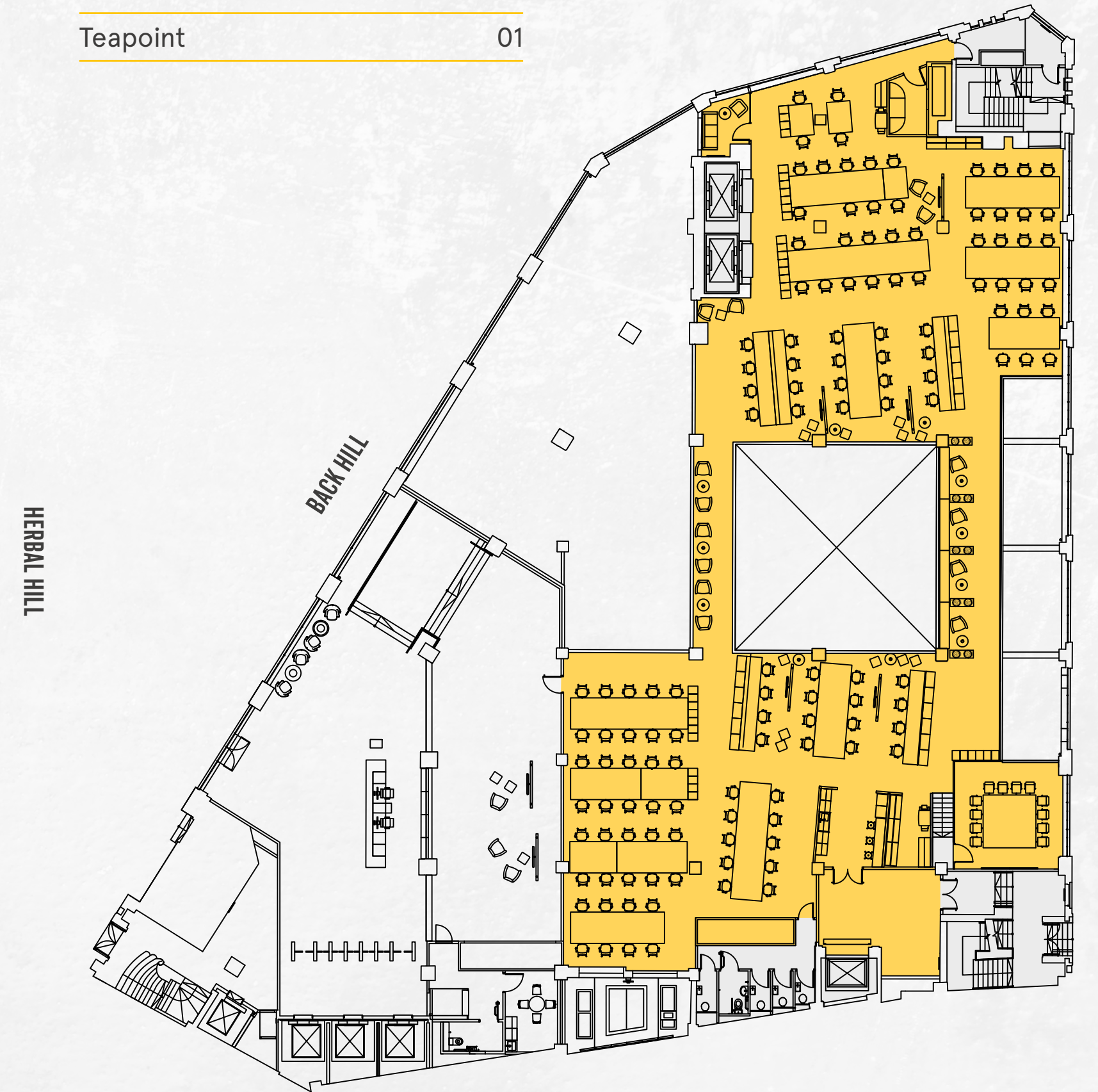

Floor plans not to scale.
For indicative purposes only.

BASEMENT - SHARED COMMUNAL BREAKOUT SPACE

6,544 SQ FT / 1,231 SQ M

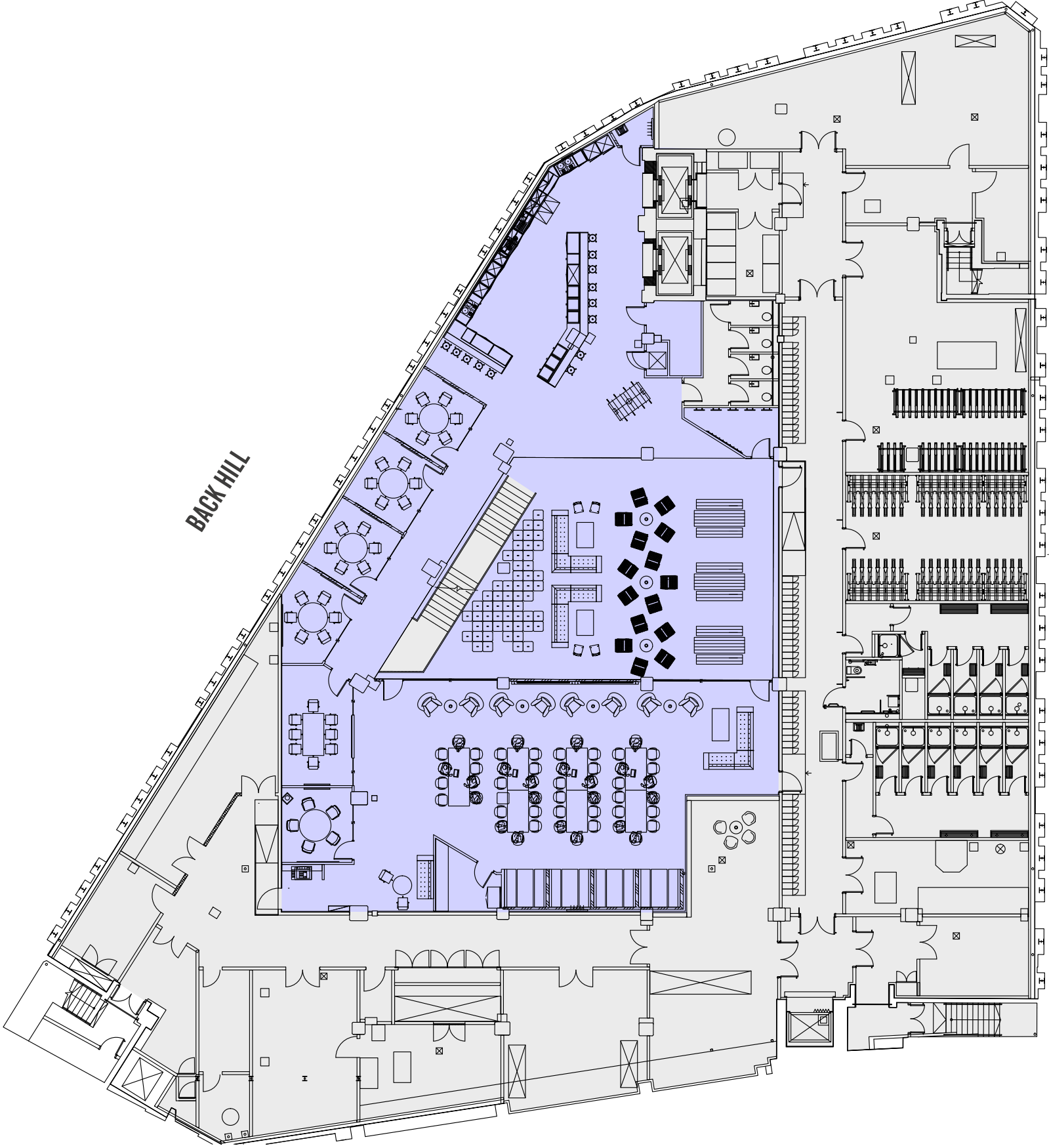

 Floor plans not to scale.
For indicative purposes only.

Shared Basement Breakout Space Core





FURTHER INFORMATION

Terms

Upon application.

Viewings

Strictly through the sole letting agents:

NH NOBLE
HARRIS

Matthew Noble

M 07980 991 214

E mnoable@nobleharris.co.uk

Carl Dobrin

M 07545 077 959

E cdobrin@nobleharris.co.uk

Noble Harris LLP copyright 2024. No warranty or representation, express or implied, is made to the accuracy or completeness of the information contained herein, and same is submitted subject to errors, omissions, change of price, rental or other conditions, withdrawal without notice, and to any special listing conditions imposed by the property owner(s). As applicable, we make no representation as to the condition of the property (or properties) in question. December 2024.

Designed and produced by Cre8te – 020 3468 5760 – cre8te.london