

**PREPARED FOR:**

MNM Business Center, LLC  
 570 El Camino Real Suite 150-449  
 Redwood City, CA 94063  
 Tel (650) 222-8626  
 Fax (650) 362-4131

<http://www.mnmpropertymanagement.com>

**MNM BUSINESS CENTER**  
**25 N. 14th STREET**  
**SAN JOSE, CA**

**LOWER LEVEL**  
 (As Measured: August 2018)  
 (Last Updated: September 2018)

**LEASE PLAN**

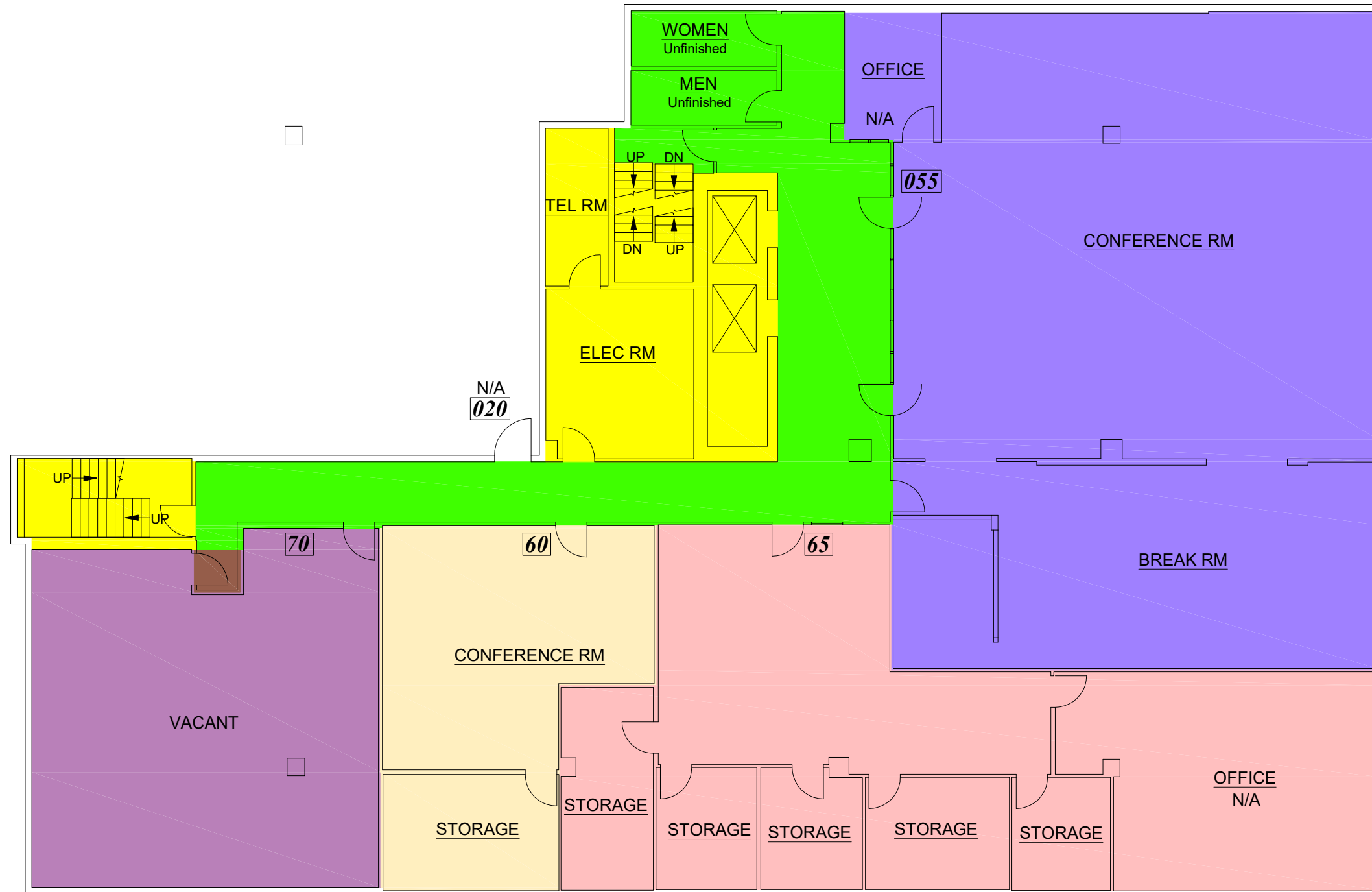
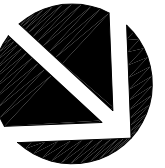

FLOOR SUMMARY	SQ.FT.
Total Rentable	8,771
Total Occupant Storage	0
Total Usable	6,747
Total Tenant	6,729
Total Ancillary	18
Total Occupant	6,747
Floor Service	1,056
Building Service	794
Inter-Building Service	0
Building Amenity	0
Inter-Building Amenity	0
Total Vertical Penetration	0
Total Unenclosed Covered Gallery	0
Total Parking	0

All areas subject to revision upon completion of building.

Suite #	Occup. Area	Rentable	Capped R.	Capped LF	% of Tot. R.
55	2,965.9	3,855.5	3,855.5	1.2999	4.9
60	738.7	960.3	960.3	1.2999	1.2
65	1,939.2	2,520.8	2,520.8	1.2999	3.2
70	1,103.2	1,434.1	1,434.1	1.2999	1.8

Survey Accuracy: +/- 0.10 %

AREAS COMPUTED IN ACCORDANCE WITH ANSI/BOMA (Z65.1) 2017 OFFICE STANDARD, METHOD A (Multiple Load Factors Method).

LASERTECH® is a registered US trademark of Lasertech® Floorplans Ltd. Copyright 1998 Lasertech® Floorplans Ltd., All Rights Reserved

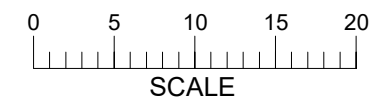

TEL: (888) 393-6655  
 FILE: 18-385