



HIGH QUALITY FURNISHED OFFICE SPACE FOR LEASE

11,681 - 32,753 RSF

CONCAR DRIVE

S A N M A T E O



Premium Class A office space

Flexible term
from 2-5 years
from 11,681 SF



Highlights

Furniture available with wiring in place



Large open blocks
for dense seating ratios



Leed certified building



Outdoor seating and meeting areas



Structure and surface parking



Unbeatable access to highways
101, 92, and 280



Move-in ready adaptable configurations



24/7 on-site security

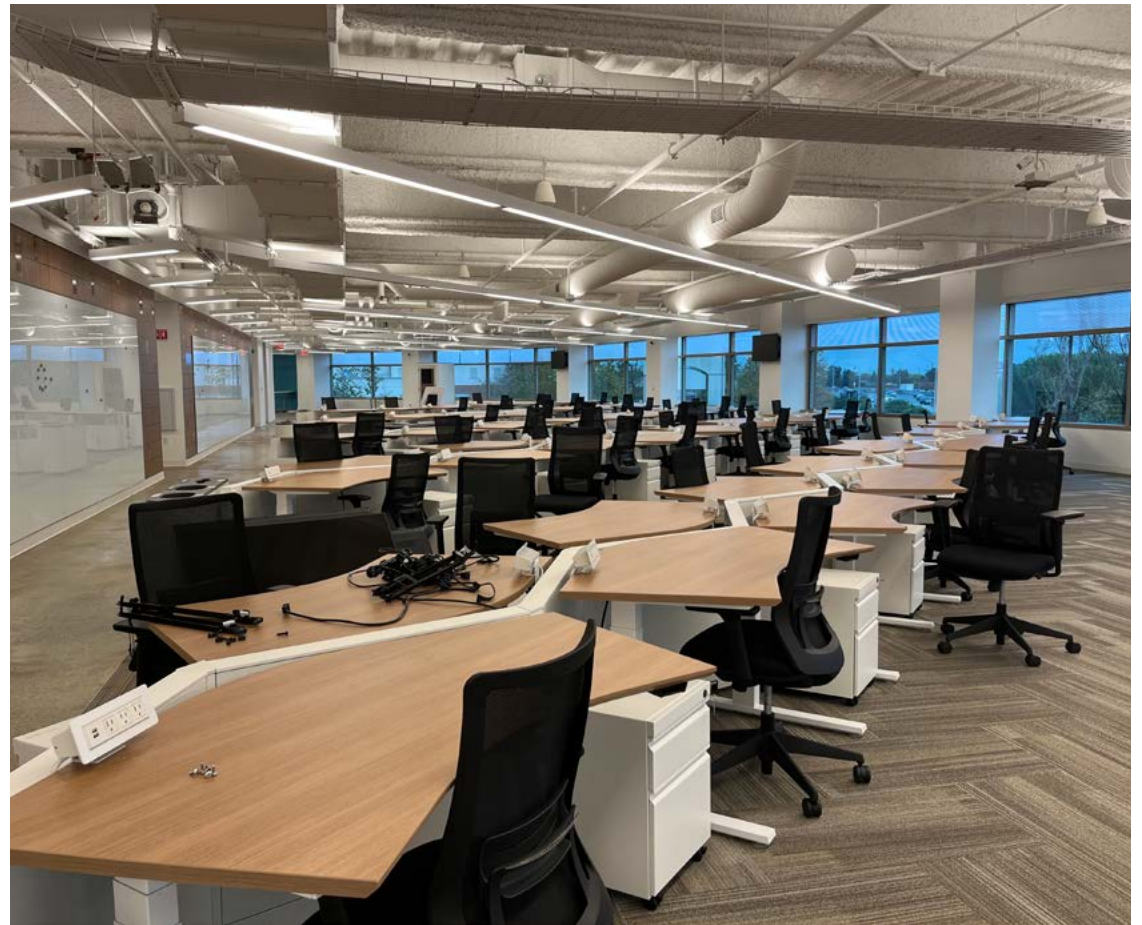

±21,072 RSF

Full Floor

115 Prewired Workstations

9 Meeting Rooms

2 Phone Booths & Soft Seating

Floor two

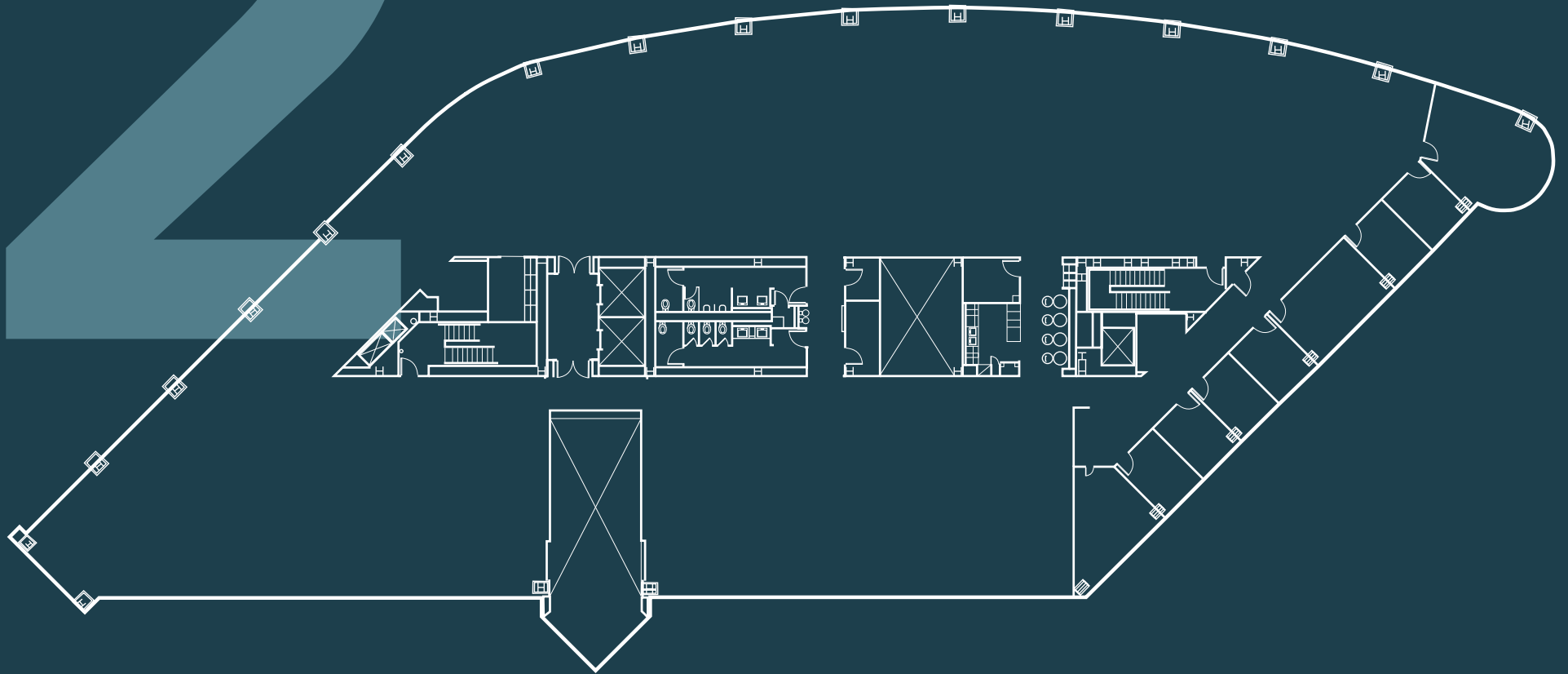

±11,681 RSF

Suite C

7 Offices + 2 Large Conferences

Floor three

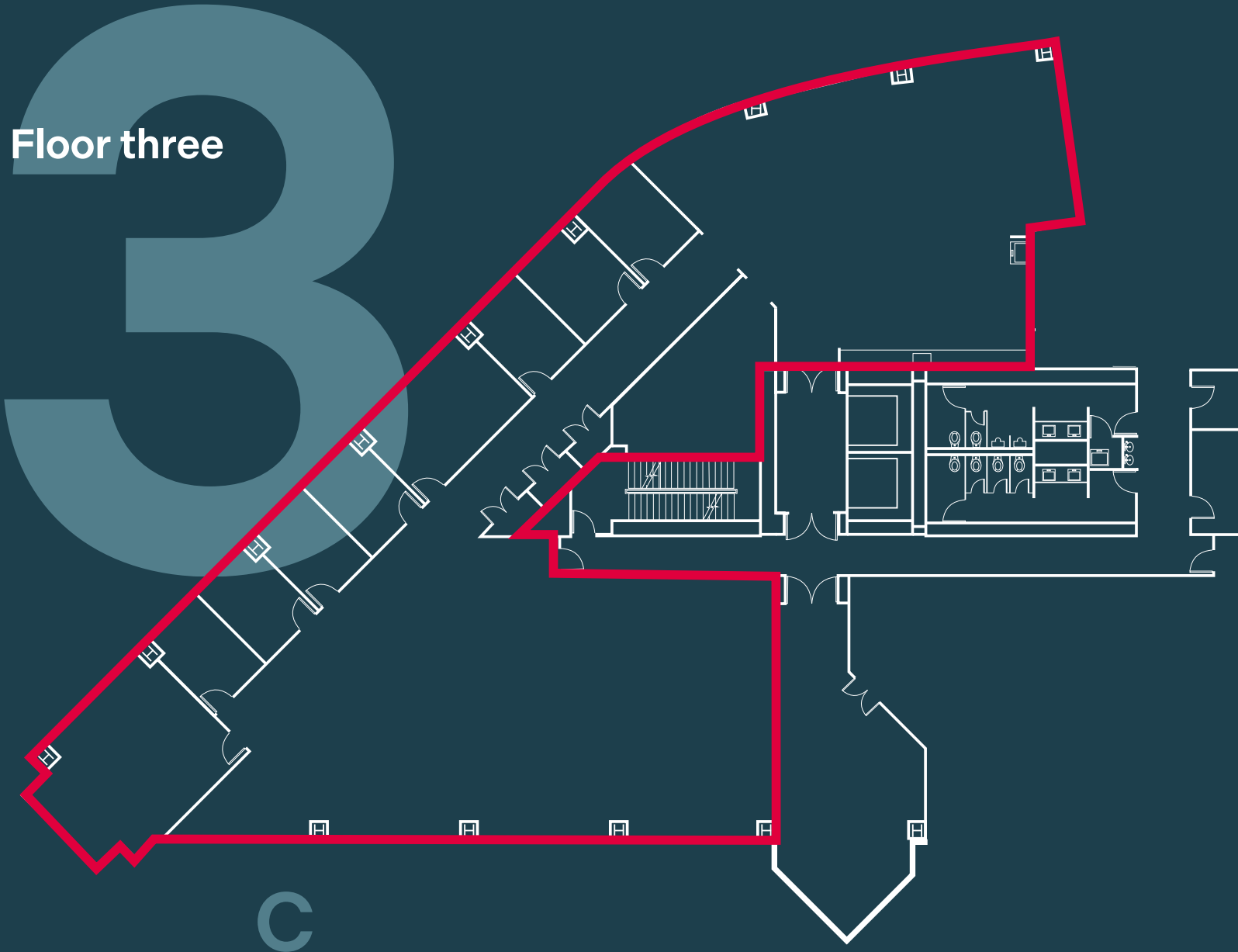

C

Building amenities

All-hands room
(110 seat conference center)



Full-service luncheon cafeteria



**Quality on-site fitness center
and locker rooms with showers**



20 EV charging stations



Manned security check-in



On site car care services
(oil change and washing)



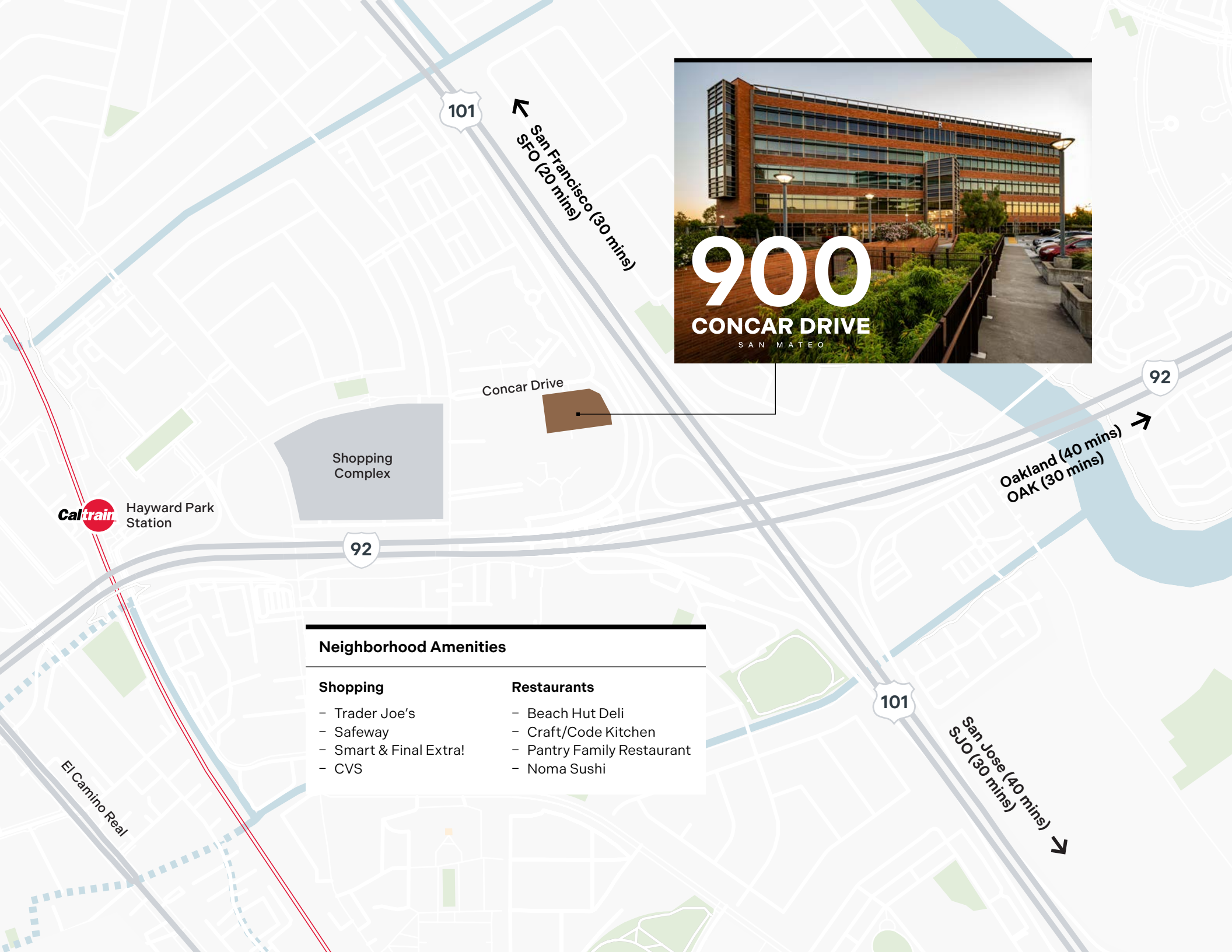

Neighborhood Amenities

Shopping	Restaurants
- Trader Joe's	- Beach Hut Deli
- Safeway	- Craft/Code Kitchen
- Smart & Final Extra!	- Pantry Family Restaurant
- CVS	- Noma Sushi



Tony Guglielmi

tony.guglielmi@jll.com

+1 650 480 2191

RE License #01785436

Tim Grant

tim.grant@jll.com

+1 650 480 2124

RE License #00674597

Jones Lang LaSalle Brokerage, Inc. Real Estate License # 01856260

Although information has been obtained from sources deemed reliable, JLL does not make any guarantees, warranties or representations, express or implied, as to the completeness or accuracy as to the information contained herein. Any projections, opinions, assumptions or estimates used are for example only. There may be differences between projected and actual results, and those differences may be material. JLL does not accept any liability for any loss or damage suffered by any party resulting from reliance on this information. If the recipient of this information has signed a confidentiality agreement with JLL regarding this matter, this information is subject to the terms of that agreement. ©2026 Jones Lang LaSalle IP, Inc. All rights reserved.

