

# Publix #1236 - 127th Shopping Center

12850 Biscayne Boulevard  
North Miami, FL 33181  
Lat 25.894, Long -80.162

**GROUND LEASE**



**960 SF & ±1.28 ACRE OP AVAILABLE**

## PROPERTY HIGHLIGHTS

- Miami-Dade County Market
- Rapidly Growing Keystone Islands Neighborhood, with Many High-End Condos and New Developments
- Located on Central US1 Corridor with Excellent Visibility
- High-End Market with High Population Density
- Just off the Bridge to Luxurious Bal Harbour
- Brand New, 49,000 SF Publix Opened December 2017

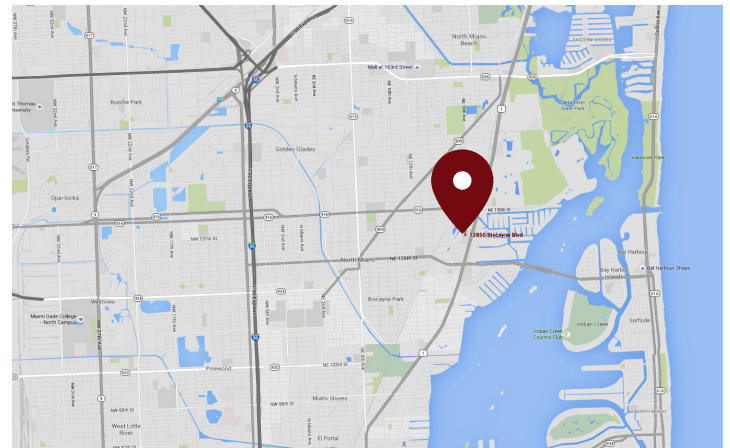

| DEMOGRAPHICS       | 1 Mile   | 3 Miles  | 5 Miles  |
|--------------------|----------|----------|----------|
| Total Population   | 28,593   | 157,347  | 416,376  |
| Daytime Population | 32,273   | 146,495  | 392,452  |
| Total Households   | 11,753   | 57,732   | 161,915  |
| Avg. HH Income     | \$83,099 | \$98,583 | \$94,888 |

Data provided by Placer Labs Inc. ([www.placer.ai](http://www.placer.ai)) & Esri

## Adriana Collazo

786.676.1650 | [acollazo@crossmanco.com](mailto:acollazo@crossmanco.com)

980 North Federal Highway, Suite 434, Boca Raton, FL

Licensed Real Estate Broker. No warranty expressed or implied has been made to the accuracy of the information provided herein, no liability assumed for error or omission.



[www.crossmanco.com](http://www.crossmanco.com)

# Publix #1236 - 127th Shopping Center

12850 Biscayne Boulevard  
 North Miami, FL 33181  
 Lat 25.894, Long -80.162

## SITE PLAN

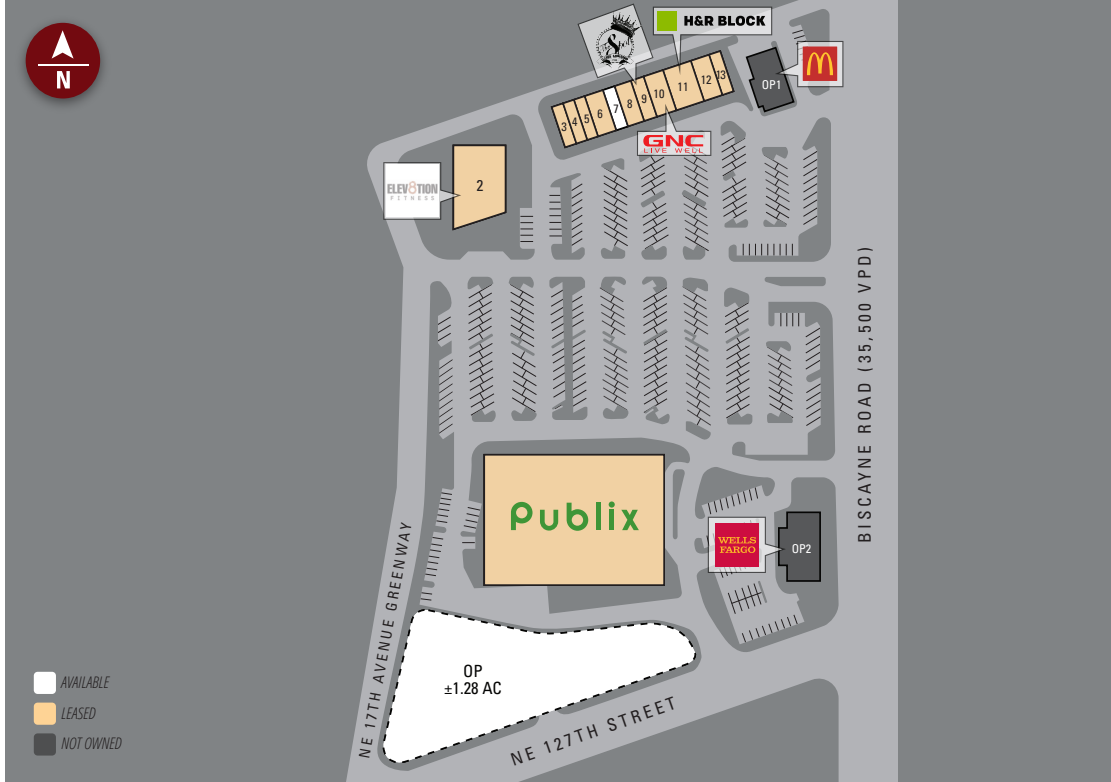

| Suite | Tenant                      | Size     |
|-------|-----------------------------|----------|
| ANC   | Publix                      | 49,098   |
| 2     | Elev8tion Fitness           | 8,032    |
| 3     | Nail Spa of America         | 960      |
| 4     | Miami Postal Pack & Ship    | 960      |
| 5     | Ivanov Orthodontic Services | 965      |
| 6     | Siegel TLC Animal Clinic    | 1,920    |
| 7     | **Coming Available**        | 960      |
| 8     | Manley's Jewelry            | 1,075    |
| 9     | The Spot Classic Barbershop | 1,245    |
| 10    | GNC                         | 1,530    |
| 11    | H&R Block                   | 2,873    |
| 12    | Clinicare Medical Center    | 1,920    |
| 13    | Poke & More                 | 960      |
| OP    | AVAILABLE                   | ±1.28 AC |
| OP1   | McDonald's (Not Owned)      |          |
| OP2   | Wells Fargo (Not Owned)     |          |

**TOTAL 72,498**



**Adriana Collazo**

786.676.1650 | [acollazo@crossmanco.com](mailto:acollazo@crossmanco.com)

980 North Federal Highway, Suite 434, Boca Raton, FL

*Licensed Real Estate Broker. No warranty expressed or implied has been made to the accuracy of the information provided herein, no liability assumed for error or omission.*



Crossman & Company

[www.crossmanco.com](http://www.crossmanco.com)

# Publix #1236 - 127th Shopping Center

12850 Biscayne Boulevard  
North Miami, FL 33181  
Lat 25.894, Long -80.162

## FOOT TRAFFIC OVERVIEW

EST. # OF CUSTOMERS ANNUALLY

 **273,900**

EST. # OF VISITS ANNUALLY

 **2.4 Million**

AVG. VISITS / CUSTOMER

 **8.71**

AVG. LENGTH-OF-STAY / VISIT

 **26 MIN**

TOP 3 DAYS



|           |         |
|-----------|---------|
| Friday    | 356,772 |
| Saturday  | 352,816 |
| Wednesday | 352,770 |

# OF VISITS

TOP 3 HOURS



|        |         |
|--------|---------|
| 2-3 PM | 331,241 |
| 3-4 PM | 314,839 |
| 4-5 PM | 294,714 |

# OF VISITS

Data provided by Placer Labs Inc. (www.placer.ai) July 1, 2023 - June 30, 2024

## SITE VISIT DENSITY

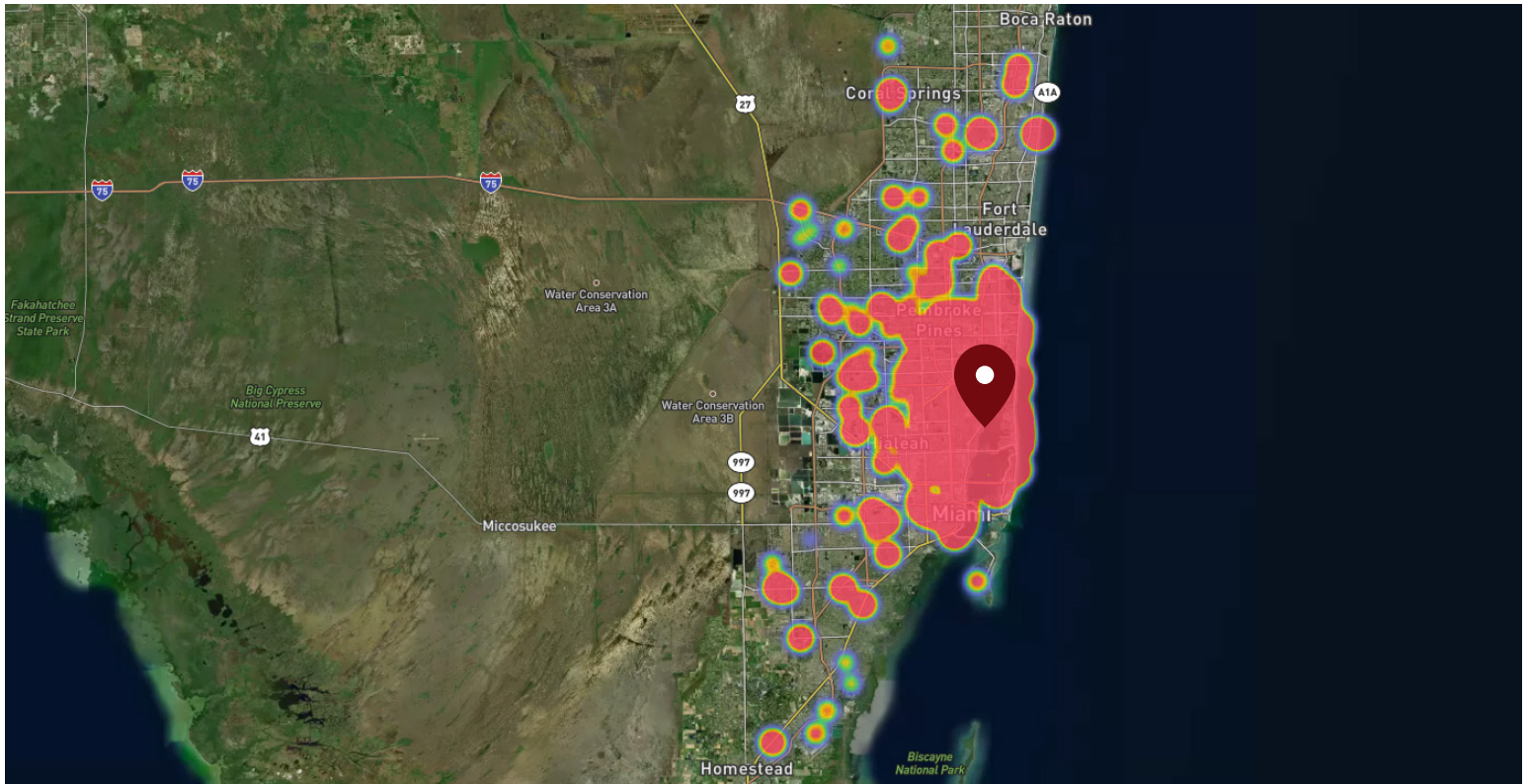

Red, orange, and yellow colors represent the location of 60% of site visitors

Data provided by Placer Labs Inc. (www.placer.ai)

**Adriana Collazo**

786.676.1650 | [acollazo@crossmanco.com](mailto:acollazo@crossmanco.com)

980 North Federal Highway, Suite 434, Boca Raton, FL

Licensed Real Estate Broker. No warranty expressed or implied has been made to the accuracy of the information provided herein, no liability assumed for error or omission.



[www.crossmanco.com](http://www.crossmanco.com)