

E. Vish...

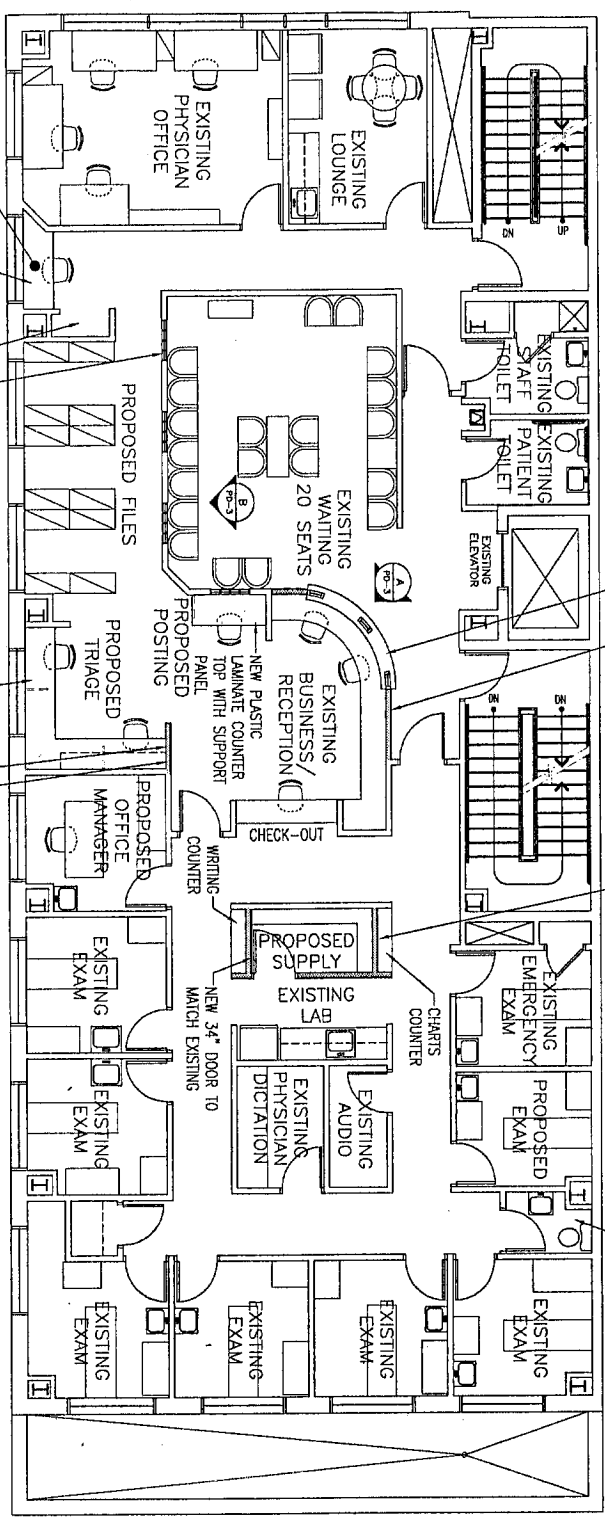

PROPOSED FLOOR PLAN - STUDY 'A1'
SCALE: 1/8" = 1' - 0"

- GENERAL NOTES:
1. NEW CARPETING SIMILAR TO DURKAN SS BLD EAST. SUNSET STRIP THROUGHOUT SPACE EXCEPT EXAM ROOMS AND TOILET ROOMS
 2. EXAM ROOMS TO RECEIVE WOOD LAMINATE FLOORING SIMILAR TO BERRY FLOOR LOFT PROJECT
 3. NEW WMC IN WAITING ROOM
 4. PAINT ALL NEW AND EXISTING WALLS NOT TO RECEIVE WMC
 5. NEW WMC BORDER IN ALL EXAMS
 6. REMOVE EXISTING WALL SCOURCES IN WAITING
 7. NEW LIGHTING IN WAITING
 8. NEW VINYL BASE IN ALL AREAS TO RECEIVE NEW FLOORING

PROPOSED FLOOR PLAN - STUDY 'A1'		SHEET NO.
PAUL SLOWIK & ASSOCIATES ARCHITECTS 8980 PERRY HIGHWAY PITTSBURGH, PENNSYLVANIA 15237		
JOB NO.	2023-07	DATE
		FEBRUARY 12, 2007
	CCP - MT. LEBANON	PD-1