

**GOBLE
PROPERTIES**

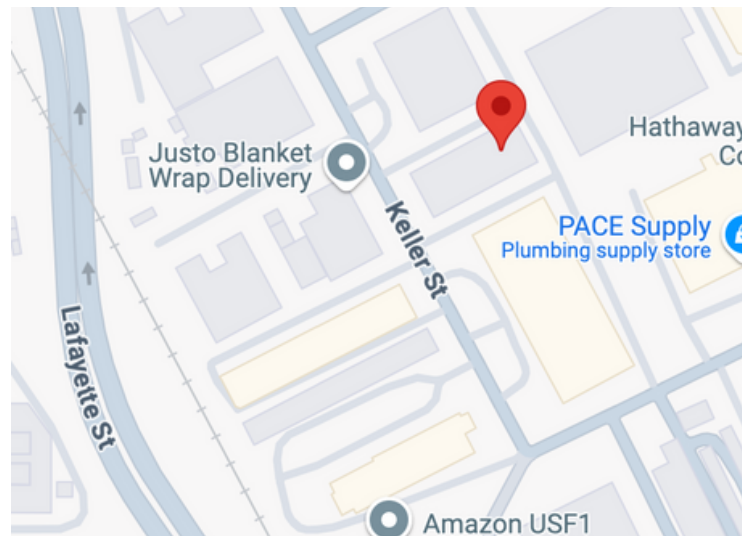

3281 KELLER STREET SANTA CLARA, CA

R&D/FLEX For Lease
6,417 SF



GOBLEPROPERTIES.COM

Contact Us

408-452-1754

contact@gobleproperties.com

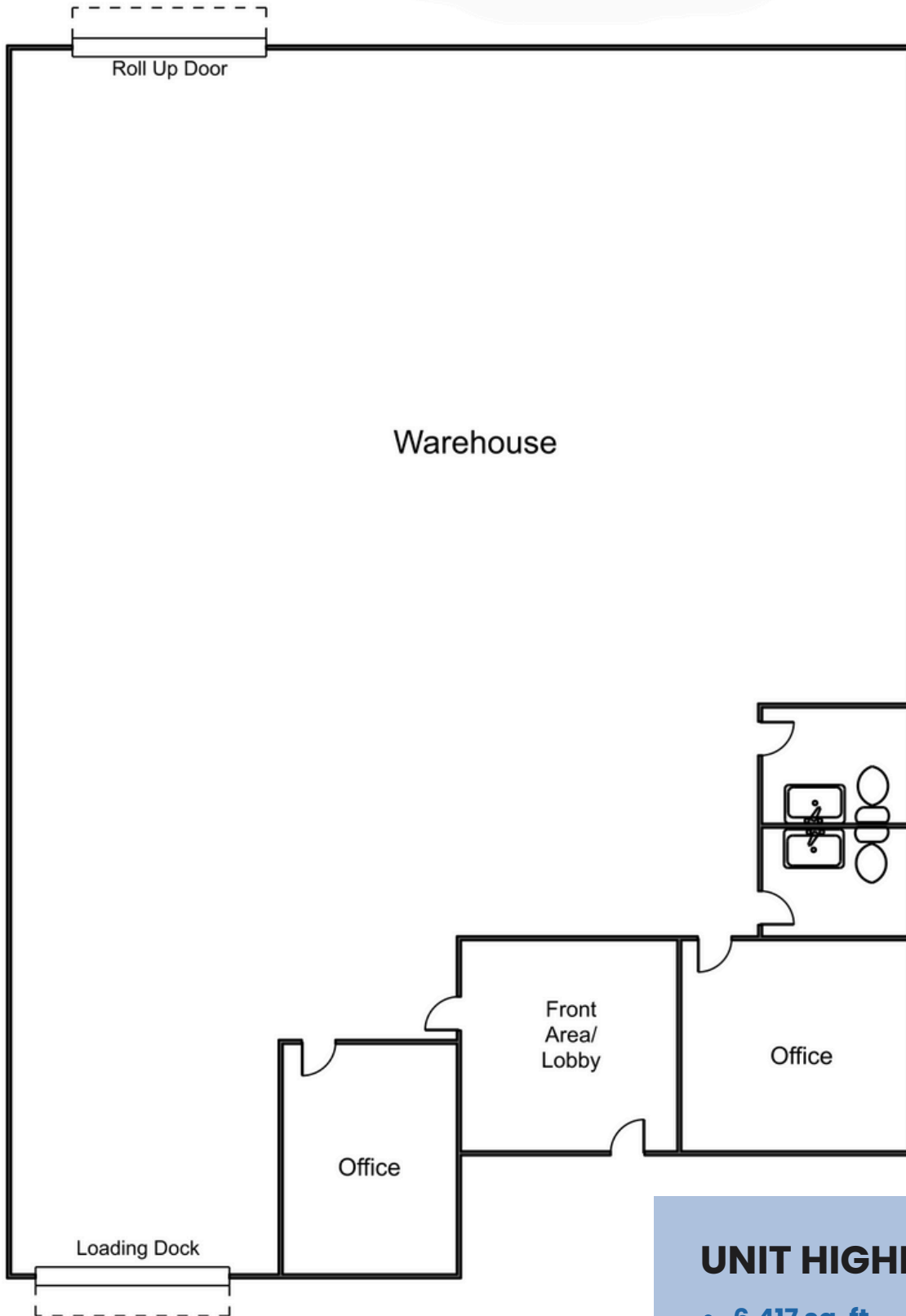

***Floor plans are not to scale and are for layout purposes only.**

UNIT HIGHLIGHTS

- 6,417 sq. ft.
- 1 Grade Level Roll Up Door
- 1 Loading Dock
- Front Area/Lobby + 2 Offices
- HVAC In Offices
- 2 Restrooms
- 200 Amps



Contact Us

408-452-1754

contact@gobleproperties.com

 **GOBLE**
PROPERTIES