

TO LET

RETAIL UNIT(S)

Ryden

- PROMINENT LOCATION ON BUSY ARTERIAL ROUTE
- POTENTIAL TO SUB-DIVIDE
- SITUATED BELOW 171-BED TRAVELODGE
- WITHIN A SHORT DISTANCE OF GEORGE SQUARE, BUCHANAN STREET AND QUEEN STREET STATION



**UNITS 4&5,
72-74 QUEEN STREET
GLASGOW
G1 3DN**

2,061
SQUARE FEET

192
SQUARE METRES

GET IN TOUCH

CONTACT John Conroy

TELEPHONE 07979 494915

EMAIL john.conroy@ryden.co.uk

Viewing is strictly by arrangement with the joint letting agents.

GLASGOW
130 St Vincent Street
G2 5HF
0141 204 3838



ryden.co.uk

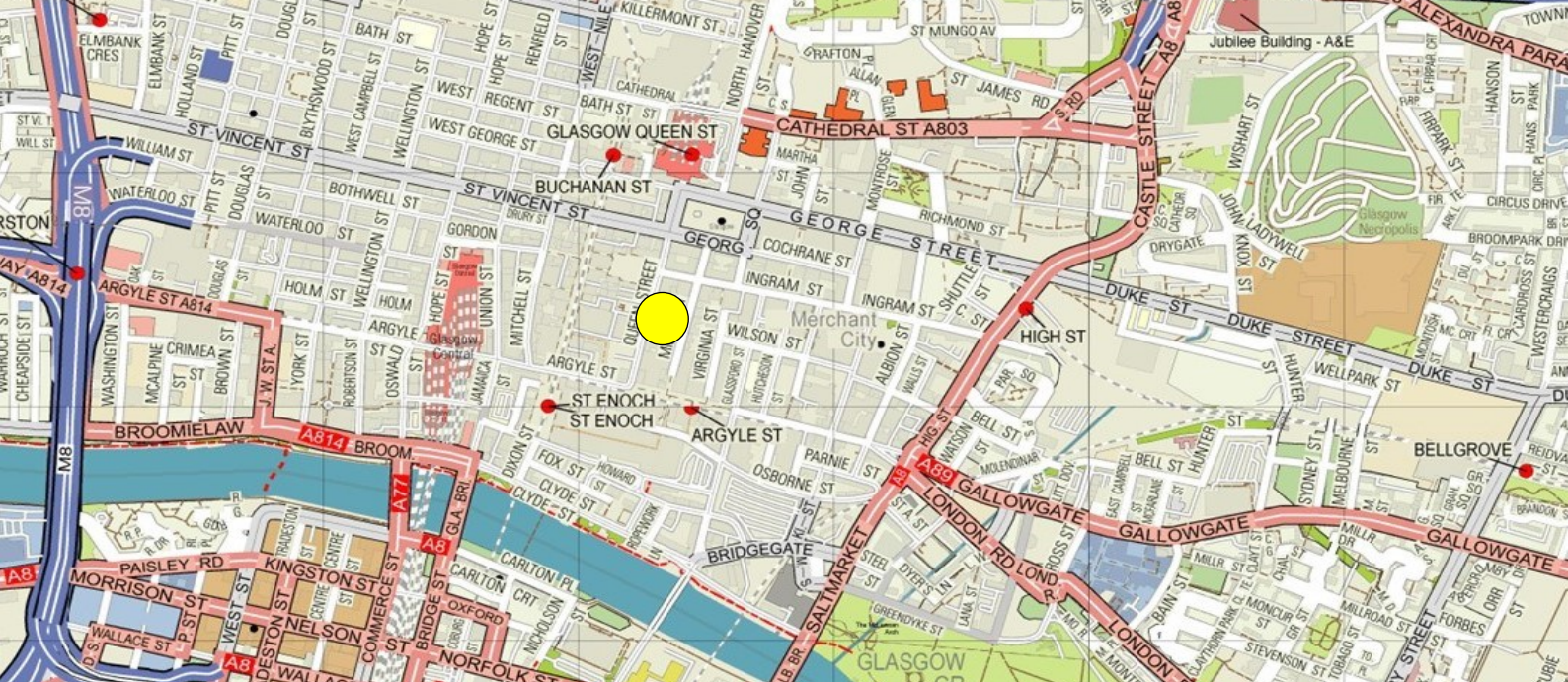

LOCATION

Glasgow is Scotland's largest city and benefits from a residential population in the order of 630,000 with a further catchment in excess of 2 million. The city is widely recognised as the UK's second retail centre after London.

The subjects are located on Queen Street, a busy arterial route within the heart of the city centre, situated below a 171-room Travelodge Hotel.

The subjects are within a few minutes walk from George Square, Buchanan Street and the newly refurbished Queen Street Station (5th busiest station in the UK with approximately 23 million passengers).

The Gallery of Modern Art is located diagonally opposite the subjects and other nearby occupiers include Tesco Express, Caffe Nero, Clydesdale Bank and Reiss.

DESCRIPTION

The subjects comprise a ground floor retail unit with storage and WC to the rear. The accommodation may be divided for multiple occupation.

ACCOMODATION

The subjects have the following approximate area:-

GROUND FLOOR	192 sq m	2,061 sq ft
---------------------	-----------------	--------------------

There is potential to sub-divide the units to provide the following areas:

UNIT 4	96 sq m	1,030 sq ft
---------------	----------------	--------------------

UNIT 5	96 sq m	1,030 sq ft
---------------	----------------	--------------------

LEASE TERMS

The subjects are available on a new Full Repairing and Insuring basis incorporating 5 yearly rent reviews, for a term to be agreed.

RENT

Upon application.

ENERGY PERFORMANCE CERTIFICATE (EPC)

The property has an EPC rating of D. A copy of the certificate is available upon request.

RATEABLE VALUE

The subjects are currently entered in the Assessor's Valuation Roll as having an RV of £49,500.

Rates payable will be in the order of £24,651.

PLANNING

The subjects benefit from a Class 1 (retail) consent, however other uses will be considered, subject to planning.

ANTI MONEY LAUNDERING REGULATIONS

To comply with Anti Money Laundering Regulations we are legally required to undertake due diligence on prospective tenants which will at a minimum include proof of identity/address and funding. Applicable documentation will therefore be required on agreement of heads of terms.

LEGAL COSTS

In the normal manner, each party will be responsible for their own costs incurred with the tenant being responsible for Land and Buildings Transactional Tax and registration dues.

VAT

Unless otherwise stated, all prices, premiums and rents are quoted exclusive of Value Added Tax (VAT). Any intending purchaser or lessee must satisfy themselves independently as to the incidence of VAT in respect of any transaction.



Experian Goad Plan Created: 23/02/2022
Created By: Ryden LLP



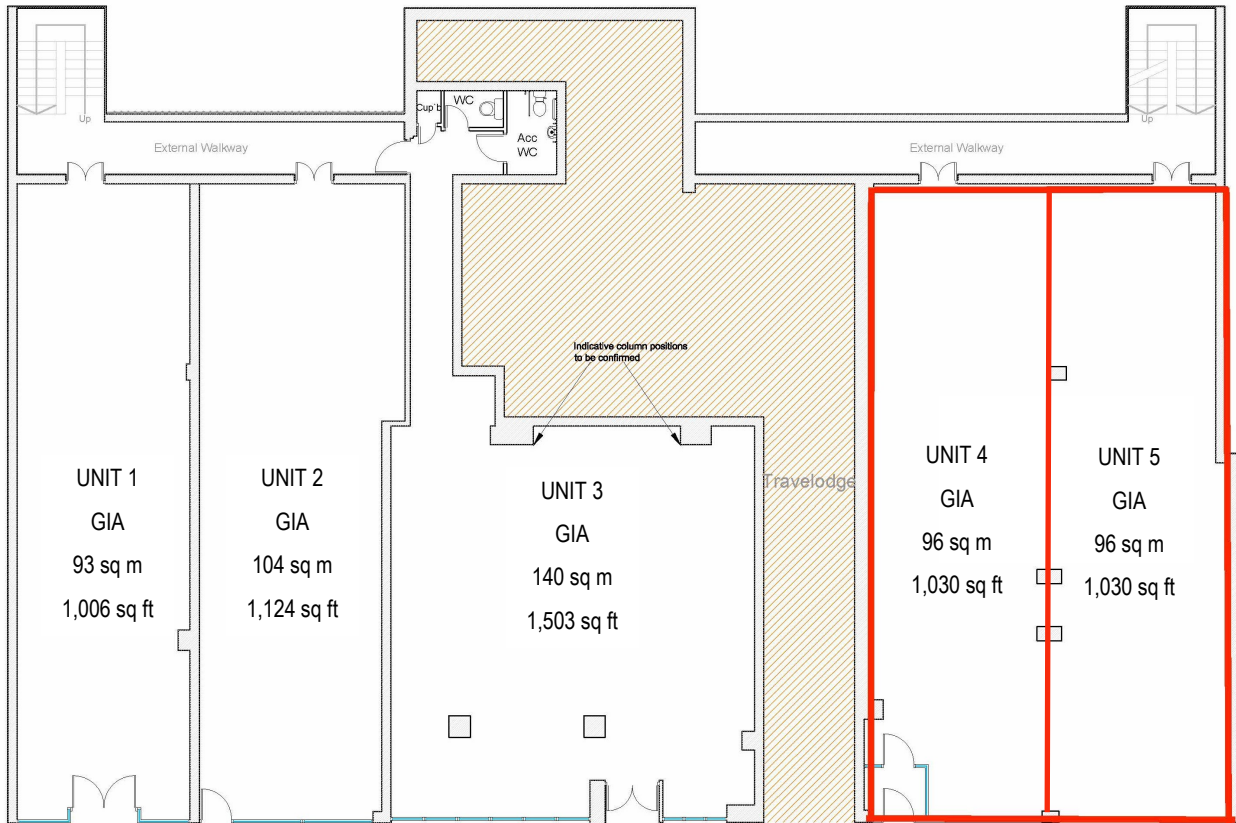

GET IN TOUCH

CONTACT John Conroy

TELEPHONE 0141 270 3176 / 07979 494915

EMAIL john.conroy@ryden.co.uk

GLASGOW

**130 St Vincent Street
G2 5HF
0141 204 3838**



ryden.co.uk

CONTACT Ewan Mackay

TELEPHONE 0141 226 1662

EMAIL ewan@ewanmackay.com

GLASGOW

**234 West George Street
G2 4WF
0141 226 1662**



Ryden is a limited liability partnership registered in Scotland. Messrs Ryden for themselves and for vendors or lessors of this property whose agents they are given notice that: (i) the particulars are set out as a general outline only for the guidance of intended purchasers or lessees, and do not constitute, nor constitute part of, an offer or contract; (ii) all descriptions, dimensions, reference to condition and necessary permissions for use and occupation, and other details are given without responsibility and any intending purchasers or tenants should not rely on them as statements or representations of fact but must satisfy themselves by inspection or otherwise as to the correctness of each of them; (iii) no person in the employment of Messrs Ryden has any authority to make or give any representation or warranty whatever in relation to this property.