

49, 55, & 67 W. WILLIS STREET
DETROIT, MICHIGAN



**SIGNATURE
ASSOCIATES**
KNOW SIGNATURE | KNOW RESULTS

OFFICE FOR SALE
5,641 Square Feet Available



PROPERTY FEATURES

- 5,641 square feet available
- 3-story historic building with basement and (1) apartment unit
- SD2 Zoning provides flexibility for a range of potential uses including office, residential, mixed-use or adaptive re-use, subject to site plan approval
- Located on 0.39 acres
- Sale Price: \$1,495,000

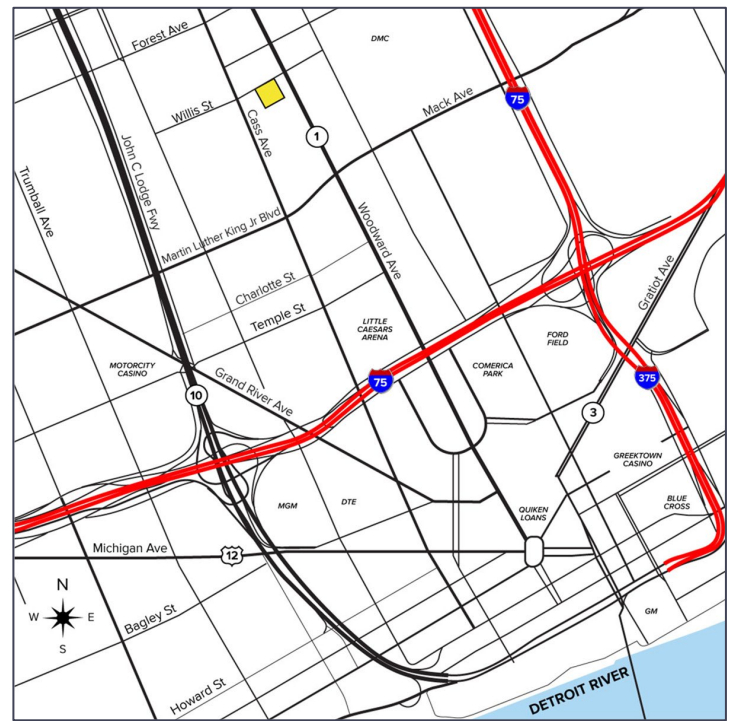

For more information, please contact:

CHRIS MONSOUR
(248) 948 0107
cmonsour@signatureassociates.com

JOE STACK
(248) 359 0615
jstack@signatureassociates.com

SIGNATURE ASSOCIATES
One Towne Square, Suite 1200
Southfield, MI 48076
www.signatureassociates.com

49, 55 & 67 W. Willis Street – Detroit, Michigan

Office For Sale

5,641
Square Feet
AVAILABLE

Site Plan

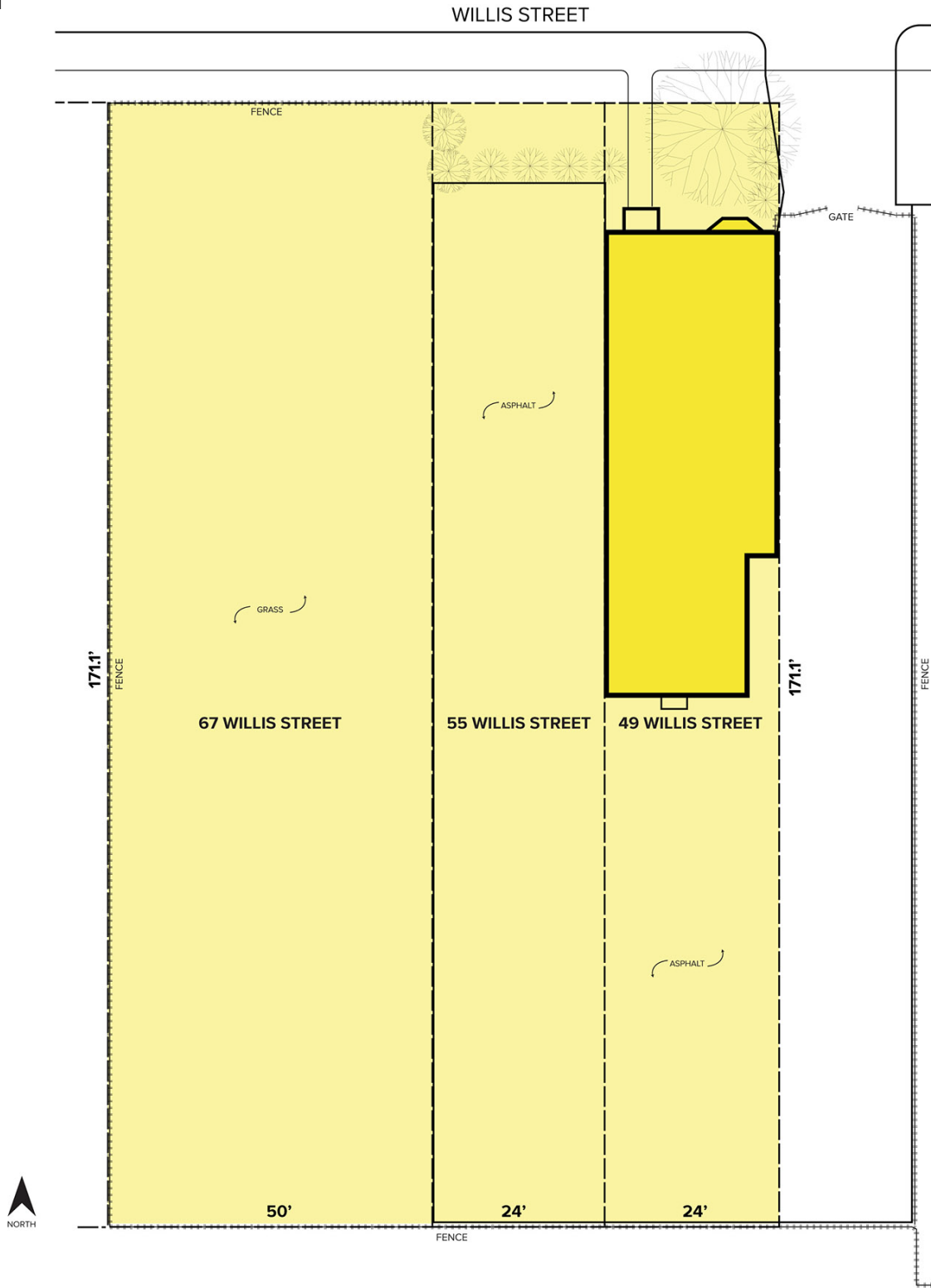

For more information, please contact:

CHRIS MONSOUR
(248) 948 0107
cmonsour@signatureassociates.com

JOE STACK
(248) 359 0615
jstack@signatureassociates.com

SIGNATURE ASSOCIATES
One Towne Square, Suite 1200
Southfield, MI 48076
www.signatureassociates.com

49, 55 & 67 W. Willis Street – Detroit, Michigan

Office For Sale

5,641
Square Feet
AVAILABLE

Aerial



For more information, please contact:

CHRIS MONSOUR
(248) 948 0107
cmonsour@signatureassociates.com

JOE STACK
(248) 359 0615
jstack@signatureassociates.com

SIGNATURE ASSOCIATES
One Towne Square, Suite 1200
Southfield, MI 48076
www.signatureassociates.com