

AUTOMOTIVE SPACE FOR LEASE



±2,250
AVAILABLE SF

TWO (2)
OVERSIZED GRADE
LEVEL DOORS PER UNIT

\$1.64
LEASE RATE (PRICE/SF)
+ \$0.13/SF CAM FEE

±2,250 SF automotive space available

Office, lobby, restroom and warehouse

Two (2) oversized grade level doors per unit

Excellent location

Monument signage available

Call to show

*For More
Info Contact*

JOHN WITHERALL
760.815.9004
john.witherall@kidder.com
LIC N° 01759453

KIDDER.COM

This information supplied herein is from sources we deem reliable. It is provided without any representation, warranty, or guarantee, expressed or implied as to its accuracy. Prospective Buyer or Tenant should conduct an independent investigation and verification of all matters deemed to be material, including, but not limited to, statements of income and expenses. Consult your attorney, accountant, or other professional advisor.

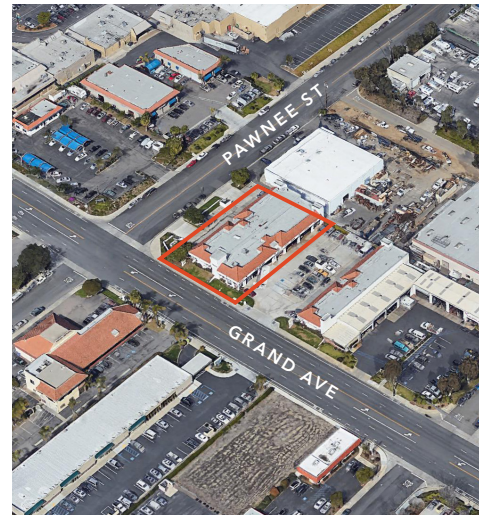
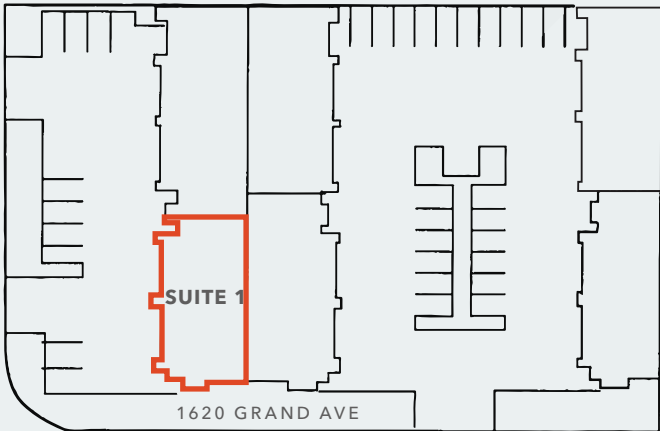
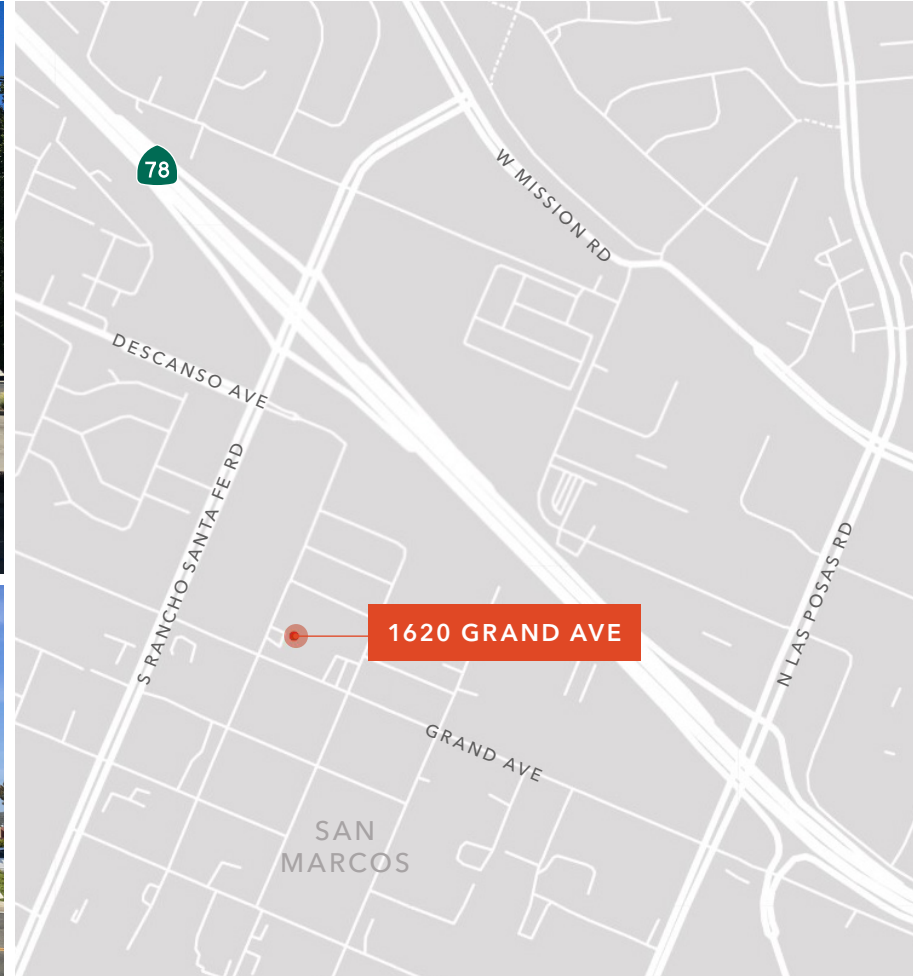

JOHN WITHERALL 760.815.9004 | john.witherall@kidder.com | LIC N° 01759453

KIDDER.COM

This information supplied herein is from sources we deem reliable. It is provided without any representation, warranty, or guarantee, expressed or implied as to its accuracy. Prospective Buyer or Tenant should conduct an independent investigation and verification of all matters deemed to be material, including, but not limited to, statements of income and expenses. Consult your attorney, accountant, or other professional advisor.



FLOOR PLAN | SUITE 1

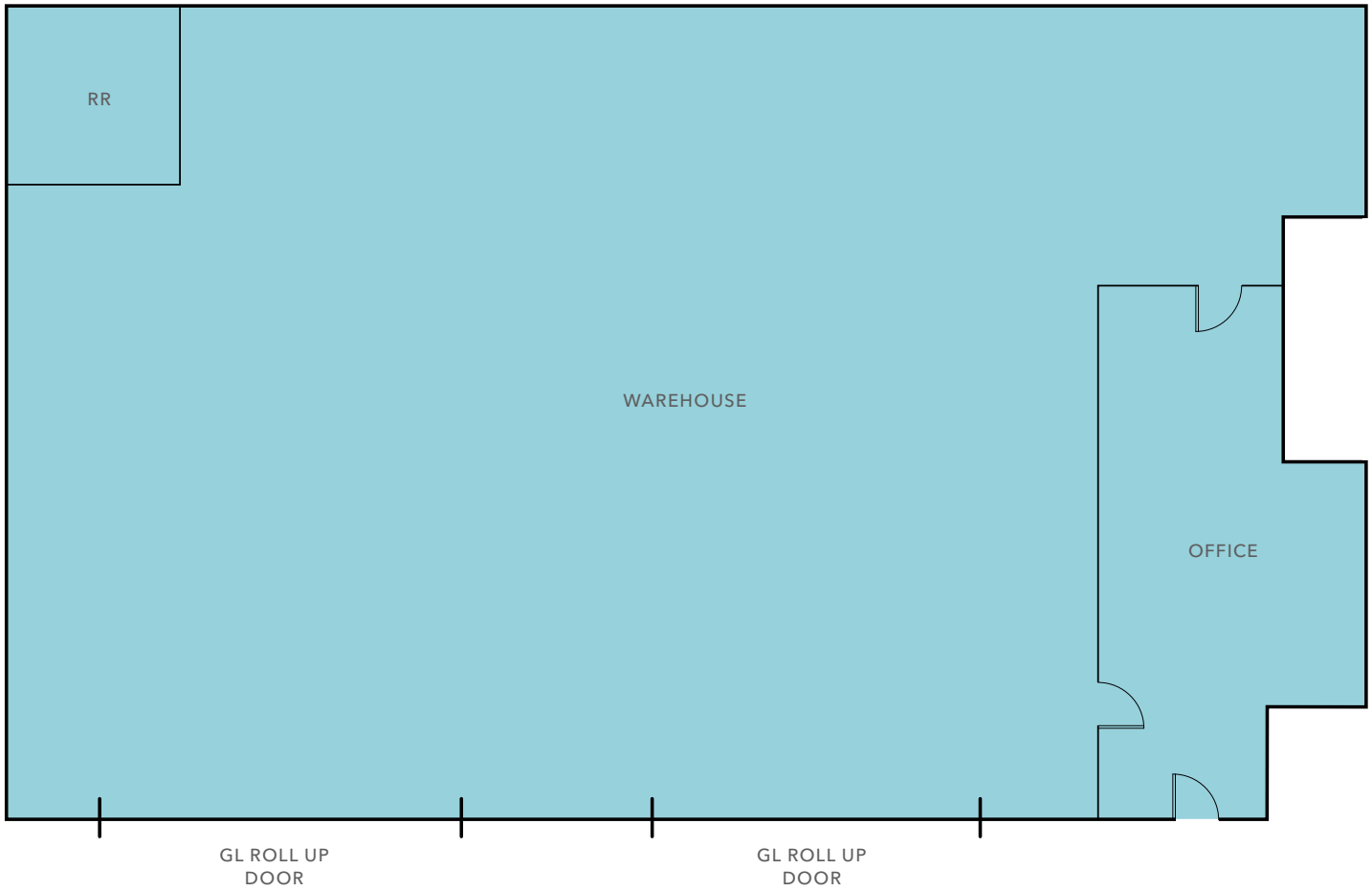

±2,250 SF

AVAILABLE

\$1.64

LEASE RATE (PRICE/SF)
+ \$0.13/SF CAM FEE

NOW

AVAILABLE

SUITE 1 ±2,250 SF

Two (2) grade level doors

Office, lobby, restroom and
warehouse

Call to show

JOHN WITHERALL 760.815.9004 | john.witherall@kidder.com | LIC N° 01759453

KIDDER.COM

This information supplied herein is from sources we deem reliable. It is provided without any representation, warranty, or guarantee, expressed or implied as to its accuracy. Prospective Buyer or Tenant should conduct an independent investigation and verification of all matters deemed to be material, including, but not limited to, statements of income and expenses. Consult your attorney, accountant, or other professional advisor.

