

CHURCH/SCHOOL SPACE FOR LEASE

1800 N BROADWAY, ESCONDIDO, CA



The Offering

Church Offering:

- Sanctuary, Fellowship Hall, and Kitchen
- Sunday afternoon and evening timeslots available

School Offering:

- 3 classrooms, office space, and outdoor play area
- Suitable for private, public/charter, or preschool programs

See next page for more details. Please do not disturb Church.

RILEY ROHDE 858.369.3041 | riley.rohde@kidder.com | LIC N° 02207141

ROBERT FLETCHER 858.369.3034 | robert.fletcher@kidder.com | LIC N° 01706060

ERIC KNOWLES 858.369.3017 | eric.knowles@kidder.com | LIC N° 00944210

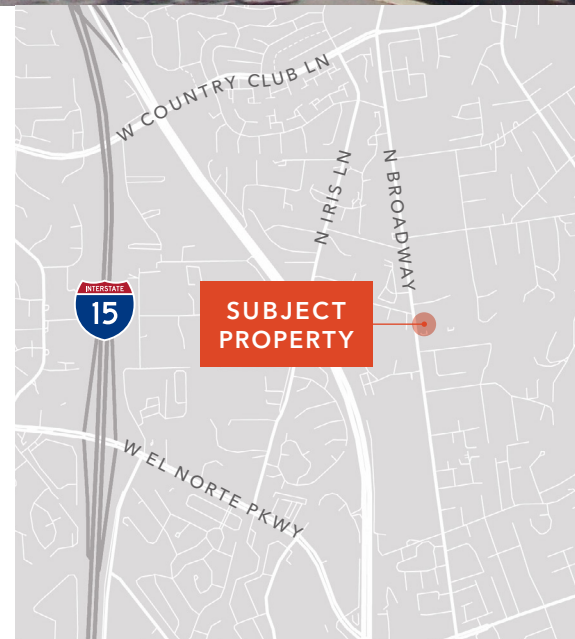

KIDDER.COM

This information supplied herein is from sources we deem reliable. It is provided without any representation, warranty, or guarantee, expressed or implied as to its accuracy. Prospective Buyer or Tenant should conduct an independent investigation and verification of all matters deemed to be material, including, but not limited to, statements of income and expenses. Consult your attorney, accountant, or other professional advisor.

km Kidder
Mathews

CHURCH / SCHOOL SPACE FOR LEASE

PROPERTY HIGHLIGHTS

PREMISES:	<p>School Space: ±2,532 SF, 3 classrooms, office, and outdoor play area (Fellowship Hall and Kitchen use are also available) Available: Monday - Friday during traditional school days and hours</p> <p>Church Space: ±6,979 SF, Sanctuary seats ±250, Fellowship Hall (seats 200), and Kitchen Available: Sundays from 12:00 PM - 8:00 PM in all spaces; all day Saturdays, and various weeknights</p>
UTILITIES:	Tenant to pay its share of sewer, water, gas, electric, and trash
PARKING:	On-site parking
RESTROOMS:	Four kiddie toilets in the education building and two restrooms (3 stalls each) in the Fellowship Hall building
SHARED VS. EXCLUSIVE:	Landlord requires shared use of some classrooms, Fellowship Hall, and Kitchen
NON-PROFIT VS. FOR-PROFIT:	Non-profit is preferred; Landlord will consider for-profit (Tenant to be responsible for any increase in property taxes)
LEASE RATE:	<p>School Space: \$7,500.00 per month + share of utilities. (Use of Fellowship Hall and Kitchen is negotiable)</p> <p>Church Space: \$3,500.00 - \$5,000.00 per month + share of utilities</p>



FOR LEASING INFORMATION PLEASE CONTACT

RILEY ROHDE
858.369.3041
riley.rohde@kidder.com
LIC N° 02207141

ROBERT FLETCHER
858.369.3034
robert.fletcher@kidder.com
LIC N° 01706060

ERIC KNOWLES
858.369.3017
eric.knowles@kidder.com
LIC N° 00944210

KIDDER.COM

This information supplied herein is from sources we deem reliable. It is provided without any representation, warranty, or guarantee, expressed or implied as to its accuracy. Prospective Buyer or Tenant should conduct an independent investigation and verification of all matters deemed to be material, including, but not limited to, statements of income and expenses. Consult your attorney, accountant, or other professional advisor.



FLOOR PLAN

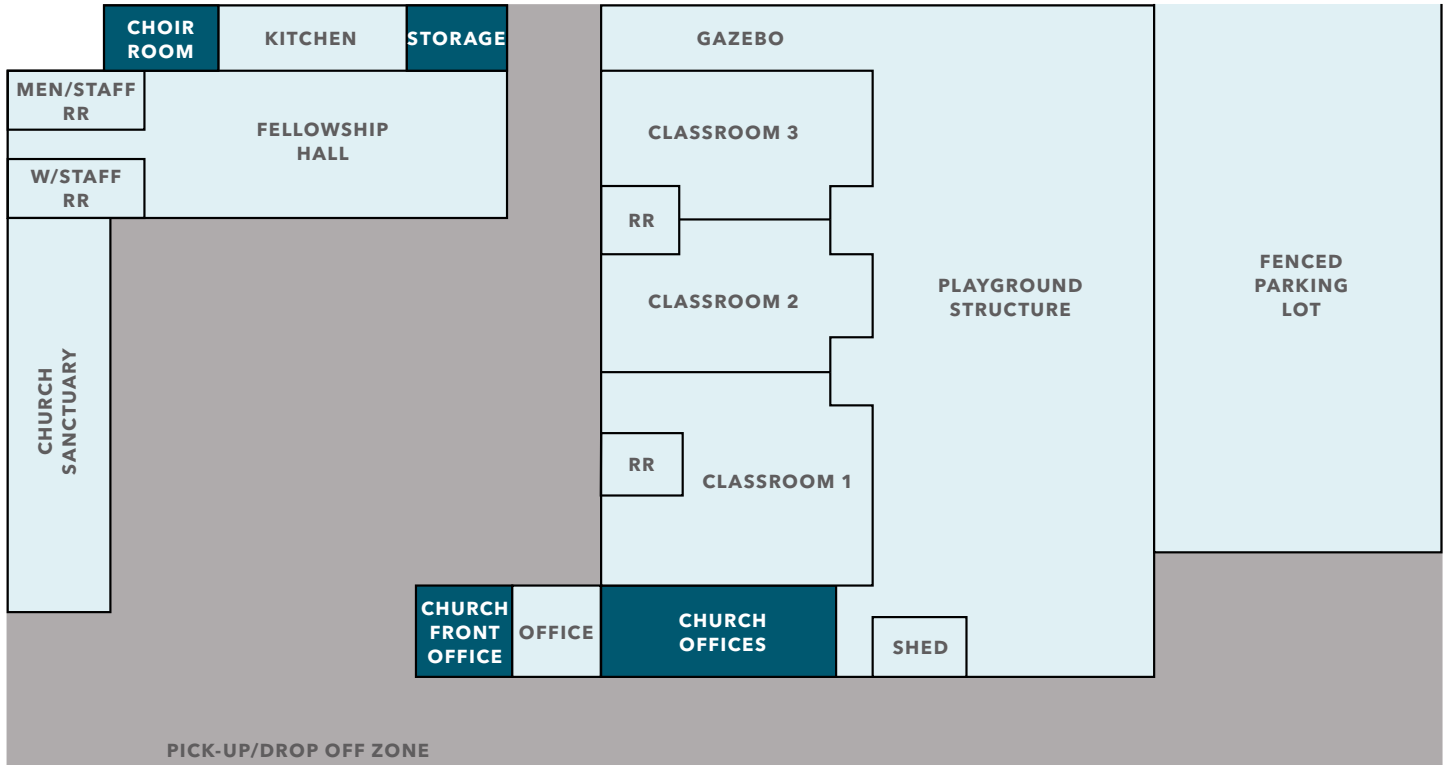

LEGEND: ● Available ● Unavailable

RILEY ROHDE 858.369.3041 | riley.rohde@kidder.com | LIC N° 02207141

ROBERT FLETCHER 858.369.3034 | robert.fletcher@kidder.com | LIC N° 01706060

ERIC KNOWLES 858.369.3017 | eric.knowles@kidder.com | LIC N° 00944210

KIDDER.COM

This information supplied herein is from sources we deem reliable. It is provided without any representation, warranty, or guarantee, expressed or implied as to its accuracy. Prospective Buyer or Tenant should conduct an independent investigation and verification of all matters deemed to be material, including, but not limited to, statements of income and expenses. Consult your attorney, accountant, or other professional advisor.



CHURCH / SCHOOL SPACE FOR LEASE



KIDDER.COM

This information supplied herein is from sources we deem reliable. It is provided without any representation, warranty, or guarantee, expressed or implied as to its accuracy. Prospective Buyer or Tenant should conduct an independent investigation and verification of all matters deemed to be material, including, but not limited to, statements of income and expenses. Consult your attorney, accountant, or other professional advisor.

