

PROPERTY DETAILS

- Building 1: 23,936 - 61,770 SF
- 4,052 SF of Office
- Estimated 2026 CAM \$6.61 PSF
- 8 dock high loading doors
- 11 drive in bays
- 3-phase power
- 28' clear height
- Zoning: I - General Industrial
- Parking Ratio: 1.84/1,000 SF
- Strategically located just east of I-95 between Sunrise Blvd. and Oakland Park Blvd. providing seamless highway access.

ABOUT PROPERTY



PRICE

Upon Request



YEAR BUILT

1987



AVAILABLE SF

23,936 - 61,770 SF



PARKING

1.84/1,000 SF



LOCATION

Fort Lauderdale, FL

For more information:

Keith R. Graves, CCIM, SIOR

Jonathan Thiel

Daniel Forman

954.652.2031 | Kgraves@Bergercommercial.Com

954.652.2020 | Jthiel@Bergercommercial.Com

954.652.2004 | Dforman@Bergercommercial.Com

bergercommercial.com



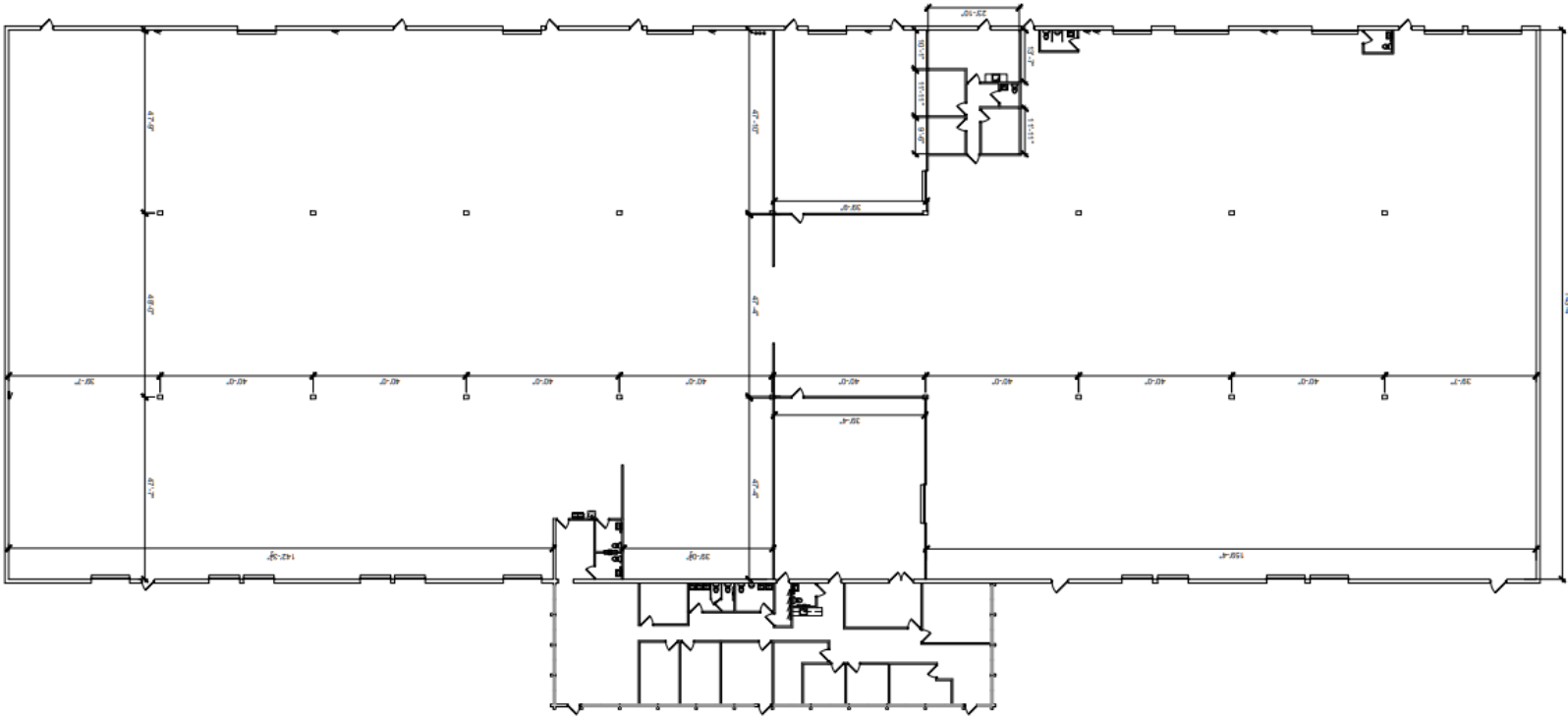

For more information:

Keith R. Graves, CCIM, SIOR

Jonathan Thiel

Daniel Forman

954.652.2031 | Kgraves@Bergercommercial.Com

954.652.2020 | Jthiel@Bergercommercial.Com

954.652.2004 | Dforman@Bergercommercial.Com

bergercommercial.com



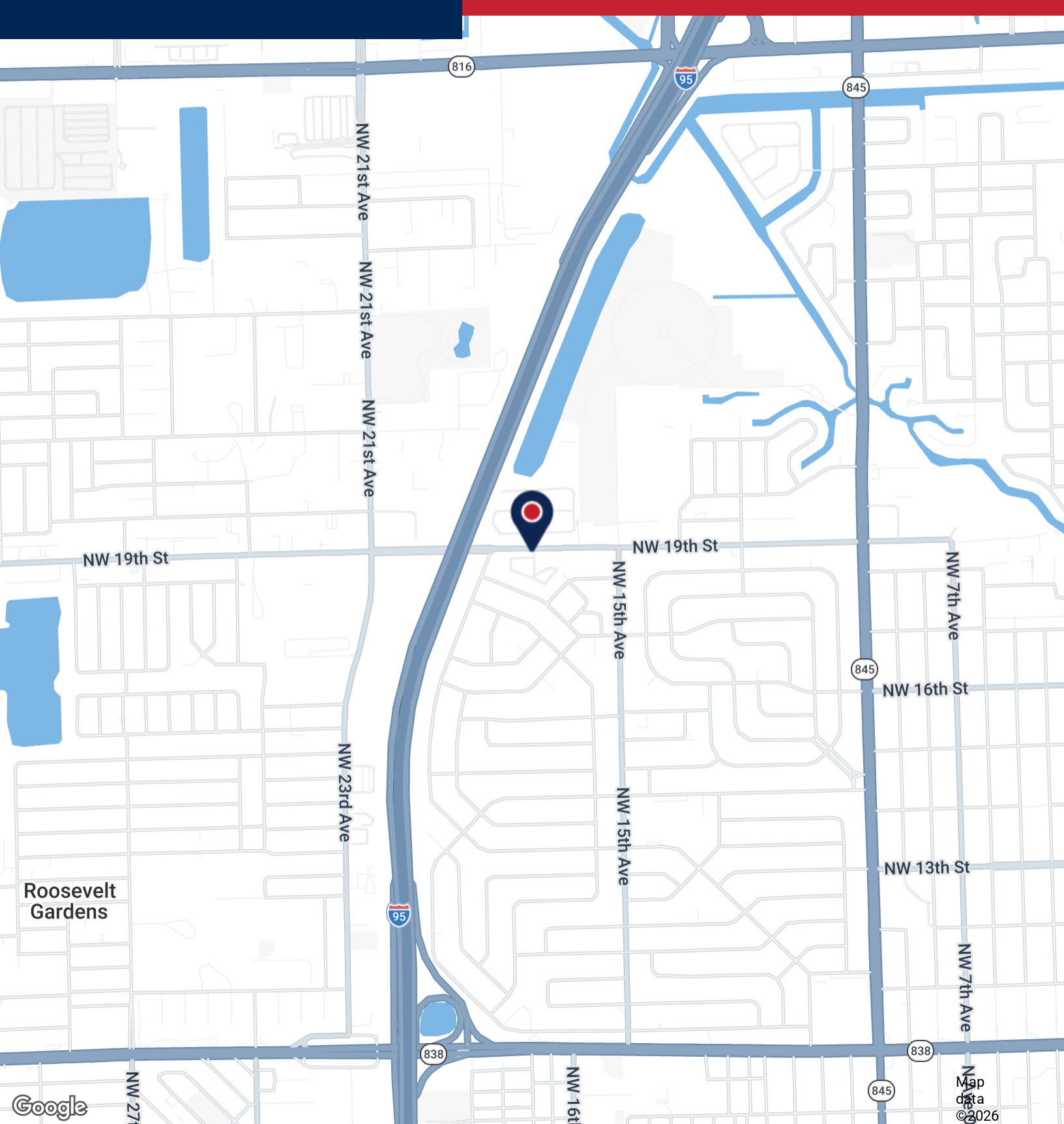

For more information:

Keith R. Graves, CCIM, SIOR

Jonathan Thiel

Daniel Forman

954.652.2031 | Kgraves@Bergercommercial.com

954.652.2020 | Jthiel@Bergercommercial.com

954.652.2004 | Dforman@Bergercommercial.com

bergercommercial.com



COMMERCIAL BROKERAGE AND PROPERTY MANAGEMENT