

540

THIRD AVENUE MURRAY HILL, NYC

Corner of Third Avenue & East 36th Street

RETAIL FOR LEASE

APPROXIMATE SIZE

Corner: 1,954 SF
Inline: 1,792 SF

CEILING HEIGHT

18 FT

ASKING RENT

Corner: \$165 PSF
Inline: \$150 PSF

POSSESSION

Q1 2026

TERM

Negotiable

FRONTAGE

140 FT Wraparound

COMMENTS

- Retail or restaurant spaces available at the base of a brand-new 150-unit luxury building
- Highly visible corner with wraparound frontage and excellent signage potential
- Black-iron venting and gas in place
- Prime corridor surrounded by residential buildings, restaurants, and retail
- Spaces can be leased together or separately

NEIGHBORS

D'Agostino • NYU Langone • Yeshiva University
• Pio Pio • Mazu • Blue Haven • Mira • Crunch Fitness • Chipotle • Cask • Medium Rare • Bodyrok
• Romano Pizza and Restaurant • Jersey Mike's

TRANSPORTATION



PROPERTY INFORMATION

JAMES FAMULARO

President
646.658.7373
jfamularo@meridiancapital.com

JORDAN LANGER

Senior Associate
212.468.5977
jlanger@meridiancapital.com



MERIDIAN
RETAIL LEASING

All information supplied is from sources deemed reliable and is furnished subject to errors, omissions, modifications, removal of the listing from sale or lease, and to any listing conditions, including the rates and manner of payment of commissions for particular offerings imposed by Meridian Capital Group. This information may include estimates and projections prepared by Meridian Capital Group with respect to future events, and these future events may or may not actually occur. Such estimates and projections reflect various assumptions concerning anticipated results. While Meridian Capital Group believes these assumptions are reasonable, there can be no assurance that any of these estimates and projections will be correct. Therefore, actual results may vary materially from these estimates and projections. Any square footage dimensions set forth are approximate.

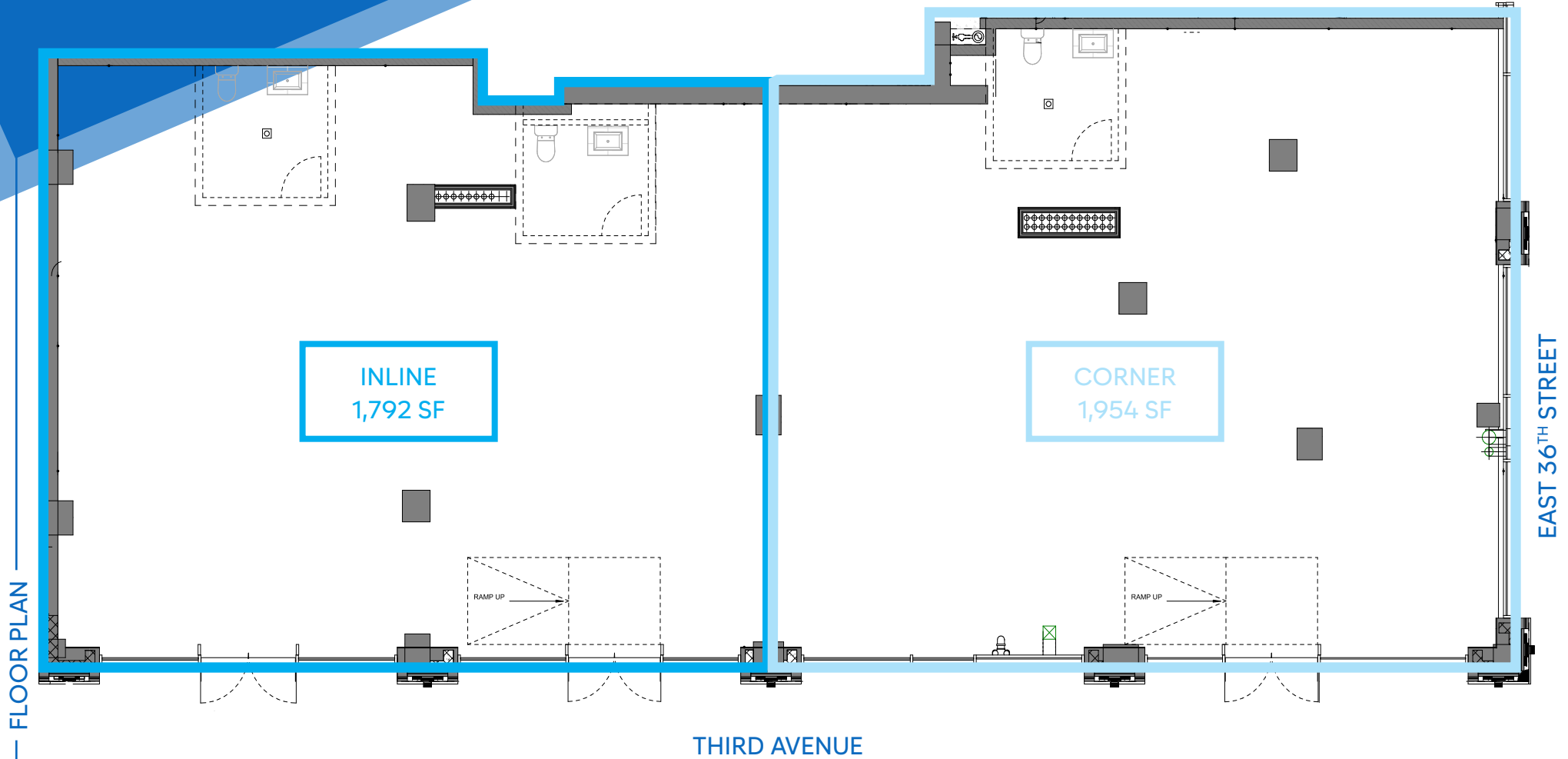

JAMES FAMULARO
President
646.658.7373
jfamularo@meridiantcapital.com

JAMES FAMULARO
President
646.658.7373
jfamularo@meridiantcapital.com

JORDAN LANGER
Senior Associate
212.468.5977
jlanger@meridiantcapital.com



MERIDIAN
RETAIL LEASING

The map displays the Murray Hill neighborhood in NYC, bounded by Lexington Avenue to the west, Second Avenue to the east, and East 33rd Street to the south. The central focus is 540 Third Avenue, located at the corner of East 36th Street. The map is divided into blocks by East 33rd, 34th, 35th, and 36th Streets. Various businesses and landmarks are marked with their respective logos, including Citi Bike, Dunkin', NYU Langone Health, CVS, and many others. A blue circle with the number '540' and 'THIRD AVENUE' is placed over the target location. The map also indicates the Tunnel Entrance and Exit on Third Avenue.

NEIGHBORS

JAMES FAMULARO
President
646.658.7373
jfamularo@meridiancapital.com

JORDAN LANGER
Senior Associate
212.468.5977
jlanger@meridiancapital.com



All information supplied is from sources deemed reliable and is furnished subject to errors, omissions, modifications, removal of the listing from sale or lease, and to any listing conditions, including the rates and manner of payment of commissions for particular offerings imposed by Meridian Capital Group. This information may include estimates and projections prepared by Meridian Capital Group with respect to future events, and these future events may or may not actually occur. Such estimates and projections reflect various assumptions concerning anticipated results. While Meridian Capital Group believes these assumptions are reasonable, there can be no assurance that any of these estimates and projections will be correct. Therefore, actual results may vary materially from these estimates and projections. Any square footage dimensions set forth are approximate.