

05.15.2026

31171 Niguel Rd, Laguna Niguel, CA 92677

Site Plan

Issues or Revisions:

05.15.2026 1st Issue for int. review

Scale: As indicated

Sheet size: 24" x 36"

Drawn by: A.R.

Phase: As-Built

Project #: -

Sheet #: -

01

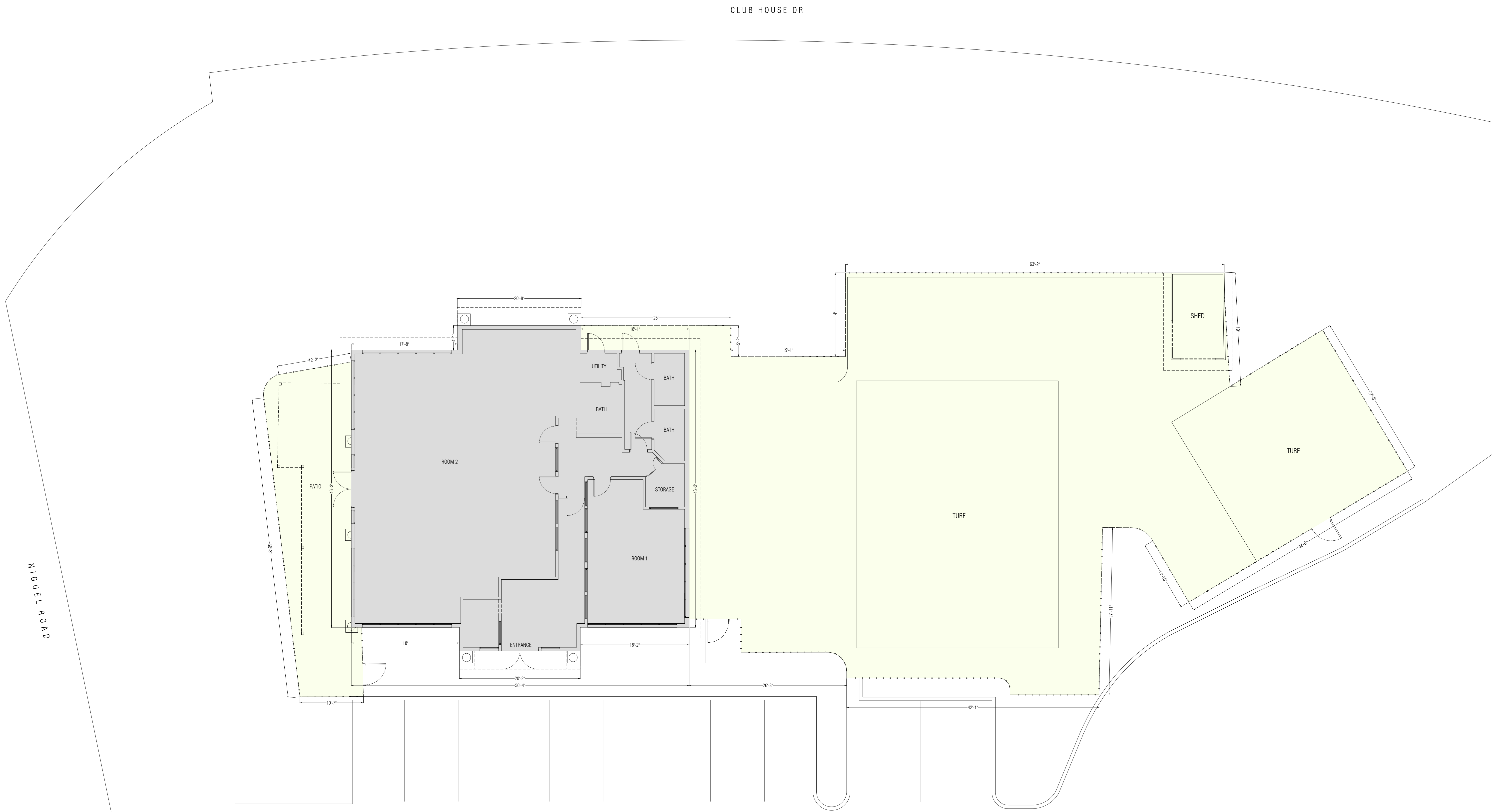

CLUB HOUSE DR

NIGUEL ROAD

PARKING LOT

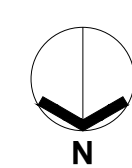

SITE PLAN

SCALE: 1/8"= 1'-0"

BUILDING FOOTPRINT = 2768 SQ.FT.

YARDS AREA = 6680 SQ.FT.

OVERALL LOT AREA = 9448 SQ.FT.