

Meridian Business Campus

3050 Universal Boulevard, Weston, FL 33331



Weston Road Exposure



**Office Space For Lease
7,948 Square Feet**

For More Information:

Timothy J. Talbot
Andrew Ackerman
O (954) 385-0000

www.comrealfortlauderdale.com



Meridian Business Campus

3050 Universal Boulevard, Weston, FL 33331



Building Features

- Freestanding Office Building on Lake
- For Lease: Suite 190 - 7,948 SF
- Weston Road Exposure
- Full Service On-Site Management
- Parking Ratio 4.5/1,000
- Close Proximity to Shopping, Restaurants, Banking Establishments & The Fort Lauderdale-Hollywood International Airport
- Minutes to I-75, South of I-595 & the Sawgrass Expressway

Location! Location! Location!

Weston Road Exposure
Cleveland Clinic
Minutes to Weston Town Center
Fine Dining & Shopping
Weston Hills Country Club
Starbucks, Publix, Banking
Walgreens Pharmacy
& Many More!

www.comrealfortlauderdale.com



Meridian Business Campus

3050 Universal Boulevard, Weston, FL 33331



Meridian Business Campus

3050 Universal Boulevard, Weston, FL 33331

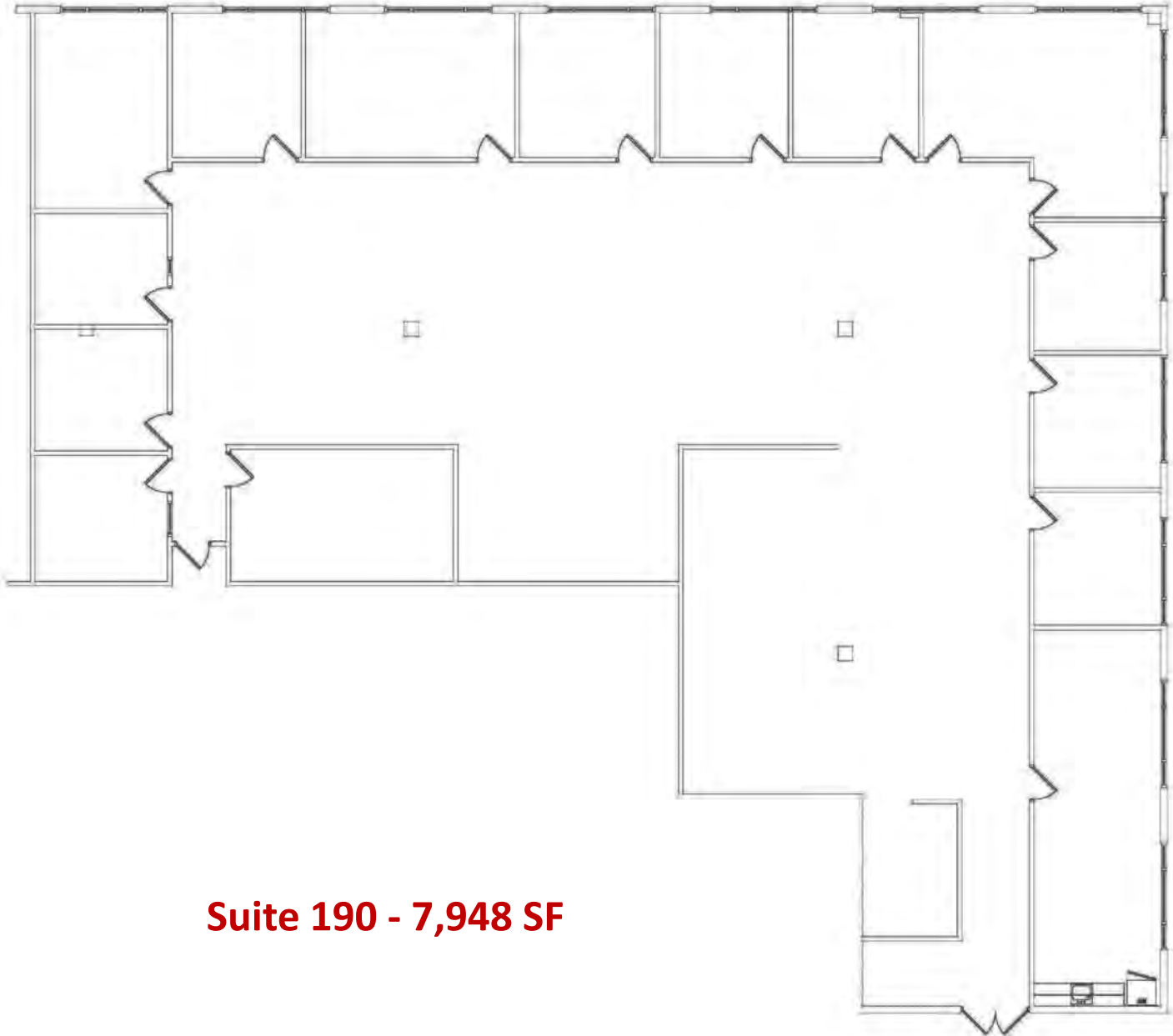

Suite 190 - 7,948 SF

FOR LEASING INFORMATION:

Timothy J. Talbot | ttalbot@comreal.com

Andrew Ackerman | aackerman@comreal.com

954.385.0000

