

AMANECER BUSINESS PARK

940 Calle Amanecer, Suite N
San Clemente, CA

1,570 Square Feet

\$1.75 SF/MO

Triple Net

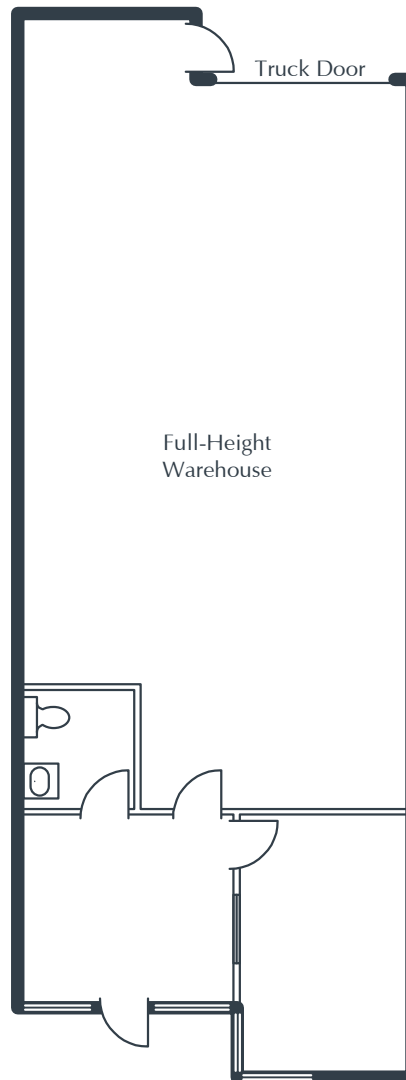

NOTES

Reception

Window Office

Restroom

Ground-Level Truck Door

Approximately 946 sq. ft. of Full-Height Warehouse

Part of a Professionally Managed Business Park

Created by Olen Commercial Realty Corp., 2022.
Information is not to be published or copied without
written approval. Square footage and floor plans are
estimates and should be separately verified. All rates,
terms, floor plans, and building facts are subject to
change without notice.

LAURA PRESTON-FAYERMAN

Senior Leasing Director

949.719.7205

lfayerman@olen.com



Seven Corporate Plaza

Newport Beach, CA

949.644.6536

www.olen.com