

# NEW RETAIL/CATERING UNIT

## BIRMINGHAM

UNIT 2 CHERRY STREET - 55 TEMPLE ROW



SHOP TO LET

### LOCATION

Cherry Street is a vibrant niche retailing location in the heart of Birmingham's City Centre, adjoining Cannon Street, with a consistently strong pedestrian flow between Birmingham's retail and business district.

### SITUATION

The property occupies a prominent position, close to the junction of Cannon Street and Temple Row. The site sits between the main catering F&B locations and Retail location with nearby retailers including **The Ivy, SanCarlo, Riva Blue, McDonald's, Greggs** and **Starbucks**.

### LEASE

The premises are available by way of a new lease, for a term of years to be agreed.

### RENT

On Application

### LEGAL COSTS

Each party to be responsible for their own legal costs.

### EPC

A copy of the energy performance certificate is available on request.

### ACCOMMODATION

Frontage	46 ft	14 m
Shop Depth	148 ft	45 m
Ground Floor	5,200 sq ft	483 sq m
Ground Floor Store	835 sq ft	83 sq m

### BUSINESS RATES & SERVICE CHARGE

Rateable Value	TBA
Rates Payable (21/22)	TBA
Service Charge (21/22)	TBA

### ANTI MONEY LAUNDERING

In accordance with Anti-Money Laundering Regulations, two forms of ID and confirmation of the source of funding will be required from the successful applicant.

### VIEWING

For further information or to arrange a viewing, please contact:

### BWD

Nick De-Pons  
07767-768-423  
ndepons@bwdretail.co.uk

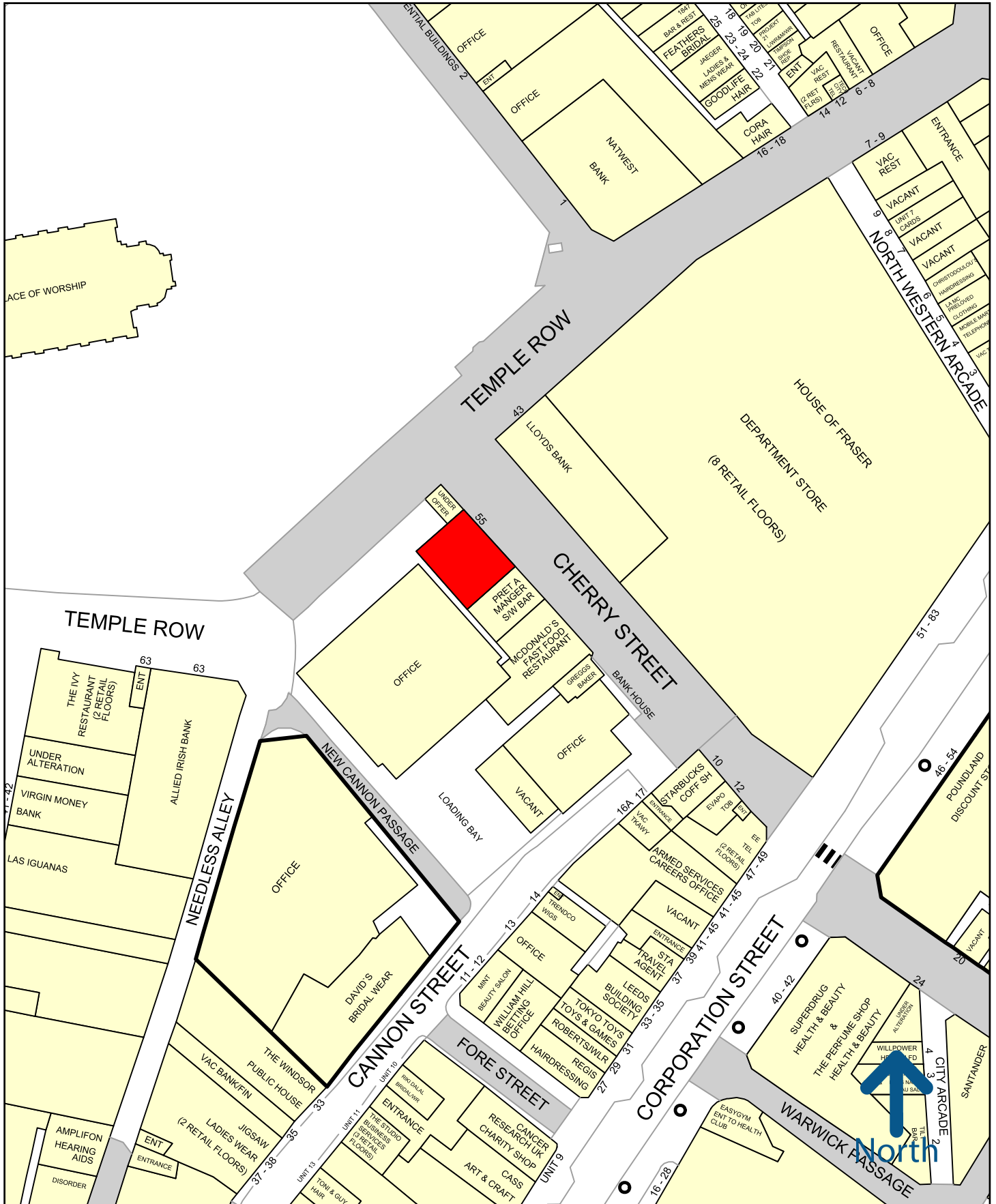

50 metres

Experian Goad Plan Created: 21/10/2019  
Created By: Bidwell Webber De Pons Ltd



Copyright and confidentiality Experian, 2019. © Crown copyright and database rights 2019. OS 100019885

For more information on our products and services:  
[www.experian.co.uk/goad](http://www.experian.co.uk/goad) | [goad.sales@uk.experian.com](mailto:goad.sales@uk.experian.com) | 0845 601 6011



 Zone for Demise

 Common Zone

SCALE 1 : 200

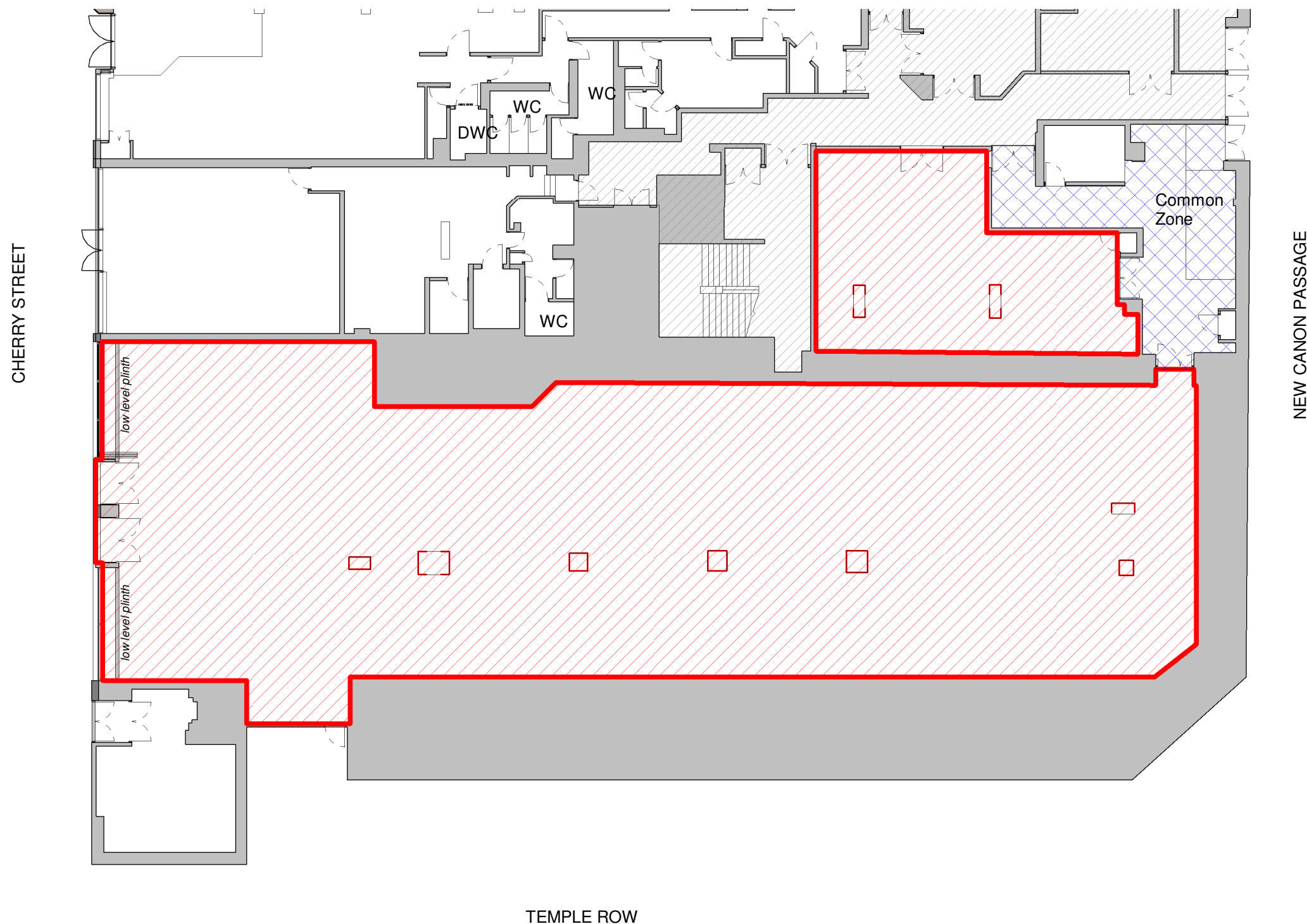

Rev	Description	Date	Dr by	App by
original by		date created		approved by
SL		10/18/19		SL

**AHR** Architects Ltd  
 Alpha Works  
 Alpha Tower  
 Suffolk Street Queensway  
 Birmingham  
 B1 1TT  
 United Kingdom

T +44(0)121 4561591  
 E birmingham@ahr.co.uk  
 www.ahr.co.uk

client name		
IM Properties		
project		
55 Temple Row		
drawing		
Lease Plan Unit 2		
computer file	plot date	
H:\AR\BR20162016.00417.000 - 55 Temple Row\10 BMR10.0 WIP Data\00417.AHR.XX.XX.M5-A-55 TEMPLE STREET CENTRAL_detached 2016.rvt		
project number	scale	
2016.00417.000	As indicated @A3	
drawing number	rev	issue
SK14		status

This drawing is to be read in conjunction with all related drawings. All dimensions must be checked and verified on site before commencing any work or producing shop drawings. The originator should be notified immediately of any discrepancy. This drawing is copyright and remains the property of AHR.