

RETAIL FOR LEASE

Stella Place

12847 50 Street NW
Edmonton, AB

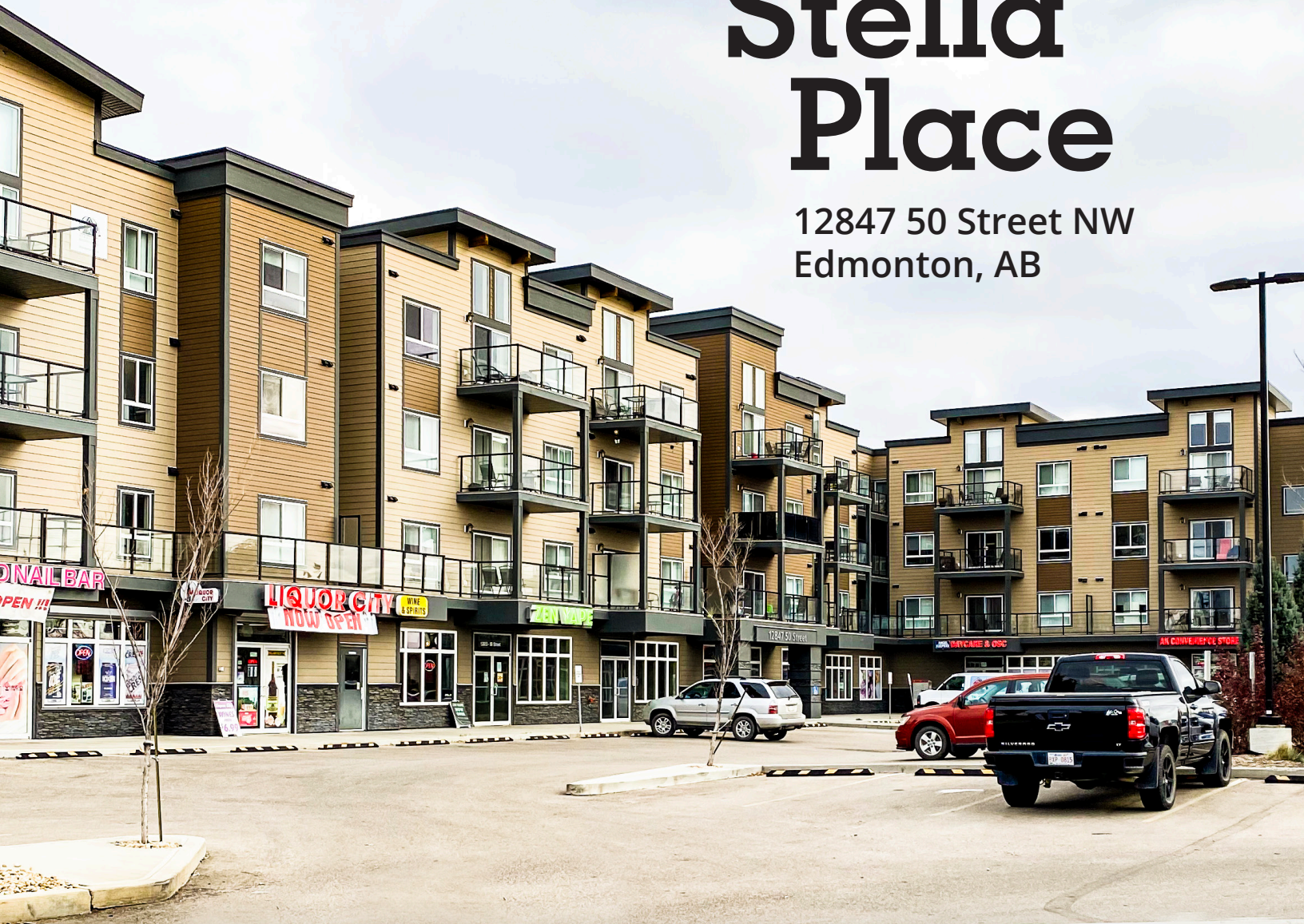

Get more
information

Paul Raimundo
Principal
+1 780 702 0697
paul.raimundo@avisonyoung.com





Bruce Peters
Vice President
+1 780 478 7162
bruce.peters@avisonyoung.com

AVISON
YOUNG

Stella Place



Demographics

	3 kilometers	5 kilometers
 Population	80,402	178,971
 Households	30,070	65,373
 Median Age	37.6	37.8
 Average Household Income	\$92,222	\$98,194

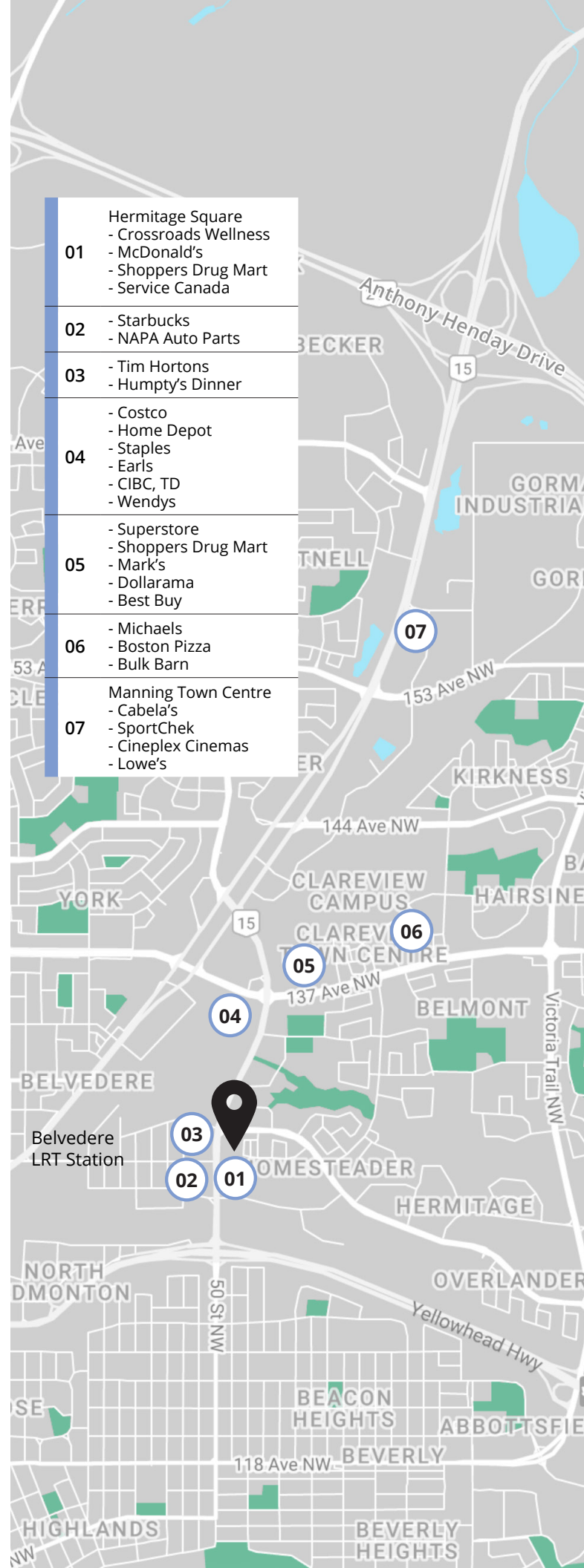

- 01**
 - Hermitage Square
 - Crossroads Wellness
 - McDonald's
 - Shoppers Drug Mart
 - Service Canada
- 02**
 - Starbucks
 - NAPA Auto Parts
- 03**
 - Tim Hortons
 - Humpty's Dinner
- 04**
 - Costco
 - Home Depot
 - Staples
 - Earls
 - CIBC, TD
 - Wendys
- 05**
 - Superstore
 - Shoppers Drug Mart
 - Mark's
 - Dollarama
 - Best Buy
- 06**
 - Michaels
 - Boston Pizza
 - Bulk Barn
- 07**
 - Manning Town Centre
 - Cabela's
 - SportChek
 - Cineplex Cinemas
 - Lowe's

For Lease

12847 50 Street NW, Edmonton, AB

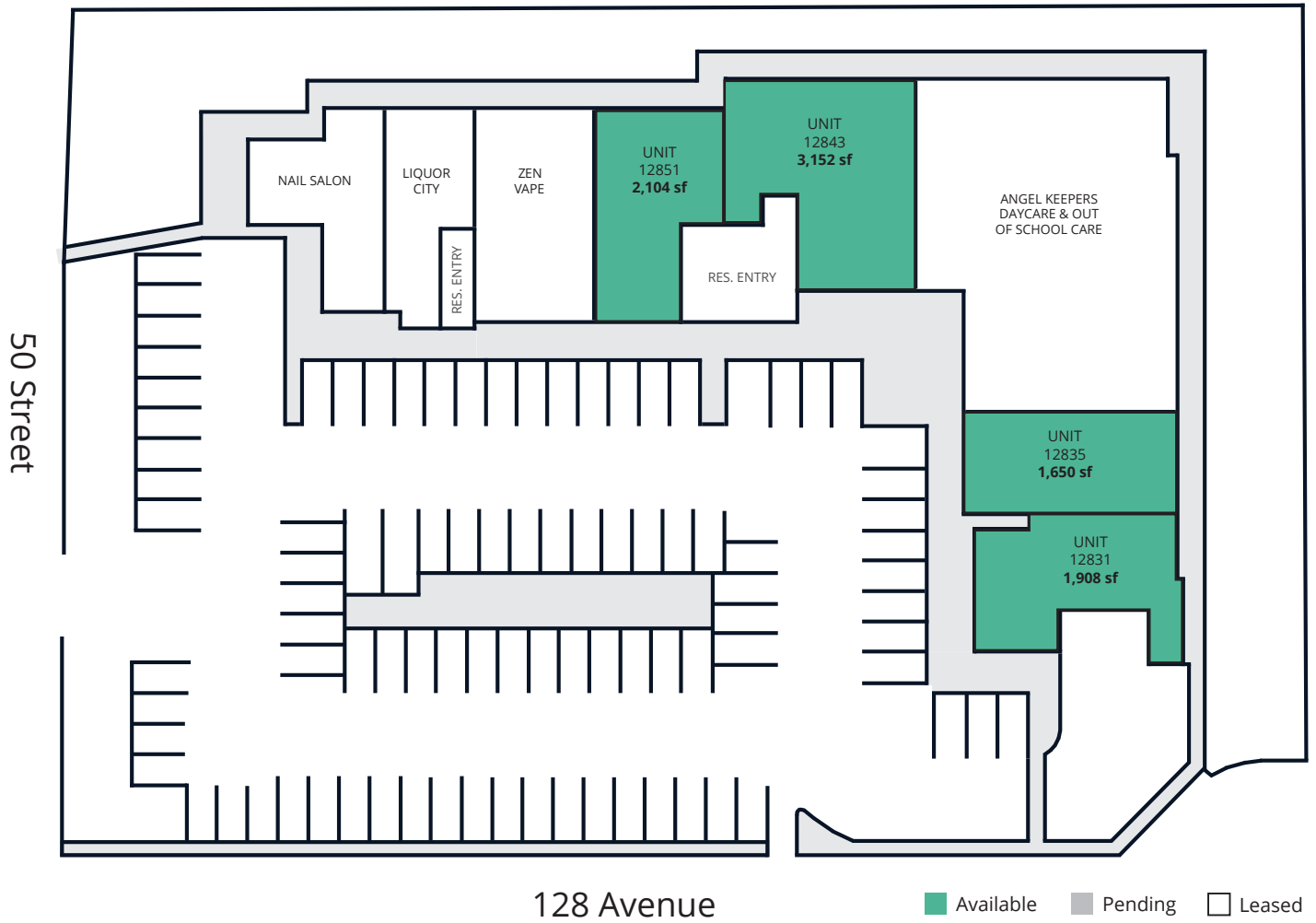

Offering summary

Unit Available	SF
12831	1,908
12835	1,650
12843	3,152
12851	2,104
<hr/>	
Year built:	2016
<hr/>	
Zoning:	CG - General Commerical Zone
<hr/>	
Residential units:	66 units
<hr/>	
Lease rate:	Market

Stella Place

12847 50 Street NW
Edmonton, AB



Get more information

Paul Raimundo

Principal

+1 780 702 0697

paul.raimundo@avisonyoung.com

Bruce Peters

Vice President

+1 780 478 7162

bruce.peters@avisonyoung.com

**AVISON
YOUNG**