

# 100 CITY SQUARE

CHARLESTOWN | BOSTON, MA

TRANSIT-ORIENTED LOCATION SEAMLESSLY CONNECTED TO BOSTON

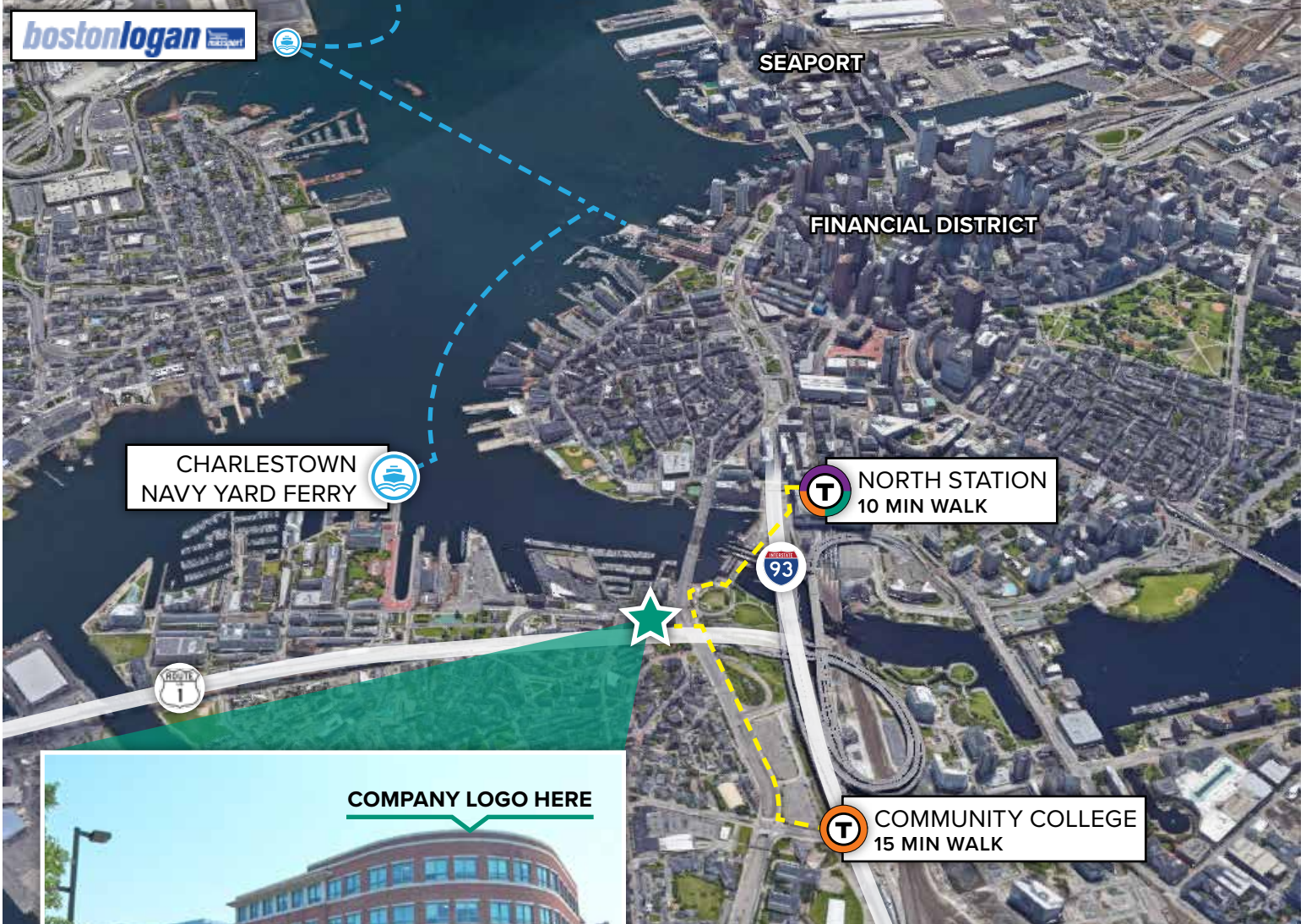

**GLOBAL HQ OPPORTUNITY**

51,870 RSF Class A Office For Lease

LINCOLN  
PROPERTY  
COMPANY

# HIGHLIGHTS

- ✔ Ground floor lobby with dedicated reception desk
- ✔ Private elevator access to 2nd and 3rd floors from the building's garage
- ✔ Views of Boston Harbor and Charles River
- ✔ On-site parking with 95 Indoor Parking Spaces



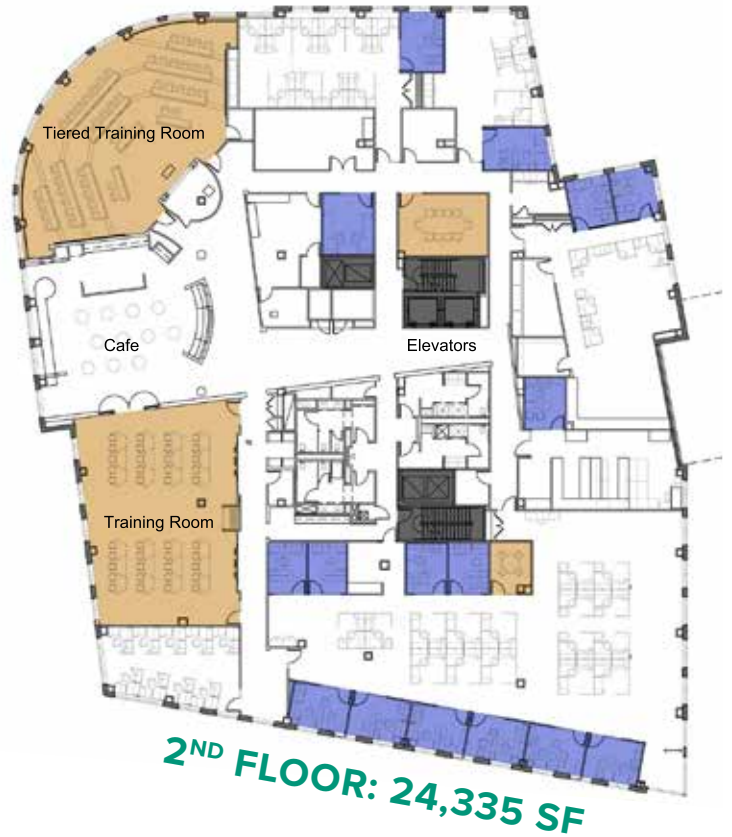

## AVAILABLE SPACE

Lobby:	3,200 SF
2 <sup>nd</sup> Floor:	24,335 SF
3 <sup>rd</sup> Floor:	24,335 SF
<b>TOTAL:</b>	<b>51,870 SF</b>

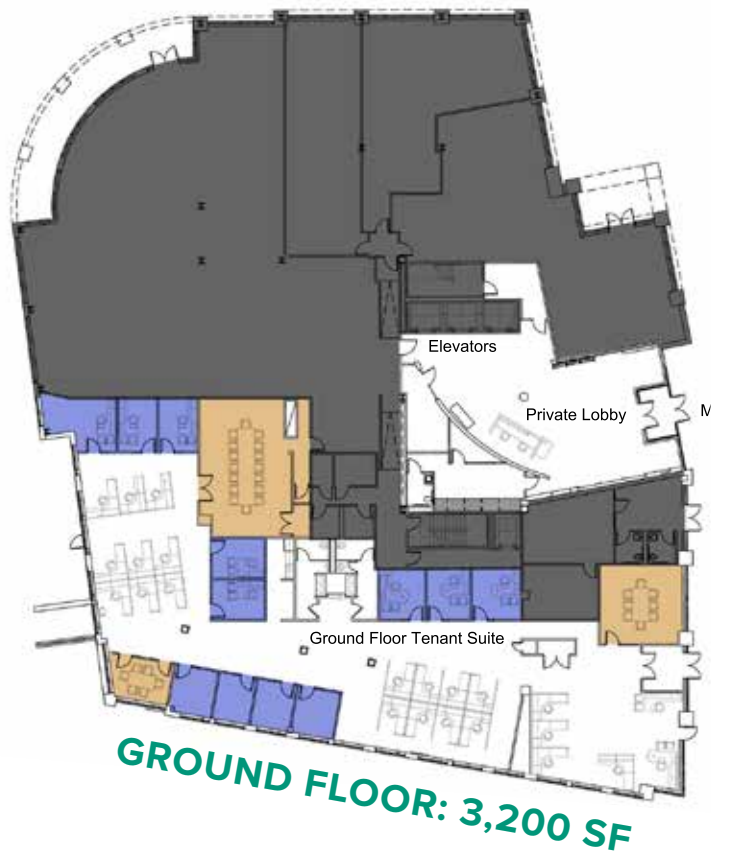

Floor plans show existing conditions.  
Select demo is underway.

Floor Plan measurements are approximate and are for illustrative purposes only. While we do not doubt the floor plans accuracy, we make no guarantee, warranty or representation as to the accuracy and completeness of the floor plan.

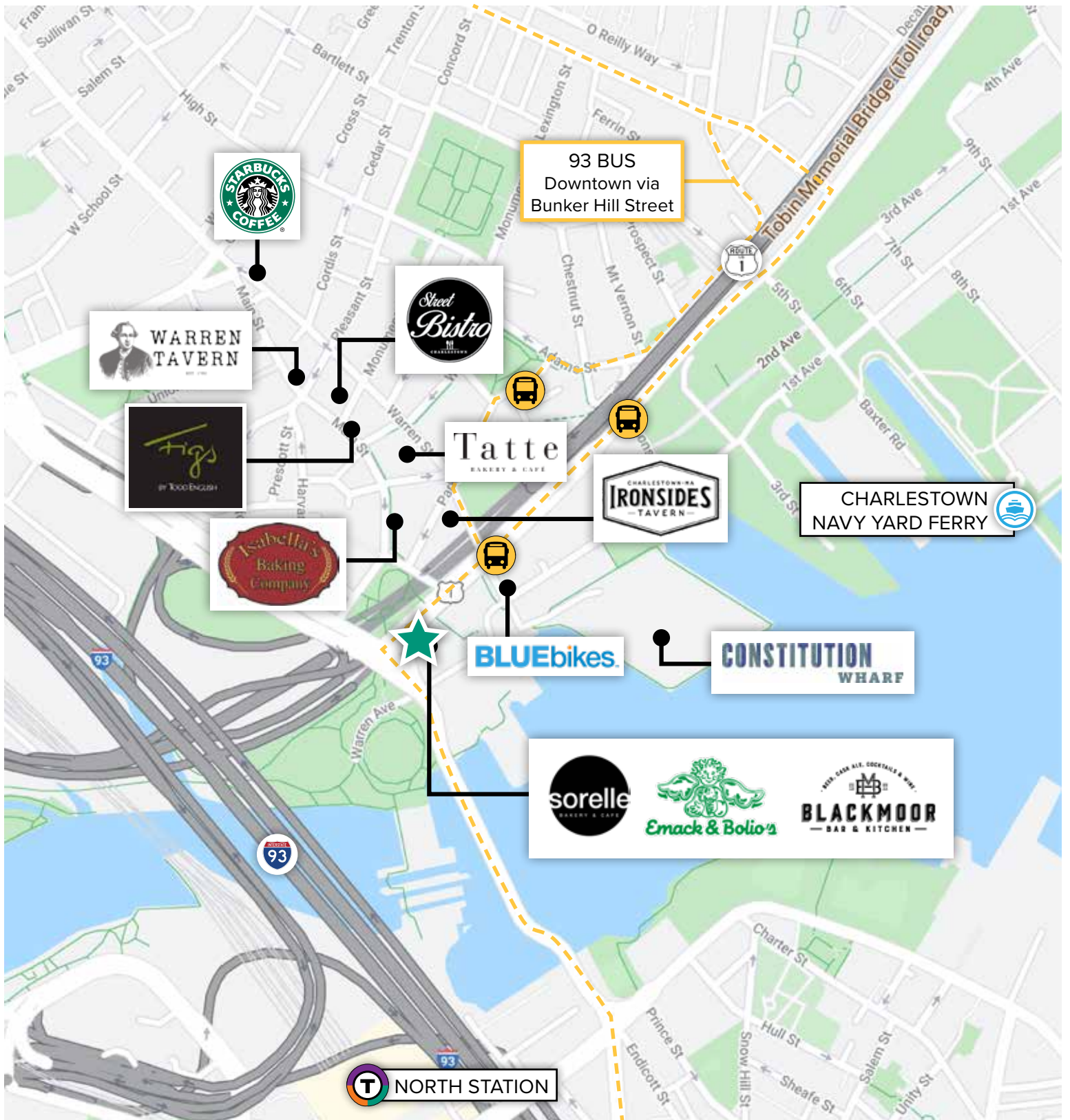

**ROB CRONIN**  
 Senior Vice President  
 617.951.4147  
 rcronin@lpc.com

**BRENDAN MILLER**  
 Senior Vice President  
 617.951.4148  
 bmiller@lpc.com

**JEFFREY MOORE**  
 Senior Vice President  
 617.951.4161  
 jmoore@lpc.com

**CHRISTOPHER SCOTT**  
 Vice President  
 617.951.4135  
 cscott@lpc.com