



1415

E. 14th Street
San Leandro, CA

RETAIL OR MEDICAL BUILDING
FOR LEASE

Available: NOW

Asking Rate: \$30 NNN per RSF / Year

1415 E. 14th Street 2,196 RSF +/-
(Formerly GameStop)

~~1417 E. 14th Street 2,275 RSF +/-~~
(Formerly T-Mobile) **LEASED**

Exclusively Represented By:

Jay D. Shaffer

(415) 407-3997

jshaffer@coltoncommercialsf.com

License #: 01444640



530 Bush Street, Ste. 800
San Francisco, CA 94108
(415) 834-1600

1415

E. 14th Street San Leandro, CA

RETAIL OR MEDICAL BUILDING
FOR LEASE



2024 POPULATION

1 MILE	3 MILES	5 MILES
30,960	167,230	348,173



2024 NUMBER OF HOUSEHOLDS

1 MILE	3 MILES	5 MILES
11,610	53,806	113,110



2024 AVERAGE HOUSEHOLD INCOME

1 MILE	3 MILES	5 MILES
\$121,776	\$104,847	\$ 113,619

**Source: CoStar*

- High Identity retail spaces
- Exceptional signage opportunities & Identity
- High foot traffic
- Easy Access
- Adjacent to Safeway Shopping Center
- Plentiful nearby parking



All material presented herein is intended for informational purposes only. Information is compiled from sources deemed reliable but is subject to errors, omissions, changes in price, condition, sale, or withdraw without notice. No statement is made as to accuracy of any description. All measurements and square footages are approximate. Exact dimensions can be obtained by retaining the services of an architect or engineer. This is not intended to solicit property already listed.

1415

E. 14th Street
San Leandro, CA

HIGH IDENTITY CORNER SPACE

2,196 RSF +/-
(Formerly GameStop)

Available: NOW

Rate: ~~\$36~~ **\$30**
per RSF/Year, NNN

Term: 5-10 Years

- High Identity retail space
- Exceptional signage opportunities & Identity
- High foot traffic
- Easy Access
- Adjacent to Safeway Shopping Center
- Plentiful nearby parking



1415

E. 14th Street
San Leandro, CA

HIGH IDENTITY
CORNER RETAIL SPACE

FLOOR PLAN
2,196 RSF +/-

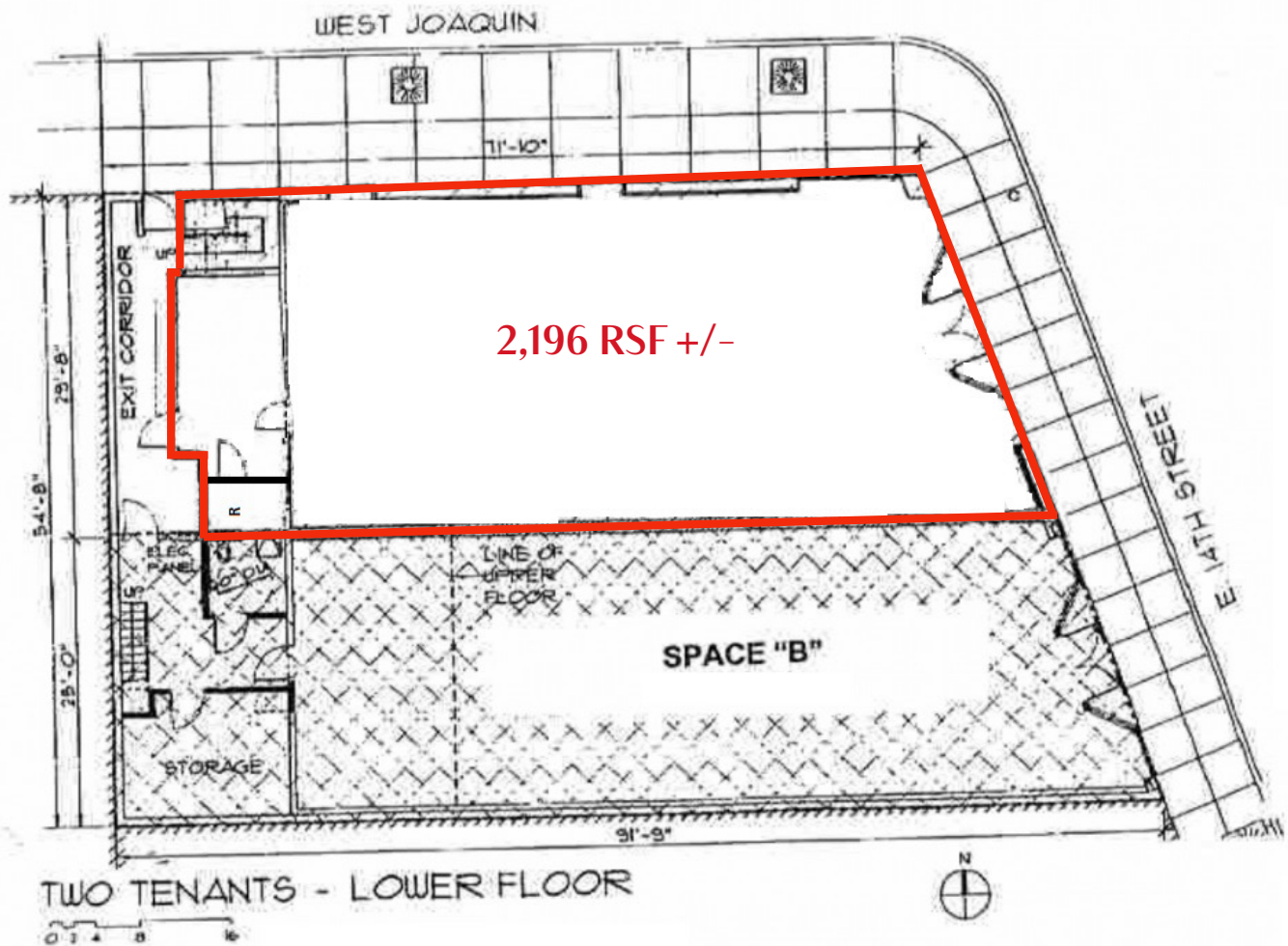

1415

E. 14th Street San Leandro, CA

NEIGHBORHOOD MAP

NEARBY:

- San Leandro Plaza - Shopping Mall
- CVS
- Safeway
- Bank of America Financial Center
- Fieldwork Brewing Company
- Sons of Liberty Alehouse
- Peet's Coffee
- Taqueria Los Pericos
- Café Sorriso
- Pelton Cafe

