

# Suite 550

±3,198 RSF

- Double Door Entry
- Fully Furnished  
Plug-and-Play Opportunity
- Open Plan With 20 Sit/Stand Workstations
- One Medium Conference Room
- Open Kitchen
- Reception Area



## HARLAN PLACE

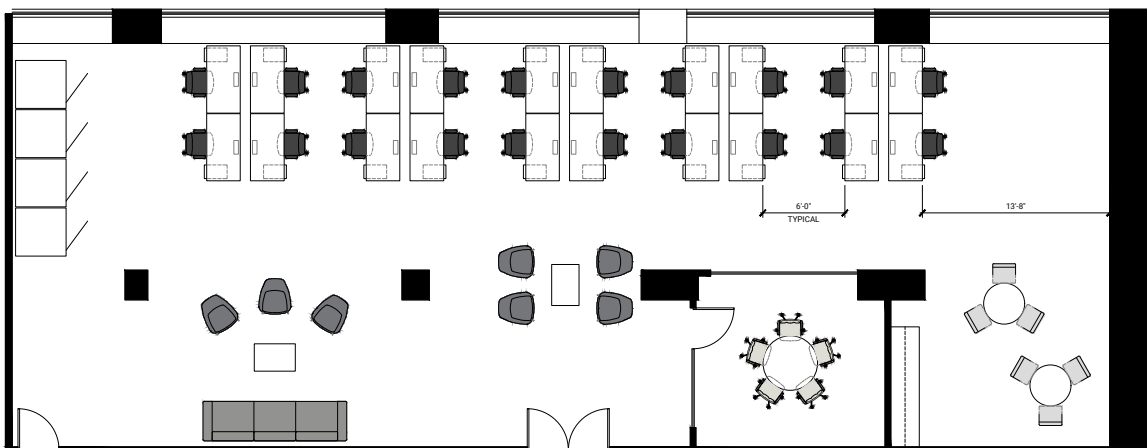

**MICHAEL DEMARIA**  
+ 1 415 395 7248  
michael.deMaria@jll.com  
License #: 01366535

**MADDIE MITCHELL**  
+ 1 650 863 8804  
maddie.mitchell@jll.com  
License #: 02265276

