

401

WEST 207th ST

CORNER OF 207TH STREET & 9TH AVE
INWOOD, NYC

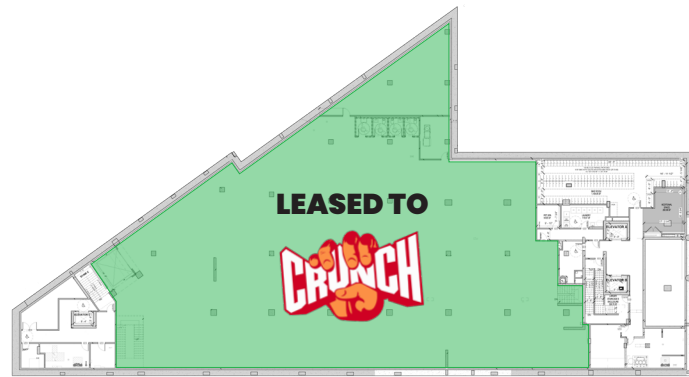

FLOOR PLANS:
INLINE SPACE:

14,850 SF

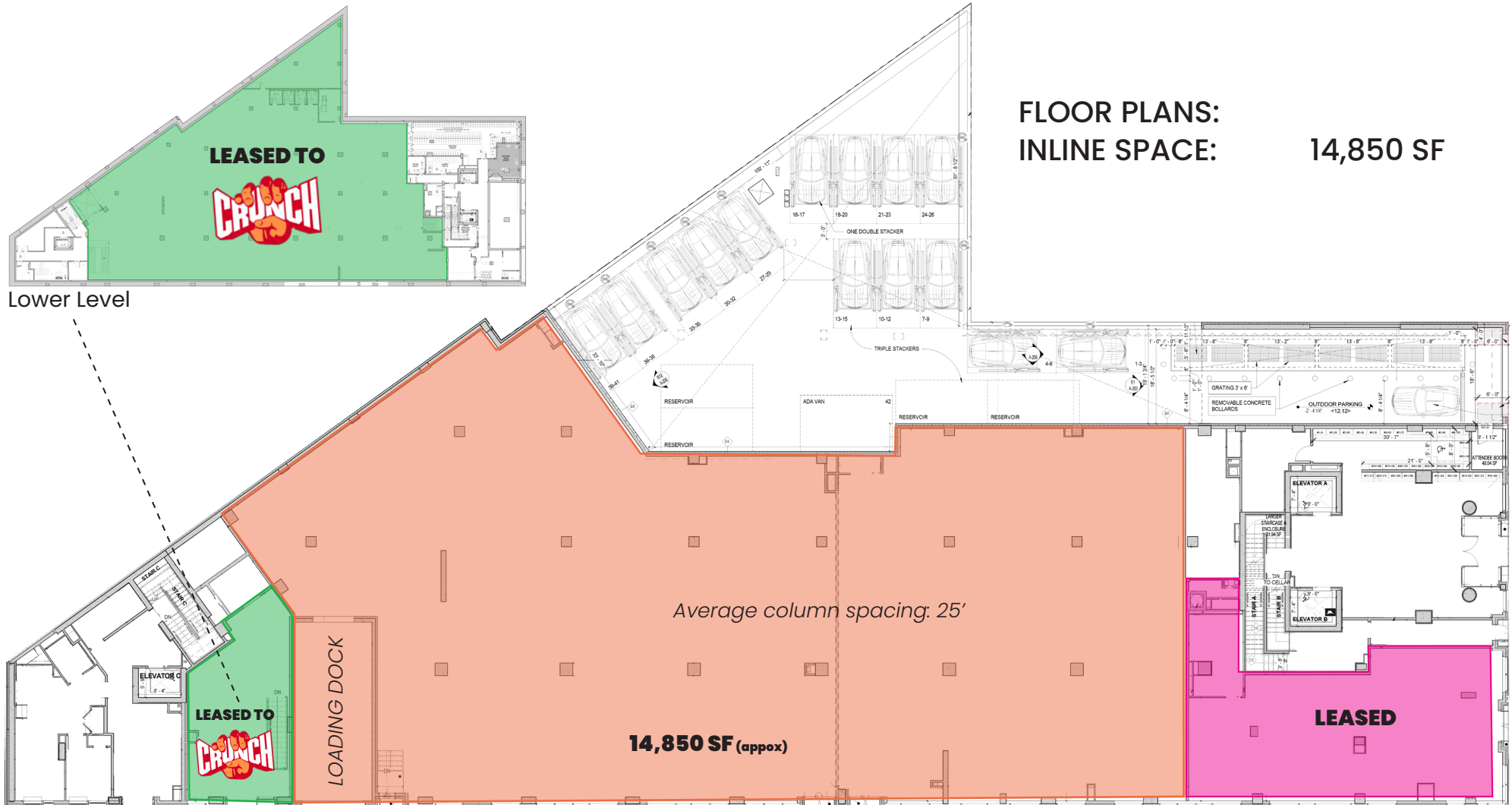

Ground Floor

401

WEST 207th ST

CORNER OF 207TH STREET & 9TH AVE
INWOOD, NYC

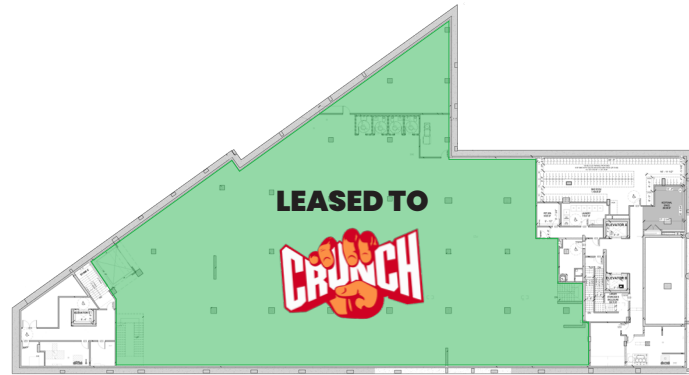

Lower Level

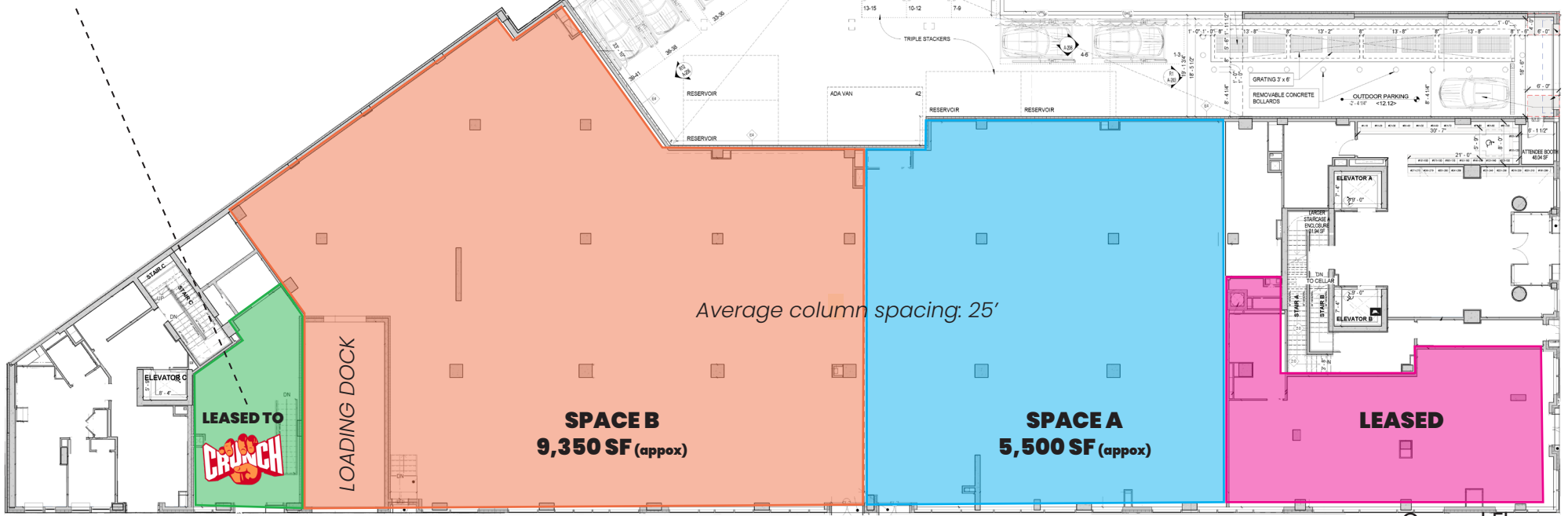

PROPOSED DIVISION: OPTION 1

FLOOR PLANS:

SPACE A:	5,500 SF
SPACE B:	9,350 SF
TOTAL:	14,850 SF

401

WEST 207th ST

CORNER OF 207TH STREET & 9TH AVE
INWOOD, NYC

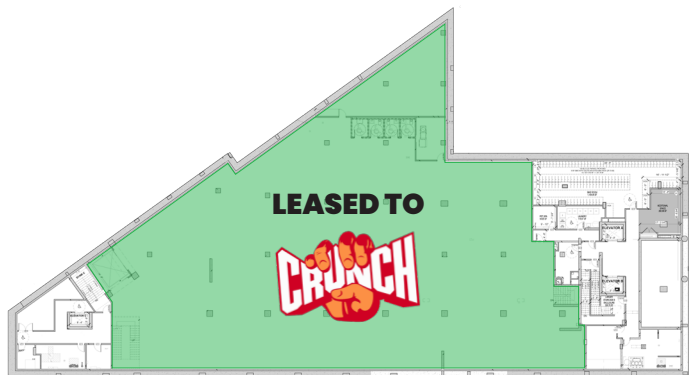

Lower Level

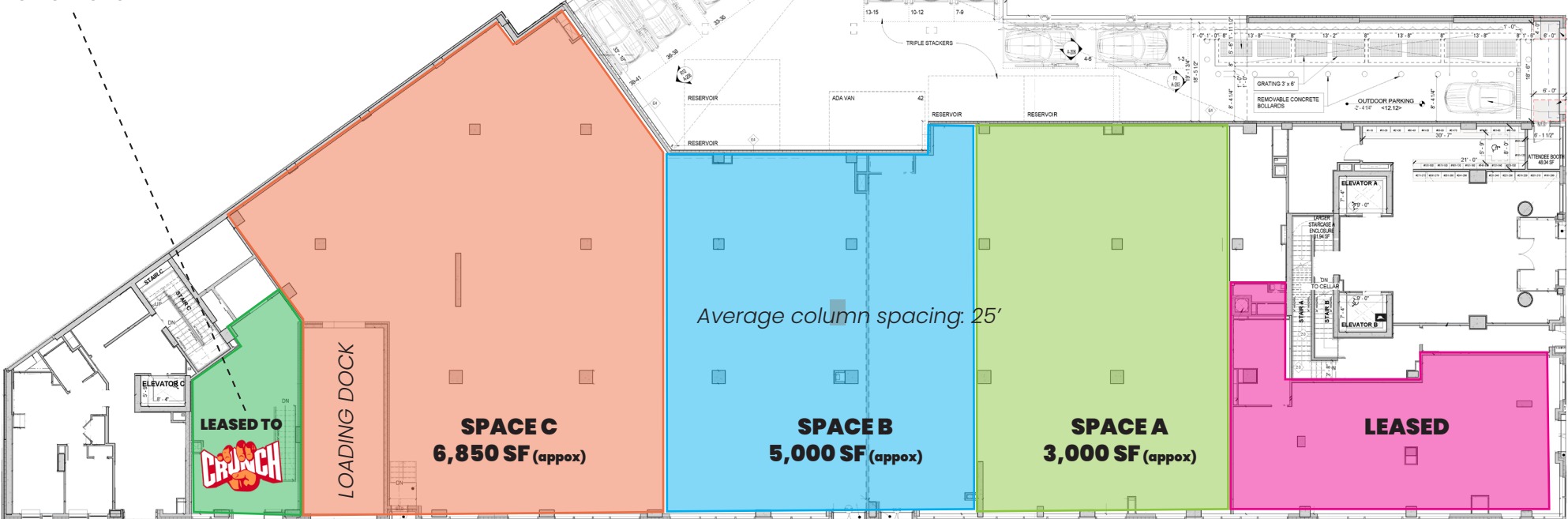

Ground Floor

PROPOSED DIVISION: OPTION 2

FLOOR PLANS:

SPACE A:	3,000 SF
SPACE B:	5,000 SF
SPACE C:	6,850 SF
TOTAL:	14,850 SF