

Sacramento, CA

DOS RIOS BUSINESS COMPLEX

1106 NORTH D STREET
FOR LEASE



**For Further Information,
Please Contact:**

Brian English
benglish@centurymgmt.com

Keith Galliano
kgalliano@centurymgmt.com

**1001 Enterprise Way, Suite 250
Roseville, CA 95678
Phone: (916) 784-3666
Fax: (916) 784-3667**

Unit #22
3,984 Square Feet

Features:

- 295 square foot office
- 1 grade-level door
- Zoned M-1
- Gross, no C.A.M. fee lease
- Minutes to Downtown Sacramento

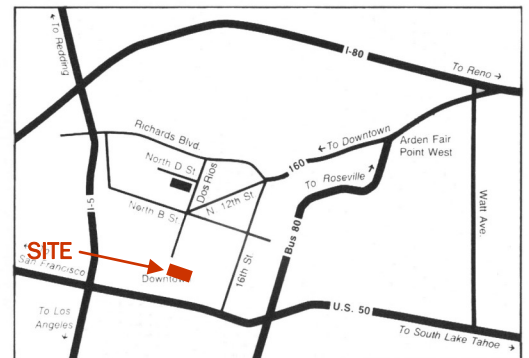

**Century
Management
Company**

Sacramento, CA

DOS RIOS BUSINESS COMPLEX

— 48' —

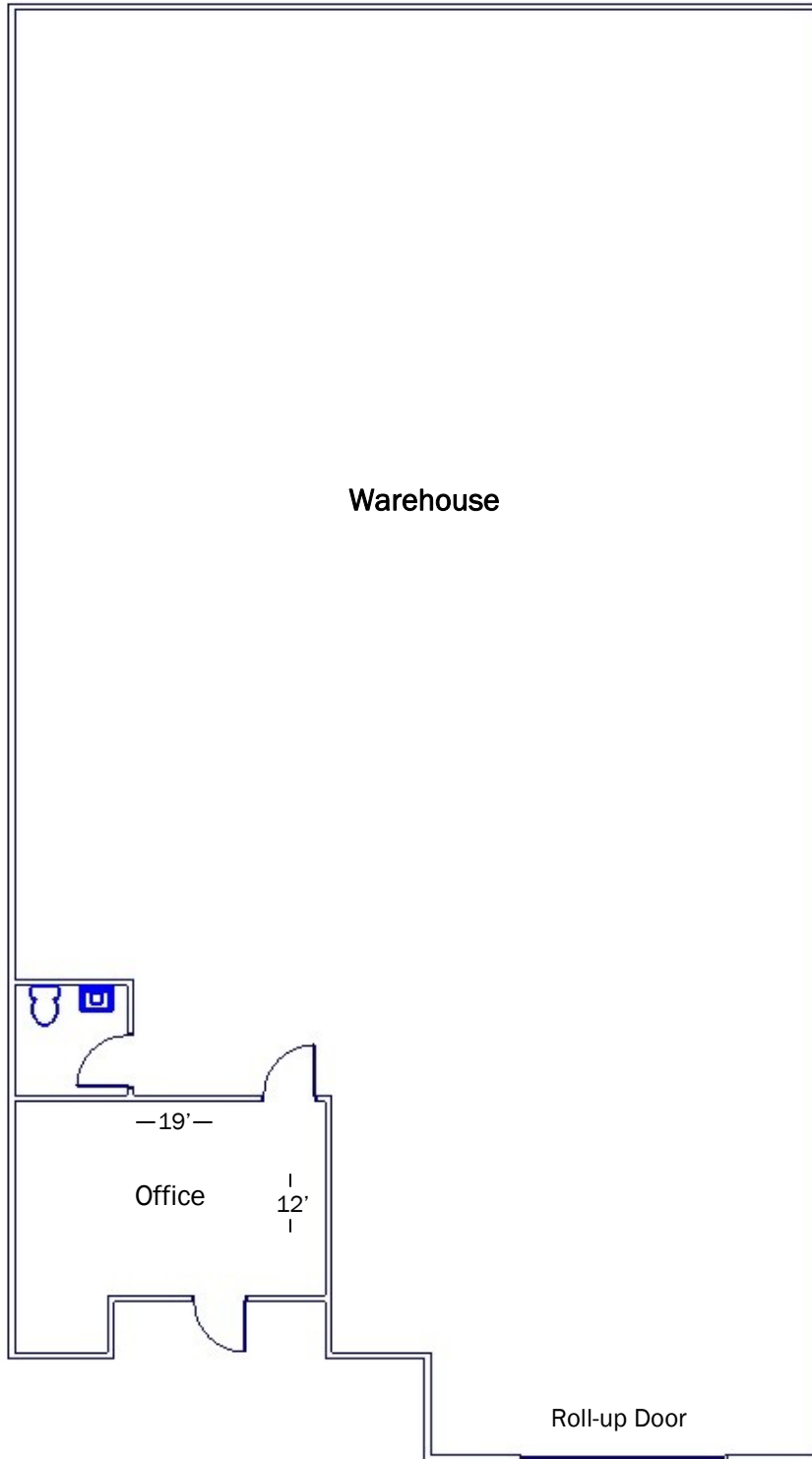

86'

(Not to scale)