

MEMORIAL REGIONAL MOB 1 SPEC SUITE 310 | 4,046 RSF

8220 MEADOWBRIDGE ROAD
MECHANICSVILLE, VA 23116



SCAN TO LEARN MORE ABOUT THIS LISTING

Seafoam



IMAGE IS A REPRESENTATION. ACTUAL SUITE MAY DIFFER.

LEASE THIS MODERN, MOVE-IN READY MEDICAL SUITE

Lease Your Move-In Ready SPEC Suite Today

Our SPEC suites combine convenience and quality in one perfect package. With sleek, modern finishes already in place, these suites are designed to be fully operational as soon as you move in. **Skip the hassle and delays of construction and permitting**—just move in and start seeing patients!



FOR LEASING INFORMATION, CONTACT:

REGIONAL LEASING DIRECTOR: Tyler Miller | tyler.miller@lillibridge.com / 804.836.4473

SPEC SUITE - SEAFOAM FINISH PALETTE

SUITE 310 | 4,046 RSF

MEMORIAL REGIONAL MEDICAL OFFICE BUILDING 1



BREAK ROOM



NURSES STATION



RECEPTION/
WAITING ROOM



PLASTIC
LAMINATE
CABINETS



LUXURY
VINYL TILE

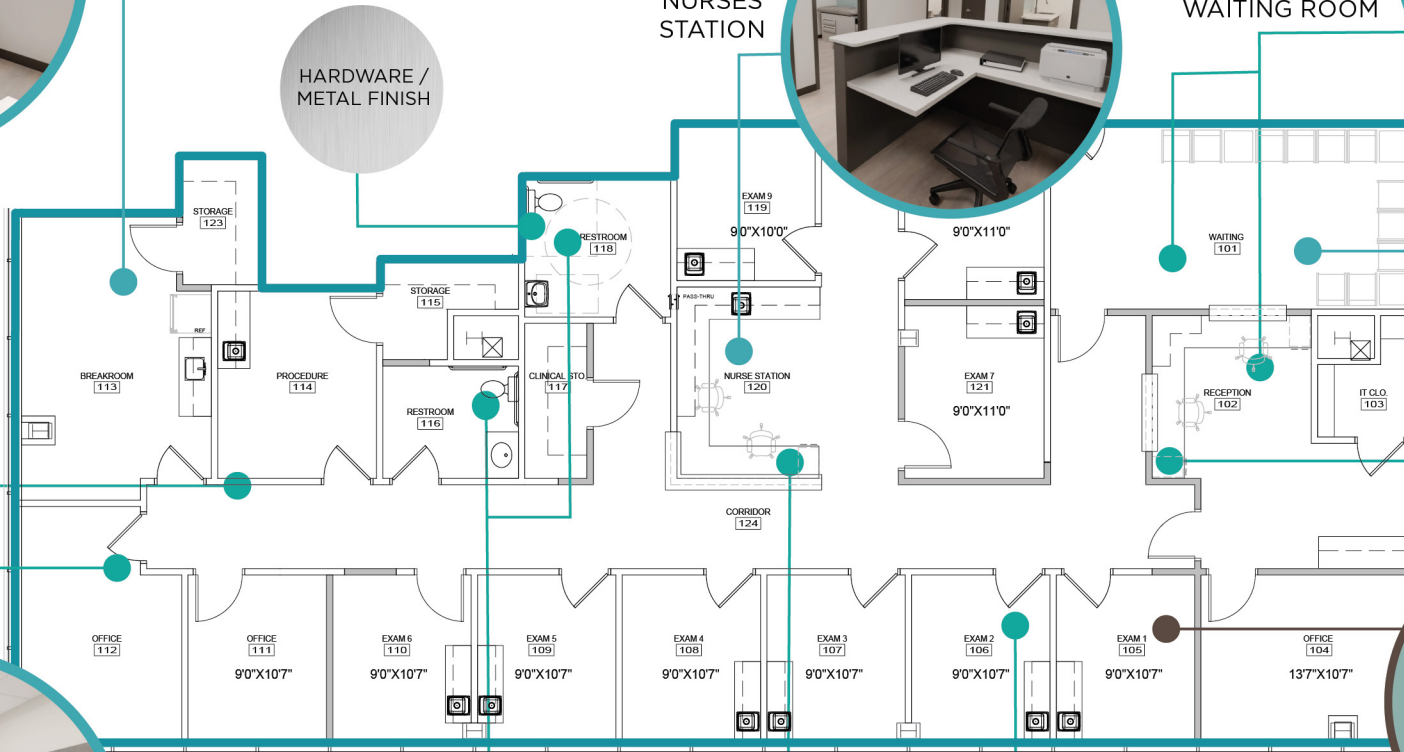

OFFICE



BATHROOM
FLOOR TILE &
WALL BASE



BATHROOM
WALL TILE



LAMINATE
COUNTERTOP



EXAM ROOM

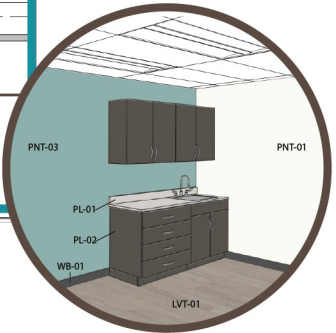

FINISH RENDERING

COLOR PALETTE

PNT-01:
OVERALL PAINT

PNT-02:
ACCENT PAINT - OFFICE

PNT-03:
ACCENT PAINT - PATIENT ROOM

PNT-04:
DOOR FRAME PAINT