

Poulton Street, Fleetwood, FY7 6LP

£500 pcm

Full Description

Ground Floor

Office 10.67m (35') x 5.26m (17'3")

UPVC double glazed entrance door, uPVC double glazed window to front, uPVC double glazed window to side, built-in storage cupboard with fuse box and electricity meter, additional storage cupboard housing hot water tank with shelving, laminate flooring, recessed spotlights

WC 1.34m (4'5") x 0.86m (2'10")

Fitted with two piece suite comprising wall mounted wash hand basin and low-level WC

Kitchen 4.23m (13'11") x 2.25m (7'5")

Fitted with a matching range of base and eye level units with round edged worktops, stainless steel sink unit with single drainer and mixer tap, uPVC double glazed window to rear, uPVC door leading to rear yard

Outside

Low maintenance yard to rear with gated access and WC outbuilding

WC 0.92m (3') x 1.38m (4'6")

Features

- Yard

Contact Us

Harris & Co

18, Poulton Street
Fleetwood
Lancashire
FY7 6LP



Ground Floor

Approx. 67.9 sq. metres (731.4 sq. feet)



HARRIS & CO
ESTATE AGENTS

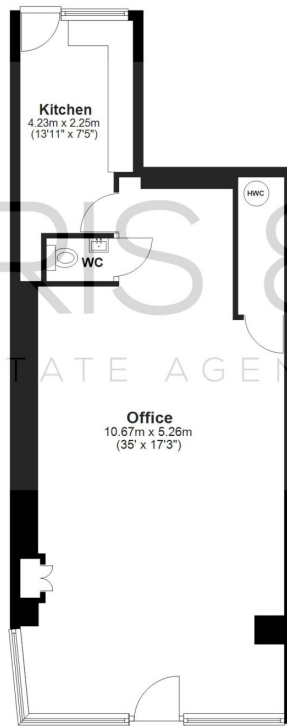

Total area: approx. 67.9 sq. metres (731.4 sq. feet)
15 Poulton Street

Ground Floor

Approx. 67.9 sq. metres (731.4 sq. feet)



HARRIS & CO
ESTATE AGENTS

Total area: approx. 67.9 sq. metres (731.4 sq. feet)

15 Poulton Street