

SOMA SKIN AND LASER

MEDICAL OFFICE SUITE 120

275-277 FOREST AVENUE
 PARAMUS, NJ

GENERAL NOTES:

1. THE GENERAL CONTRACTOR WILL COMPLETE AND SUBMIT THE REQUIRED APPLICATION FORMS ALONG WITH THE CONSTRUCTION DOCUMENTS TO THE PARAMUS BUILDING DEPARTMENT FOR APPROVAL AND OBTAIN ALL REQUIRED PERMITS AND PAY THE APPLICABLE FEES PRIOR TO THE START OF THE WORK.
2. THE GENERAL CONTRACTOR SHALL VERIFY ALL DIMENSIONS AND CONDITIONS AT THE SITE AND REPORT ANY DISCREPANCIES TO THE ARCHITECT PRIOR TO THE START OF THE WORK.
3. G.C. SHALL MAINTAIN COMPLETE UP TO DATE DRAWINGS AT THE JOB SITE AT ALL TIMES.
4. THE G.C. SHALL RESTORE TO VALUES SPECIFIED IN APPLICABLE CODES THE INTEGRITY OF EXISTING FIRE RATED PARTITIONS AND THE FIRE PROTECTION OF STRUCTURAL MEMBERS IF THEY ARE DAMAGED DURING CONSTRUCTION.
5. ALL DIMENSIONS SHALL BE FINISHED SURFACE TO FINISHED SURFACE UNLESS OTHERWISE INDICATED.
6. ALL MATERIALS AND METHODS SHALL COMPLY WITH BOCA AND NUCC REQUIREMENTS AND ALL LOCAL AGENCIES HAVING JURISDICTION.
7. THE GC WILL COORDINATE WITH THE TENANT FOR THE TENANT'S EQUIPMENT REQUIREMENTS AND PROVIDE HVAC ENGINEERING DESIGN WHICH CONFORMS WITH ALL APPLICABLE CODES.
8. ALL PERTINENT NATIONAL, STATE, LOCAL AND MUNICIPAL CODES AND APPLICABLE OSHA LAWS AND REGULATIONS SHALL BE ADHERED TO AT ALL TIMES BY THE CONTRACTOR.
9. ALL CONTRACTORS SHALL MAINTAIN CONTRACTOR'S LIABILITY, PROPERTY DAMAGE AND WORKSMAN'S COMPENSATION INSURANCE. ALL OPERATIONS SHALL CONFORM TO ALL APPLICABLE FEDERAL STATE AND LOCAL SAFETY REGULATIONS.
10. THE GC SHALL PROVIDE ALL NECESSARY CUTTING AND CHIPPING FOR ALL THE TRADES AND ALL PATCHING, REFINISHING, ETC. ARISING FROM WORK IN THE CONTRACT AREAS.
11. THE GENERAL CONTRACTOR IS TO PROVIDE BARRICADES, COVERINGS OR OTHER TYPES OF PROTECTION NECESSARY TO PREVENT DAMAGE TO THE EXISTING SPACE AND AREAS BEYOND THE CONTRACT LIMITS.
12. PROVIDE ALL REMOVALS NECESSARY FOR ALL TRADES WHICH ARE REQUIRED FOR THE DESIGN INTENT AS INDICATED IN DRAWINGS.
13. SHOULD ANY ERROR OR OMISSION EXIST ON DRAWINGS WHICH THE CONTRACTOR MIGHT REASONABLY BE EXPECTED TO DETECT, THE SAME SHALL BE BROUGHT TO THE ATTENTION OF THE ARCHITECT FOR HER CORRECTION PRIOR TO PROCEEDING WITH THE WORK INVOLVED. ALL DIMENSIONS AND CONDITIONS SHALL BE VERIFIED IN THE FIELD BY THE CONTRACTOR.

PARTITION NOTES:

1. WHEREVER A FIRE RESISTANCE CLASSIFICATION IS SHOWN INVOLVING GYPSUM WALL BOARD, PROVIDE MATERIALS, ACCESSORIES AND APPLICATION PROCEDURES PROCEDURES WHICH HAVE BEEN LISTED BY U.L. (OR TESTED) TO ACHIEVE THE RATING REQUIRED.
2. PROVIDE CONSTRUCTION OF GYPSUM BOARD PARTITIONS: TAPED AND SPACKLED AND READY FOR INSTALLATION OF DESIRED FINISHES.
3. INSTALL METAL STUDS AND COMPONENTS IN ACCORDANCE WITH MANUFACTURERS INSTRUCTIONS. PROVIDE ADDITIONAL FRAMING AND BLOCKING AS REQUIRED TO SUPPORT THE WALLBOARDS AT OPENINGS (DOORS) AND PROVIDE ADDITIONAL SUPPORT FOR ALL BUILT-IN ANCHORAGE AND ATTACHMENT DEVICES FOR OTHER WORK. THE G.C. IS TO COORDINATE FOR THE LOCATIONS OF ALL THE WORK REQUIRING ADDITIONAL SUPPORT.
4. WHERE APPLICABLE AT CONDITIONS LABELED "ALIGN" COVER FACE OF EXISTING COLUMNS OR WALLS WITH GYPSUM WALL BOARD LAMINATED TO (OR ON FURRING) COVER DISSIMILAR SURFACES AND PROVIDE A SMOOTH CRACK FREE SURFACE.
5. BREAK ROOM AND CABINET REQUIREMENTS:
 SEE ELEVATIONS FOR ADDITIONAL INFORMATION:
 2'-0" DEEP LOWER CABINET WITH ADJUSTABLE SHELVES AND DOORS AND 36" AFF F.F. COUNTERTOP (CORIAN/SOLID SURFACE)
 1'-0" DEEP UPPER CABINETS WITH ADJUSTABLE SHELVES AND DOORS PLASTIC LAMINATE APPLIANCES TO BE SUPPLIED BY TENANT INSTALLED BY CONTRACTOR/

DOOR NOTES:

1. THE G.C. IS TO COORDINATE, SUPPLY AND INSTALL ALL DOORS AND DOOR HARDWARE IN ACCORDANCE WITH THE NUCC/BOCA, ANSI (ADA) AND ALL APPLICABLE CODES.
- DOOR HARDWARE NOTES:
 1. COMPLY WITH THE APPLICABLE REQUIREMENTS FOR ALL DOOR HARDWARE TO CONFIRM WITH ANSI AND UL LISTED AND LABELED FOR RATINGS (WHERE APPLICABLE) FOR FIRE RATE DOORS IN COMPLIANCE WITH THE NEW NFPA 80.
 2. SUPPLY NEW LEVER HANDLE DOOR HARDWARE (ADA COMPLIANT) AS PER HARDWARE SCHEDULE TO MATCH EXISTING. ALL NEW DOORS TO EXTERIOR TO HAVE MATCHING BUILDING STANDARD LOCKSETS.
 3. PROVIDE ALL HARDWARE AND INSTALLATION IN COMPLIANCE WITH ALL NUCC AND ADA CODE REQUIREMENTS FOR COMPLETE DOOR OPERATION, INCLUDING BUT NOT LIMITED TO DOOR STOPS, KICK PLATES, SILENCERS AND CLOSERS, ETC.
 4. COORDINATE WITH TENANT ALL KEYPAD AND SUBMASTER KEYPAD DOORS LOCKS TO SUITE.

P2
 1.
 BC
 PF
 RE
 2.
 AN
 3.
 IN
 SL
 FC
 G.
 SL
 4.
 CC
 CC
 5.
 SE
 2-
 CC
 1-
 AF
 DC
 1.
 IN
 DC
 1.
 CC
 FC
 2.
 SC
 BL
 3.
 AC
 LP
 4.

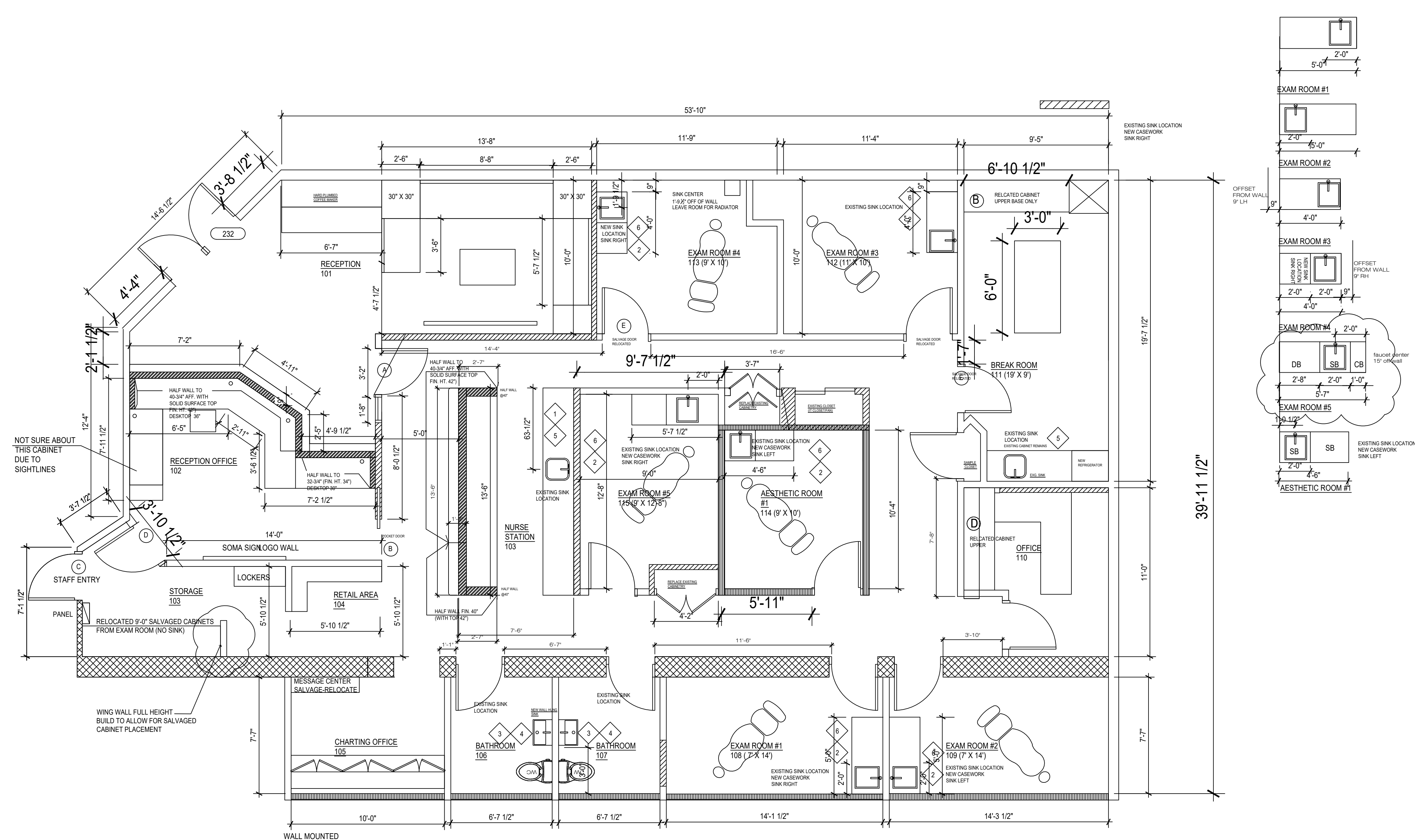

PARTITION PLAN SUITE #125
 SCALE: 1/4" = 1'-0"

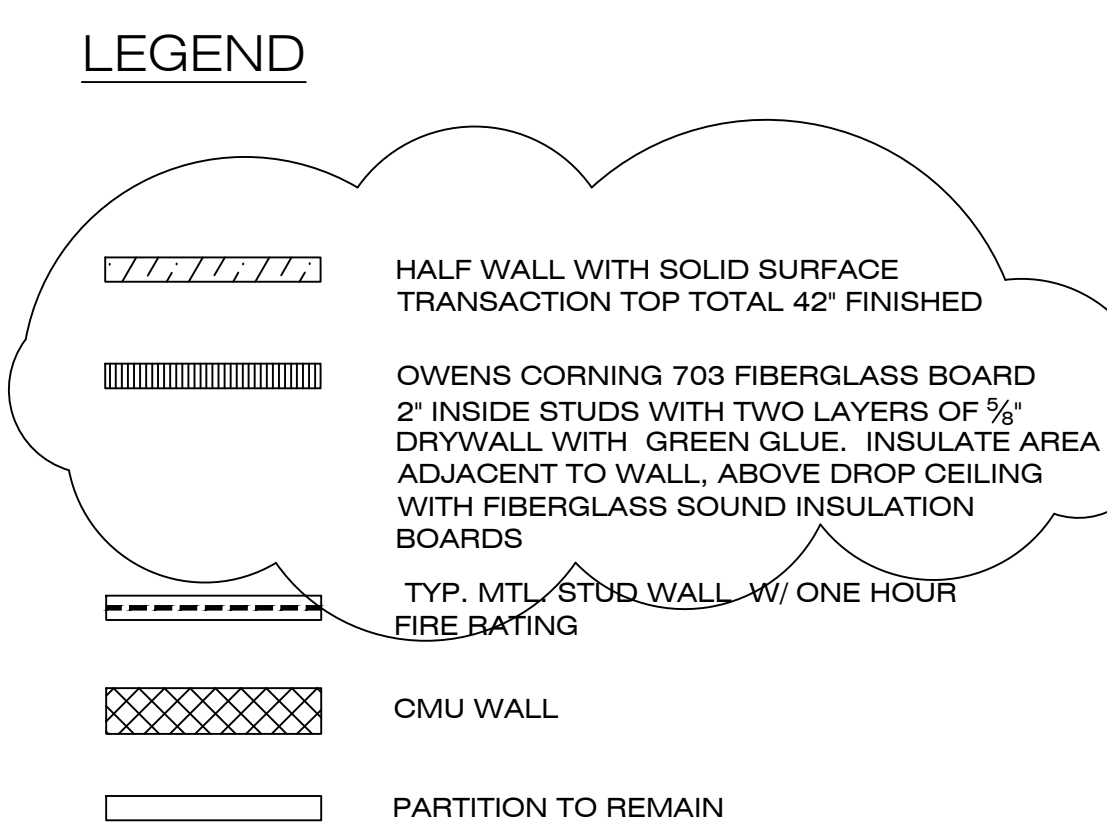

DOOR SCHEDULE						
TYPE	SIZE	MATERIAL	FRAME	LOCKSET	COLOR	
A	3' X 7'-0" (18" SIDELITE)	FROSTED GLASS DOOR WITH SIDELITE WITH SOMA LOGO		AUTOMATIC CLOSER/ BAR PULL HARDWARE	CHROME	
B	3'-0" X 6'-8"	TWO PANEL RECESSED DOOR POCKET DOOR		Krosswood Doors 15 in. x 80 in. Craftsman Shaker Primed MDF 2-Panel Right-Hand Wood Single (SAB NOT PREHUNG) POCKET		
C	3' X 7'-0" NEW DOOR BY BUILDING	EXISTING DOOR WARPED REPLACE WITH SOLID CORE PAINT GRADE				
D	3' X 7'-0"	STORAGE-USE SALVAGE DOOR		ADA LEVER HANDLE	CHROME	
E	30" X 7'-0"	SALVAGE AND REHUNG DOOR		ADA LEVER HANDLE	CHROME	

FIXTURE SCHEDULE						
NO.	DESCRIPTION	MANUFACTURER	FINISH	SIZE	LOCATION	NOTES
1	SINKS FOR NURSES STATION	Menajour	White	15" x 17"	Nurses Station	
2	ELECTRONIC FAUCETS FOR EXAM RM.	American Standard	Brushed Nickel	6056, 163	Exam Rooms	
3	WALL HUG LAV FOR BATHROOM	Narmco	White	19.88" W X 15.2"	Bathroom	
4	FAUCET FOR BATHROOM	Frimo	Brushed Nickel	Single Handle Waterfall Bathroom Vanity Faucet	Bathroom	
5	FAUCET FOR BREAKROOM AND NURSES STATION	Commlen	Brushed Chrome	Commercial Single Handle	Breakroom and Nurses Station	
6	SINKS FOR EXAM ROOMS	Commlen	Brushed Chrome	Commercial Single Handle	Exam Rooms	