

17577

METZLER LANE, HUNTINGTON BEACH, CA

± 6,059 SF INDUSTRIAL BUILDING ON A ± 22,562 SF LAND
PARCEL WITH LARGE FENCED YARD



FOR LEASE

Voit
REAL ESTATE SERVICES

BC
BOUMA CAPUTO

BUILDING ADDRESS	17577 Metzler Lane, Huntington Beach, CA
BUILDING SIZE	± 6,059 SF
OFFICE SIZE	± 1,492 SF Two-Story HVAC Office
LAND SIZE	± 22,562 SF
WAREHOUSE CEILING CLEARANCE	± 17' - 21.5'
POWER	400 Amps, 277/480 Volt (Tenant to Verify)
PARKING	13 Striped Spaces
YARD	Large Secured Fenced Yard
PARCEL NUMBER	165-392-15
GROUND LEVEL DOORS	Three (3) - 18' x 16' One (1) - 16' x 12' One (1) - 10' x 12'
FIRE SPRINKLERS	Fire Sprinklers
FEATURES	Large truck doors, high-clearance, drive-in access, open bay warehouse area and over head cranes. Well suited for servicing large equipment, trucks, vehicles, etc. (Tenant must independently verify its intended use is allowed under the current zoning)
LOCATION	Excellent Central Huntington Beach location along the Gothard Street Industrial Corridor



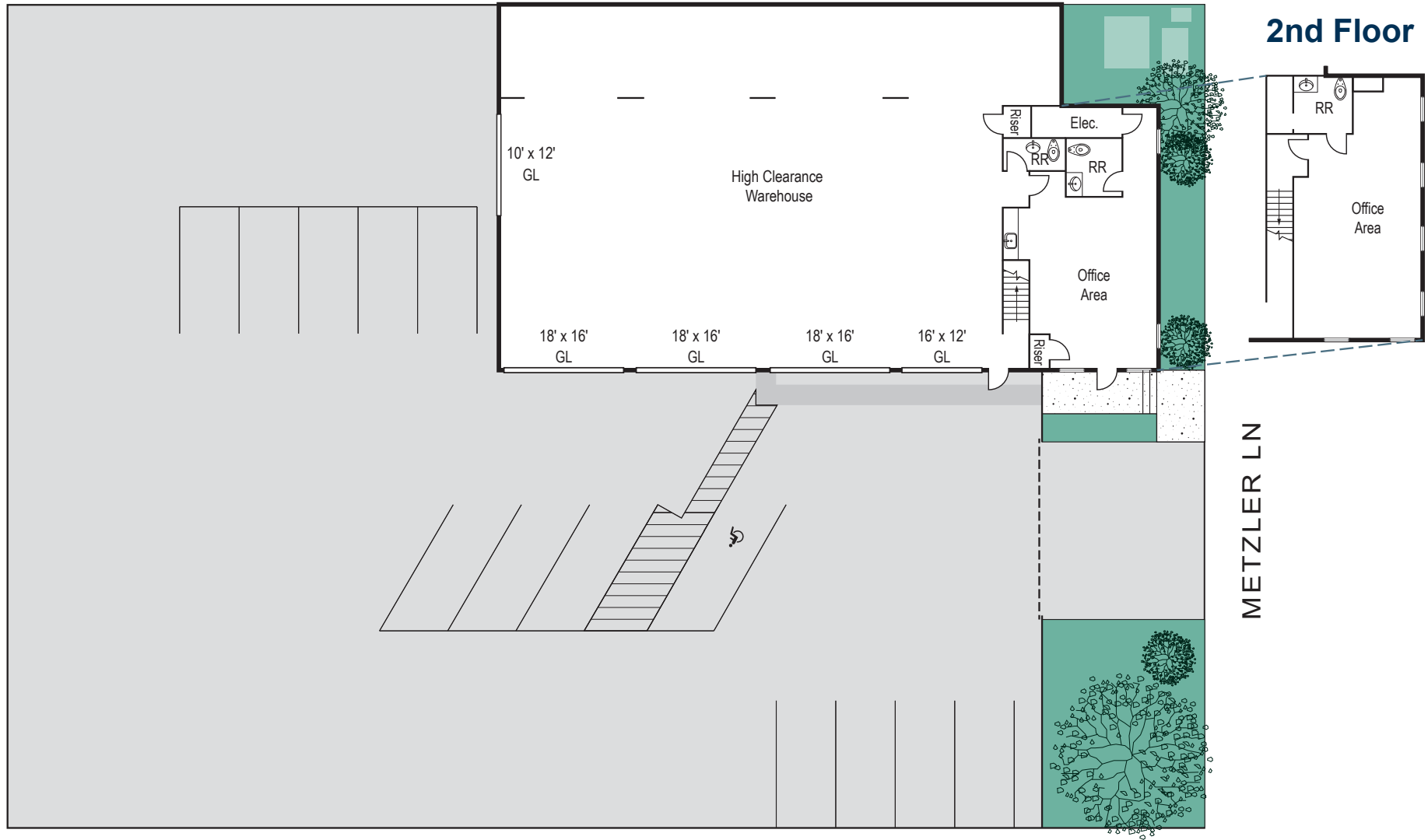

Site plan not to scale.

17577

METZLER LANE, HUNTINGTON BEACH, CA

± 6,059 SF INDUSTRIAL BUILDING ON A 22,562 SF PARCEL WITH LARGE FENCED YARD

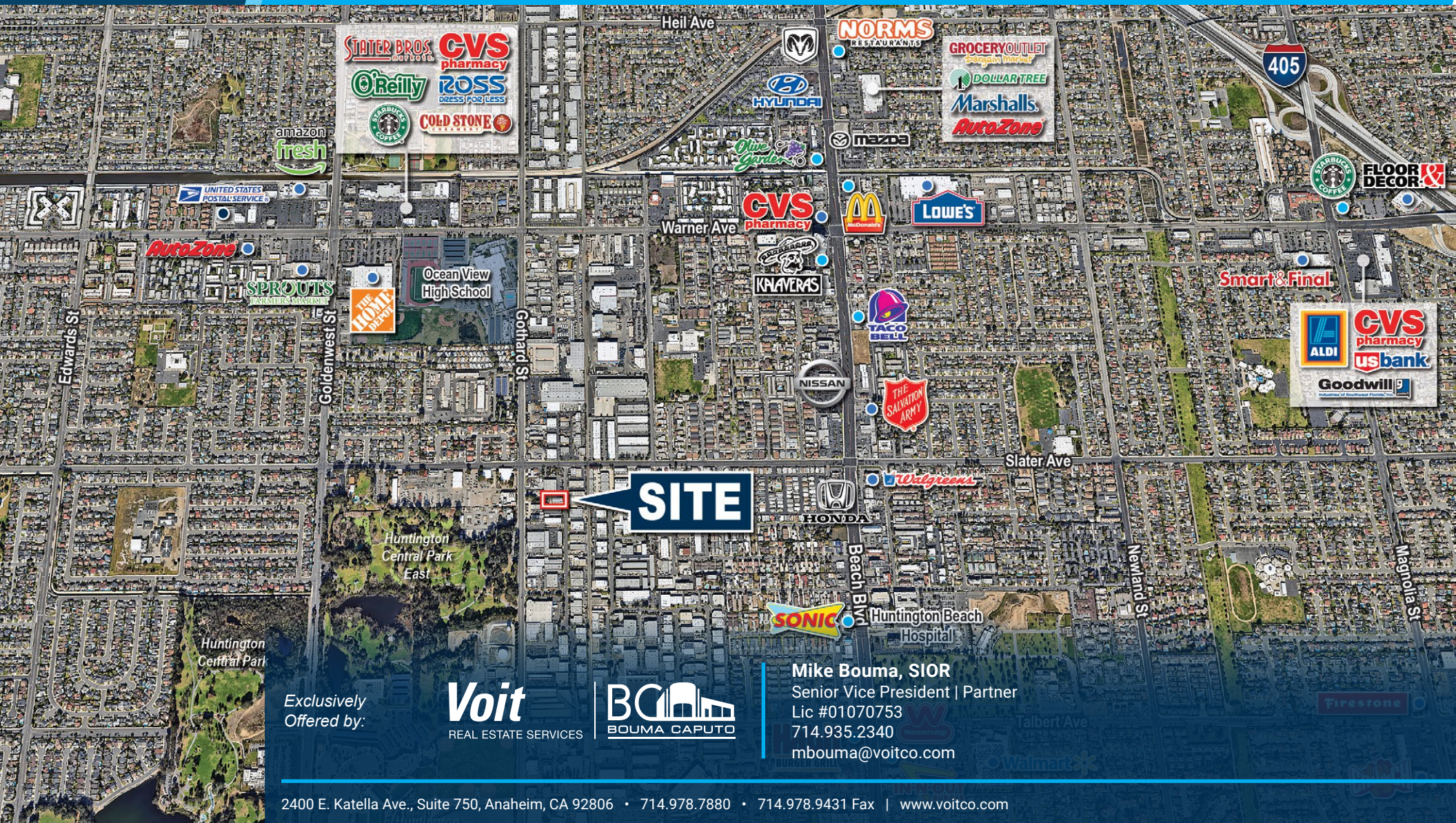

Exclusively Offered by:

Voit
REAL ESTATE SERVICES

BOUMA CAPUTO

Mike Bouma, SIOR
Senior Vice President | Partner
Lic #01070753
714.935.2340
mbouma@voitco.com

2400 E. Katella Ave., Suite 750, Anaheim, CA 92806 • 714.978.7880 • 714.978.9431 Fax | www.voitco.com