

FOR SUBLEASE

CBRE



460 YONGE STREET
Toronto, Ontario

**17,387 SF OF
AVAILABLE AREA**

LIZ NUCCI

Sales Representative*

Senior Vice President
CBRE Limited | Advisory and Transaction Services
416 887 8704
liz.nucci@cbre.com

SHAYLA ESAKOV

Sales Representative
CBRE Limited | Advisory and Transaction Services
647 965 6966
shayla.esakov@cbre.com

FOR SUBLEASE

460 YONGE STREET, TORONTO, ONTARIO

BRING YOUR PROGRAMS TO LIFE IN A SPACE DESIGNED FOR CREATIVITY AND CONNECTION.

460 Yonge Street puts your school at the center of Toronto's dynamic education hub, with modern classrooms, breakout areas, and unbeatable transit access. Surrounded by cafés, shops, and cultural hotspots, this is where learning meets lifestyle.

PROPERTY DETAILS

AVAILABLE AREA 17,387 SF

RENT: Call/Email Shayla & Liz

ADDITIONAL RENT \$20.91 per sq. ft. (2025 est)

FURNITURE To be confirmed

AVAILABILITY June 2026

EXPIRY DATE March 30, 2031

PARKING

No designated parking stalls for the premises.
Public parking is available and managed by Impark.
Additional parking options nearby (College Park, municipal lots).

LOCATION

460 Yonge Street is in the heart of Downtown Toronto, just north of Yonge and College. With excellent frontage on Yonge Street and a one-minute walk to College Station and the 506 Carlton streetcar, the building offers unmatched connectivity. Steps from Yonge-Dundas Square and the Eaton Centre—Toronto's busiest retail and entertainment destinations—this location guarantees high visibility and foot traffic.

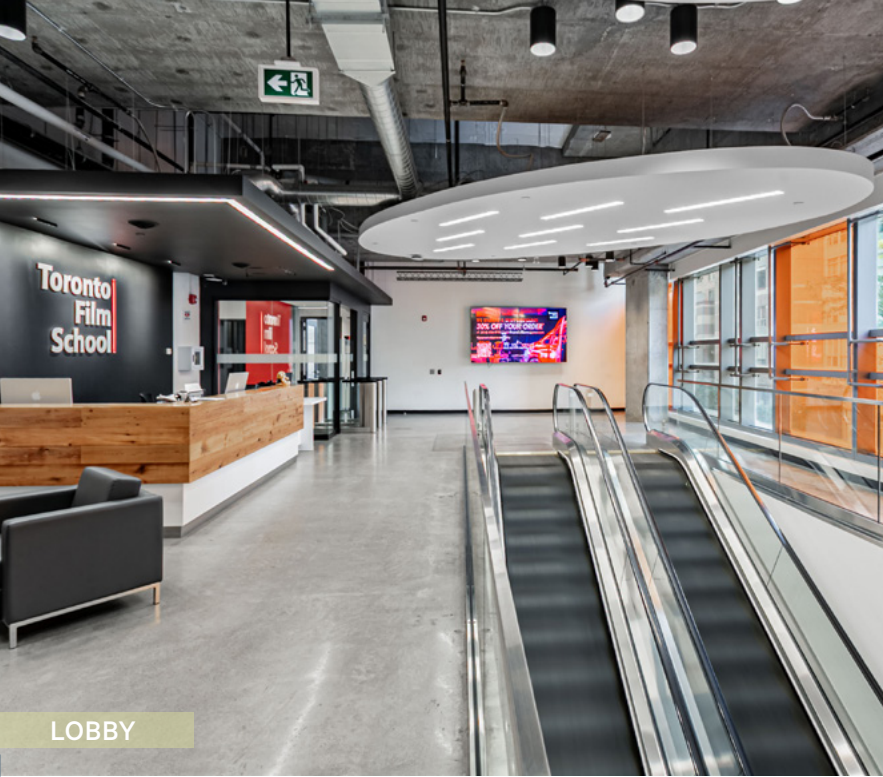

LOBBY



CLASSROOM



CLASSROOM / STUDIO



OFFICE



STAFF ROOM

SUITE FEATURES



CLASSROOMS + STUDIOS

Ideal for training and creative programs



STUDENT LOUNGE

Comfortable space for learners



INDUSTRY-GRADE EQUIPMENT ROOMS

Perfect for media or tech programs

FOR SUBLEASE

460 YONGE STREET, TORONTO, ONTARIO

FLOOR PLAN

Floor plan not to scale.

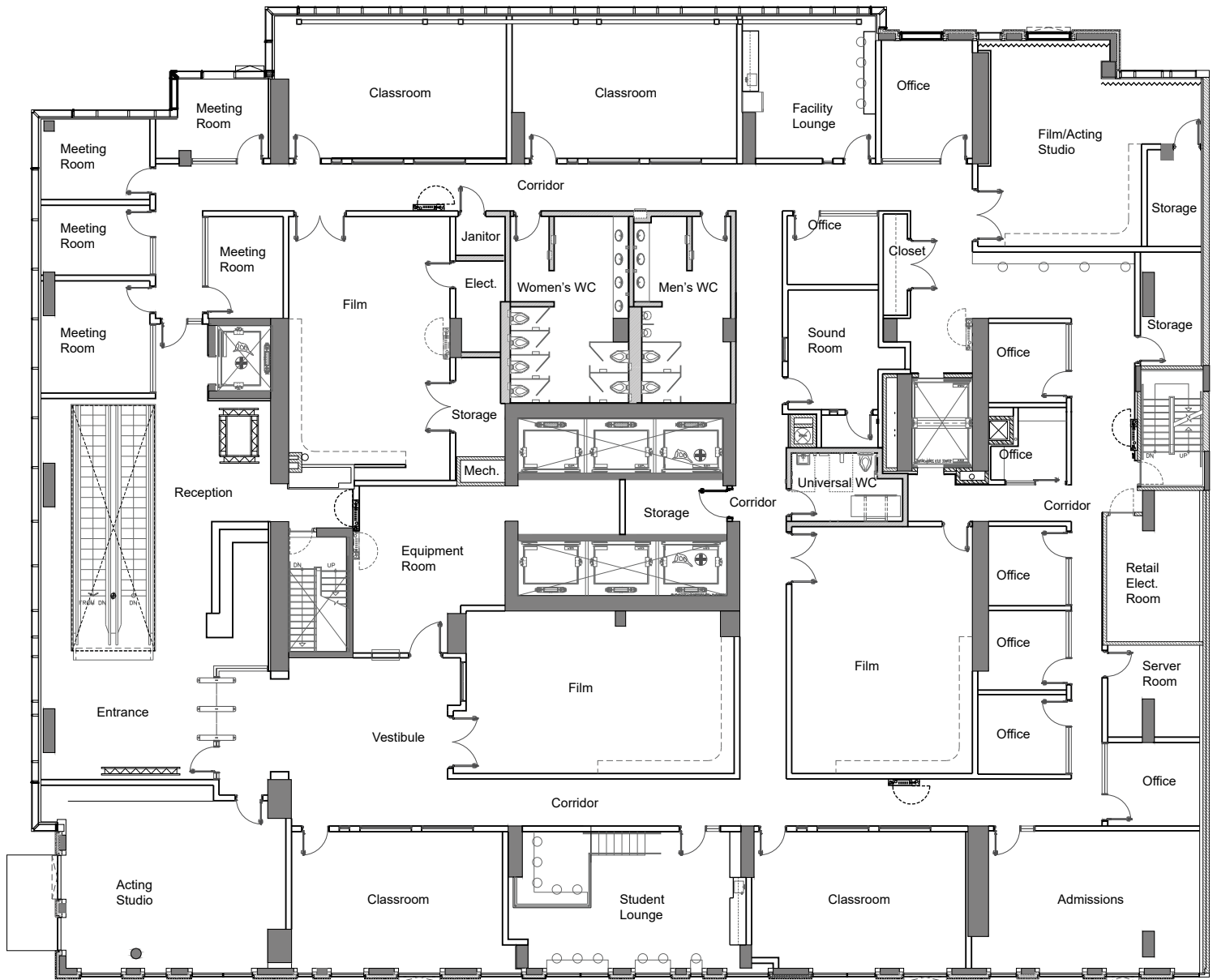



PROPERTY HIGHLIGHTS

UNMATCHED CONNECTIVITY

- + 1-minute walk to College Station
- + Direct access to TTC bus routes (97 Yonge, 94 Wellesley, 506 Carlton)

THRIVING BUSINESS HUB

- + Located in the Bay Street Corridor, home to corporate offices, educational institutions, and creative industries.

AMENITIES AT YOUR DOORSTEP

- + Steps from College Park, Eaton Centre, and hundreds of retail shops and restaurants. Nearby parks include: Alexander Street Parkette and James Canning Gardens.



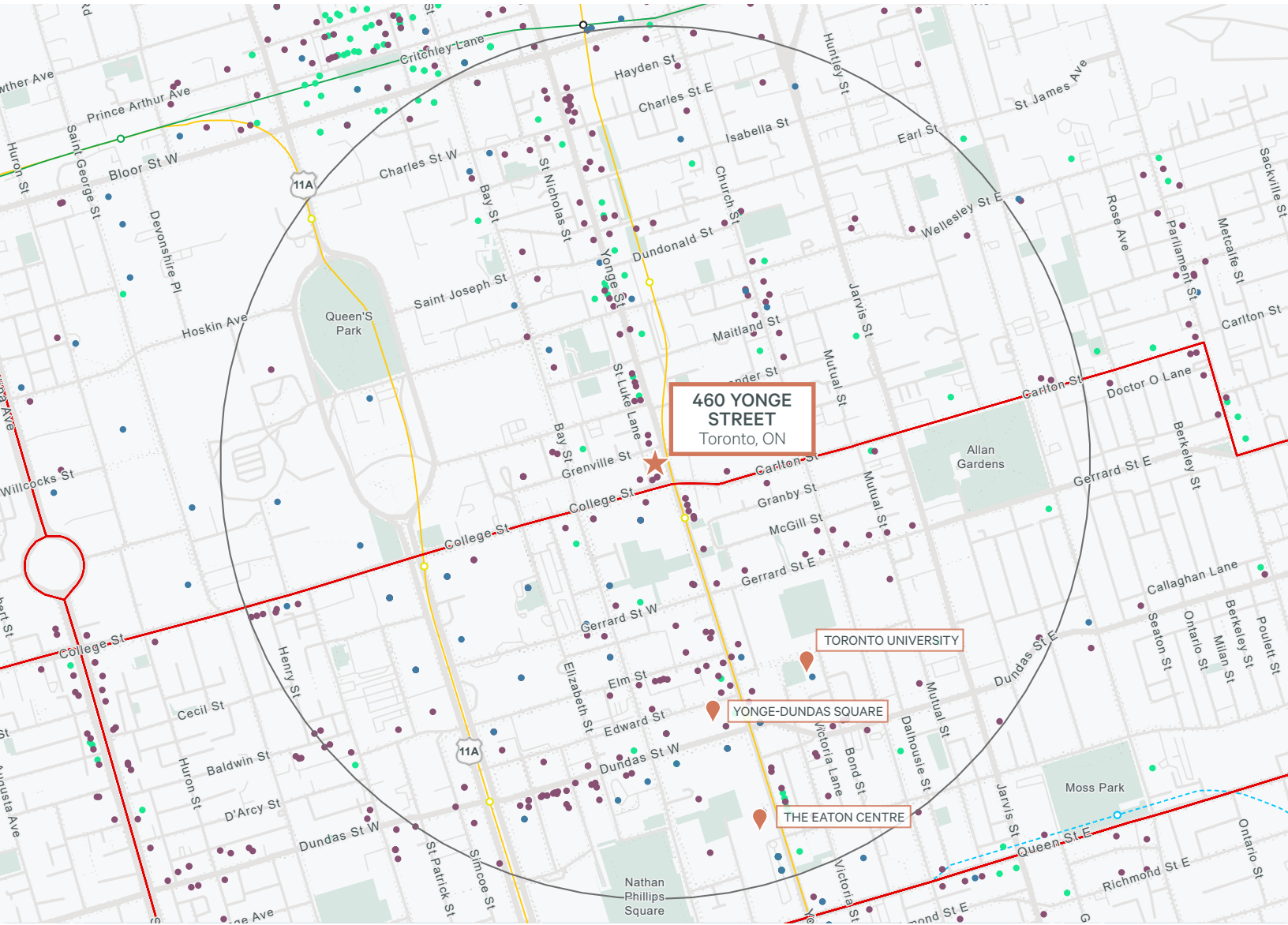

NEIGHBOURHOOD STATS

5KM RADIUS

● Restaurants ● Retail ● Coffee Shops



97
Transit Score



95
Bike Score



100
Walk Score

CONTACT

LIZ NUCCI

Sales Representative*

Senior Vice President
CBRE Limited | Advisory and Transaction Services
416 887 8704
liz.nucci@cbre.com

SHAYLA ESAKOV

Sales Representative
CBRE Limited | Advisory and Transaction Services
647 965 6966
shayla.esakov@cbre.com



This disclaimer shall apply to CBRE Limited, Real Estate Brokerage, and to all other divisions of the Corporation; to include all employees and independent contractors ("CBRE"). All references to CBRE Limited herein shall be deemed to include CBRE, Inc. The information set out herein, including, without limitation, any projections, images, opinions, assumptions and estimates obtained from third parties (the "Information") has not been verified by CBRE, and CBRE does not represent, warrant or guarantee the accuracy, correctness and completeness of the Information. CBRE does not accept or assume any responsibility or liability, direct or consequential, for the Information or the recipient's reliance upon the Information. The recipient of the Information should take such steps as the recipient may deem necessary to verify the Information prior to placing any reliance upon the Information. The Information may change and any property described in the Information may be withdrawn from the market at any time without notice or obligation to the recipient from CBRE, CBRE and the CBRE logo are the service marks of CBRE Limited and/or its affiliated or related companies in other countries. All other marks displayed on this document are the property of their respective owners. All Rights Reserved.

Mapping Sources: Canadian Mapping Services canadamapping@cbre.com; DMTI Spatial, Environics Analytics, Microsoft Bing, Google Earth.