

FOR LEASE

2321 Siempre Viva Court, Suite 103,
San Diego, CA 92154



8,585 SF

- High quality flex / industrial building
- Office Configuration: Reception, 3 large private offices
- End Cap of building with ample parking
- Heavy 3 phase power available
- Loading: 5 dock doors, 1 grade level door
- Sprinklered
- Zoning: City of San Diego IBT-1-1 Zone
- Lease Rate: Contact Agent

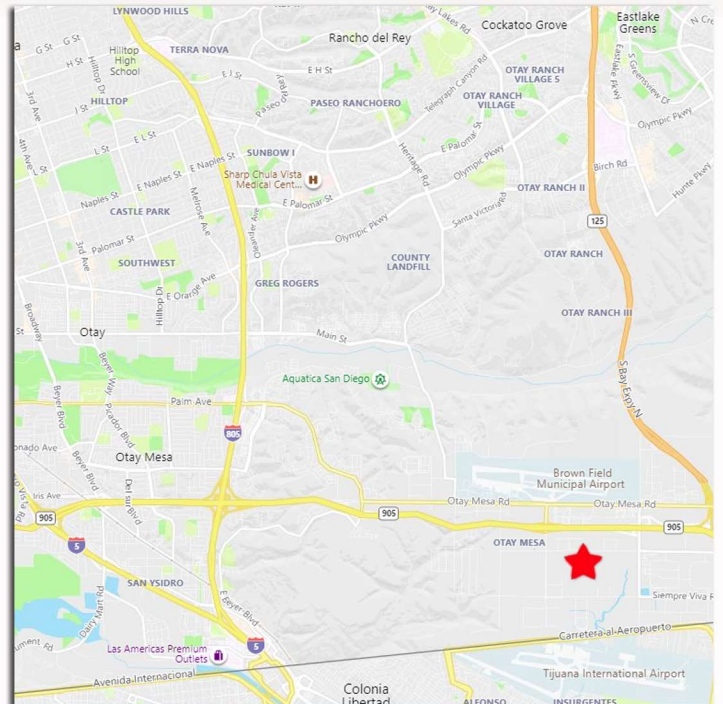

For More Information Contact:

Robbie Cornell
Robbie@tollercornell.com
CA Lic # 01702034

Mick Toller
Mick@tollercornell.com
CA Lic # 01355557

(619) 456-2380



TOLLER CORNELL
COMMERCIAL REAL ESTATE

FOR LEASE

2321 Siempre Viva Court, Suite 103,
San Diego, CA 92154

2321 Siempre Viva Court, Suite 103
San Diego, CA 92154

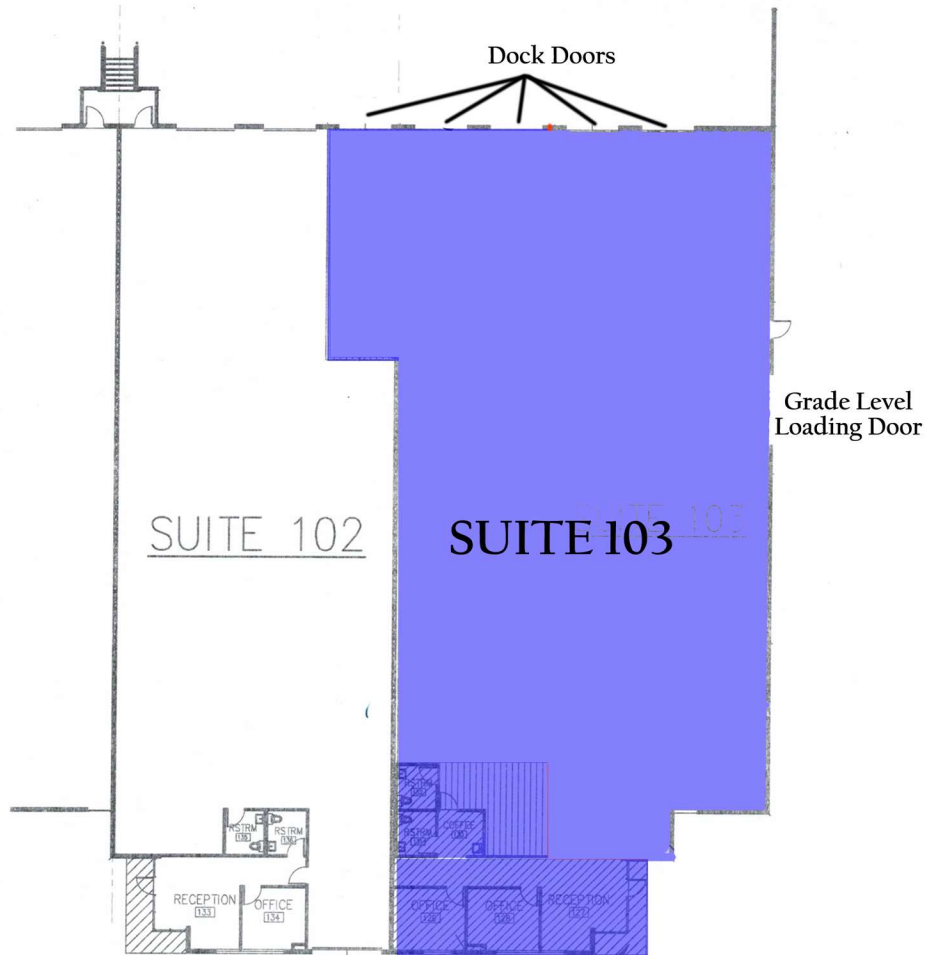

For More Information Contact:

Robbie Cornell
Robbie@tollercornell.com
CA Lic # 01702034

Mick Toller
Mick@tollercornell.com
CA Lic # 01355557

(619) 456-2380



TOLLER CORNELL
COMMERCIAL REAL ESTATE

FOR LEASE

2321 Siempre Viva Court, Suite 103,
San Diego, CA 92154



For More Information Contact:

Robbie Cornell
Robbie@tollercornell.com
CA Lic # 01702034

Mick Toller
Mick@tollercornell.com
CA Lic # 01355557

(619) 456-2380



TOLLER CORNELL
COMMERCIAL REAL ESTATE