



## To Let

### 120-122 Broad Street Mall, Reading RG1 7QA

- First floor unit
- Available long term
- Part of Broad Street Mall Shopping Centre
- Other retailers: Age UK, Post Office, NHS Centre, Bride to Be, The Gym

First floor	3,416 sq ft	Rent:	£43,000 p.a.
Second floor	1,022 sq ft	Est. Service Charge y/e 03/25	£58,177.13 p.a.
TOTAL	4,438 sq ft	Est. Buildings Insurance	£2,405.67 p.a.
ITZA	TBC	Rates payable	£14,720.50 p.a.

For more information please contact Hicks Baker

T: 0118 959 6144 E: [retail@hicksbaker.co.uk](mailto:retail@hicksbaker.co.uk) W: [hicksbaker.co.uk](http://hicksbaker.co.uk)



<b>USE</b>	<b>Class E</b>
<b>TENURE</b>	Leasehold
<b>TERM</b>	A new lease is available direct from the Landlord on terms to be agreed
<b>RATEABLE VALUE</b>	£29,500. For further information on Retail, hospitality and leisure relief, visit - <a href="https://www.tax.service.gov.uk/business-rates-find/search">https://www.tax.service.gov.uk/business-rates-find/search</a>
<b>EPC</b>	C. Expires 16/1/2034
<b>VAT</b>	VAT is payable

**Fiona Brownfoot**

Retail and Leisure

E: [f.brownfoot@hicksbaker.co.uk](mailto:f.brownfoot@hicksbaker.co.uk)

T: +44 (0) 118 955 7083

**Freddie King**

Retail and Leisure

E: [freddie.king@greenpartners.co.uk](mailto:freddie.king@greenpartners.co.uk)

T: +44 (0) 20 7659 4838

Date of publication: April 2024



Transaction



Management



Advice

### Lease code

You should be aware that the Code of Practice on Commercial Leases in England and Wales strongly recommends you seek professional advice from a qualified surveyor, solicitor or licensed conveyancer before agreeing or signing a business tenancy agreement. The code is available through professional institutions and trade associations or through the [website here](#).

### Misrepresentations Act 1967

Hicks Baker for themselves and for the vendors or lessors of this property, whose agents they are give, notice that: 1. The particulars are set out as a general outline only for the guidance of intended purchasers or lessees and do not constitute nor constitute part of an offer or contract. 2. All descriptions, dimensions, reference to condition and necessary permissions for use of occupation, and other details are given without responsibility and any intending purchasers or tenants should not rely on them as statements or representations of fact but must satisfy themselves by inspection or otherwise as to the correctness of each of them. 3. No person in the employment of Hicks Baker has any authority to make or give any representation or warranty whatsoever in relation to this property. Unless otherwise stated the terms exclude VAT.

# Retail Facts

- No. 1 retail destination in the Thames Valley
- Fastest growing economy in the Thames Valley over the last 20 years
- Reading has the 10th highest start up rate in the UK and is home to 13 of the world's top 30 brands
- 6th highest employment rate
- 15m visitors to the town p.a.
- 4th highest average wage in UK
- 1.3 Resident population
- 40,000 office workers
- 612 retail and leisure units

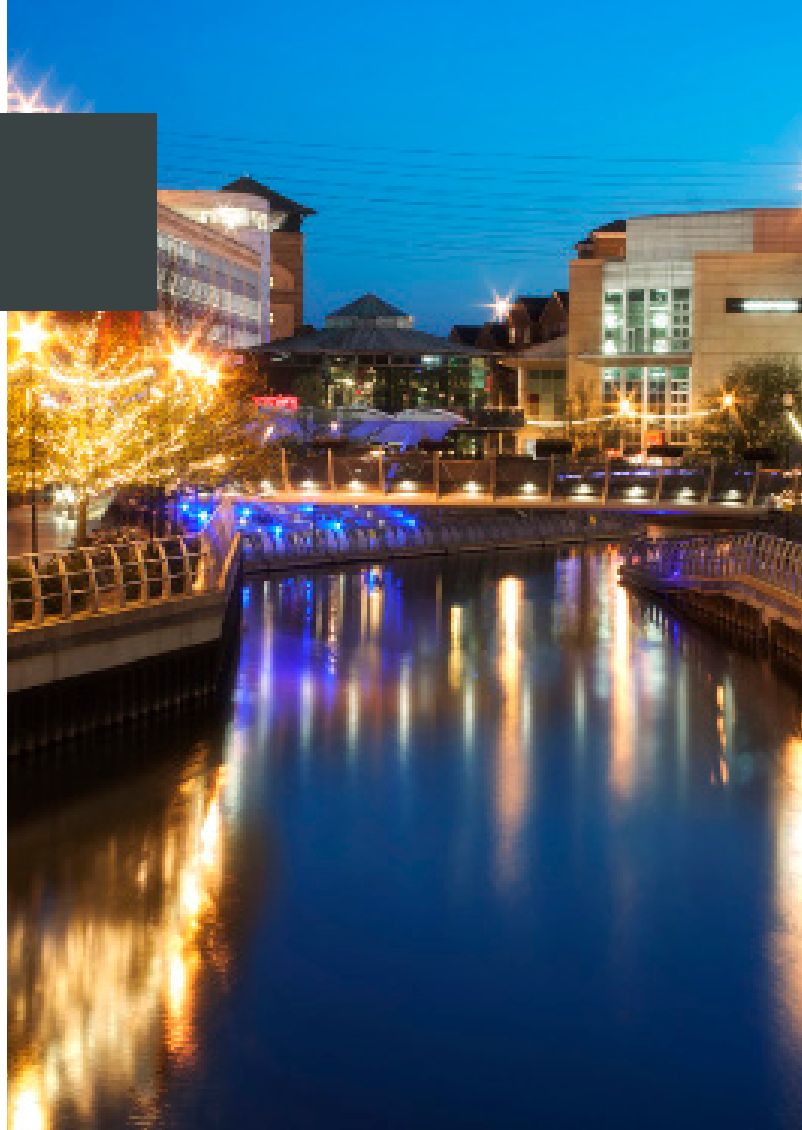

For more information please contact Hicks Baker

T: 0118 959 6144 E: [retail@hicksbaker.co.uk](mailto:retail@hicksbaker.co.uk) W: [hicksbaker.co.uk](http://hicksbaker.co.uk)

## Location Plan

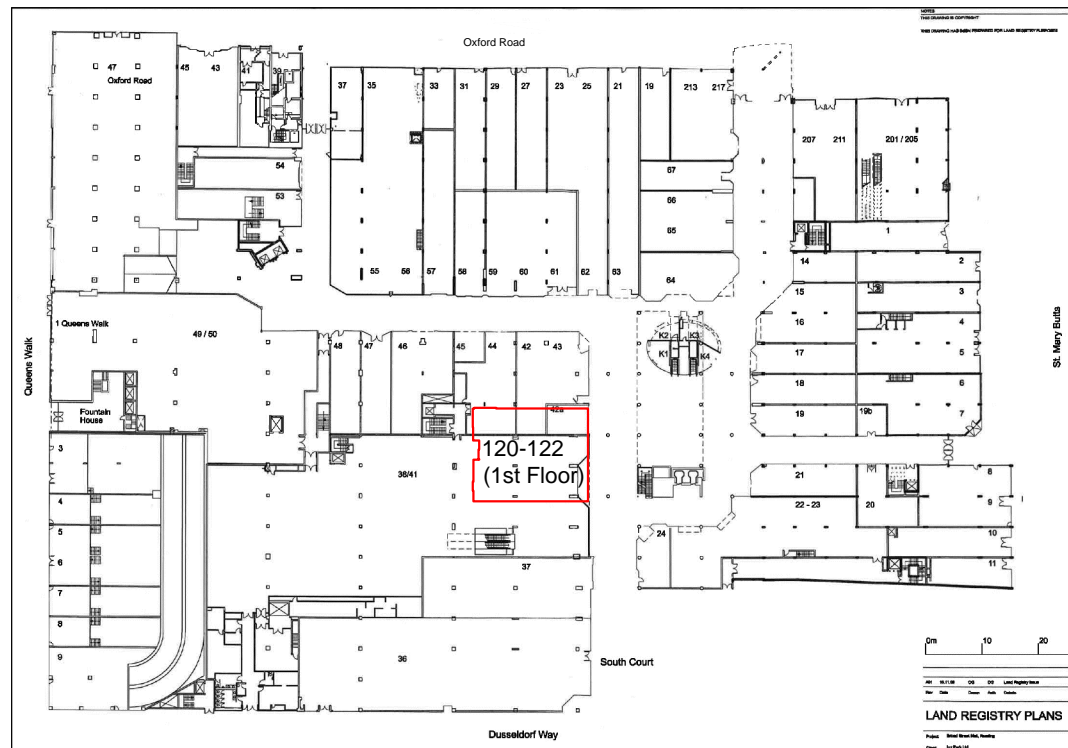

0m 1:1250 Scale Bar 50m

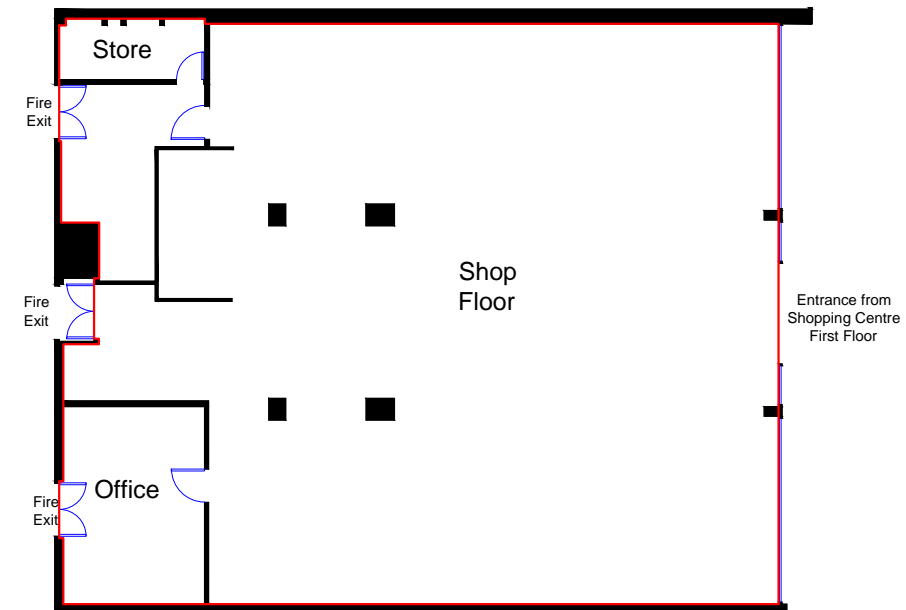

0m 1:200 Scale Bar 10m



### General Notes

#### Areas

##### Net Internal Area

First Level 315.7sqm / 3,398sqft  
**Total NIA** 315.7sqm / 3,398sqft

##### Gross Internal Area

First Level 317.3sqm / 3,415sqft  
**Total GIA** 317.3sqm / 3,415sqft

No.	Revision/Issue	Date
1	Issue	01/04/11

#### Firm Name and Address



#### Project Name and Address

Broadstreet Mall  
 First Floor  
 Reading  
 RG1 7QE

Project 11.02.263	Sheet 120-122 Broadstreet Mall First Floor
Date April 1st 2011	
Scale 1:200 @ A3	



Experian Goad Plan Created: 23/04/2024  
 Created By: Hicks Baker

