

684 Centre Street • Jamaica Plain, Massachusetts



4,522 SF Street Level / 3,818 SF Basement / 540 SF Loft Office Space



4,522 SF Street
3,818 SF Basement
540 SF Loft Office



Available Now



41' Frontage
on Centre Street



Loading in rear
of building



10 Min Walk
to Green
Street Station

Area Tenants



AERIAL & DEMOGRAPHICS



POPULATION

.5 Mile: 9,841
 1 Mile: 34,009
 5 Min Drive: 56,805



DAYTIME POPULATION

.5 Mile: 3,604
 1 Mile: 8,912
 5 Min Drive: 21,913



HOUSEHOLD INCOME

.5 Mile: \$151,722
 1 Mile: \$126,682
 5 Min Drive: \$117,518

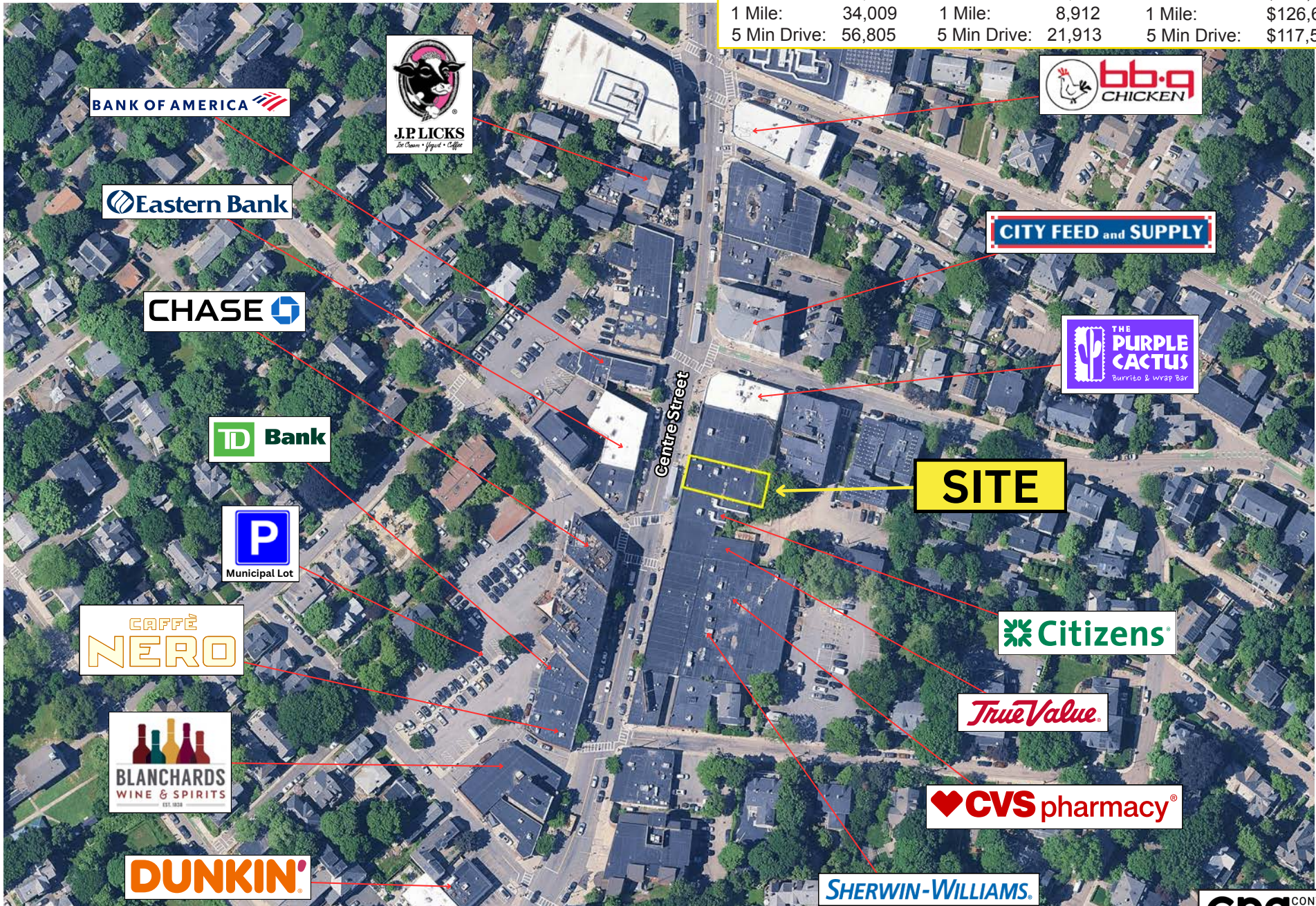

684 CENTRE STREET • JAMAICA PLAIN, MA



FLOOR PLAN*

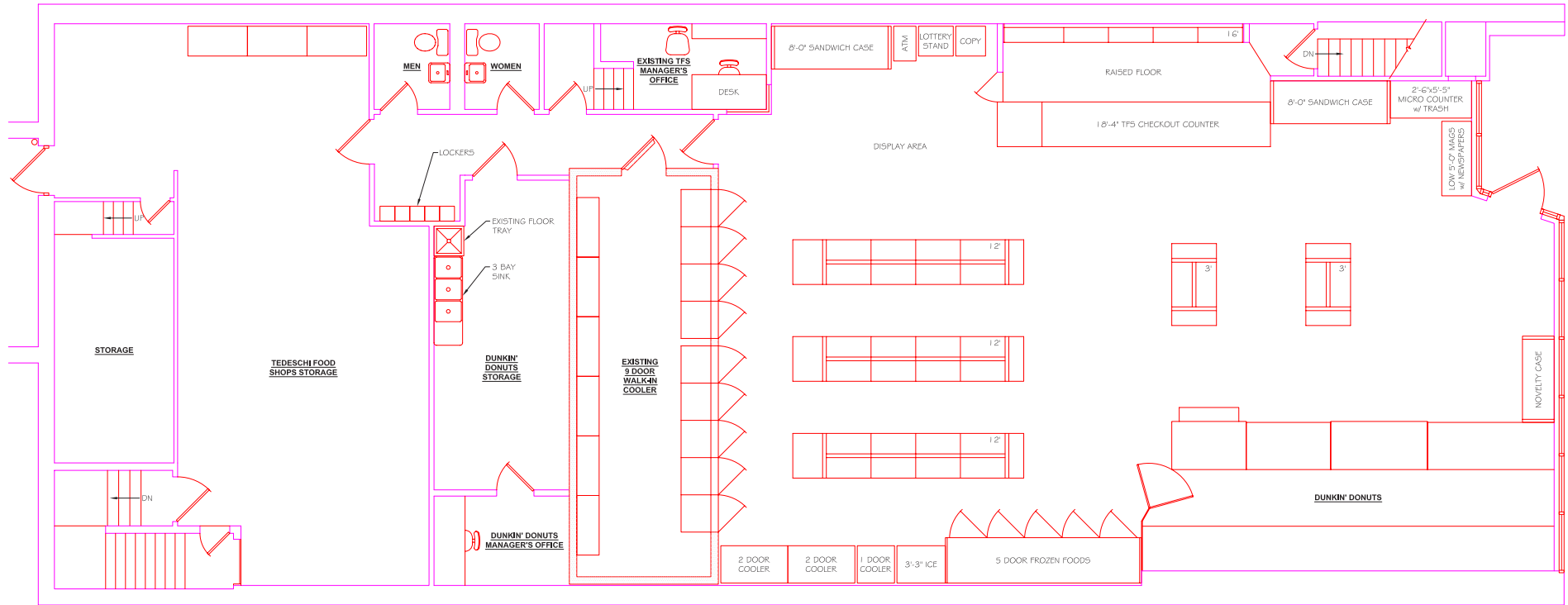

*Floor plan is the build out of the former tenant and may not reflect existing conditions

Find Your Place.

JIM CONVISER
JIM@CONVISERPG.COM
MOBILE: (781) 839-0456

ADAM CONVISER
ADAM@CONVISERPG.COM
MOBILE: (617) 593-1700

PAUL KADIS
PAUL@CONVISERPG.COM
MOBILE: (857) 363-0942



CONVISER PROPERTY GROUP, INC
220 RESERVOIR STREET, SUITE 9 • NEEDHAM, MA 02494
O: (781) 320-0600 • F: (781) 791-4599 • WWW.CONVISERPG.COM

684 CENTRE STREET • JAMAICA PLAIN, MA

