

**GOBLE
PROPERTIES**

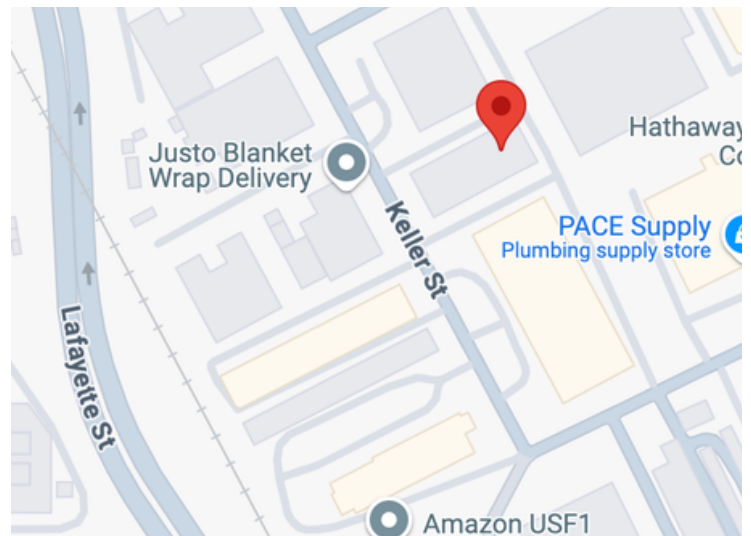

3281 KELLER STREET SANTA CLARA, CA

R&D/FLEX For Lease
6,417 SF



 **GOBLE
PROPERTIES**
GOBLEPROPERTIES.COM

Contact Us
408-452-1754
contact@gobleproperties.com

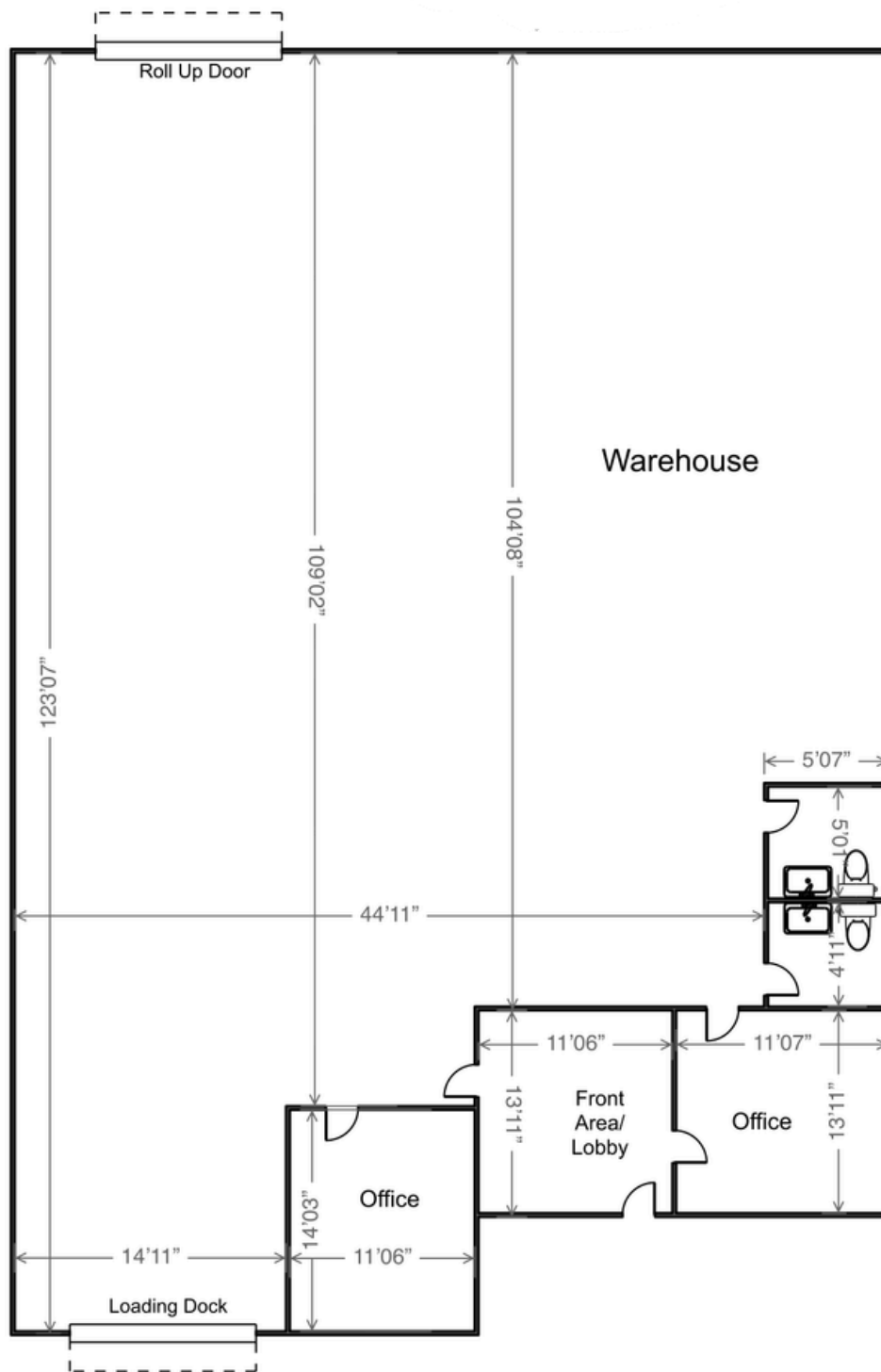

UNIT HIGHLIGHTS

- **Size: 6,417 SF**
- **Amps: 200 *Amperage Cannot Be Increased**
- **Clear Height: 18'07"**
- **Loading: 1 Grade-Level Roll-Up Door and 1 Loading Dock**
- **Office Layout: Front Reception with 2 Private Offices**
- **HVAC: In Office Areas Only**
- **Restrooms: 2 Private Restrooms**
- **Parking: 6 Unreserved Spaces (1:1 Ratio)**



Contact Us

408-452-1754

contact@gobleproperties.com

 **GOBLE**
PROPERTIES