

DeTORRES DeGEORGE LLC

23 VREELAND ROAD, SUITE #204
 FLORHAM PARK, N.J.
 1,402 RENTABLE SQ. FT.
 WWW.23VREELAND.COM

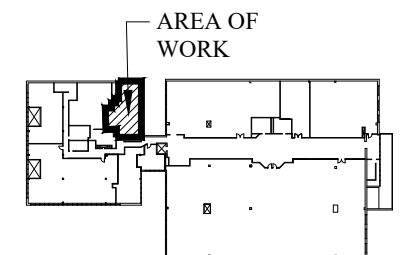
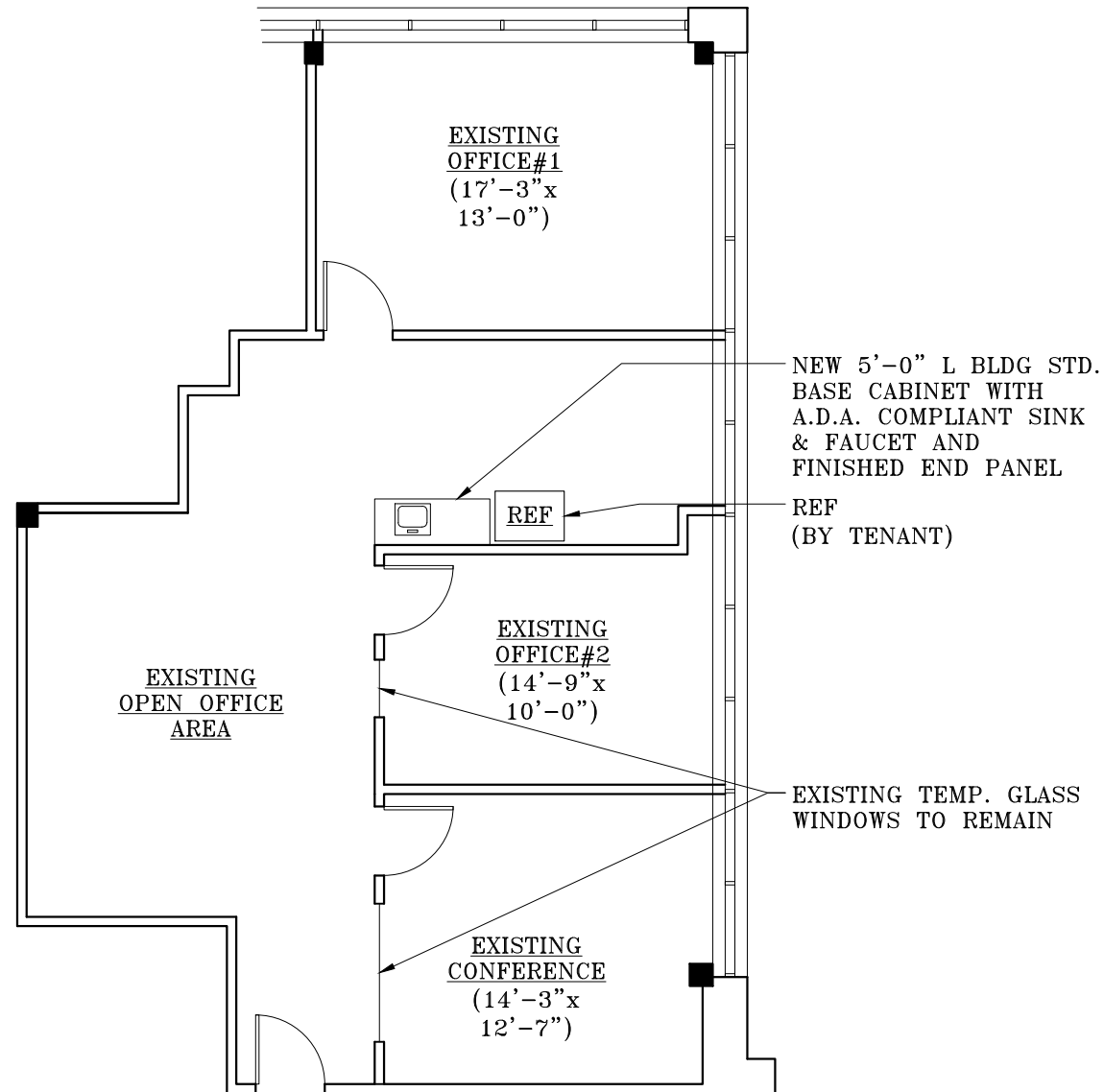

▨ DENOTES TENANT SPACE
 KEY PLAN - SECOND FLOOR
 SCALE : N.T.S.

1.) ALL ROOM SIZES ARE APPROXIMATE.

1 PROPOSED FLOOR PLAN
 SCALE: 1/8"=1'-0"

GENERAL NOTES:

- LANDLORD TO PROVIDE THE FOLLOWING:
 - SPOT PAINTING OF ENTIRE PREMISES (AS REQUIRED)
 - INSTALLATION OF NEW CARPET TILE THROUGHOUT ENTIRE SUITE.
 - REPLACEMENT OF ALL BROKEN CEILING TILES
 - INSTALLATION OF SINK WITH COUNTERTOP AND BASE CABINETS FOR BREAK AREA (AS SHOWN ON PLAN. (TENANT TO HAVE OPTION TO SELECT EITHER CARPET TILE OR VCT AT BREAK AREA).



651 OLD MT. PLEASANT AVE.
 LIVINGSTON, NJ 07039
 TEL: (973) 992-7727
 FAX: (973) 992-3084

EASTMAN
 Management Corporation
 WWW.EASTMANCOMPANIES.COM

WEISS DESIGN GROUP ARCHITECTURE INTERIOR DESIGN	
629 West Mount Pleasant Avenue Livingston, NJ 07039-1609 973.994.9490 Facsimile 973.994.9889 RONALD WEISS, AIA NJ Lic. #10001 NY Lic. #021367	
DeTORRES DeGEORGE LLC 23 VREELAND ROAD, SUITE #204 FLORHAM PARK, NEW JERSEY	
Scale AS NOTED	Drawn By CAS
Date MARCH 11, 2021	Revised
PROPOSED FLOOR PLAN	
SECOND FLOOR - SUITE# 204	Drawing Number SK-1