

1  
A1.1  
DEMOLITION PLAN  
3/16" = 1'-0"

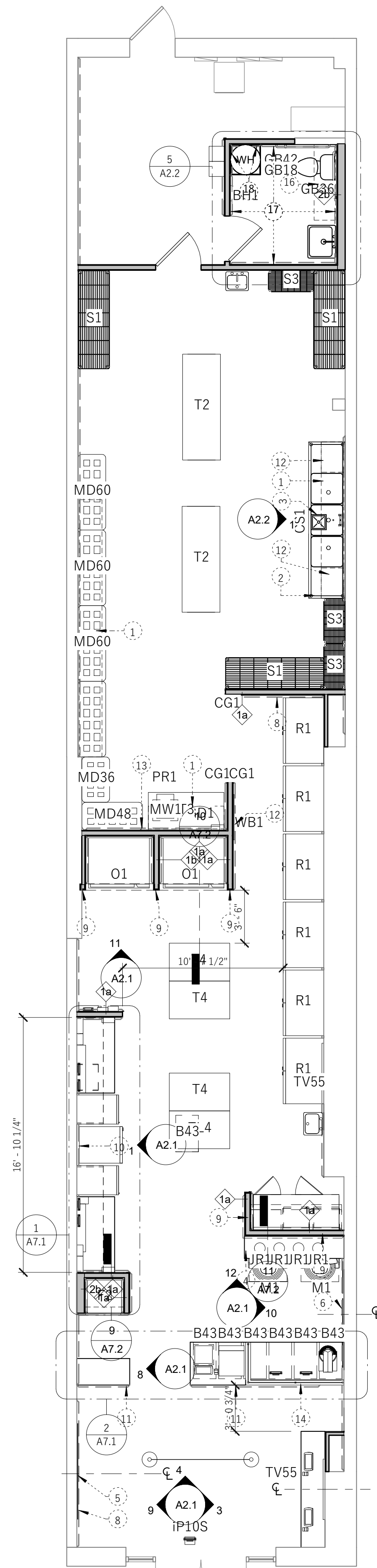

2  
A1.1  
MAIN FLOOR PLAN  
3/16" = 1'-0"

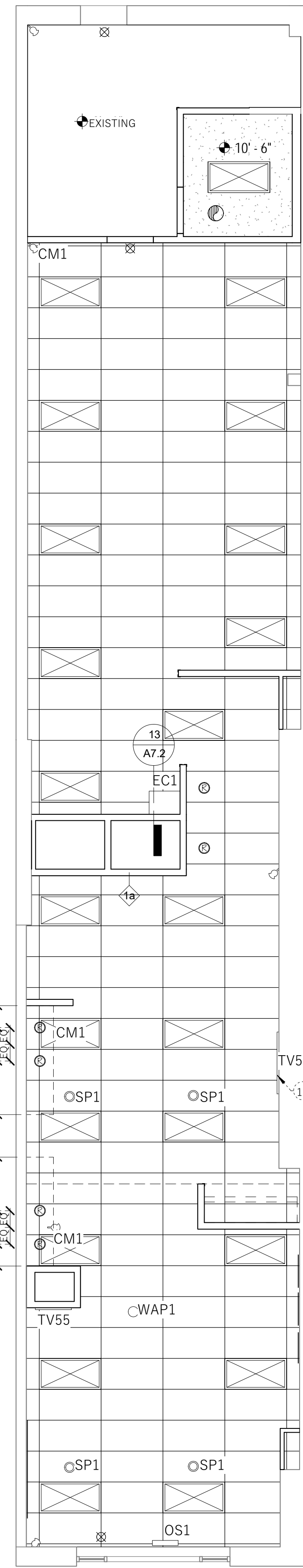

3  
A1.1  
REFLECTED CEILING PLAN  
3/16" = 1'-0"

SYMBOL LEGEND

- ⊙ RECESSED CAN LIGHT FIXTURE
- ⊠ 2 X 4 LED LAY-IN LIGHT
- ⊙ VENTILATION FAN
- ⊠ EXIT SIGN
- ⊠ RETURN AIR
- ⊠ SUPPLY AIR
- ⊠ VENTILATION FAN
- ⊠ 2 X 4 LAY-IN CEILING
- ⊠ GYP. BOARD CEILING
- ⊙ SPEAKER (SEE EQUIPMENT SCHEDULE A6.1)
- ⊙ SECURITY CAMERA (SEE EQUIPMENT SCHEDULE A6.1)
- ⊠ WALL TYPES

WALL TYPES

SEE DETAIL 3/A7.4 FOR SECTION

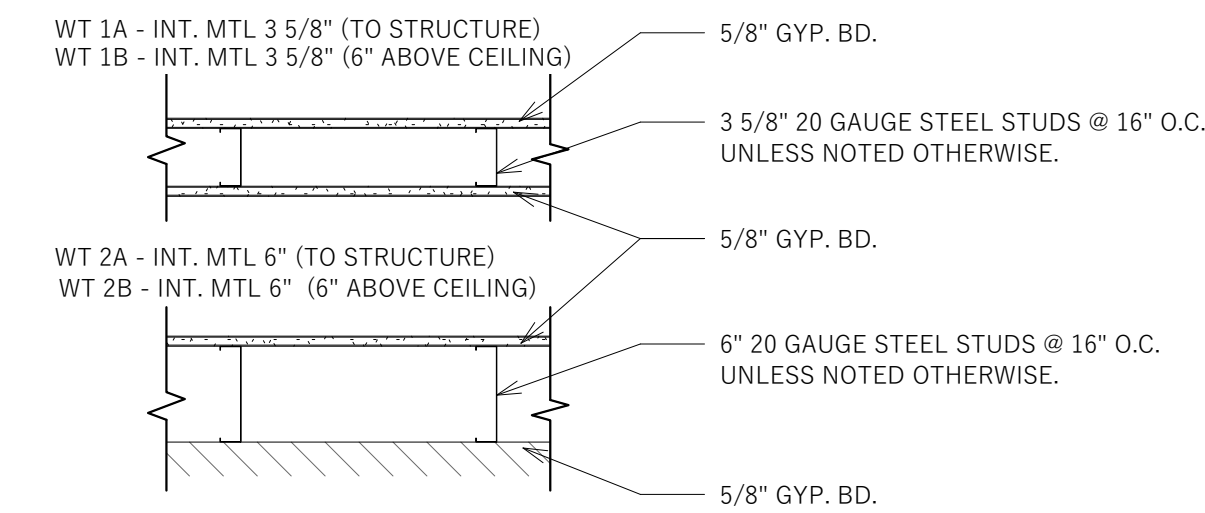

GENERAL NOTES - PLAN

- A COORDINATE ALL MECHANICAL, PLUMBING, & ELEC. DEMOLITION AND/OR REUSE W/OWNER.
- B CONTRACTOR TO DISPOSE ALL DEMOLITION ITEMS AS PER LOCAL CODES & REGULATIONS.
- C UNKNOWN CONDITIONS MAY EXIST. DEMOLITION SHALL BE DONE W/ CARE TO ENSURE THAT THERE IS NO DAMAGE TO UNSEEN COMPONENTS OR MATERIALS THAT MAY NEED TO REMAIN OR BE RELOCATED.
- D ANY PENETRATIONS THROUGH CONCRETE FLOOR SLABS, CONCRETE WALLS, OR CONCRETE COLUMNS WILL NEED TO BE APPROVED BY THE STRUCTURAL ENGINEER OF RECORD FOR THE BUILDING, PRIOR TO COMMENCING WORK.
- E PROVIDE BLOCKING, WHERE APPLIES, IN NEW AND EXISTING WALLS AS NEEDED FOR NEW MILLWORK (COORDINATE WITH MILLWORK CONTRACTORS).
- F FIELD VERIFY ALL DIMENSIONS AND NOTIFY ARCHITECT OF ANY DISCREPANCIES.
- G ALL DIMENSIONS FROM EXISTING WALLS ARE FROM EDGE OF EXISTING WALL FINISH.
- H ALL DIMENSIONS FROM NEW WALLS ARE MEASURED TO EDGE OF STUD.
- I SEE SHEET A 6.1 FOR EQUIPMENT AND FINISH INFORMATION.
- J ALL EXISTING WALL, FLOOR, AND CEILING FINISHES TO BE REMOVED DURING DEMOLITION UNLESS NOTED OTHERWISE.
- K DESIRED CEILING HEIGHT TO BE AS HIGH AS POSSIBLE IF NOT ABLE TO BE PLACED AT 12'-0" AFF AS REQUIRED. GENERAL CONTRACTOR TO FIELD VERIFY EXISTING CONDITIONS.

KEYED NOTES

- 1 18" WIRE WALL MOUNTED STORAGE SHELVING. CONTINUOUS PLYWOOD BACKING BEHIND SHEETROCK. SEE DETAILS.
- 2 NEW 3-COMPARTMENT SINK
- 3 FLOOR SINK. COORDINATE WITH PLUMBING
- 4 SOLID SURFACE FLOATING SHELF. SEE DETAILS
- 5 BAKERHEAD LOGO SIGN. DIMENSIONED TO CENTER LINE. SEE DETAILS FOR SIGNAGE INSTALLATION.
- 6 COOKIE SIGNAGE DIMENSIONED FROM FINISHED WALL FACE TO CENTER LINE. SEE DETAILS FOR SIGNAGE INSTALLATION.
- 7 SEE DETAIL 2/A7.4 FOR SUSPENDED CEILING GRID
- 8 WALL FINISH IP 3
- 9 WALL FINISH WT 1, TO TERMINATE AT T.O. WALL.
- 10 WALL FINISH WC 1 UP TO 6'-6". EXTENDS FROM EDGE OF BOXING STATION TO OVEN WALL.
- 11 WALL FINISH WT 1 ON BACK OF CABINETRY WALL
- 12 WALL FINISH WC 1, UP TO 8'-0" AFF.
- 13 WALL FINISH WC 1 FULL HEIGHT OF WALL.
- 14 FRAMED WALL AT REAR OF CABINETRY; SEE DETAILS ON SHEET A7.1
- 15 55" WALL MOUNTED TELEVISION, BOTTOM OF TV AT 6'-6"
- 16 18" WIRE MOUNTED STORAGE SHELVING ABOVE TOILET WITH 6" - 8" CLEAR BELOW. PROVIDE CONTINUOUS PLYWOOD BACKING BEHIND SHEETROCK. SEE DETAILS.
- 17 WALL FINISH WC 1 IN BATHROOM, UP TO 4'-6" A.F.F.
- 18 WALL FINISH WC 1 UP TO B.O. CEILING ADJACENT TO WATER HEATER.
- 19 EXISTING WALL TO BE REMOVED
- 20 EXISTING PLUMBING FIXTURE TO BE REMOVED
- 21 EXISTING STRUCTURE
- 22 EXISTING DOOR TO BE REMOVED
- 23 EXISTING WALL TO REMAIN
- 24 EXISTING ELECTRICAL PANEL TO REMAIN
- 25 EXISTING TRANSFORMER TO REMAIN

PROJECT NUMBER

21-138

ISSUE DATE:

MAY 18, 2021

REVISIONS:

No.	Date	Description

CONSULTANT

CRUMBL COOKIES - OCEAN

2306 NJ 66  
OCEAN, NJ 07712

DEMOLITION PLAN,  
REMODEL FLOOR  
PLAN & RCP

A1.1

