



1927 Passero Ave

TAMPA, FLORIDA · AVAILABLE NOW

NOW AVAILABLE

PROPERTY TYPE
Commercial

CONDITION
Move-In Ready

PARKING
On-Site

ASKING RATE
Call for Price

PROPERTY HIGHLIGHTS

- Single-tenant commercial building with dedicated on-site parking
- Modern exterior with updated facade and canopied entrance
- Open floor plan — well-suited for office, medical, or service use
- Full kitchen and private restroom on-site
- Three configurable interior zones with partition flexibility
- Mature tree buffer providing privacy and curb appeal
- Prominent frontage with signage opportunity
- Convenient access to major Tampa corridors

IDEAL USES

- Professional / Executive Office
- Medical or Wellness Practice
- Training or Education Facility
- Light Service or Studio Space

FLOOR PLAN

LAYOUT OVERVIEW

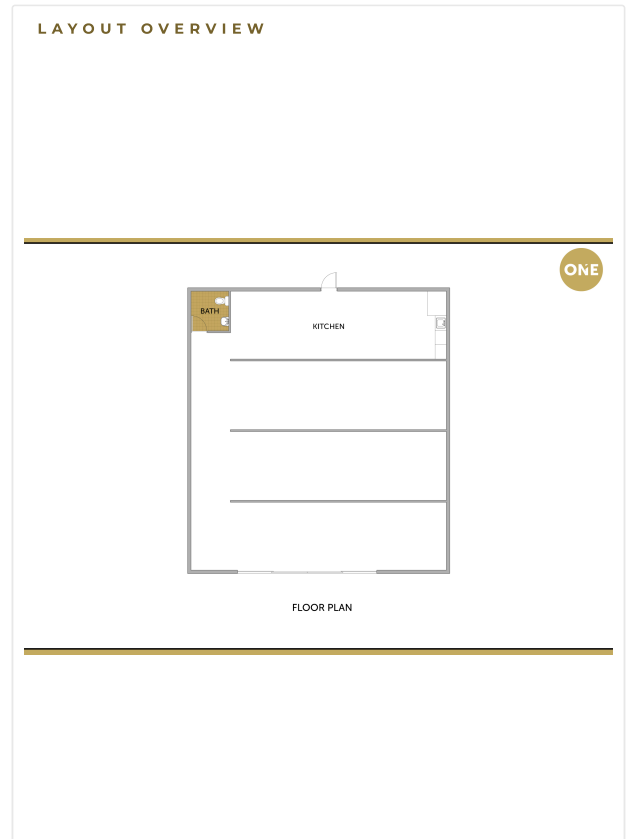

Alex Khoyi

COMMERCIAL REAL ESTATE BROKER

P 727-846-7777

E alex@brokeralex.com

CALL TO VIEW
VIRTUAL TOUR

All information deemed reliable but not guaranteed. Square footage and specifications subject to verification. Offered subject to prior lease or withdrawal.