

FOR LEASE

# CANE RUN PLACE

3220 CRUMS LANE | LOUISVILLE, KY



## INLINE SPACE

NOW AVAILABLE

- + 1,500± to 4,500± square feet available
- + Anchored by Roses
- + Great visibility and access via Crums Ln & Cane Run Rd
- + High traffic intersection
- + Easy access to Interstate 264, located just one mile north
- + Traffic counts: 36,700 CPD on Cane Run Rd;  
12,200 CPD on Crums Lane



## CONTACT US

### Clay Hunt

Vice President  
+1 502 412 7607  
clay.hunt@cbre.com

### Robert Schwartz

Senior Vice President  
+1 502 412 7606  
robert.schwartz@cbre.com

FOR LEASE

# CANE RUN PLACE

3220 CRUMS LANE | LOUISVILLE, KY

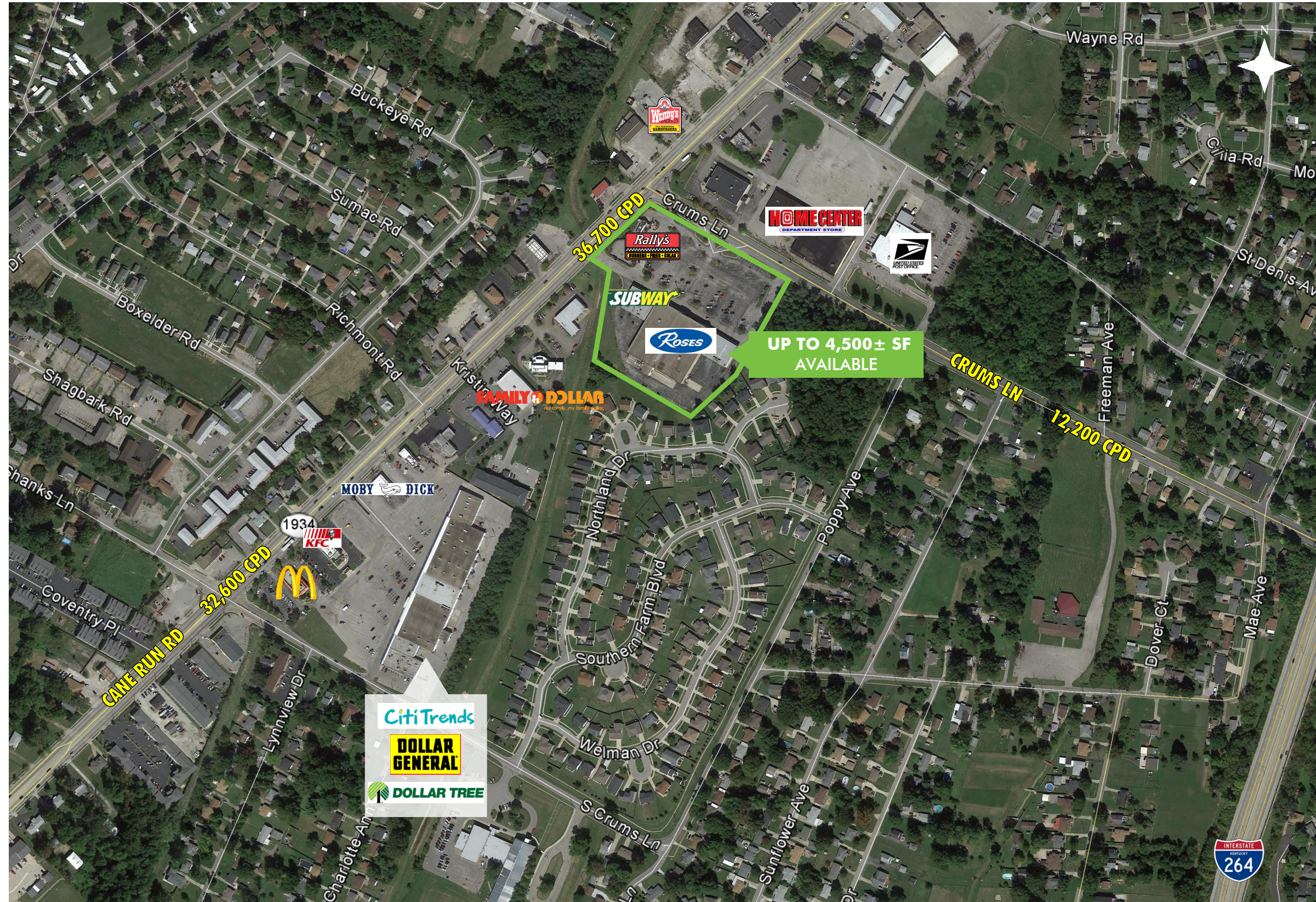

FOR LEASE

# CANE RUN PLACE

3220 CRUMS LANE | LOUISVILLE, KY

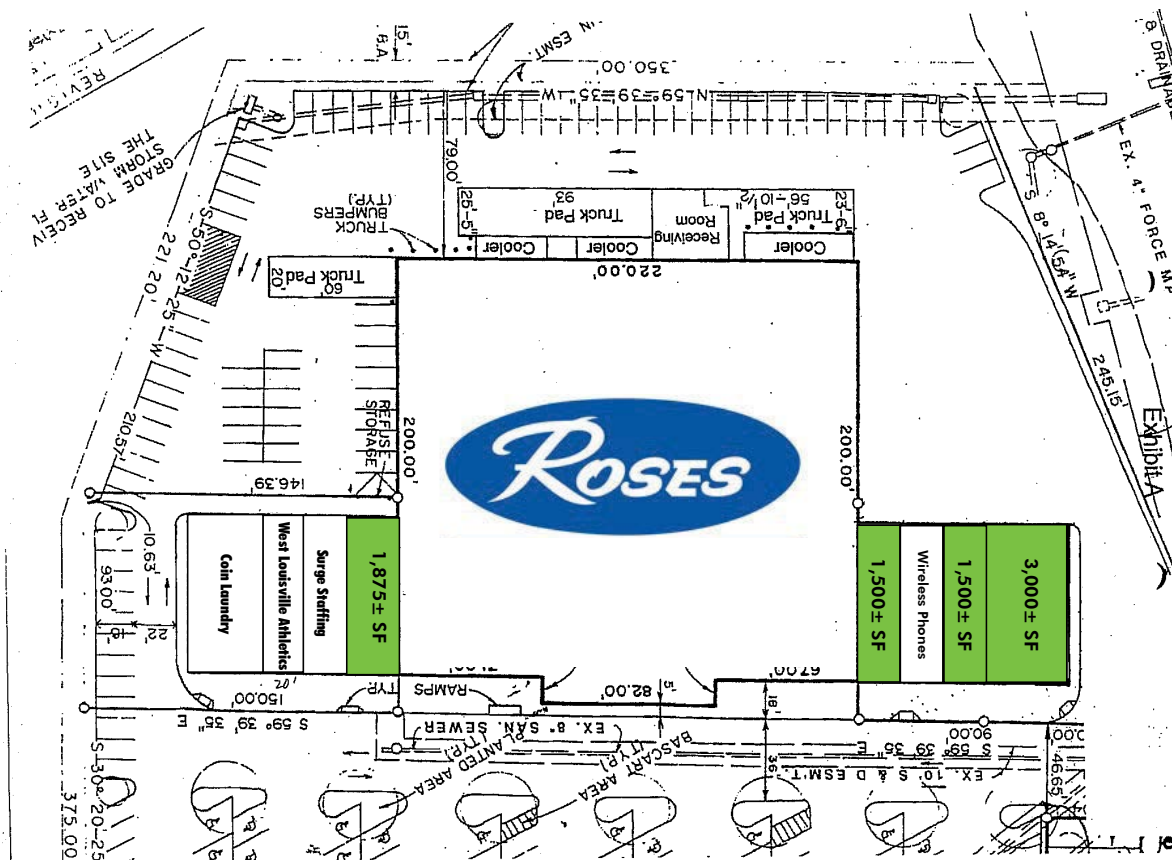

## 2020 Estimated Demographics

	1 Mile	3 Miles	5 Miles
Population	9,497	67,323	189,871
Average Household Income	\$56,640	\$53,656	\$53,047

## CONTACT US

### Clay Hunt

Vice President  
+1 502 412 7607  
clay.hunt@cbre.com

### Robert Schwartz

Senior Vice President  
+1 502 412 7606  
robert.schwartz@cbre.com

© 2021 CBRE, Inc. All rights reserved. This information has been obtained from sources believed reliable, but has not been verified for accuracy or completeness. You should conduct a careful, independent investigation of the property and verify all information. Any reliance on this information is solely at your own risk. CBRE and the CBRE logo are service marks of CBRE, Inc. All other marks displayed on this document are the property of their respective owners, and the use of such logos does not imply any affiliation with or endorsement of CBRE. Photos herein are the property of their respective owners. Use of these images without the express written consent of the owner is prohibited.