

420

LEXINGTON

THE GRAYBAR BUILDING

Partial 29th Floor: 11,150 RSF

Partial 30th Floor: 9,071 RSF

Total Contiguous Block: 20,221 RSF

High-end Installation with 5 useable Terraces

SUBLEASE

CBRE



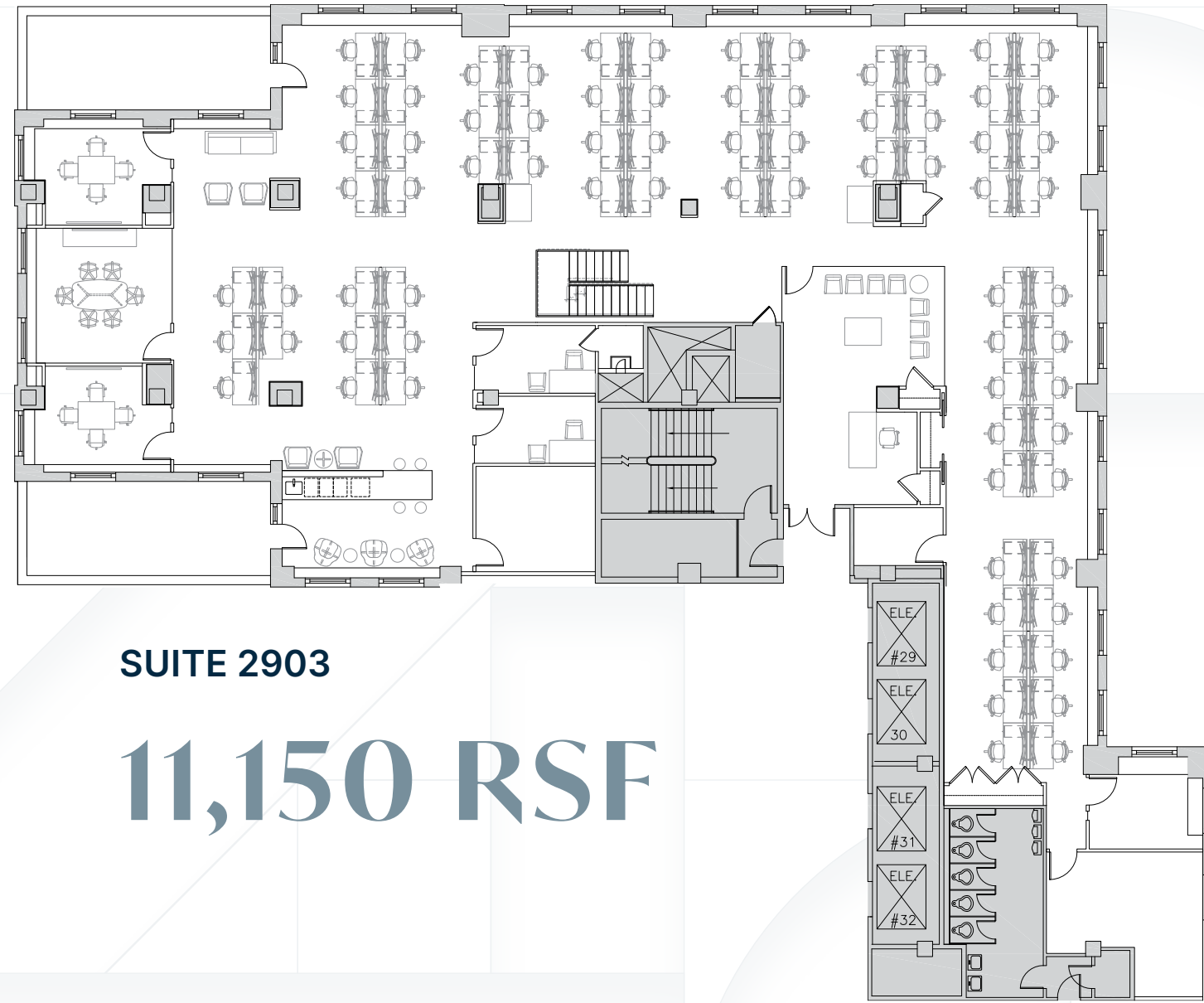

SUITE 2903

11,150 RSF

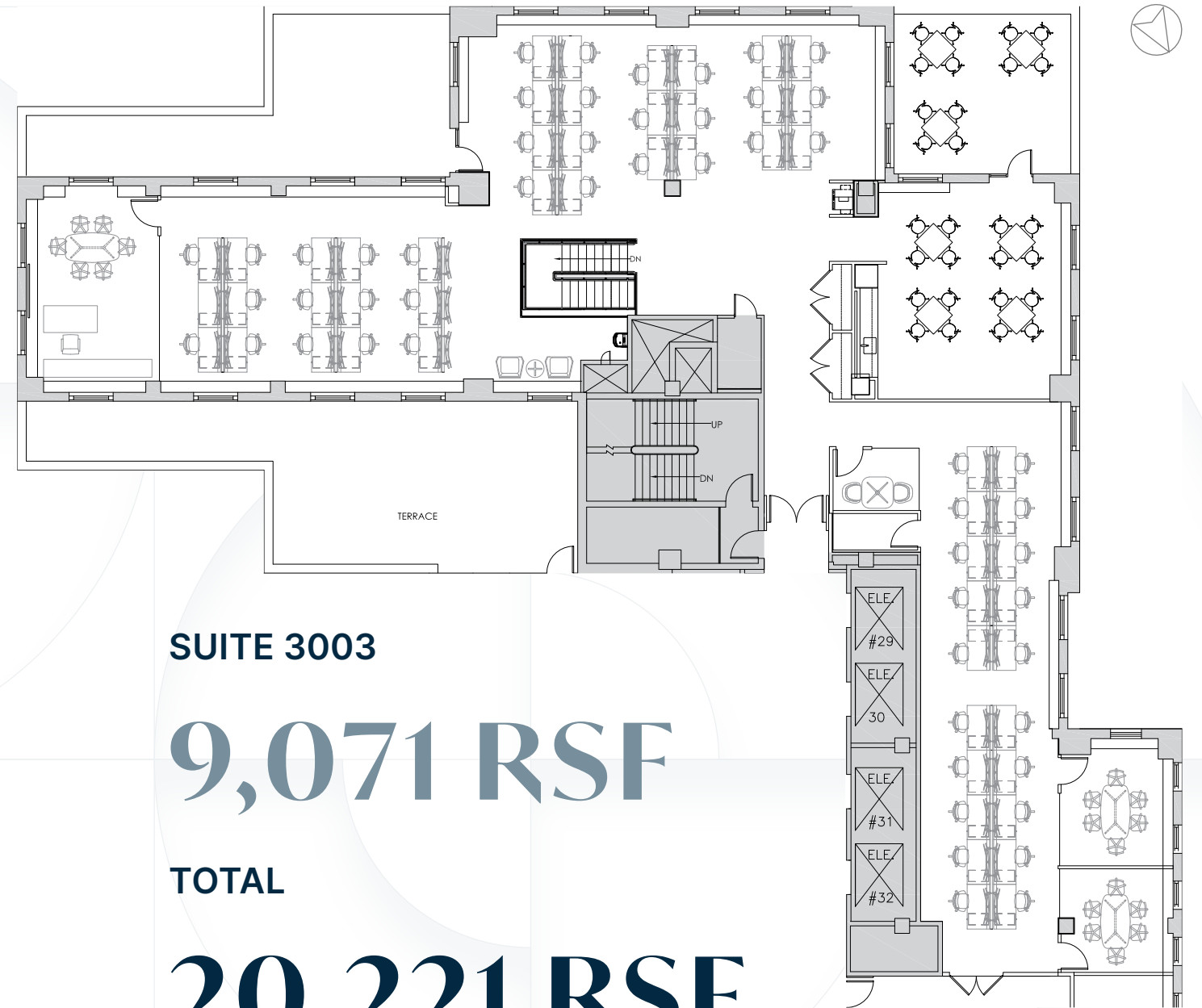

SUITE 3003

9,071 RSF

TOTAL

20,221 RSF

POSSESSION:

Immediate

TERM:

Through 12/30/2032

COMMENTS:

- High-end, above standard contiguous block
- Internal staircase connecting the two floors
- 5 useable terraces
- Fantastic natural light and views throughout
- Fully furnished

- Installation consists of a mix of offices, conferencing space, open area for workstations, and high-end pantries
- Additional growth space can be made available to create 25k RSF contiguous block



29TH FLOOR





30TH FLOOR



420

LEXINGTON

THE GRAYBAR BUILDING

David Katz

david.b.katz@cbre.com

+1 212 984 7170

David Hollander

david.hollander@cbre.com

+1 212 984 6553

CBRE



© 2025 CBRE, Inc. All rights reserved. This information has been obtained from sources believed reliable, but has not been verified for accuracy or completeness. You should conduct a careful, independent investigation of the property and verify all information. Any reliance on this information is solely at your own risk. CBRE and the CBRE logo are service marks of CBRE, Inc. All other marks displayed on this document are the property of their respective owners, and the use of such logos does not imply any affiliation with or endorsement of CBRE.