



PLANTATION, FL

# THE FOUNTAINS - 801 S UNIVERSITY DR

1,050 SF - 5,001 SF RETAIL & RESTAURANT SPACE AVAILABLE



# PROJECT DETAILS

THE FOUNTAINS - 801 S UNIVERSITY DR • 1,050 SF - 5,001 SF AVAILABLE • RETAIL & RESTAURANT

## PROPERTY HIGHLIGHTS

- 161,463 SF power center located in the heart of Broward County and along Plantation's main retail corridor
- Adjacent to the Broward Regional Mall and fronting University Drive with a ADT of 50,500
- Anchor tenants include Kohl's, Dick's Sporting Goods, Total Wine, Marshalls, Homegoods, and more
- Very strong demographics with high density, daytime population and income
- Over 4.6 million annual visits to the center

## DEMOGRAPHICS

	1 MILE	3 MILE	5 MILE
 POPULATION	9,810	132,206	396,854
 DAYTIME POPULATION	16,525	65,417	148,776
 MEDIAN HH INCOME	\$93,659	\$78,017	\$63,161

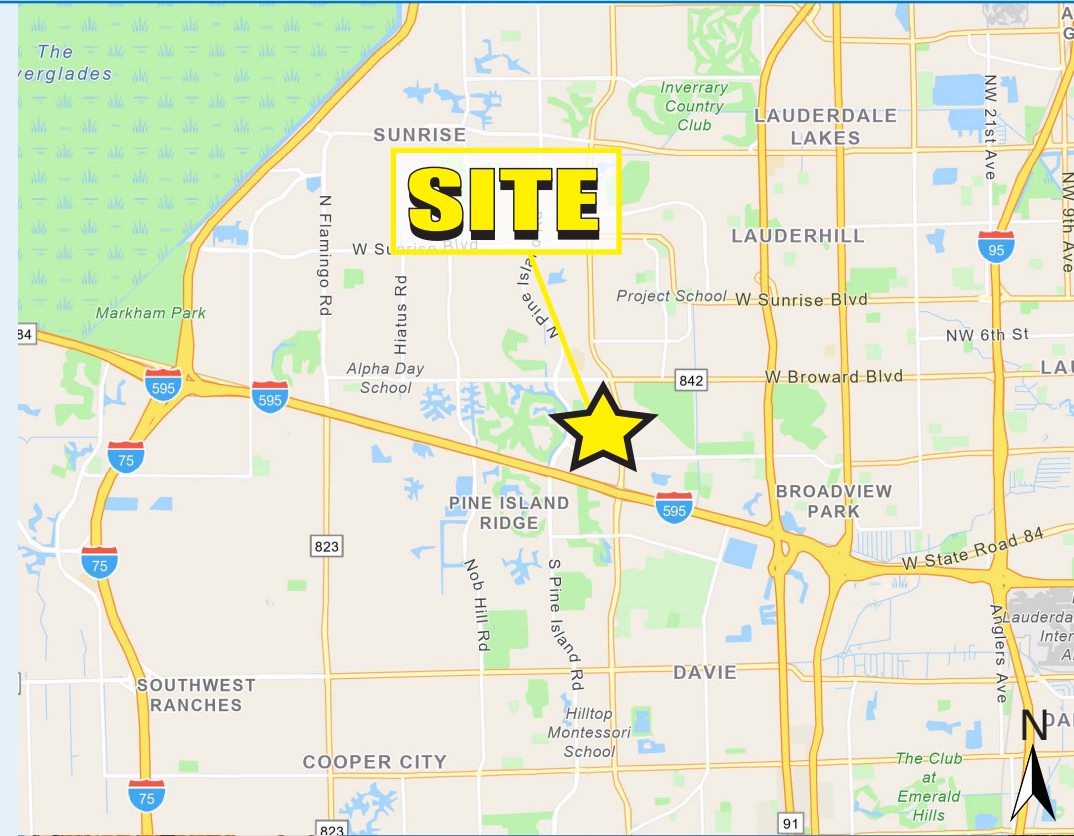

MARKET AERIAL

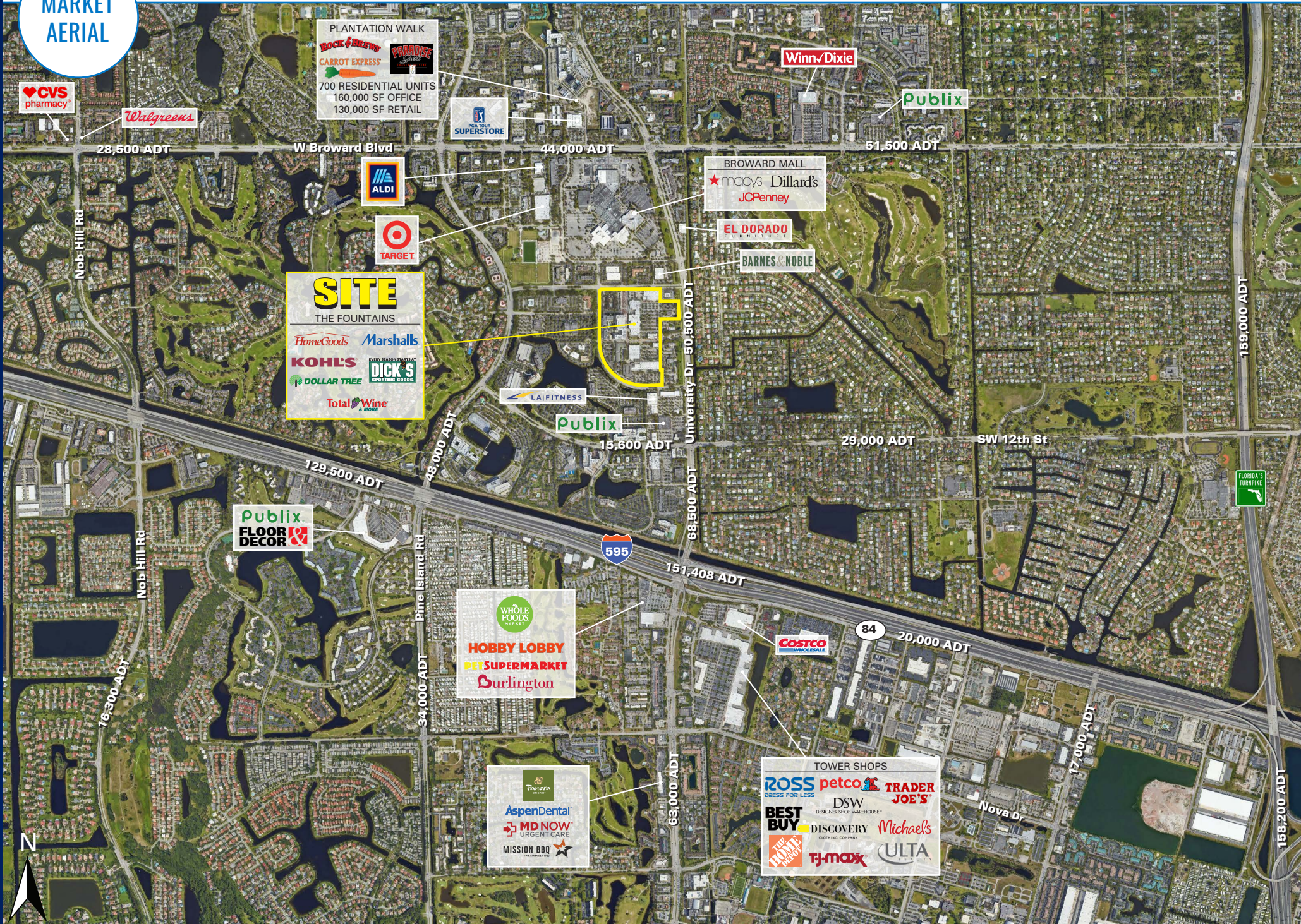

**SITE**  
THE FOUNTAINS

HomeGoods Marshalls  
Kohl's EVERY SEASON'S GREAT AT  
DOLLAR TREE DICK'S SPORTING GOODS  
Total Wine & More

PLANTATION WALK  
ROCK & BERRY CARROT EXPRESS  
700 RESIDENTIAL UNITS  
160,000 SF OFFICE  
130,000 SF RETAIL

BROWARD MALL  
★macy's Dillard's  
JCPenney

EL DORADO FURNITURE  
BARNES & NOBLE

WHOLE FOODS MARKET  
HOBBY LOBBY  
PET SUPERMARKET  
Burlington

TOWER SHOPS  
ROSS DRESS FOR LESS petco TRADER JOE'S  
DSW DESIGNER SHOE WAREHOUSE  
BEST BUY DISCOVERY MICHAEL'S  
THE HOME DEPOT TJ-maxx ULTA

Pizzeria  
AspenDental  
MD NOW URGENT CARE  
MISSION BBQ

SITE PLAN

AVAILABLE COMING AVAILABLE LEASE PENDING

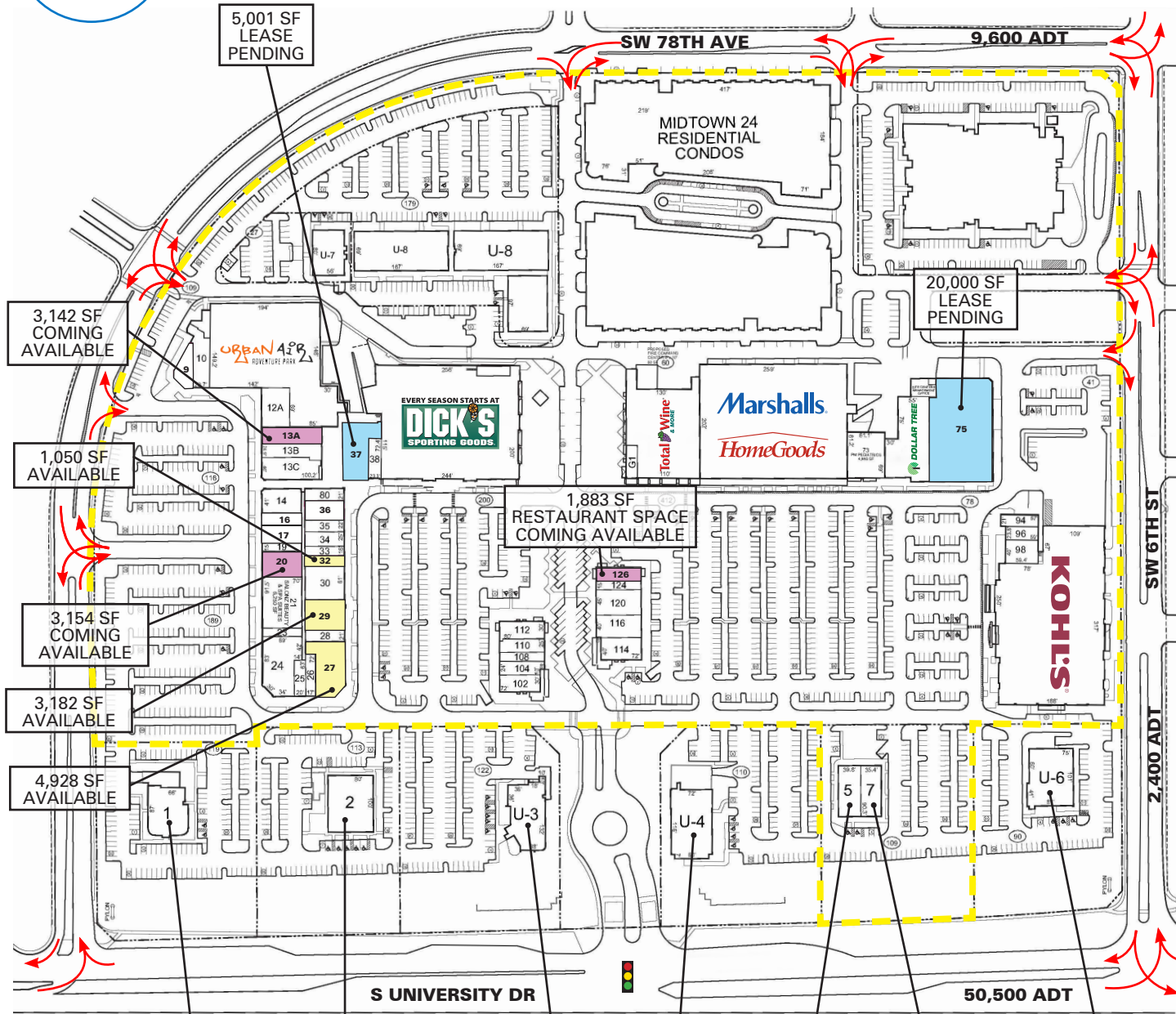

Bay #	Tenant	S.F.
1	CHILI'S GRILL & BAR	6,079
2	DUFFY'S SPORTS GRILL	8,080
5	VISIONWORKS	3,689
7	RUMBLE	3,204
9	BARWIS PHYSICAL THERAPY	1,800
10	PARK'S MA	3,114
11	URBAN AIR TRAMPOLINE & ADVENTURE PARK	35,073
12A	DIVERSITY MRI	3,600
13A	COMING AVAILABLE	3,142
13B	PETBAR	2,645
13C	KID STRONG	3,938
14	H&R BLOCK	2,983
16	FIREHOUSE SUBS	1,564
17	BUNKER GOLF LOUNGE	2,110
19	MANE CHANGES SALON	1,044
20	COMING AVAILABLE	3,154
21	SALONZ BEAUTY & SPA SUITES	6,250
23	GRADIENTS BARBER LOUNGE	1,052
24	TOOJAYS GOURMET DELI	6,300
25	SUPERCUTS	1,300
26	ECOTECH HOMES	1,170
27	AVAILABLE	4,928
28	FACIAL MANIA SPA	1,583
29	AVAILABLE	3,182
30	KIKO SUSHI & THAI SAKE BAR	4,304
32	AVAILABLE	1,050
33	BD NAILS & SPA	1,054
34	MANPOWER	1,700
35	JUST LIFT STUDIOS	2,369
36	SANO DENTAL	2,300
37	LEASE PENDING	5,001
38	CHIROCARE OF FLORIDA	1,689
39	DICK'S SPORTING GOODS	50,614
72	MARSHALLS/HOMEGOODS	52,649
73	PM PEDIATRICS	4,958
74	DOLLAR TREE	10,667
75	LEASE PENDING	20,000
80	STROMBOLI PIZZA	1,332
94	PILATES OF PLANTATION	1,465
96	HELENA'S COFFEE	1,410
98	SAS SHOES	2,515
99	KOHL'S	109,060
102	LIME FRESH MEXICAN GRILL	2,160
104	THE SKINNY DIP FROZEN YOGURT BAR & MORE	1,840
108	HOFFMAN'S SWEET SHOPPE	1,295
110	AT&T	1,980
112	FOUNTAIN'S JEWELRY	2,193
114	FIVE GUYS BURGERS & FRIES	2,880
116	SICILIAN OVEN	3,162
120	T-MOBILE	3,600
124	GYROVILLE	1,200
126	RESTAURANT SPACE COMING AVAILABLE	1,883
G	TOTAL WINE & MORE	21,058
G1	BATCH THE COOKIE COMPANY	1,255
U-3	SMOKEY BONES	7,443
U-4	OLIVE GARDEN	9,062
U-6	RED LOBSTER	7,978
U-7	FOUNTAINS PROFESSIONAL CENTER	4,500
U-8	FOUNTAINS PROFESSIONAL CENTER	30,266



PLANTATION, FL

# THE FOUNTAINS - 801 S UNIVERSITY DR

**1,050 SF - 5,001 SF RETAIL & RESTAURANT SPACE AVAILABLE**

**TRAVIS LANGHORST**

561.424.3026

TLANGHORST@ATLANTICRETAIL.COM

**GLORIA ANSELMO**

561.424.3015

GANSELMO@ATLANTICRETAIL.COM



**ALBANY  
ATLANTA  
BOSTON  
CHARLOTTE  
LOS ANGELES  
NEW YORK CITY  
ORLANDO  
PITTSBURGH  
WEST PALM BEACH**

HOLTEC BUILDING  
1001 N US HWY ONE, SUITE 600  
JUPITER, FL 33477  
561.427.6699

**WWW.ATLANTICRETAIL.COM**

 [LINKEDIN.COM/COMPANY/ATLANTIC-RETAIL-PROPERTIES](https://www.linkedin.com/company/atlantic-retail-properties)

 [INSTAGRAM.COM/ATLANTIC\\_RETAIL/](https://www.instagram.com/atlantic_retail/)

 **REALESTATE  
RESOURCES**