



300, Léo-Pariseau

Discover Place du Parc



Nestled at the base of Mount Royal, Place du Parc is a premier 26-storey office building that offers an unparalleled work experience with a 360 view of the city just outside the downtown Montreal core. This prime location merges the benefits of a bustling city with the serene backdrop of nature. The building is seamlessly integrated into a lively community featuring upscale residential condos, diverse retail and food options, the McGill University campus, and the natural beauty of Mount Royal.

3 0 0 , L é o - P a r i s e a u



Strategic Location

Only 700 meters from Place des Arts metro station, placing you within steps of Mont Royal and its numerous recreational offerings.



Convenient Access

Directly connected to Les Galeries du Parc, an underground retail center boasting a variety of dining options, Cinema du Parc, Uniprix, Dollarama, Metro grocery store, and SAQ.



Stunning Views

Enjoy breathtaking, unobstructed 360 view of Mont Royal, Downtown Montreal, and the South Shore.



Ample Parking

An interior parking garage with 1,100 stalls and charging stations for electric vehicles ensures convenience for all.



Wellness Amenities

Access to an on-site fitness center complete with an exterior heated pool, in-building locker rooms, and showers available for tenant use.

Floor Plan

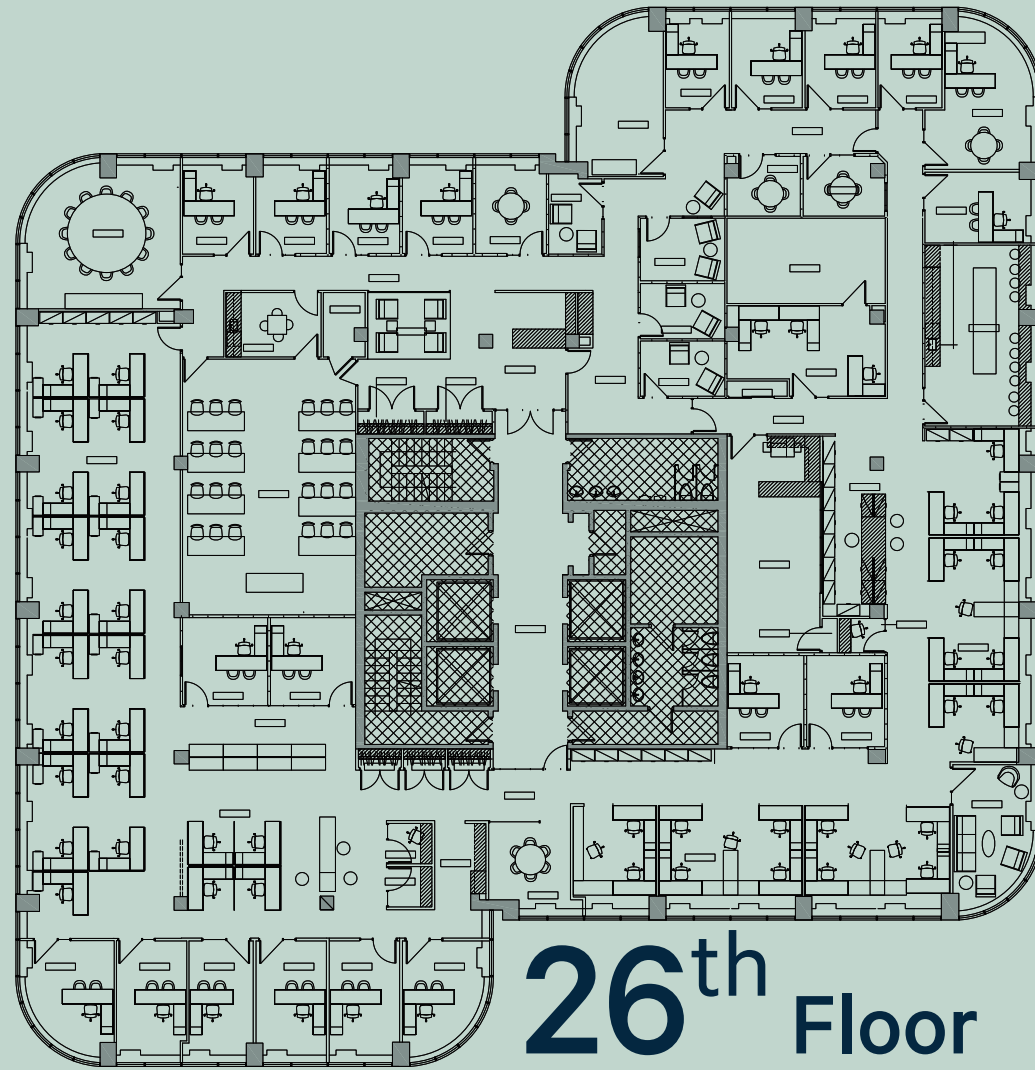

26th Floor

15 166
SF

Lease Expiry

November 30, 2027

Net Rent

Negotiable

Additional Rent (est. 2024)

\$ 19.81

Electricity and Cleaning

Included













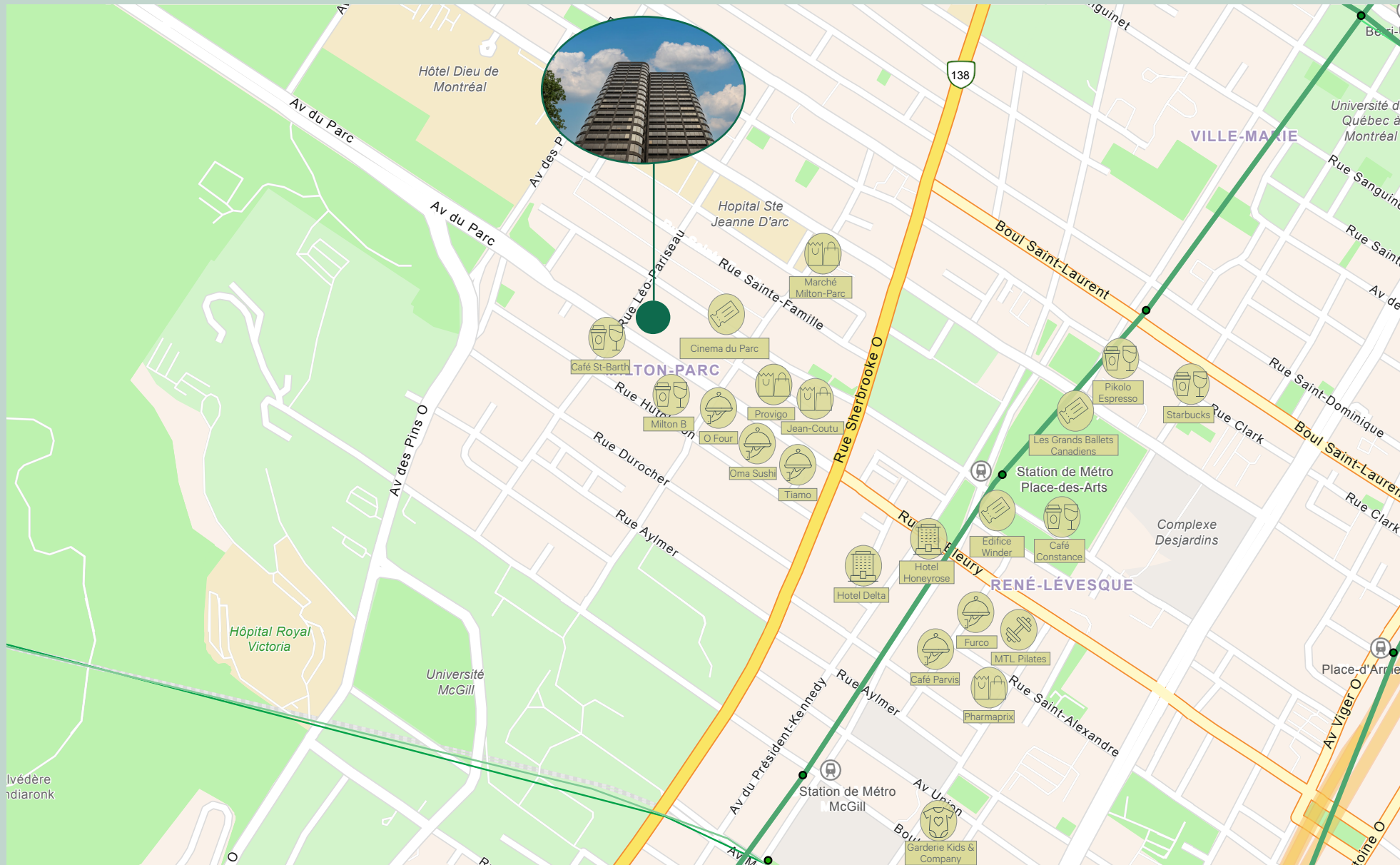

LOBBY



Location



Amenities

-  Restaurant
-  Café
-  Retail Shop
-  Pharmacy/Grocery
-  Entertainment
-  Daycare
-  Gym
-  Hotel

Transit

-  12-minute walking distance to Place-des-arts metro station
-  STM Bus 144, 365, 80, 129, 480, 360, 55, 363
-  24-minute walking distance to Gare Centrale train station
-  Extensive network of bike trails

Contact Us

Liam Mayes**

Vice President

+1 514 375 0805

liam.mayes@cbre.com

Real Estate Broker

Juan-Alonso Papathanassiou

Transaction Manager

+1 514 375 0825

juanalonso.papa@cbre.com

Real Estate Broker

**Real Estate Broker carrying out his activities with the business corporation Liam Mayes Real Estate Brokerage Inc.

CBRE Limited, Real Estate Agency

1250 René-Lévesque Boulevard West, Suite 2800, Montreal (Qc) H3B 4W8 Tél. +1 514 849 6000 | www.cbre.ca

This disclaimer shall apply to CBRE Limited, Real Estate Agency, and to all other divisions of the Corporation; to include all employees and independent contractors ("CBRE"). The information set out herein, including, without limitation, any projections, images, opinions, assumptions and estimates obtained from third parties (the "Information") has not been verified by CBRE, and CBRE does not represent, warrant or guarantee the accuracy, correctness and completeness of the Information. CBRE does not accept or assume any responsibility or liability, direct or consequential, for the Information or the recipient's reliance upon the Information. The recipient of the Information should take such steps as the recipient may deem necessary to verify the Information prior to placing any reliance upon the Information. The Information may change and any property described in the Information may be withdrawn from the market at any time without notice or obligation to the recipient from CBRE. CBRE and the CBRE logo are the service marks of CBRE Limited and/or its affiliated or related companies in other countries. All other marks displayed on this document are the property of their respective owners. All Rights Reserved. Mapping Sources: Canadian Mapping Services canadamapping@cbre.com; DMTI Spatial, EnviroNics Analytics, Microsoft Bing, Google Earth.

CBRE