

# INDUSTRIAL SPACE FOR LEASE MULTI-TENANT INDUSTRIAL BUILDING

620 VENTURE STREET | ESCONDIDO, CA



## BUILDING AMENITIES

- Suite B: 3,450 SF
- Multi-tenant industrial building near Escondido Auto Park
- 16' warehouse ceiling height

**LEASE RATE: \$1.40/SF/MO + \$0.05/SF CAM**

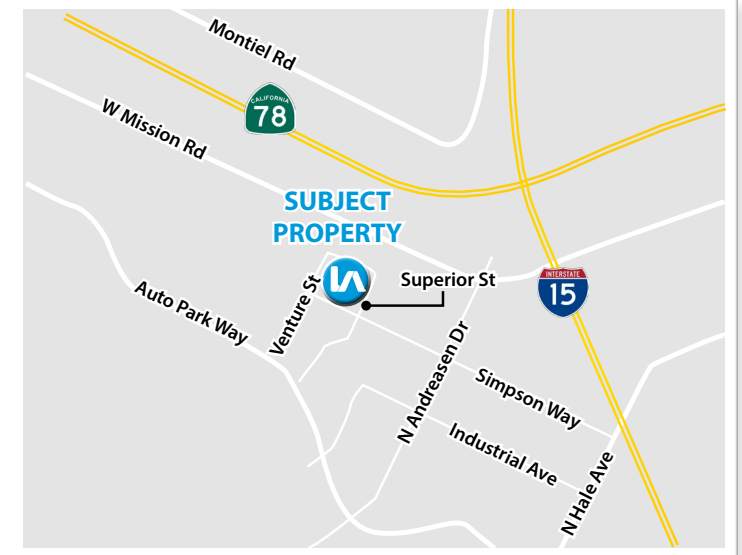

Peter Merz  
pmerz@lee-associates.com  
D 760.448.1362  
DRE #01269042

Daniel Knoke  
dknoke@lee-associates.com  
D 760.929.7836  
DRE #01215373

All information furnished regarding property for sale, rental or financing is from sources deemed reliable, but no warranty or representation is made to the accuracy thereof and same is submitted to errors, omissions, change of price, rental or other conditions prior to sale, lease or financing or withdrawal without notice. No liability of any kind is to be imposed on the broker herein.

# INDUSTRIAL SPACE FOR LEASE MULTI-TENANT INDUSTRIAL BUILDING

620 VENTURE STREET | ESCONDIDO, CA

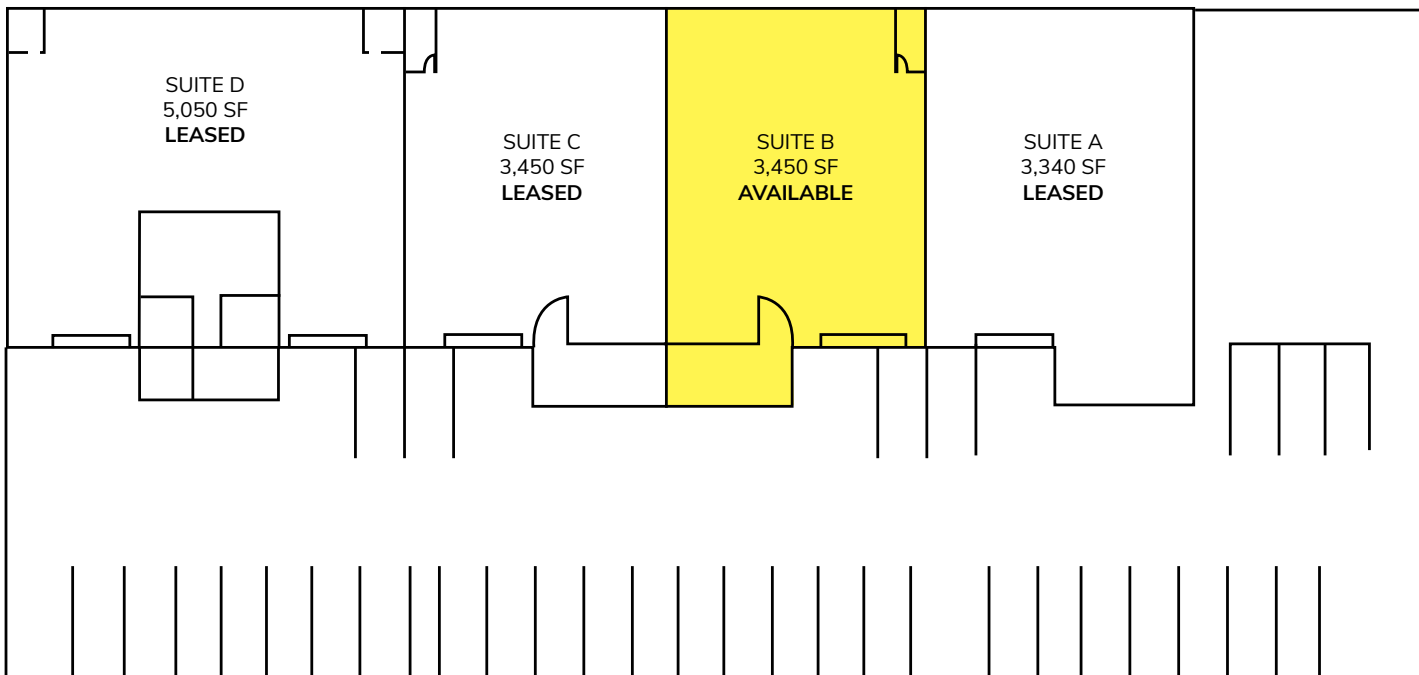

SUITE	SIZE/SF	IMPROVEMENTS	RATE/SF/MO	AVAILABILITY	ACCESS
B	3,450 SF	Small office, rest room and warehouse	\$1.40/SF/MO + \$0.05 CAM	December 2025	Call to Show

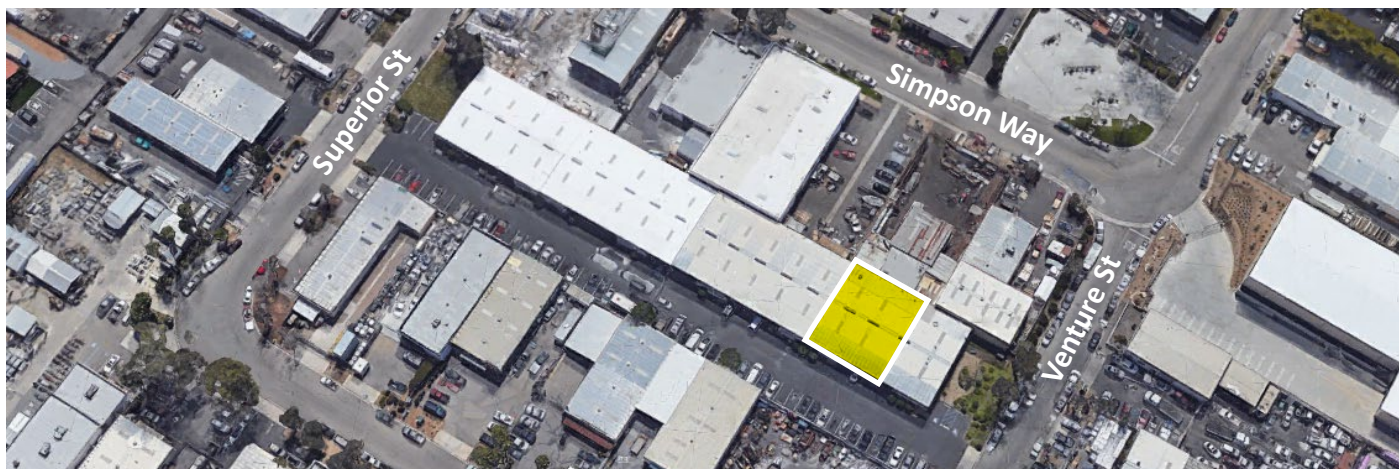

Peter Merz  
pmerz@lee-associates.com  
D 760.448.1362  
DRE #01269042

Daniel Knoke  
dknoke@lee-associates.com  
D 760.929.7836  
DRE #01215373

All information furnished regarding property for sale, rental or financing is from sources deemed reliable, but no warranty or representation is made to the accuracy thereof and same is submitted to errors, omissions, change of price, rental or other conditions prior to sale, lease or financing or withdrawal without notice. No liability of any kind is to be imposed on the broker herein.