



REAL ESTATE

IMAGINE  
SOMETHING  
**GRAND**

Retail and Restaurant  
Space for Lease  
Wilshire Grand Center

900 Wilshire Blvd., Los Angeles, CA 90017

JUSTIN WEISS · 310.887.3450 · Justin.Weiss@kwprealestate.com · DRE #01920886

LEE SHAPIRO · 310.887.6226 · Lee.Shapiro@kwprealestate.com · DRE #00961769



# Retail and Restaurant Space for Lease

900 Wilshire Blvd., Los Angeles, CA 90017

## AVAILABLE

Ste 114: ±5,000 - 9,294

Rent: \$4.50 PSF/Mo., MG

## PROPERTY HIGHLIGHTS

- Retail and restaurant space at Wilshire Grand Center – the most recognizable and architecturally significant tower to be built in DTLA in decades
- Restaurant space has venting and grease interceptor, direct elevator access to/from P2 parking level, and high visibility and frontage
- Ceiling heights of up to 21 feet and jaw-dropping glass lines
- On-site valet
- Located in the heart of the Financial District, Wilshire Grand Center is surrounded by established shopping, dining and entertainment, and is easily accessible by public transportation
- Just blocks from L.A. Live, Crypto.com, and the L.A. Convention Center
- Wilshire Grand Center appeals to the over 500,000 people who work in the DTLA area, as well as its more than 65,000 residents and 19 million annual visitors

*\* Prospective tenants are hereby advised that all uses are subject to City approval*

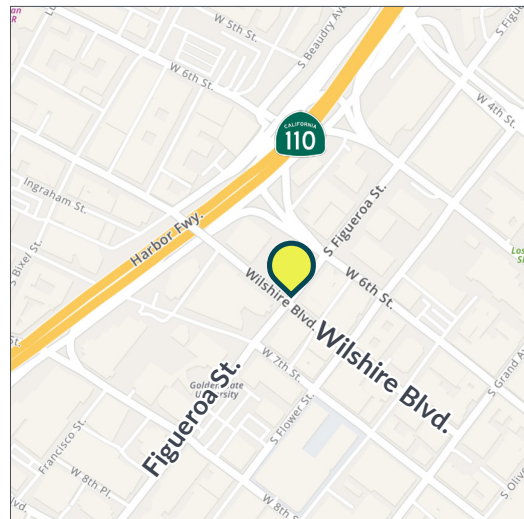

## TRADE AREA



ZARA



WOKCANO



UNI QLO



# Retail and Restaurant Space for Lease

900 Wilshire Blvd., Los Angeles, CA 90017



## Suite 114

- 5,000 - 9,294 square feet
- Rent: \$4.50 PSF/Mo. MG
- Retail/Restaurant use



See Page 5 for more photos.

## Dense Foot Traffic in the Heart of DTLA's Financial District

- 18 million square feet of office space within a 3-block radius
- 37,000 employees within the same area
- 3,000 to 4,000 pedestrians per hour at 7th Street and Figueroa on weekdays

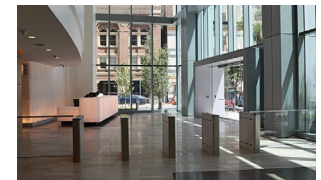
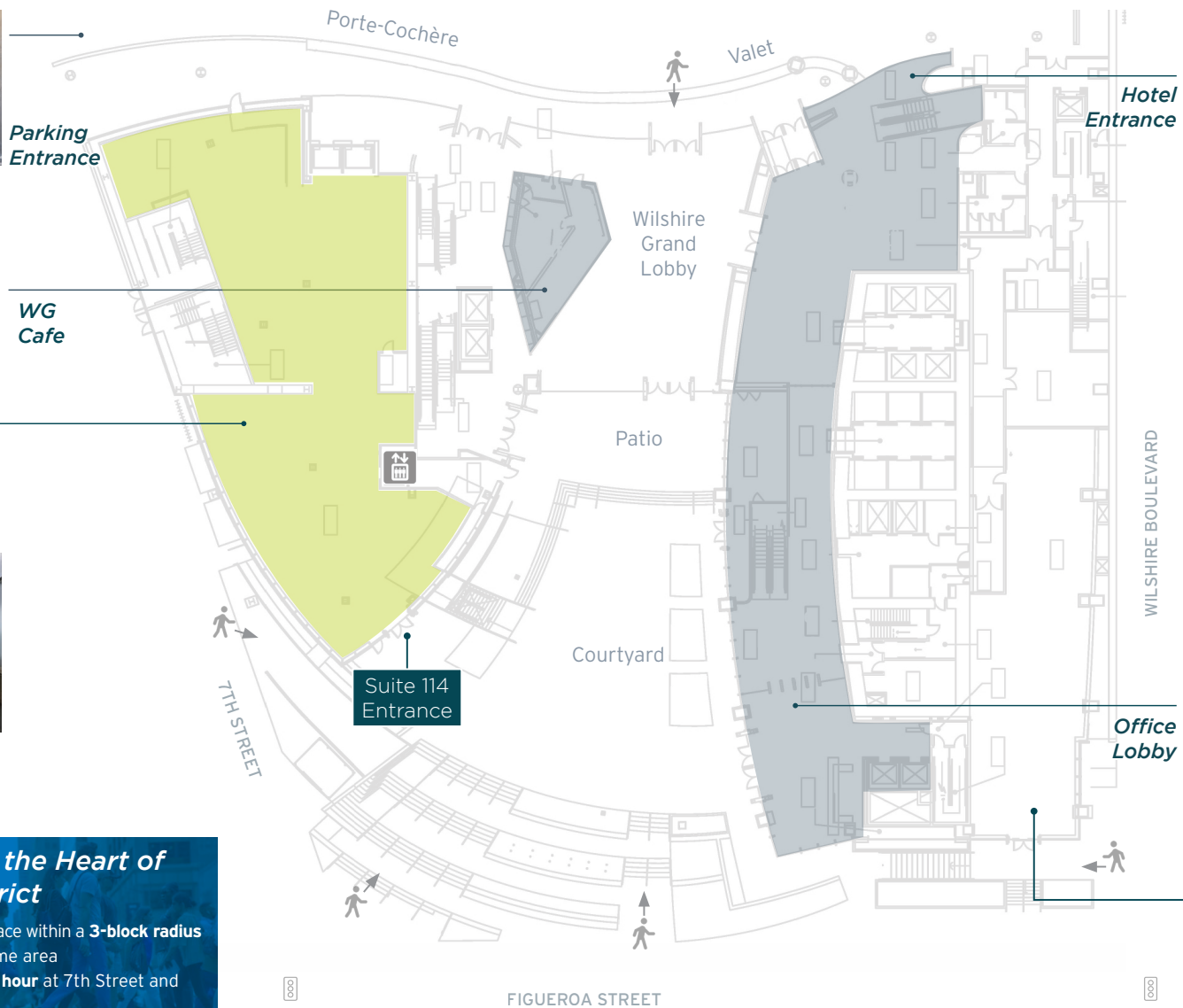

Suite 110: Pacific Western Bank coming soon

# Retail and Restaurant Space for Lease

900 Wilshire Blvd., Los Angeles, CA 90017

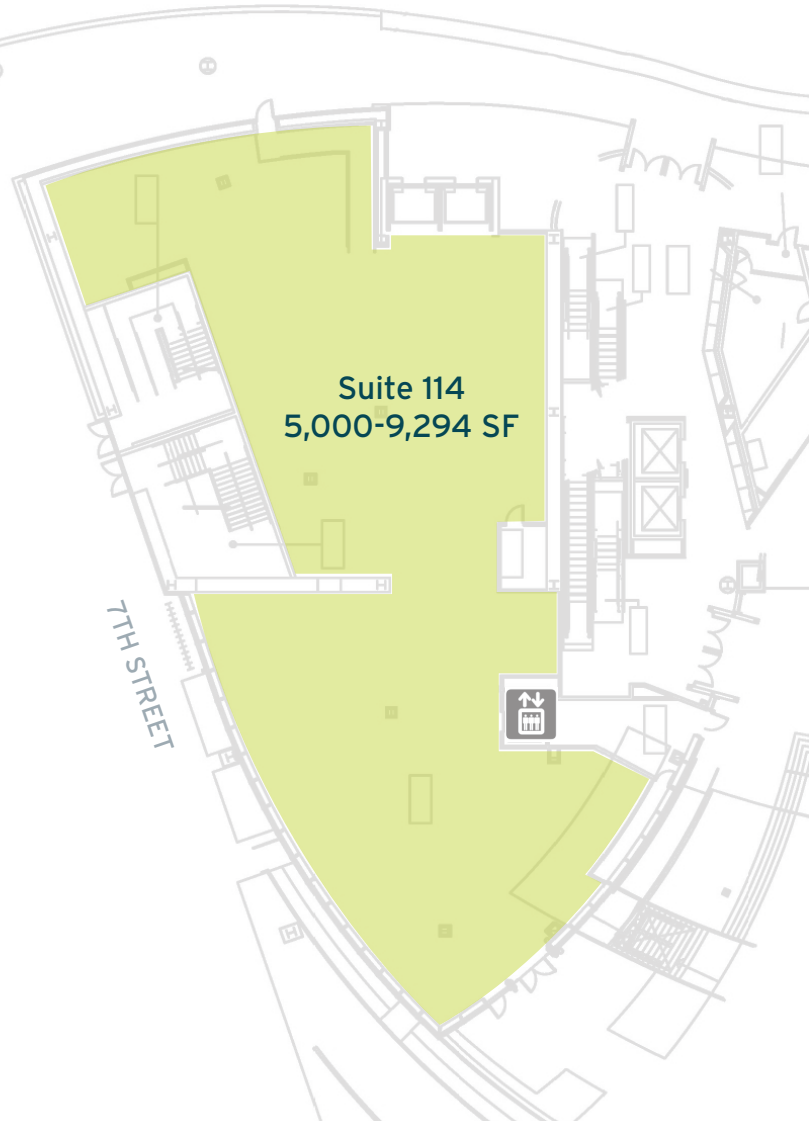

# Retail and Restaurant Space for Lease



900 Wilshire Blvd., Los Angeles, CA 90017

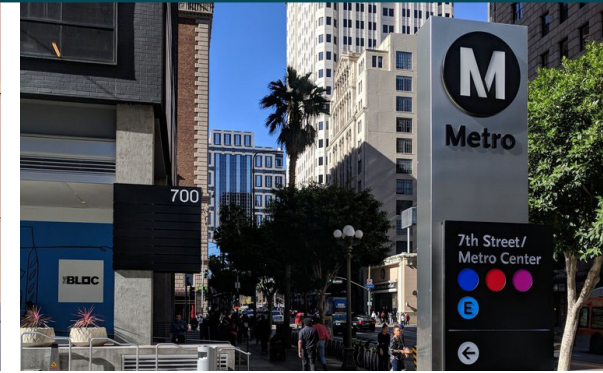

## IMAGINE SOMETHING GRAND Wilshire Grand Center Features & Amenities

As the tallest building west of the Mississippi River, Wilshire Grand Center has forever changed the Los Angeles skyline. The 2.1 million square foot complex includes the luxurious 889-room InterContinental Hotel, 17 floors of state of the art office space, a colorful art installation by famed contemporary artist Do Ho Suh, and incredible views from the Spire 73 rooftop bar. Located directly across from the 7th Street/Metro Center subway station and surrounded by notable shopping and dining at FIGat7th and The Bloc, Wilshire Grand Center is at the heart of DTLA's continuing renaissance.

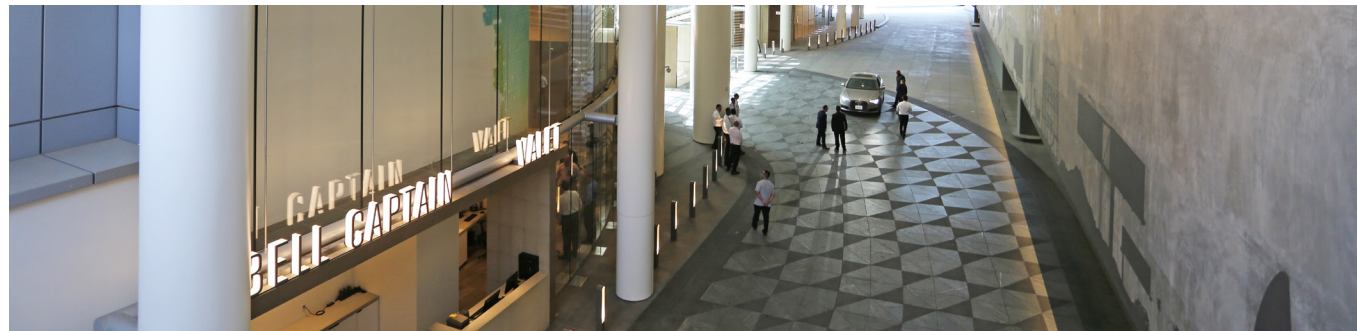
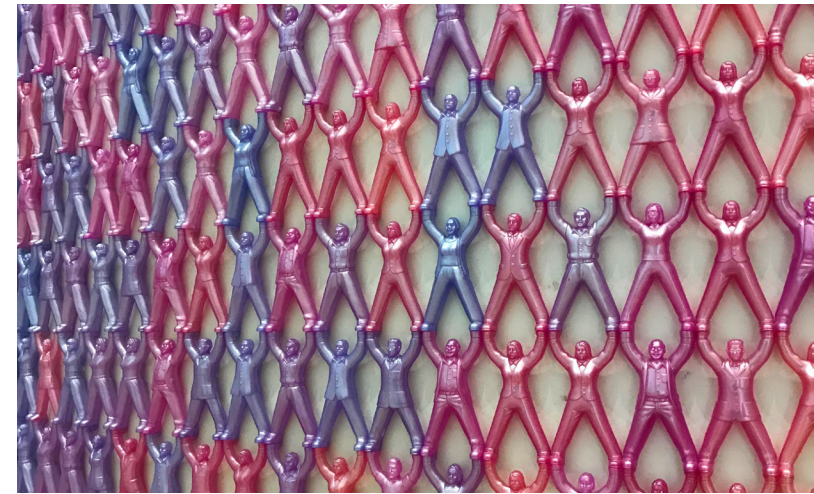

# Retail and Restaurant Space for Lease



900 Wilshire Blvd., Los Angeles, CA 90017



## IMAGINE SOMETHING GRAND Dining

Wilshire Grand Center offers chic restaurants and cocktail spaces as well as airy spots for coffee or a quick snack. Dining options at WGC include Niku X, Dekkadance, La Boucherie, Spire 73, WG Cafe and the No Dive Bar.



# Retail and Restaurant Space for Lease

900 Wilshire Blvd., Los Angeles, CA 90017

**FIGAT7TH**

- Bath & Body Works
- Gold's Gym
- H&M
- MAC
- Morton's
- Nordstrom Rack
- Target
- Victoria's Secret
- Zara

**THE BLOC**

- Alamo Drafthouse
- District Bar | Kitchen
- JOEY DTLA
- LA Fitness
- Macy's
- Sheraton Grand
- Uniqlo

**LA LIVE**

- Conga Room
- Fleming's
- Grammy Museum
- Katsuya
- Lucky Strike
- Rock'N Fish
- Rosa Mexicano
- Tom's Urban
- Wolfgang Puck
- Yard House



# Retail and Restaurant Space for Lease

900 Wilshire Blvd., Los Angeles, CA 90017

## DTLA DEMOGRAPHICS

### Live 80,000+ RESIDENTS

**\$93,000**

AVERAGE HHI

**61%**

25-54 YEARS OLD

**67%**

LOVE DTLA

<b>90%</b>	RESIDENTIAL OCCUPANCY
<b>26%</b>	RESIDENTIAL INVENTORY GROWTH SINCE 2010
<b>41%</b>	POPULATION GROWTH 2010-2022

**67%** POST SECONDARY EDUCATION

**46%** WALK, BIKE, OR TAKE TRANSIT TO WORK

### Work 288,000+ JOBS

**\$95,000**

AVERAGE HHI

**61%**

30-54 YEARS OLD

<b>79%</b>	EXPECT TO BE IN THE OFFICE AT LEAST HALF THE TIME
<b>19%</b>	JOB GROWTH IN "KNOWLEDGE INDUSTRIES"
<b>19%</b>	OF CITYWIDE JOBS

**57%** POST SECONDARY EDUCATION

**57%** COMMUTE LESS THAN 7 MILES FROM THEIR HOME



### Visit 17 MILLION VISITORS IN 2023

**\$4.5 Billion**

SPENT YEARLY

**745**

RETAIL BUSINESSES PER SQUARE MILE

<b>58%</b>	HAVE VISITED GRAND CENTRAL MARKET
<b>58%</b>	HAVE VISITED ARTS DISTRICT
<b>55%</b>	HAVE VISITED LITTLE TOKYO

**171** FOOD/BEVERAGE BUSINESSES PER SQUARE MILE

**93** WALK SCORE



Source: DCBID Demographic Survey 2024



REAL ESTATE

**JUSTIN WEISS**

310-887-3450

Justin.Weiss@kwprealestate.com

DRE #01920886

**LEE SHAPIRO**

310-887-6226

Lee.Shapiro@kwprealestate.com

DRE #00961769

KWP Real Estate | 151 S. El Camino Drive, Beverly Hills, CA 90212 | 310-887-6400 | kwprealestate.com

KWP Real Estate (Responsible Broker Identity, DRE #00659610) makes no warranty or representation as to the accuracy of the information contained herein. Terms of sale or lease and availability of the property are subject to change or withdrawal without notice.