

FOR LEASE

Great Manufacturing/Distribution Center

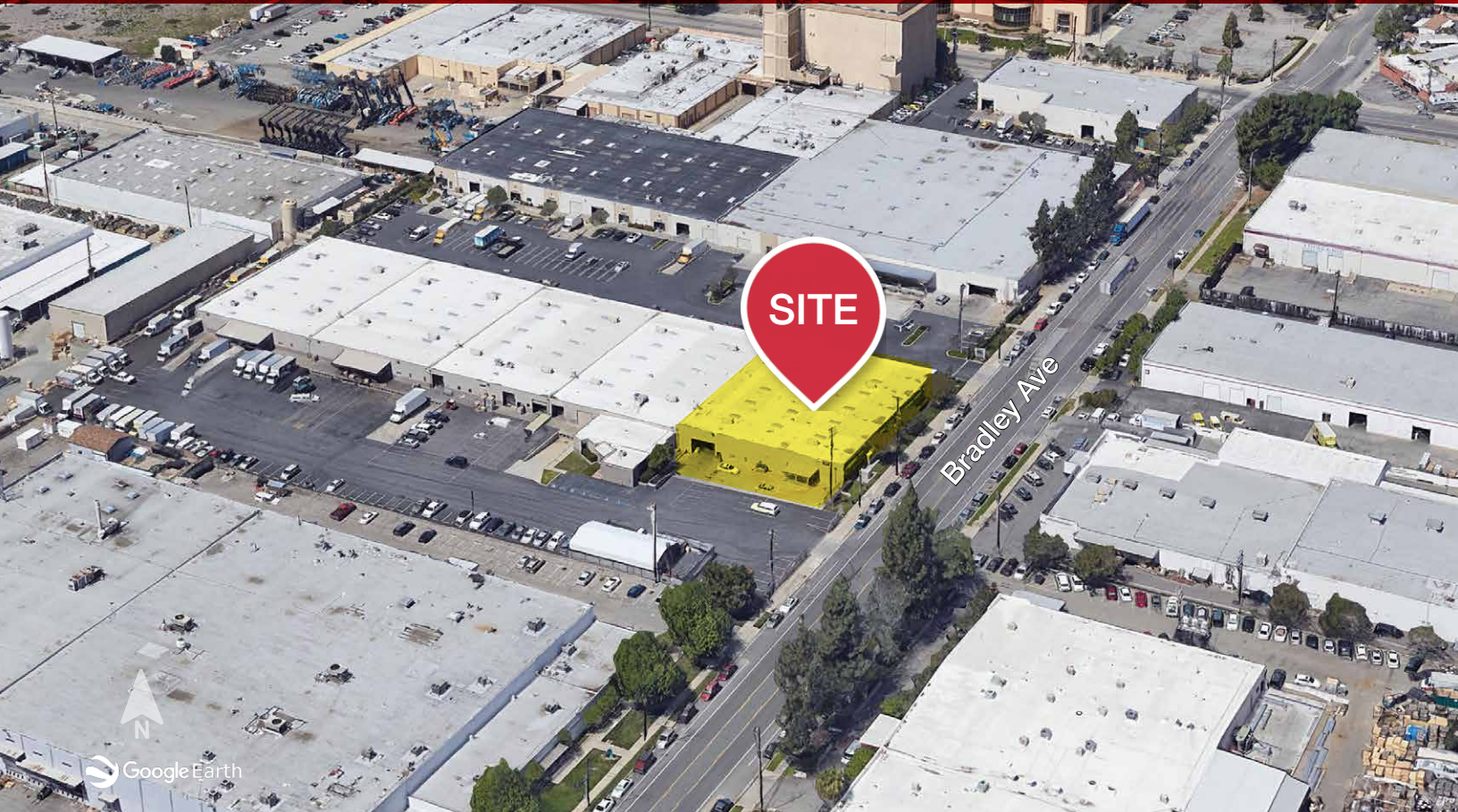

13051 BRADLEY AVE. SYLMAR, CA 91342

PROPERTY DETAILS:

Lease Type: \$20,094.80 Per Month
Lease Rate: \$1.10
Net Fees: \$4,932.36
Net Fees/SF: \$ \$0.27

- 18,268 Sq. Ft. Available
- Excellent Access to the 5, 405, 118, 210 and 14 Frwys.
- 300 Sq. Ft. Office Space (3 Offices)
- Concrete Tilt-Up Construction-Fenced and Sprinklered
- 14' Minimum Clear Height
- Renovated in 2007
- Ground Level Loading
- 400 Amps, 277- 480 Volt, 3 Phase Power Expandable

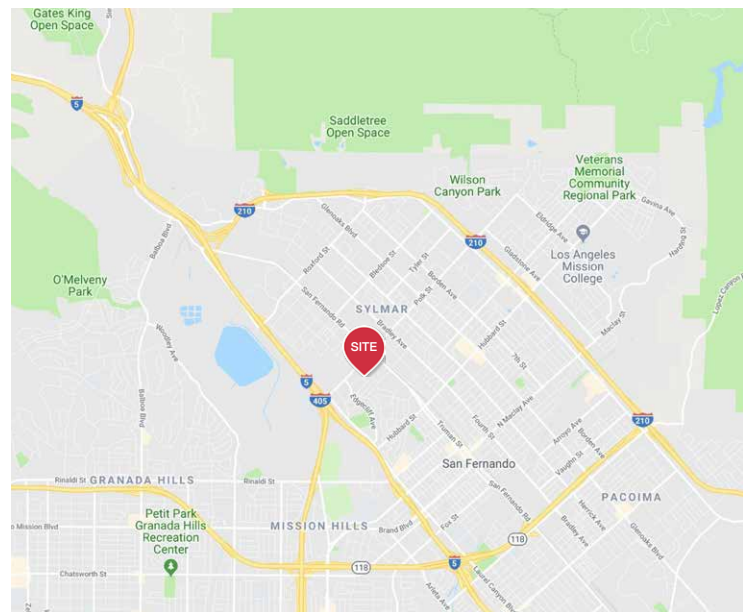

Chris Jackson

CEO
818 933 2368 direct
cjackson@naicapital.com
Cal DRE Lic #01255538

Todd Lorber

Executive Vice President
818 933 2376 direct
tlorber@naicapital.com
Cal DRE Lic #01014637

Eric Seidenglanz

Vice President
818 815 2426 direct
eseidenglanz@naicapital.com
Cal DRE Lic #01975684

NAI Capital
COMMERCIAL REAL ESTATE SERVICES, WORLDWIDE

No warranty, express or implied, is made as to the accuracy of the information contained herein. This information is submitted subject to errors, omissions, change of price, rental or other conditions, withdrawal without notice, and is subject to any special listing conditions imposed by our principals. Cooperating brokers, buyers, tenants and other parties who receive this document should not rely on it, but should use it as a starting point of analysis, and should independently confirm the accuracy of the information contained herein through a due diligence review of the books, records, files and documents that constitute reliable sources of the information described herein. NAI Capital CA DRE #01990696

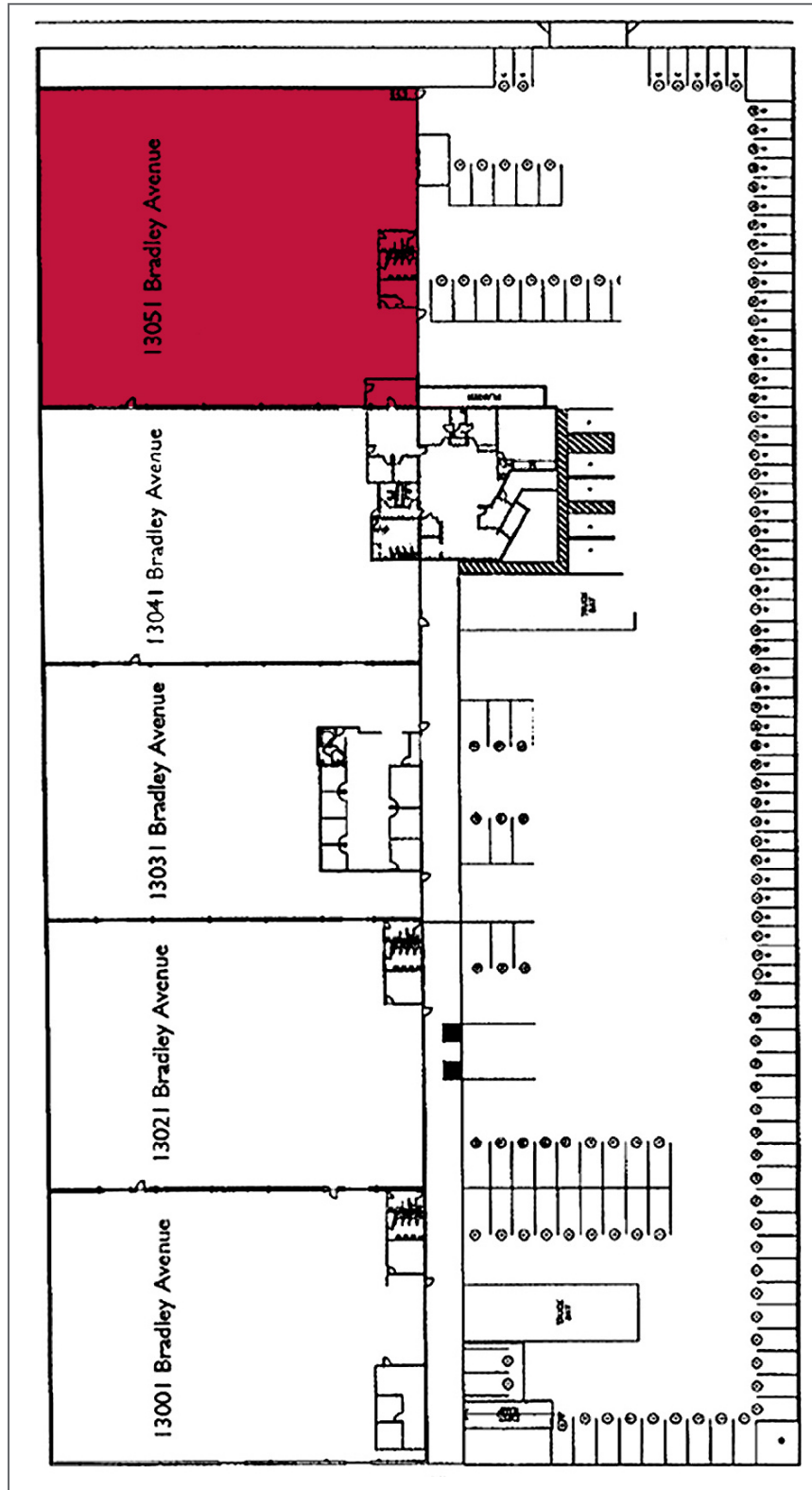

Chris Jackson
CEO
818 933 2368 direct
cjackson@naicapital.com
Cal DRE Lic #01255538

Todd Lorber
Executive Vice President
818 933 2376 direct
tlorber@naicapital.com
Cal DRE Lic #01014637

Eric Seidenglanz
Vice President
818 815 2426 direct
eseidenglanz@naicapital.com
Cal DRE Lic #01975684