

The Architect hereby expressly reserves the common law copyright and other property rights in these drawings. The drawings shall not be reproduced without the written permission and consent of the Architect. Nor are they to be assigned to any party without first obtaining written permission and consent.

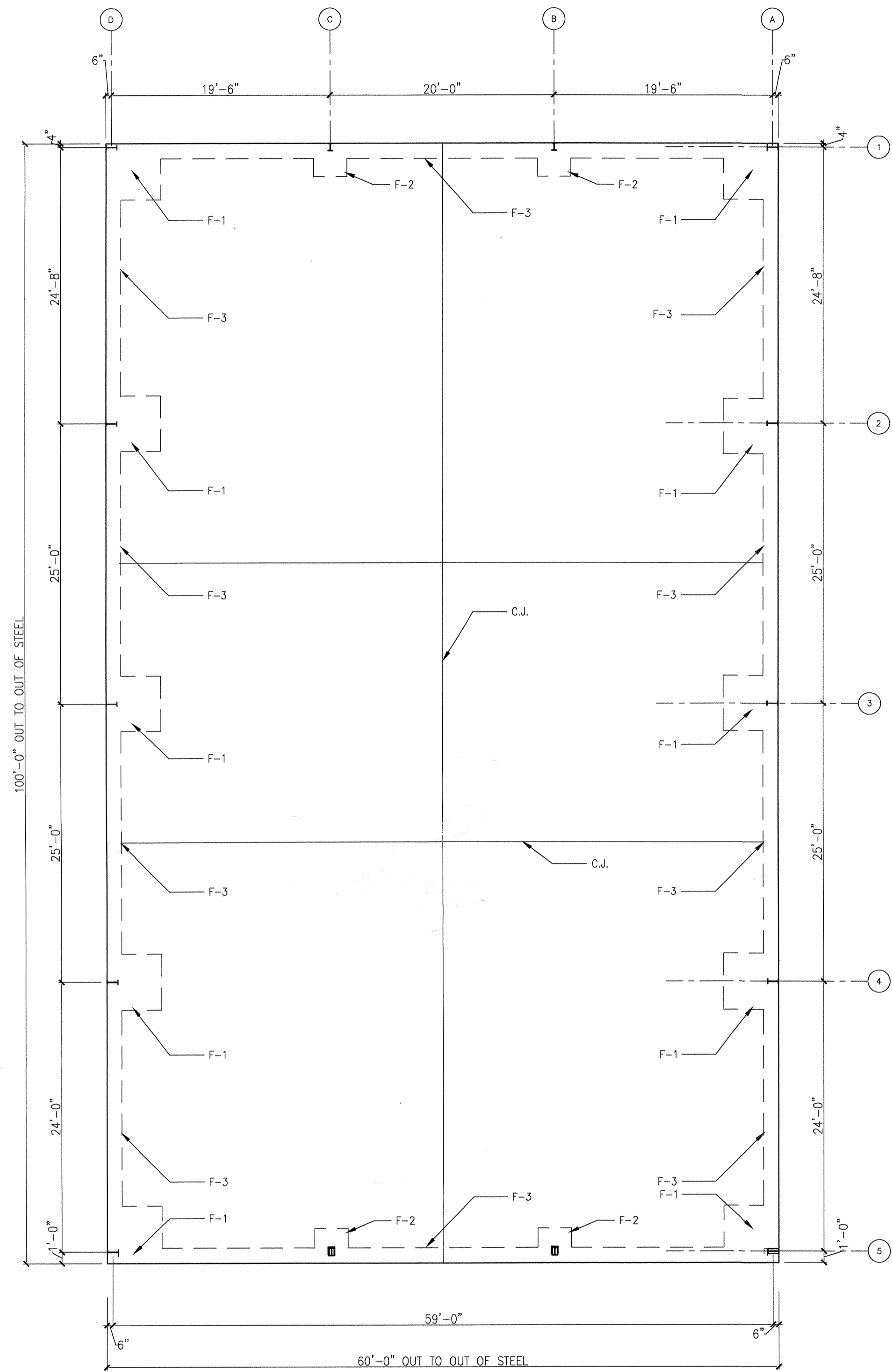

1/8" = 1'-0" 1 FOUNDATION PLAN
PLAN NORTH

FOOTING SCHEDULE

- F-1) 5' x 5' x 24" POURED CONC.
FTG. W/ (5) #5 RODS EA. WAY
- F-2) 3' x 3' x 18" POURED CONC.
FTG. W/ (3) #5 RODS EA. WAY
- F-3) 16" W x 18"D THICKENED SLAB
FTG. W/ (2) #5 RODS CONT.

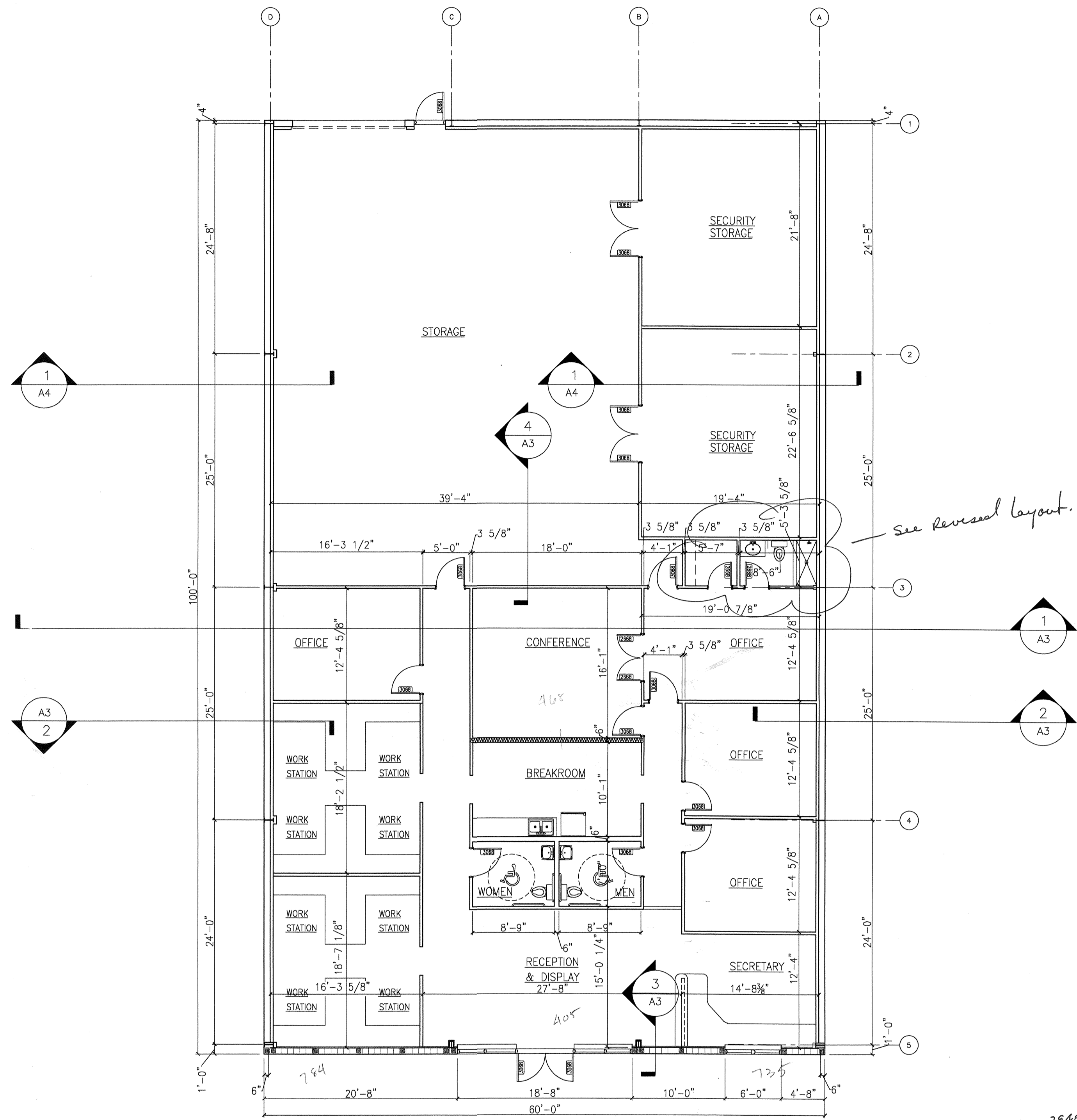

1/8" = 1'-0" 2 FLOOR PLAN
PLAN NORTH

Building 1912

*file 2940 2000 29.9
shxy 3000
additional female bathroom
required*

seal

LIC. No. AA0002469
3615 N.W. 13th Street
Gainesville, FL 32609
Phone (352) 372-6477
Fax (352) 338-4476

**EUGENE
RUSSELL
DAVIS** architect inc.

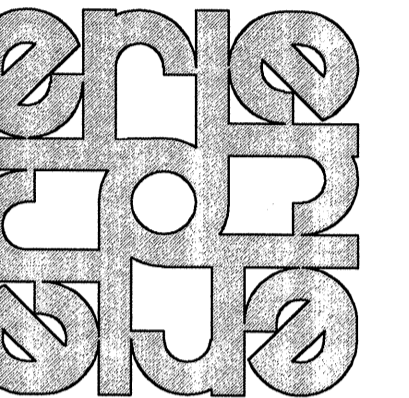

QUALITY COLLECTIBLES
BUILDING PLAN FOR
SOUTHERN EQUITY INVESTMENTS INC.
GAINESVILLE, FLORIDA

sheet title:

FOUNDATION &
FLOOR PLANS

drawn: J.G.R.
checked: E.R.D.
date: 5-8-00

revisions:
6-2-00
7-25-00

project no.: 2013
file no.:

drawing no.:

A1

of