

69,470 SF TO 158,300 SF



AVAILABLE

FOR SUBLEASE

3040 Shelby Industrial Dr, Apopka, FL 32703

HIGHLIGHTS

- SUBLEASE EXP: 2/28/2030
- 1,483 SF Office
- 36' Clear Height
- 70 Trailer Parking Spaces
- Up to 50 Dock High Doors
- 2 Drive-In Ramps



BUILDING SPECIFICATIONS:

OPTION A - 69,470 SF

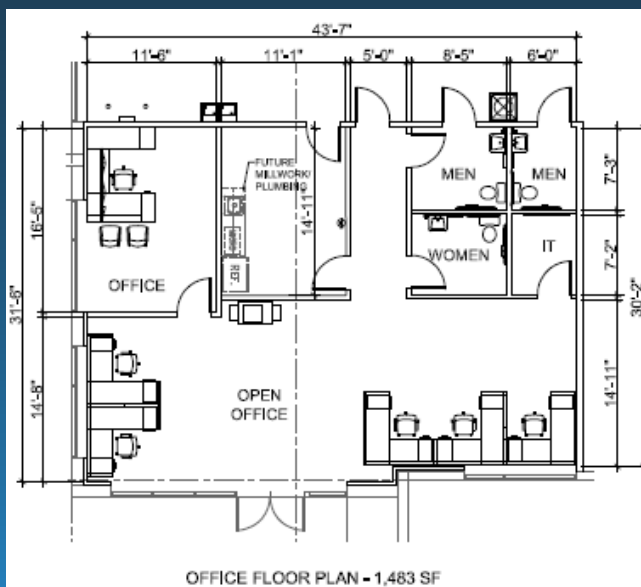
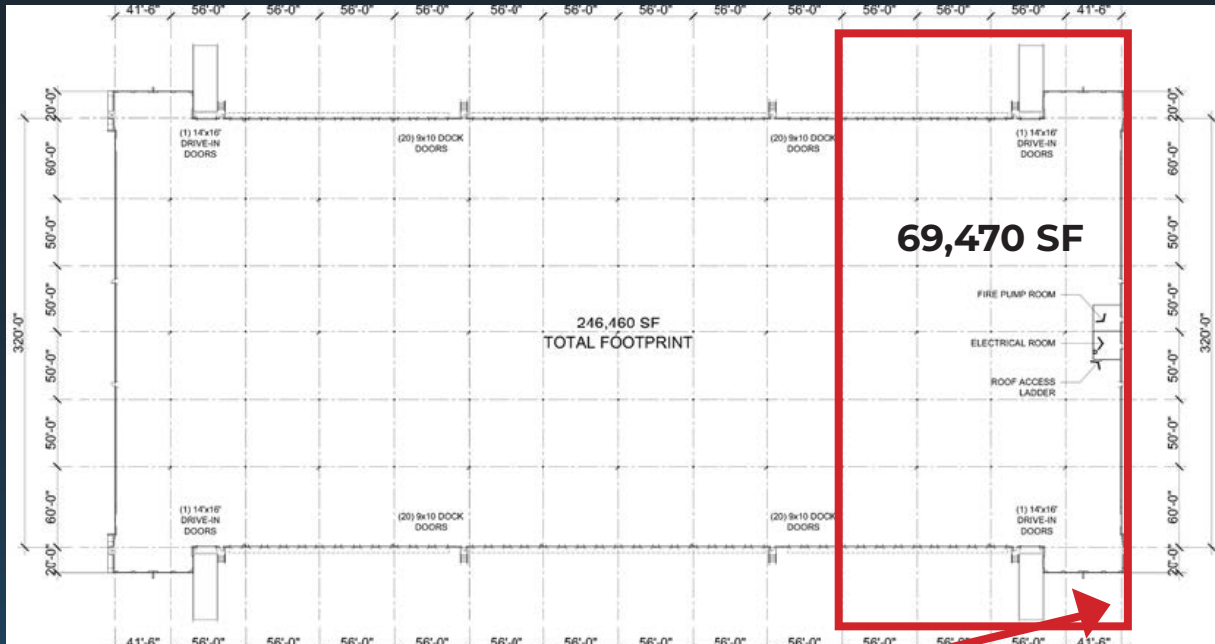

| | |
|---------------------------------|----------------------------------------|
| Master Lease Expiration: | February 28, 2030 |
| Available Size: | 69,470 SF |
| Building Size: | 246,460 SF |
| Loading: | Cross Dock |
| Building Dimensions: | 755' x 320' |
| Ceiling Height: | 36' |
| Office Space: | 1,483 SF |
| Loading Doors: | 18 Dock High Doors 2 Drive-In Ramps |
| Column Spacing: | 56' x 50' |
| Truck Court: | 185' |
| Employee Parking: | 61 Spaces |
| Sprinkler System: | ESFR |
| Warehouse Lighting: | Motion-Sensored LED |
| Power: | 800 Amps, 3 Phase |
| Zoning: | I-P |

BUILDING SPECIFICATIONS:

OPTION B - 158,300 SF

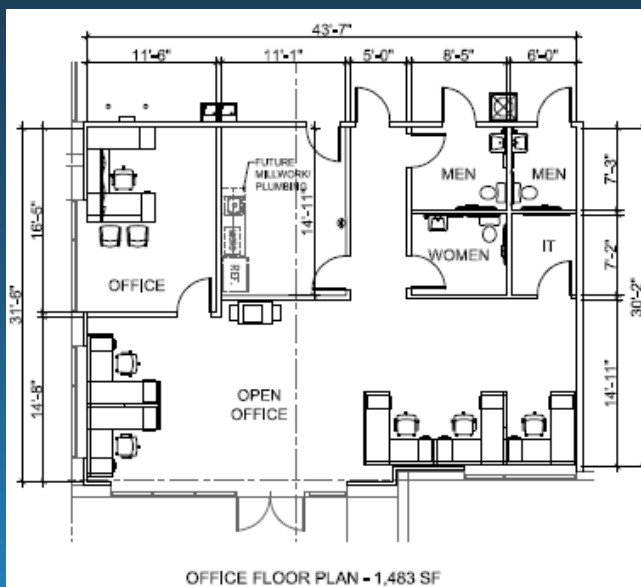
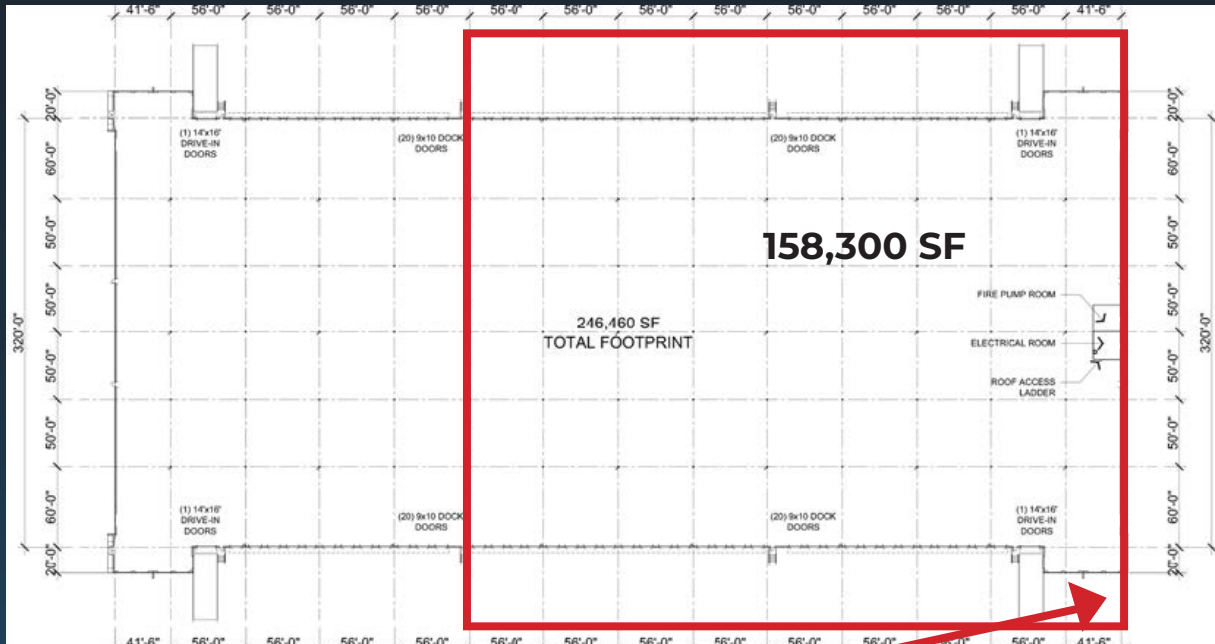

| | |
|---------------------------------|----------------------------------------|
| Master Lease Expiration: | February 28, 2030 |
| Available Size: | 158,300 SF |
| Building Size: | 246,460 SF |
| Loading: | Cross Dock |
| Building Dimensions: | 755' x 320' |
| Ceiling Height: | 36' |
| Office Space: | 1,483 SF |
| Loading Doors: | 50 Dock High Doors 2 Drive-In Ramps |
| Column Spacing: | 56' x 50' |
| Truck Court: | 185' |
| Employee Parking: | 100 Spaces |
| Sprinkler System: | ESFR |
| Warehouse Lighting: | Motion-Sensored LED |
| Power: | 800 Amps, 3 Phase |
| Zoning: | I-P |

CENTRALIZED LOCATION CLOSE TO ALL MAJOR ROADWAYS



- Light Manufacturing
- Distribution
- Logistics

This industrial building for sublease, located at 3040 Shelby Industrial Dr, is positioned in the Northwest Orlando / Apopka industrial submarket, one of Central Florida's fastest-growing logistics corridors. The property offers excellent regional connectivity with immediate access to State Road 429, U.S. Highway 441, and SR 414, providing efficient routes to Interstate 4, the Florida Turnpike, and the greater Orlando metropolitan area. This strategic location allows convenient distribution to Tampa, Jacksonville, and South Florida markets while remaining within close proximity to Orlando's major employment centers and airports.



LOCATION OVERVIEW

Located at 3040 Shelby Industrial Dr in Apopka, Florida, this warehouse space offers significant advantages for businesses looking to streamline logistics and grow their operations. Its strategic location provides direct access to State Road 429, U.S. Highway 441, SR 414, allowing efficient connectivity to Interstate 4, the Florida Turnpike, and major distribution routes throughout Central Florida.

REGIONAL DEMOGRAPHICS

| | 3 MILE | 5 MILE | 10 MILE |
|----------------|----------|----------|----------|
| Population | 29,512 | 70,142 | 359,258 |
| Households | 10,357 | 23,814 | 128,507 |
| Employees | 5,629 | 16,351 | 100,605 |
| Ave. HH Income | \$97,513 | \$96,151 | \$87,797 |

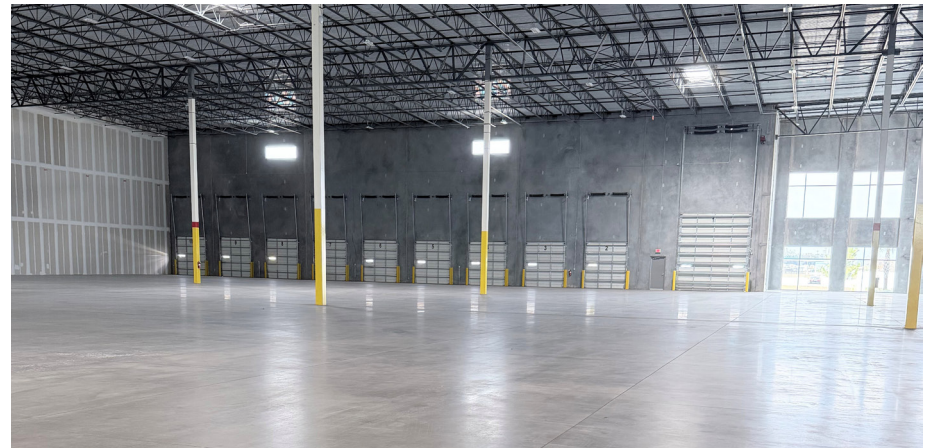

YOUR PARTNERS IN COMMERCIAL REAL ESTATE



JOE HILLS

Principal

 +1 407-718-3096

 JHills@HLIPartners.com

JOSH LIPOFF

Principal

 +1 856-535-6973

 JLipoff@HLIPartners.com

DISCLAIMER: HLI Partners LLC, a licensed real estate broker. Although information has been obtained from sources deemed reliable, neither Owner nor HLI makes any guarantees, warranties or representations, express or implied, as to the completeness or accuracy as to the information contained herein. Any projections, opinions, assumptions or estimates used are for example only. There may be differences between projected and actual results, and those differences may be material. The Property may be withdrawn without notice. Neither Owner nor HLI accepts any liability for any loss or damage suffered by any party resulting from reliance on this information. If the recipient of this information has signed a confidentiality agreement regarding this matter, this information is subject to the terms of that agreement. Any projections, opinions or estimates are subject to uncertainty and do not signify current or future property performance. HLI Partners is presenting available properties but may not be representing the ownership of all of the presented properties. ©2023. HLI Partners, LLC. All rights reserved.