

The
READ

5217 W ADAMS BLVD
LOS ANGELES, CA

8,747 SF

Ground Floor Retail /
Office Space for Lease

Demisable to $\pm 1,500$ SF



OPPORTUNITY

5217 West Adams is a newly constructed multiuse development offering a prime ground-floor retail opportunity with excellent visibility, direct access to the 10 Freeway and located in the heart of West Adams.

PROPERTY HIGHLIGHTS



New building, located in the West Adams District



Immediate access to 10 Freeway



Exterior building signage available



Within walking distance to an abundance of retail and dining destinations including Chulita, Damn I Miss Paris, Tartine, Mizlala and Cento



Hard corner location on Adams & Redondo



Onsite parking available



Interior Space

- » Exposed ceiling
- » Polished concrete floors
- » Can be demised to fit Tenant's requirements

AREA DEMOGRAPHICS

(3 Mile Radius)¹



155,394

Total Employees



22,194

Total Businesses



343,914

Population



136,889

Households

FLOOR PLAN



8,747 SF
Demisable to $\pm 1,500$ SF

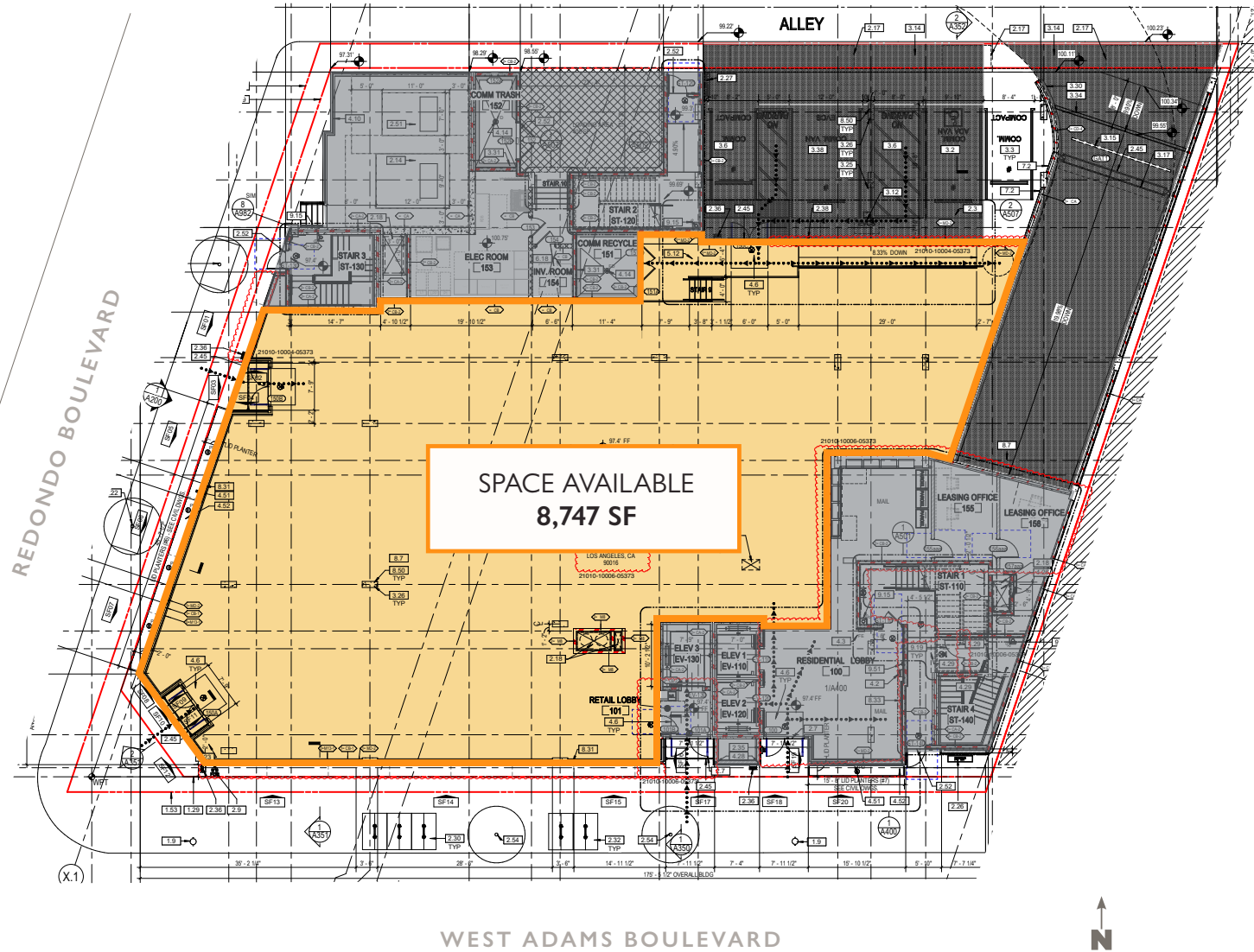

WEST ADAMS AMENITIES

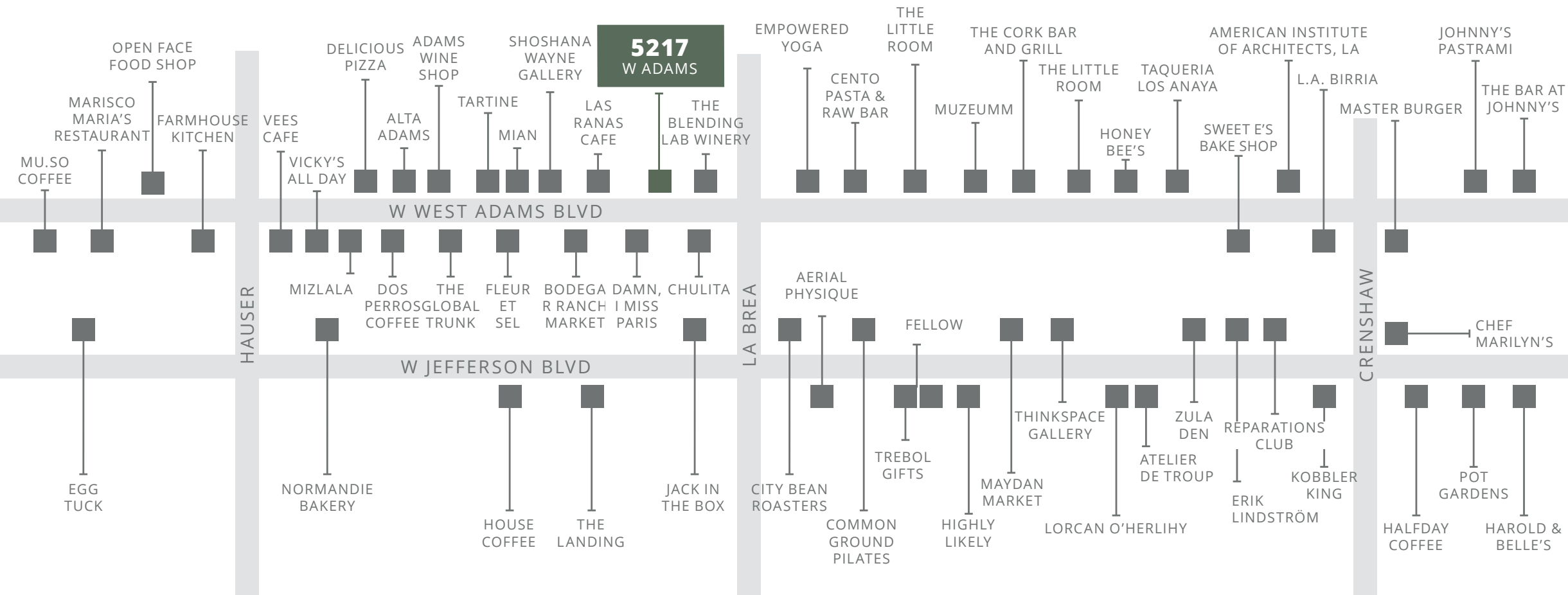

Tucked between Culver City and Downtown LA, West Adams is where creativity meets community. This neighborhood is home to local artists, up-and-coming restaurants, and unique shops. Whether you're grabbing coffee at a cozy café, checking out a gallery, or trying a new restaurant, West Adams offers a laid-back vibe with plenty to explore.

Trendy Local Businesses

- » Museum of Ice Cream
- » Aerial Physique
- » MuzeuMM
- » Fellow
- » Common Ground Pilates
- » American Institute of LA

Nearby Eateries

- » Alta Adams
- » Cento Pasta & Raw Bar
- » Chulita
- » Damn I Miss Paris
- » Fleur Et Sel
- » Tartine

The
READ

5217 WEST ADAMS BLVD, LOS ANGELES, CA

For Leasing Opportunities Contact

BLAKE ECKERT

1st Vice President

323.860.4908

beckert@cimgroup.com

Lic #01916057

GENO ST. JOHN III

Vice President

323.556.9658

gstjohn@cimgroup.com

Lic #01805139

LEONEL GARCIA

Director

323.860.4863

lgarcia@cimgroup.com

Lic #02048765



CIM is a community-focused real estate and infrastructure owner, operator, lender and developer. www.cimgroup.com

This information has been obtained from sources believed reliable, but has not been verified for accuracy or completeness. You should conduct a careful, independent investigation of the property and verify all information. Any reliance on this information is solely at your own risk.