

# Neighborhood Shopping Center For Lease

125 Washington Valley Road, Warren Twp.  
Somerset County, New Jersey 07059

## PROPERTY DESCRIPTION

Quail Run Shopping Center is a 22,000 SF neighborhood retail center consisting of two buildings, prominently positioned along Washington Valley Road. The property offers excellent visibility, abundant surface parking, and prominent signage opportunities, making it ideal for retail, service, medical, and professional tenants. Surrounded by high-income single-family homes, Quail Run benefits from strong demographics and steady consumer demand. The center is easily accessible from major highways, including I-287 and Routes 22 and 202/206, and is conveniently located near other retail destinations, restaurants, and daily conveniences. Well-maintained and professionally managed, Quail Run Shopping Center provides tenants with a highly desirable location to establish and grow their business.

## AVAILABLE FOR LEASE

Unit 1: +/- 1,694 SF

## RENTAL RATES

Upon request, subject to use and creditworthiness

## CAM & REAL ESTATE TAXES

\$8.00 psf projected 2025

## OCCUPANCY

Immediate

## FOR ADDITIONAL INFORMATION CONTACT EXCLUSIVE LEASING AGENTS

**Christian Harrington**  
Associate – Brokerage Department  
908.604.6900 X 119  
[CHarrington@silbertrealestate.com](mailto:CHarrington@silbertrealestate.com)

**SILBERT**  
REALTY & MANAGEMENT COMPANY, INC.

152 Liberty Corner Road  
Suite 203  
Warren, NJ 07059



Visit Our Website: [WWW.SilbertRealEstate.com](http://WWW.SilbertRealEstate.com)

# RETAIL LEASING PLAN

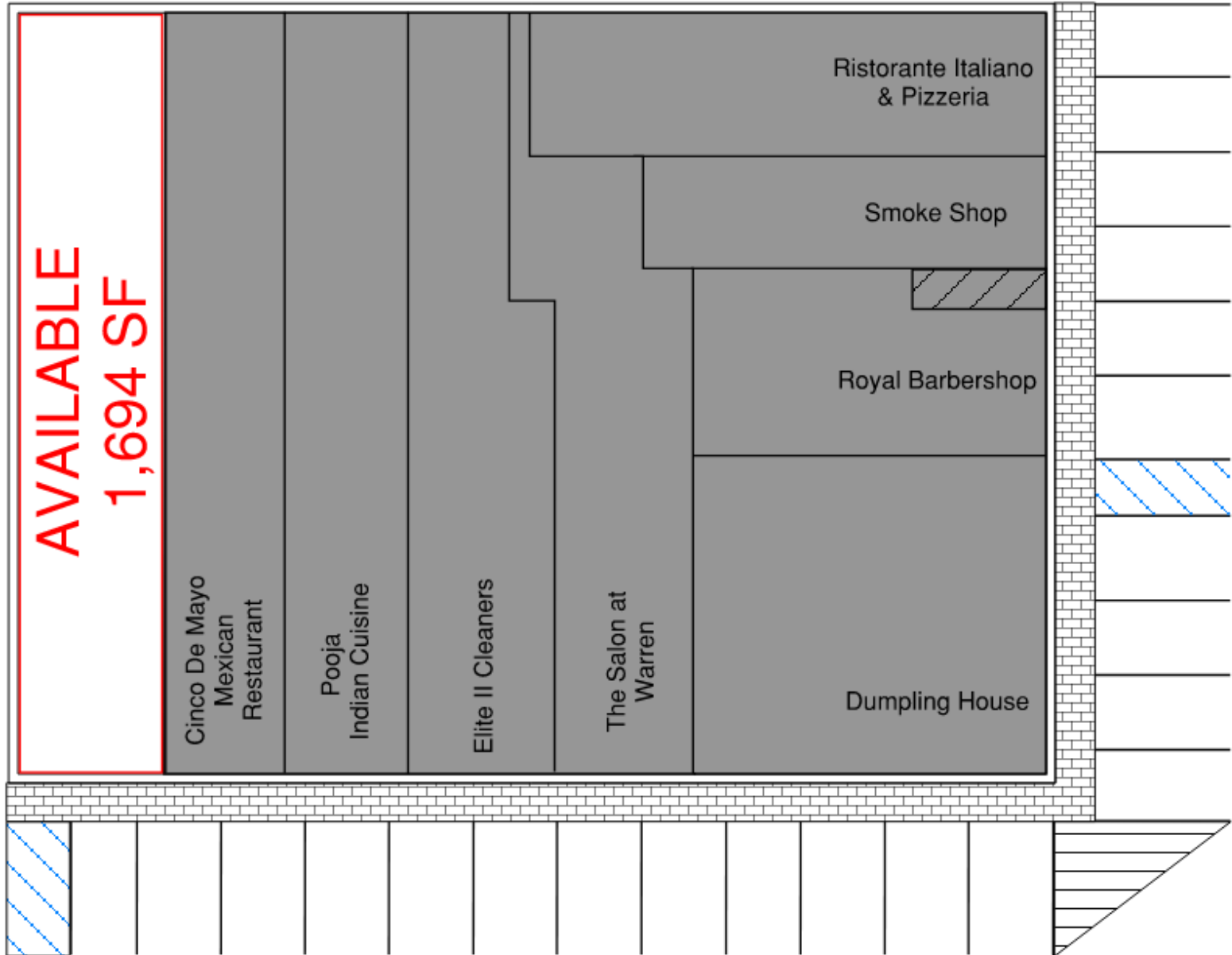



# REGIONAL TRADE AERIAL



