

FOR LEASE

356

E AVENUE K6

LANCASTER, CA 93535

BRAND-NEW INDUSTRIAL BUILDING



STRATTONCRE.COM



356
E AVENUE K6
LANCASTER, CA 93535

FOR LEASE
PRICE: CONTACT AGENT



Daniel Stratton

Vice President of Sales - DRE #01986597

Cell: 661-414-6364

Daniel@StrattonCRE.com



Robert Stratton

CEO/President - DRE #01182000

Cell: 661-212-5699

Robert@StrattonCRE.com

The information in this brochure has been obtained from sources believed to be reliable. While we do not doubt its accuracy, we have not verified it and make no guarantee, warranty or representation about it. It is your responsibility to independently confirm its accuracy and completeness.

STRATTON COMMERCIAL REAL ESTATE, INC.



356 E AVENUE K6, LANCASTER, CA 93535

STRATTONCRE.COM | SINCE 1994

OFFERING SUMMARY

356 E AVENUE K6 BRAND-NEW INDUSTRIAL BUILDING

Stratton Commercial Real Estate, Inc. is pleased to present 356 E Avenue K6, Lancaster, CA, a brand-new 27,000± sq.ft. industrial building in the prestigious Lancaster Business Park. Situated on a 58,275± sq.ft. lot within Specific Plan 80-02 zoning, this property supports a variety of industrial uses.

The new building features a modern exterior with granite highlights and professional landscaping, creating a polished first impression. Inside, the shell condition provides a blank canvas for tenants to customize the space, complemented by a master kitchen and three private restrooms with custom granite finishes for added functionality and style.

This is a prime opportunity for businesses seeking a high-quality industrial space tailored to their needs. Contact Daniel or Robert Stratton today to schedule a tour or for more details.

BUILDING SQ.FT	27,000±
LOT SIZE SQ.FT	58,275±
YEAR BUILT	2022
FLOORS	1
APN(S)	3126-032-067
CLEAR HEIGHT	11' FT.
ZONING	SP BP 80-02

















356 E AVENUE K6

LANCASTER, CA 93535

FLOOR PLAN

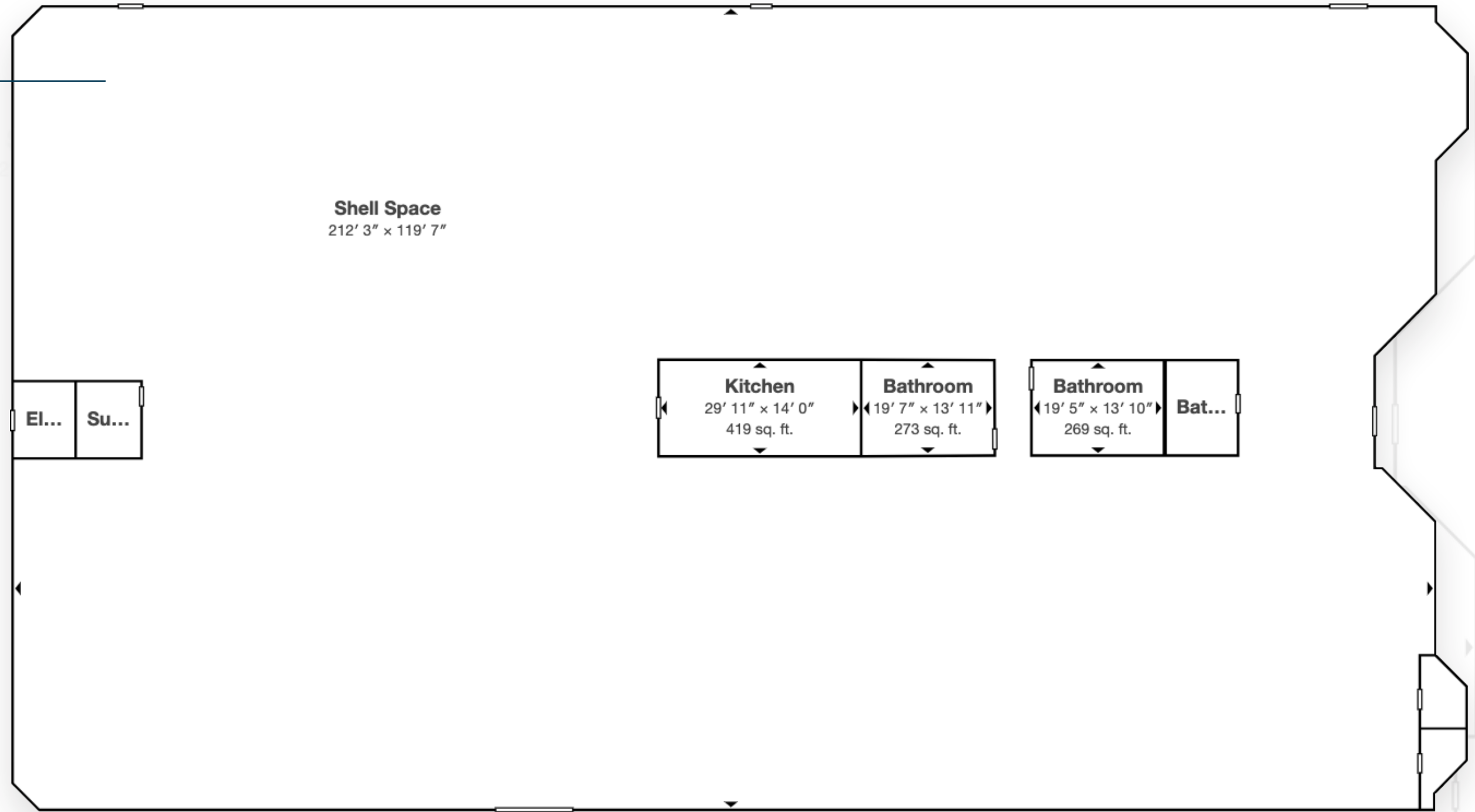

SCAN, TAP or CLICK!

The information in this floorplan has been obtained from sources believed to be reliable. While we do not doubt its accuracy, we have not verified it and make no guarantee, warranty

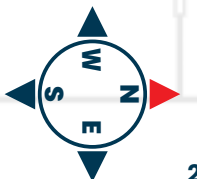



356 E AVENUE K6

LANCASTER, CA 93535

FOR LEASE NEW INDUSTRIAL BUILDING

FOR MORE INFORMATION:



Daniel Stratton

Vice President of Sales - DRE #01986597

Cell: 661-414-6364

Daniel@StrattonCRE.com



Robert Stratton

CEO/President - DRE #01182000

Cell: 661-212-5699

Robert@StrattonCRE.com

The information in this brochure has been obtained from sources believed to be reliable. While we do not doubt its accuracy, we have not verified it and make no guarantee, warranty or representation about it. It is your responsibility to independently

