



# ALLENDALE SHOPPING CENTER | PITTSFIELD, MASSACHUSETTS



## PROPERTY OVERVIEW

- Located at the intersection of Cheshire Road (Route 8) and Dalton Avenue (Route 9).
- The GLA is 211,951 sf ±
- Parking available for over 987 cars
- Pittsfield is one of the Pittsfield Metropolitan New England City and Town Statistical Areas (NECTA)
- The property is located near Interstates 90 and 91
- Situated in the heart of New England's Knowledge Corridor with the second largest concentration of New England's colleges and universities.

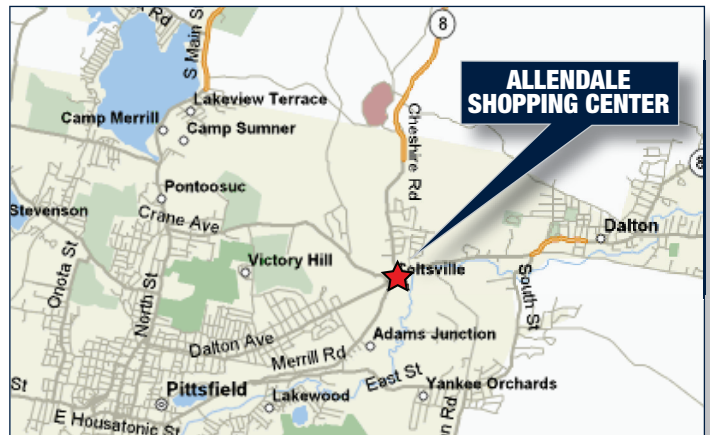

DEMOGRAPHICS	1 MILE	3 MILES	5 MILES
■ Population	2,490	34,988	53,893
■ Average HH Income	\$35,223	\$53,133	\$59,451
■ Total HH	1,271	15,525	23,434
■ Median Age	52.9	40.4	40.8

DAILY TRAFFIC COUNT	
■ Route 8	18,800 VPD
■ Route 9	19,300 VPD

CONTACT: Glenn Langenback | T: 413-236-5957 | F: 413-236-5731 | glenn@pihc.com





# ALLENDALE SHOPPING CENTER

PITTSFIELD, MASSACHUSETTS

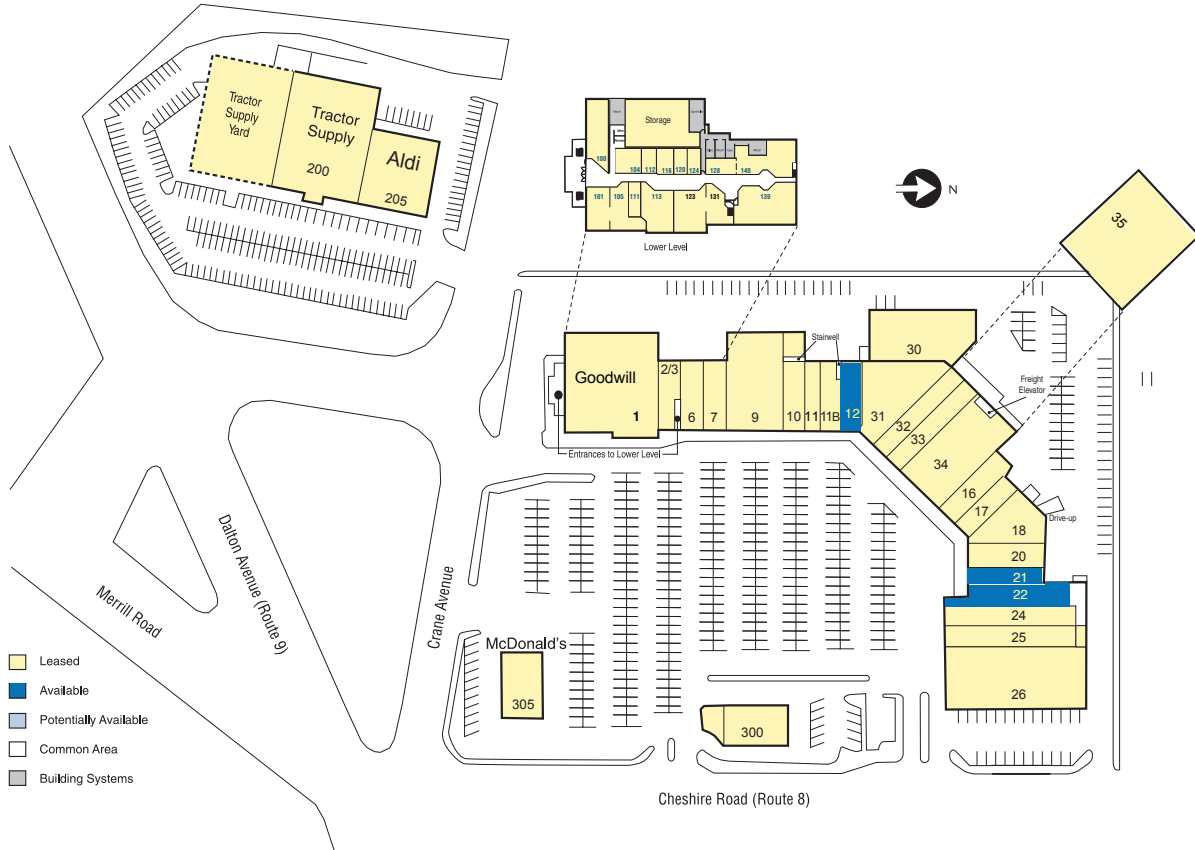

Allendale Shopping Center Property Businesses		
FIRST FLOOR		LOWER LEVEL
1. Goodwill	16. Great Expectations Dental Center	100. Hair Express
2&3. GameStop (0005)	17. Bella Tan (0061)	101/105. (combined) – Thrift Store
6. Ace Beauty Systems (0009)	18. Trustco Bank (0065)	104. Beauty Studio
7. Computer Sales & Repair	20. Osterman Propane	111. Hearing Aids
9. Walgreens (0017)	21. <b>Available 2,320 sf</b> (0073)	112. Beauty Studio (0109)
10. H&R Block (0021)	22. <b>Available 4,880 sf 9/2022</b> (0077)	113. Berkshire Running Center
11. Coffee Beans	24. Chinese Buffet (0081)	123. Berkshire Running Center (0133)
11B. Lucky Nails	25. Greylock Credit Union	131. Berkshire Running Center (0133)
12. <b>Available 2,892 sf</b> (0033)	26. Greylock Credit Union	116. Gift Shop
30. Wood Bros. Music	300. Berkshire Bank (0300)	120. Gift Shop
31. Wood Bros. Music	305. McDonalds (0305)	124. Property Management (0117)
32. Pizzeria	205. Aldi	128. Retail Coffee Shop
33. Old Brick Furniture	200. Tractor Supply (0200)	139. Chiropractor
34. Old Brick Furniture		140. Wholesale Coffee (0129)
35. Furniture Storage		

**CONTACT: Glenn Langenback** | T: 413-236-5957 | F: 413-236-5731 | glenn@pihc.com

All areas and dimensions are approximate. This plan is intended for identification purposes only and is not to be deemed a representation by Landlord as to the accuracy or square footage.

