

# 1220 & 1221 CARAWAY COURT

Upper Marlboro, MD, 20774  
Prince Georges County

**FLEX & OFFICE SPACE AVAILABLE**



## PROPERTY INFORMATION

- Two-building 155,444 SF
- Class A Flex Portfolio
- 17' clear ceilings
- Dock loading
- Ample Parking
- Located one mile to I-495

### **Immediate Proximity to:**

- Largo Town Center
- UMD Capital Region Medical Center
- Prince George's County Government Offices

LEASED BY:

**klnb**

**Kenneth Fellows**  
301-222-0210  
kfellows@klnb.com

**Robert E. Pugh**  
301-222-0211  
rpugh@klnb.com

**Keiry Martinez**  
703-334-5629  
kmartinez@klnb.com

12435 Park Potomac Ave, Suite 250  
Rockville, MD 20854  
[klnb.com](http://klnb.com)

# 1220 & 1221 CARAWAY COURT

Upper Marlboro, MD, 20774  
Prince Georges County

## 1220 | FLOOR PLAN

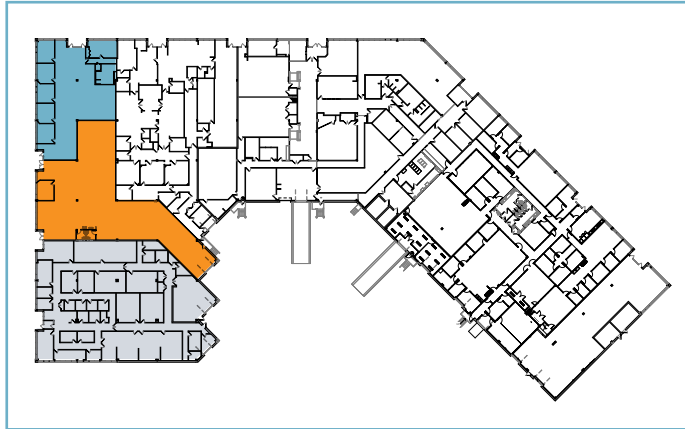

**Space A: 4,393 SF**

**Space B: 6,430 SF**

Available 03/2026

**Space C: 10,754 SF**

Available 03/2026

**Kenneth Fellows**  
kfellows@klnb.com  
301-222-0210

**Robert Pugh**  
rpugh@klnb.com  
301-222-0211

**Keiry Martinez**  
kmartinez@klnb.com  
703-334-5629

12435 Park Potomac Ave, Suite 250  
Rockville MD, 20854  
klnb.com



# 1220 & 1221 CARAWAY COURT

Upper Marlboro, MD, 20774  
Prince Georges County

1221 | FLOOR PLAN

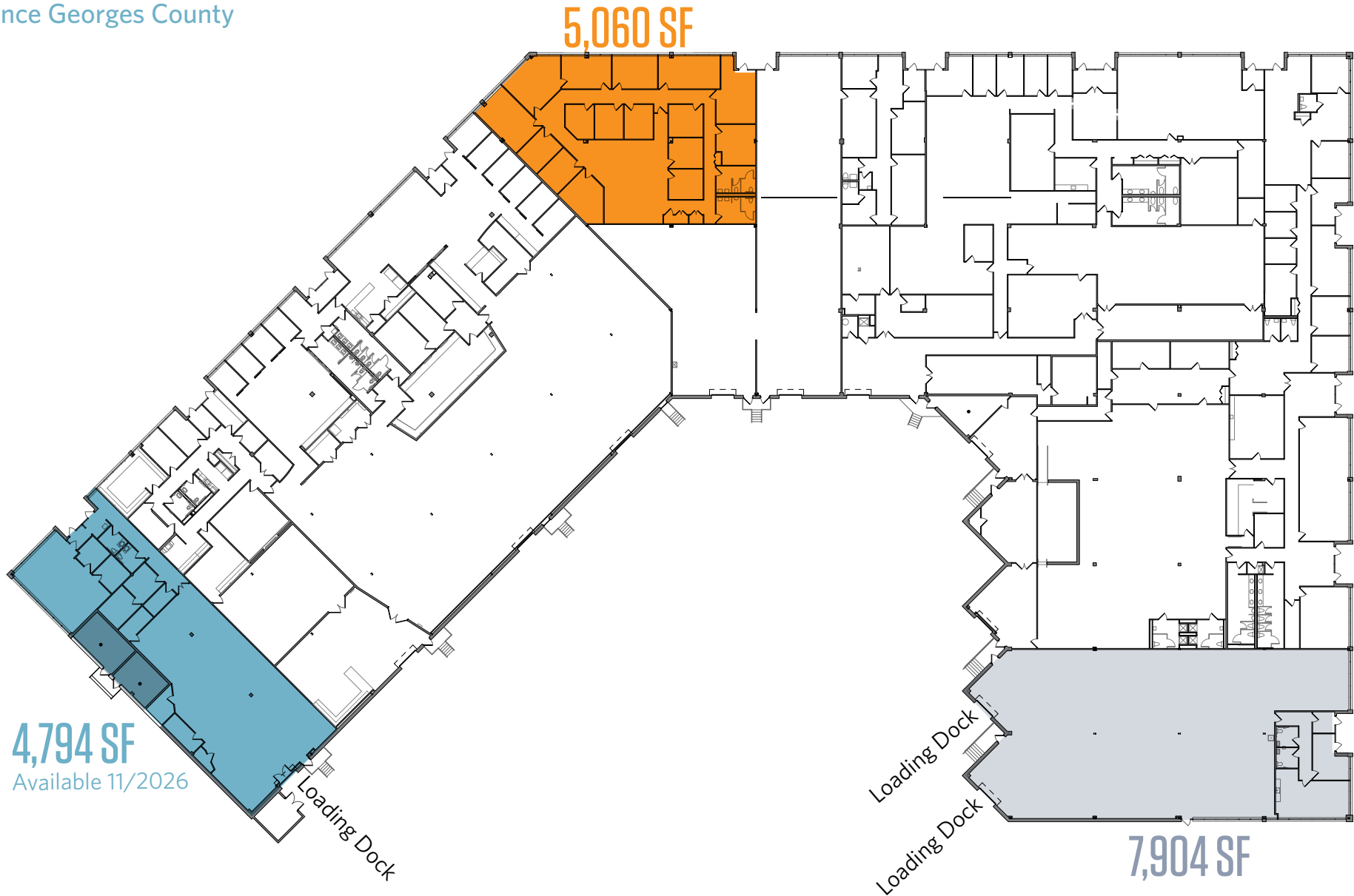

**Kenneth Fellows**  
kfellows@klnb.com  
301-222-0210

**Robert Pugh**  
rpugh@klnb.com  
301-222-0211

**Keiry Martinez**  
kmartinez@klnb.com  
703-334-5629

12435 Park Potomac Ave, Suite 250  
Rockville MD, 20854  
klnb.com



# 1220 & 1221 CARAWAY COURT

Upper Marlboro, MD, 20774  
Prince Georges County

## OVERVIEW



**Surrounding Area:**  
Lottsford Rd: 0.4 Mile  
Landover Rd: 0.7 Mile  
Largo Town Center: 1 Mile  
Route 202: 1.1 Miles  
UMD Medical Center: 1.1 Miles  
I- 495: 1.2 Miles  
Woodmore Towne Center: 1.5 Miles

**Kenneth Fellows**  
kfellows@klnb.com  
301-222-0210

**Robert Pugh**  
rpugh@klnb.com  
301-222-0211

**Keiry Martinez**  
kmartinez@klnb.com  
703-334-5629

12435 Park Potomac Ave, Suite 250  
Rockville MD, 20854  
klnb.com



# 1220 & 1221 CARAWAY COURT

Upper Marlboro, MD, 20774  
Prince Georges County

PHOTOS



**Kenneth Fellows**  
kfellows@klnb.com  
301-222-0210

**Robert Pugh**  
rpugh@klnb.com  
301-222-0211

**Keiry Martinez**  
kmartinez@klnb.com  
703-334-5629

12435 Park Potomac Ave, Suite 250  
Rockville MD, 20854  
klnb.com



# 1220 & 1221 CARAWAY COURT

Upper Marlboro, MD, 20774

Montgomery County

[CLICK TO VIEW PROPERTY WEBSITE](#)

**For More Information, Please Contact:**

**Kenneth Fellows**  
kfellows@klnb.com  
301-222-0210

**Robert Pugh**  
rpugh@klnb.com  
301-222-0211

**Keiry Martinez**  
kmartinez@klnb.com  
703-334-5629



While we have no reason to doubt the accuracy of any of the information supplied, we cannot, and do not, guarantee its accuracy. All information should be independently verified prior to a purchase or lease of the property. We are not responsible for errors, omissions, misuse, or misinterpretation of information contained herein and make no warranty of any kind, express or implied, with respect to the property or any other matters.

12435 Park Potomac Ave, Suite 250  
Rockville MD, 20854  
[klnb.com](http://klnb.com)

